

WHELEN[®]

ENGINEERING COMPANY INC.

Route 145, Winthrop Road,

Chester, Connecticut 06412

Phone: (860) 526-9504

Fax: (860) 526-4078

Internet: www.whelen.com

Sales e-mail: autosale@whelen.com

Canadian Sales e-mail: autocan@whelen.com

Customer Service e-mail: custserv@whelen.com

Installation Guide 3012, 3015 & 3022 Strobe Beacons

Safety First

This document provides all the necessary information to allow your Whelen product to be properly and safely installed. Before beginning the installation and/or operation of your new product, the installation technician and operator must read this manual completely. Important information is contained herein that could prevent serious injury or damage.

- **Proper installation of this product requires the installer to have a good understanding of automotive electronics, systems and procedures.**
- **If mounting this product requires drilling holes, the installer MUST be sure that no vehicle components or other vital parts could be damaged by the drilling process. Check both sides of the mounting surface before drilling begins. Also de-burr the holes and remove any metal shards or remnants. Install grommets into all wire passage holes.**
- **If this product is mounted with tape or Velcro™, clean the mounting surface with a 50/50 mix of isopropyl alcohol and water and dry thoroughly.**
- **Do not install this product or route any wires in the deployment area of your air bag. Equipment mounted or located in the air bag deployment area will damage or reduce the effectiveness of the air bag, or become a projectile that could cause serious personal injury or death. Refer to your vehicle owners manual for the air bag deployment area. The User/Installer assumes full responsibility to determine proper mounting location, based on providing ultimate safety to all passengers inside the vehicle.**
- **For this product to operate at optimum efficiency, a good electrical connection to chassis ground must be made. The recommended procedure requires the product ground wire to be connected directly to the NEGATIVE (-) battery post (this does not include products that use cigar power cords).**
- **If this product uses a remote device for activation or control, make sure that this device is located in an area that allows both the vehicle and the device to be operated safely in any driving condition.**
- **Do not attempt to activate or control this device in a hazardous driving situation.**
- **This product contains either strobe light(s), halogen light(s), high-intensity LEDs or a combination of these lights. Do not stare directly into these lights. Momentary blindness and/or eye damage could result.**
- **Use only soap and water to clean the outer lens. Use of other chemicals could result in premature lens cracking (crazing) and discoloration. Lenses in this condition have significantly reduced effectiveness and should be replaced immediately. Inspect and operate this product regularly to confirm its proper operation and mounting condition. Do not use a pressure washer to clean this product.**
- **It is recommended that these instructions be stored in a safe place and referred to when performing maintenance and/or reinstallation of this product.**
- **FAILURE TO FOLLOW THESE SAFETY PRECAUTIONS AND INSTRUCTIONS COULD RESULT IN DAMAGE TO THE PRODUCT OR VEHICLE AND/OR SERIOUS INJURY TO YOU AND YOUR PASSENGERS!**

Installation...

1. Remove the clamp ring that secures the dome to the base. Remove the dome.
2. Remove the three screws that secure the strobe assembly to the adapter plate. Remove the strobe assembly.
3. Remove the four screws that secure the adapter plate to the base. Remove the adapter.
4. Looking down into the base, locate the three mounting holes on the bottom of the base. These holes will be covered by the decal that is affixed to the bottom of the base.

NOTE: If the strobe is to be mounted on the vehicle as described in this procedure (permanent-style), this decal may be removed from the base and discarded. If the strobe is to be mounted with either the optional magnetic mount kit or the optional mirror mount kit, do not remove this decal!

5. Secure the supplied drilling template (located on the back of this page) to the mounting surface in the precise mounting location selected for the strobe. Before proceeding any further, it is a good idea to visually confirm that there is nothing on or near the underside of the mounting surface that could be damaged by the drilling of the mounting holes. It is also advisable to drop the vehicle's headliner to prevent drill contact and inevitable damage to the headliner.
6. Drill a 9/64" hole into each of the mounting holes indicated on the template.
7. Drill a 1/4" wire passage hole through the center of the template. Be sure to de-burr and install a properly sized grommet into this hole.
8. Position the supplied mounting gasket onto the mounting surface. Align the holes in the gasket with the holes drilled in the mounting surface.
9. With the mounting gasket still in position, and using the supplied #10 x 5/8" sheet metal screws, secure the base to the vehicle. Tighten these screws firmly, but do not over-tighten.
10. Route the two strobe assembly wires through the adapter plate, through the center of the base, through the grommeted, wire passage hole and into the vehicle.
11. Re-assemble all the components in their original locations.
12. From inside the vehicle, the strobe wires must now be extended. Use the wiring diagram on the next page to assist you.

IMPORTANT WARNING! All customer supplied wires that connect to the positive terminal of the battery must be sized to supply at least 125% of the maximum operating current, and fused AT THE BATTERY to carry that load!

WARNING! The strobe power supply is a HIGH VOLTAGE device! Do not perform ANY work on this product while in operation! WAIT 10 MINUTES after turning off power before beginning ANY work or troubleshooting procedure!

13. Mount a 5 amp switch (user supplied) within reach of the vehicle operator and extend the POSITIVE wire from the strobe and connect it to the switch. Now extend a wire from the switch and, along with the NEGATIVE wire, route these wires towards the vehicle battery.
14. Install a 5 amp fuse on the end of the POSITIVE wire and extend a wire from the fuse to the battery. There can not be more than two feet of wire between the fuse and the battery. Connect this wire to the POSITIVE terminal on the battery and connect the end of the NEGATIVE wire to the vehicle chassis ground.
15. Turn the strobe on and confirm proper operation. If the strobe does not function, check the fuse and all connections.

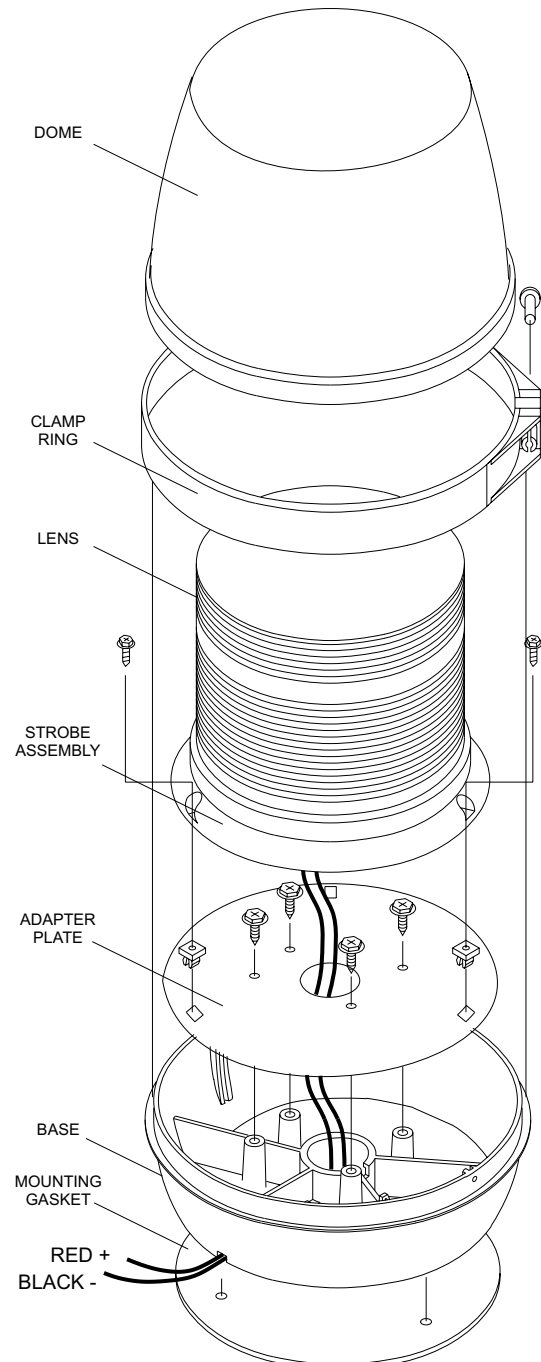

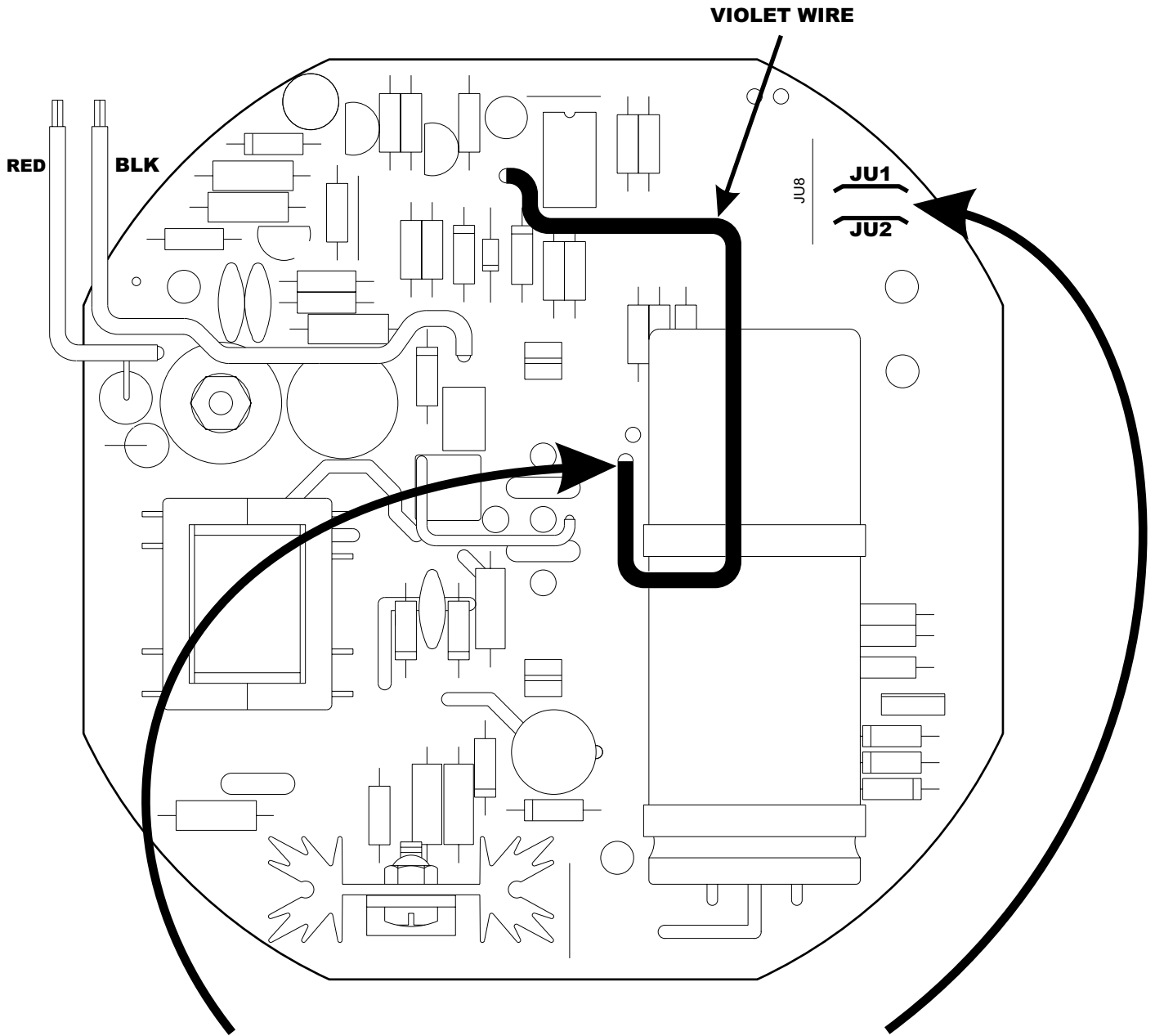

High/Low Power Control Wire*

Cut the VIOLET wire AT THIS END and extend it through the base of the beacon along with the RED and BLACK wires. High/Low activation is as follows:

Activate High Power mode by grounding the Violet wire

Activate Low Power mode by removing the Violet wire from ground.

*** Models 3015 & 3022 Only**

Flash Pattern Activation*

This beacon can be configured to display one of four available patterns. Pattern selection is determined by the state of jumpers JU1 & JU2.

	JU1	JU2
Quint Flash	IN TACT	IN TACT
Double Flash	IN TACT	CUT
Modu-Flash™	CUT	IN TACT
Action Flash™	CUT	CUT

QTY.	ITEM	PART NUMBER	DESCRIPTION
-	-	01-0663011-()	MODEL 3012
-	-	01-0663012-()	MODEL 3015
-	-	01-0663013-()	MODEL 3022
1	1	68-4161381-30	LENS, CLEAR
1	2		#10 X 3/4" P.P.H. SHEET METAL SCREW
1	3	19-261465-000	CLAMP RING
A/R	4	68-2180452-50	DOMES, (RED)
A/R	5	68-2180452-40	DOMES, (GREEN)
A/R	6	68-2180452-30	DOMES, (CLEAR)
A/R	7	68-2180452-20	DOMES, (BLUE)
A/R	8	68-2180452-10	DOMES, (AMBER)
3	9	15-066939-086	SCREW, 6-32 X 1/2" PHXWASHR HD
A/R	10	02-0283198-04	MODEL 3012 STROBE ASSEMBLY
A/R	11	02-0283146-04	MODEL 3015 STROBE ASSEMBLY
A/R	12	02-0283147-04	MODEL 3022 STROBE ASSEMBLY
4	13	15-081916-106	SCREW, 8 X 5/8" PHXWASHR HD
3	14	13-062C40-16J	SCREW GROMMET, #6 FASTEX
1	15	07-763476-000	BRACKET, 3000 SERIES ADAPTOR PLATE
1	16	11-362171-000	BASE, HOUSING
1	17	38-0241504-00	GASKET
A/R	18	01-0462174-00	KIT, MAGNET MOUNT
A/R	19	01-0462175-00	*KIT, MIRROR MOUNT
3	20		*#10 X 5/8" P.P.H. S.M.S. (MOUNTING SCREW)

*Not Shown

DIMENSIONS

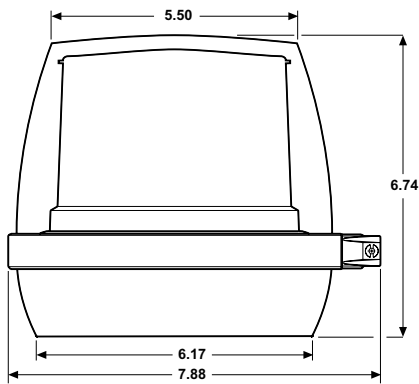

BOTTOM VIEW OF BASE

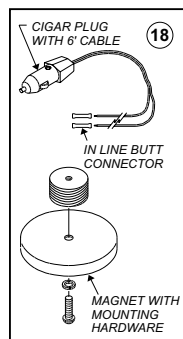
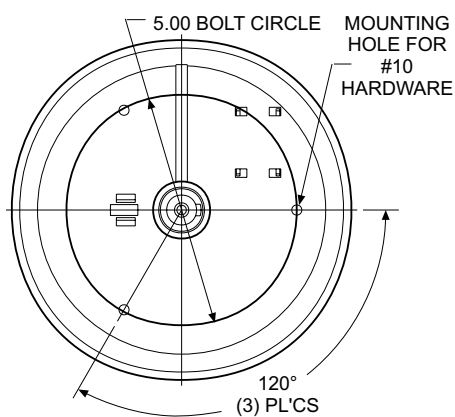

WIRING DIAGRAM

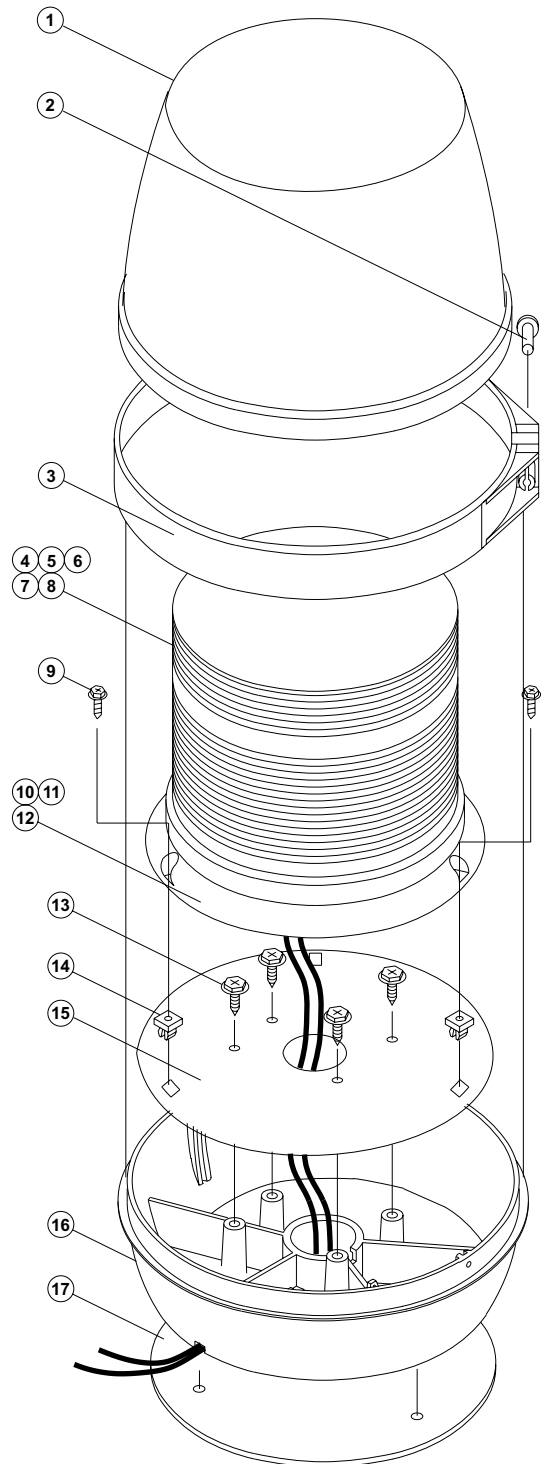
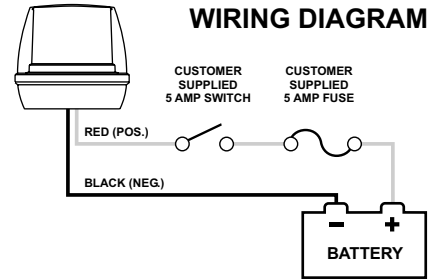

The outer surfaces of this product may be cleaned with mild soap and water. Use of any other chemicals may void product warranty. Do not use a pressure washer.

DRILLING TEMPLATE

Mounting Holes (.140" DIA. @ 120°)

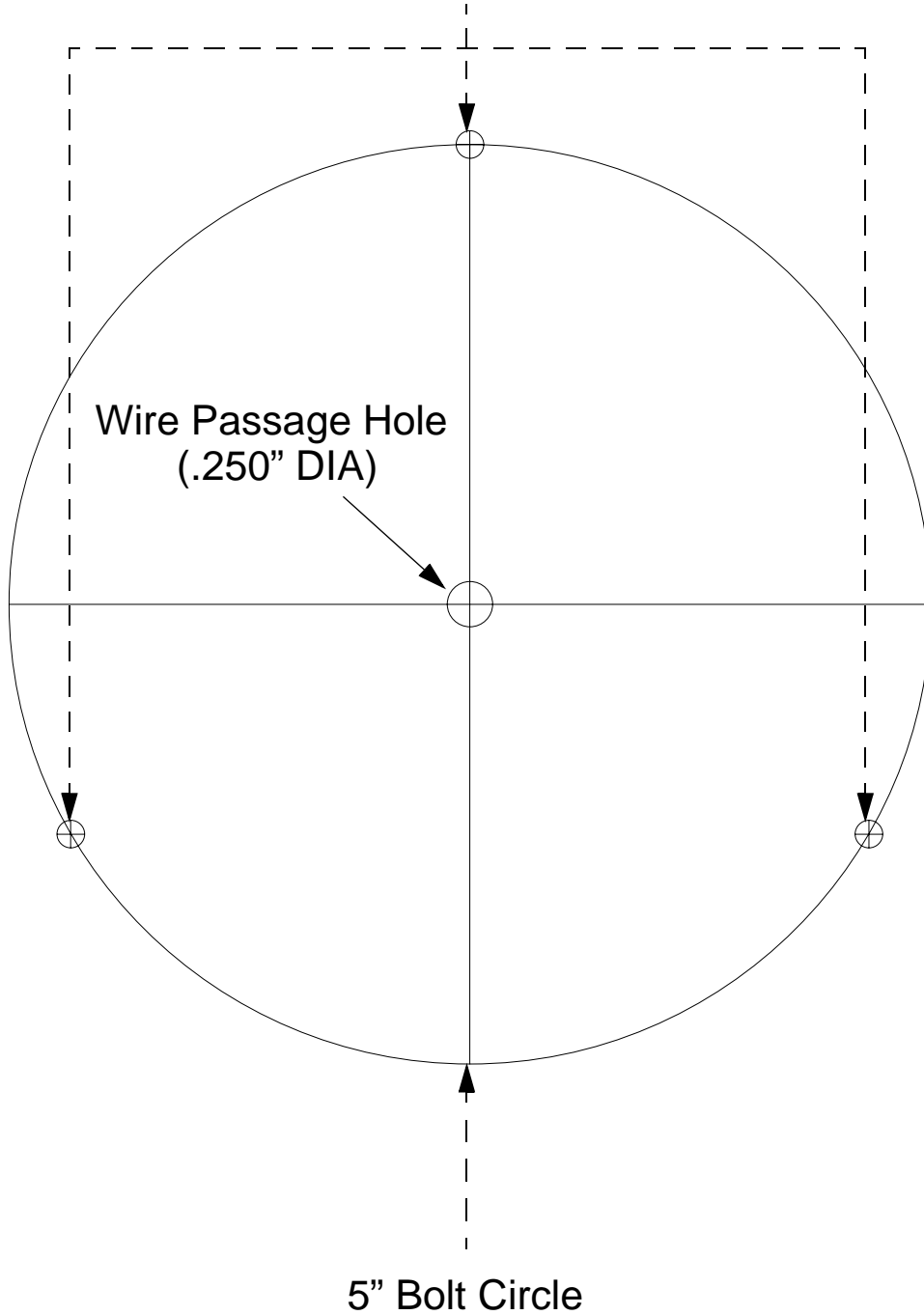

IMPORTANT NOTE!!

The template(s) included with this manual
MAY NOT BE TO SCALE.
Before drilling, *CONFIRM ALL DIMENSIONS.*