

Route 145, Winthrop Road
Chester, Ct 06412-0684
TELEPHONE: (860) 526-9504
TOLL FREE: 1-800-637-4736
FACSIMILE: (860) 526-4784

WRHX SERIES ROTATING BEACONS

WRHX012, 12 VOLTS DC
WRHX024, 24 VOLTS DC
WRHX120, 120 VOLTS AC
WRHX240, 240 VOLTS AC

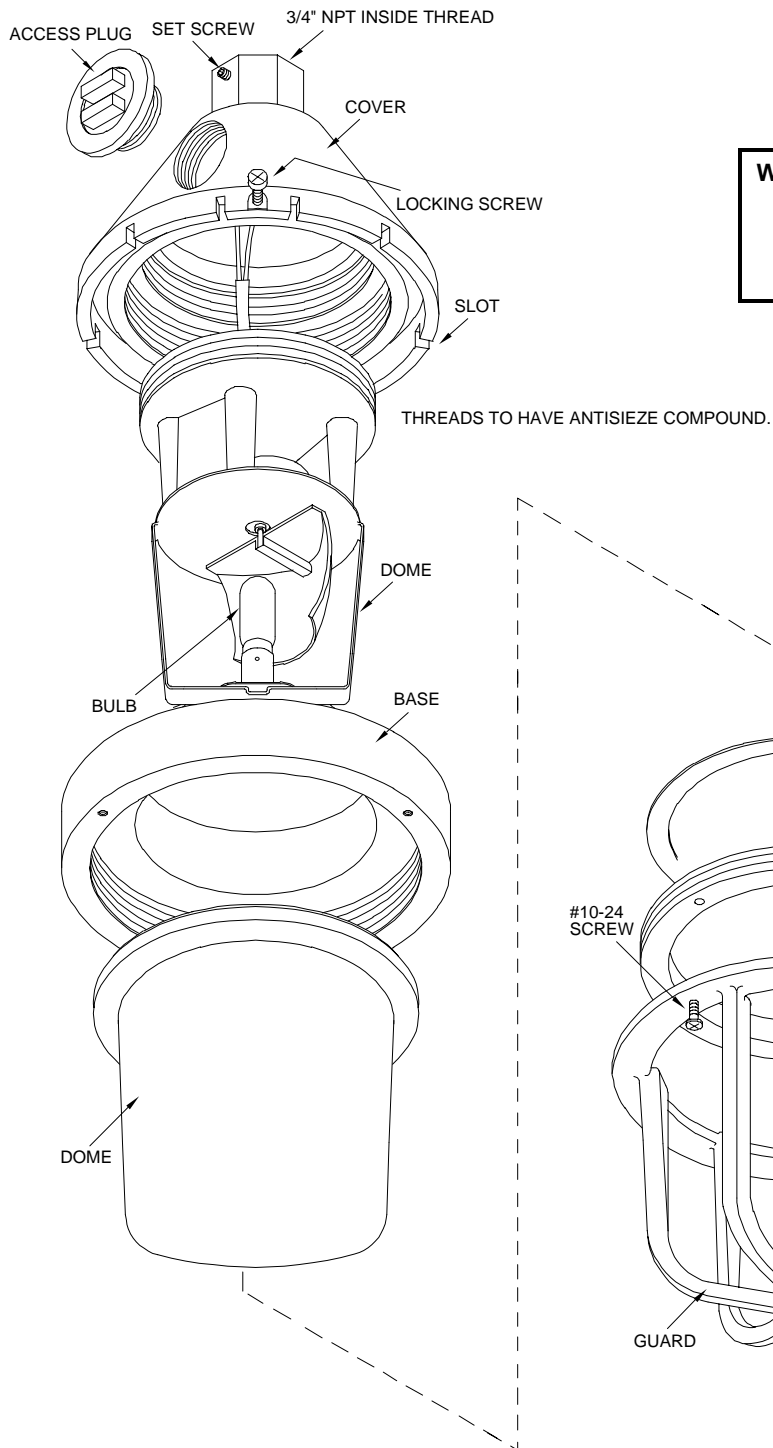

**WARNING... DISCONNECT THE
POWER SOURCE BEFORE
INSTALLING OR SERVICING
THE BEACON.**

**SEE OTHER SIDE OF PAGE FOR
REPLACEMENT PARTS LISTING.**

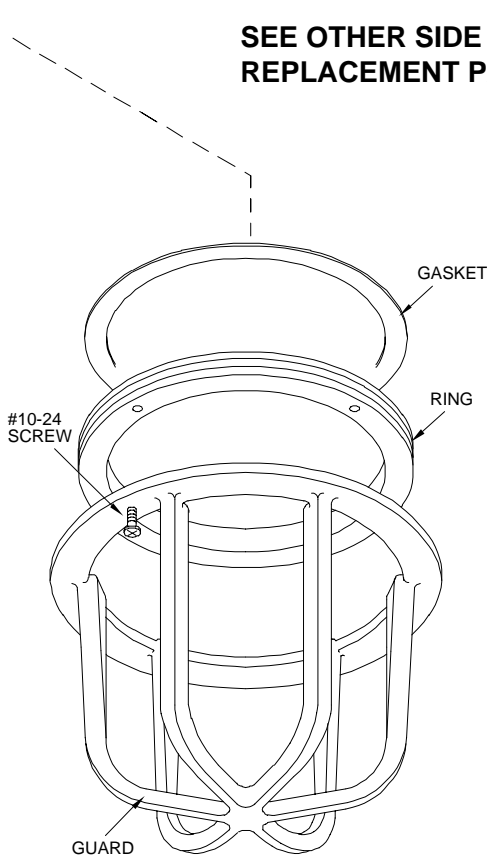

REPLACEMENT PARTS LISTING FOR WRHX SERIES BEACONS

DESCRIPTION	QTY.	PART NUMBER	WRHX012	WRHX024	WRHX120	WRHX240
LAMP BULB, 12 VDC	1	34-0412050-44	■			
LAMP BULB, 24 VDC	1	34-0428050-6B		■		
LAMP BULB, 120 VAC	1	34-0412150-59			■	
LAMP BULB, 240 VAC	1	34-0423150-59				■
MOTOR, 12 VDC	1	27-0216432-00	■			
MOTOR, 24 VDC	1	27-0216433-00		■		
MOTOR, 120 VAC	1	27-0216182-02			■	
MOTOR, 240 VAC	1	27-0216183-01				■

MOUNTING & WIRING INSTRUCTIONS

The WRHX Series of Rotating Beacons are designed for mounting to a pendant with a 3/4" NPT thread.

1. Feed the power source cable through the pipe.
2. Remove the Access Plug from the Cover of the WRHX Beacon.
3. Screw the WRHX Beacon to the pipe threads. Make sure that the power wires are not pinched or severely twisted. Tighten the Set Screw.
4. Working through the access hole. Wire the beacon according to the Model type.

MODEL WRHX012

1. Connect the RED wire to the positive DC voltage (+).
2. Connect the BLACK wire to the DC ground (-).

MODEL WRHX024

1. Connect the WHITE wire to the positive DC voltage (+).
2. Connect the BLACK wire to the DC ground (-).

MODEL WRHX120

1. Connect the GREEN wire to the AC service green wire (ground).
2. Connect the BLACK wire to the AC service black wire (hot).
3. Connect the WHITE wire to the AC service white wire (neutral).

MODEL WRHX240

1. Connect the GREEN wire to the AC service green wire (ground).
2. Connect the BLACK wire to the AC service wire (hot).
3. Connect the RED wire to the AC service wire (neutral).

5. Securely install the access plug when wiring is complete.

BULB REPLACEMENT

1. Disconnect power.
2. Remove the Locking Screw from the Cover.
3. Place a flat bladed screwdriver into one of the slots in the Cover and gently pry the Base loose. Grip the unit by the Guard and unscrew the Base assembly.

Note: There is **antiseize grease** on the threads.
4. The colored dome is held on by two tabs. Squeeze the sides of the dome, 90° either side of the tabs, to release the dome from the plate. Rotate the dome over the reflector.
5. Replace the Bulb. Re-assemble the beacon. Be sure to reinsert the Locking Screw.

Note: All internal threads must remain coated with the antiseize compound, as manufactured. Do not wipe the compound off of the threads, during service or installation.