

WHELEN[®] ENGINEERING COMPANY INC.

Route 145, Winthrop Road,
Chester, Connecticut 06412

Phone: (860) 526-9504

Fax: (860) 526-4078

Internet: www.whelen.com

Sales e-mail: autosale@whelen.com

Canadian Sales e-mail: autocan@whelen.com

Customer Service e-mail: custserv@whelen.com

Installation Guide Flatlighter FLKIT Kit

Safety First

This document provides all the necessary information to allow your Whelen product to be properly and safely installed. Before beginning the installation and/or operation of your new product, the installation technician and operator must read this manual completely. Important information is contained herein that could prevent serious injury or damage.

- **Proper installation of this product requires the installer to have a good understanding of automotive electronics, systems and procedures.**
- **If mounting this product requires drilling holes, the installer MUST be sure that no vehicle components or other vital parts could be damaged by the drilling process. Check both sides of the mounting surface before drilling begins. Also de-burr the holes and remove any metal shards or remnants. Install grommets into all wire passage holes.**
- **If this manual states that this product may be mounted with suction cups, magnets, tape or Velcro™, clean the mounting surface with a 50/50 mix of isopropyl alcohol and water and dry thoroughly.**
- **Do not install this product or route any wires in the deployment area of your air bag. Equipment mounted or located in the air bag deployment area will damage or reduce the effectiveness of the air bag, or become a projectile that could cause serious personal injury or death. Refer to your vehicle owners manual for the air bag deployment area. The User/Installer assumes full responsibility to determine proper mounting location, based on providing ultimate safety to all passengers inside the vehicle.**
- **For this product to operate at optimum efficiency, a good electrical connection to chassis ground must be made. The recommended procedure requires the product ground wire to be connected directly to the NEGATIVE (-) battery post (this does not include products that use cigar power cords).**
- **If this product uses a remote device for activation or control, make sure that this device is located in an area that allows both the vehicle and the device to be operated safely in any driving condition.**
- **Do not attempt to activate or control this device in a hazardous driving situation.**
- **This product contains either strobe light(s), halogen light(s), high-intensity LEDs or a combination of these lights. Do not stare directly into these lights. Momentary blindness and/or eye damage could result.**
- **Use only soap and water to clean the outer lens. Use of other chemicals could result in premature lens cracking (crazing) and discoloration. Lenses in this condition have significantly reduced effectiveness and should be replaced immediately. Inspect and operate this product regularly to confirm its proper operation and mounting condition. Do not use a pressure washer to clean this product.**
- **It is recommended that these instructions be stored in a safe place and referred to when performing maintenance and/or reinstallation of this product.**
- **FAILURE TO FOLLOW THESE SAFETY PRECAUTIONS AND INSTRUCTIONS COULD RESULT IN DAMAGE TO THE PRODUCT OR VEHICLE AND/OR SERIOUS INJURY TO YOU AND YOUR PASSENGERS!**

For warranty information regarding this product, visit www.whelen.com/warranty

Fig. 1

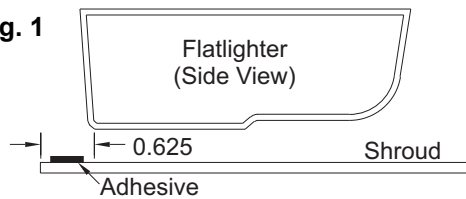

Fig. 2

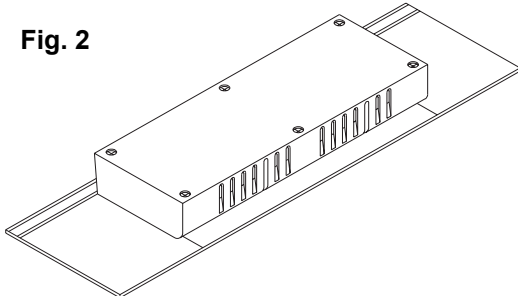

Fig. 3

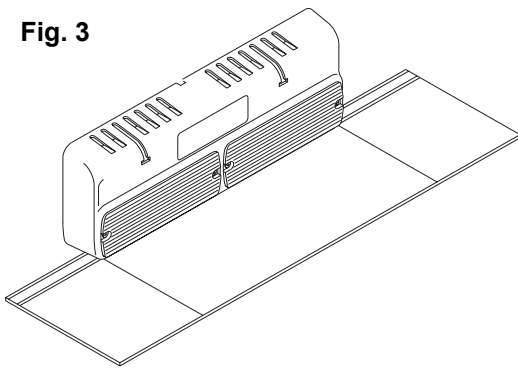

Fig. 4

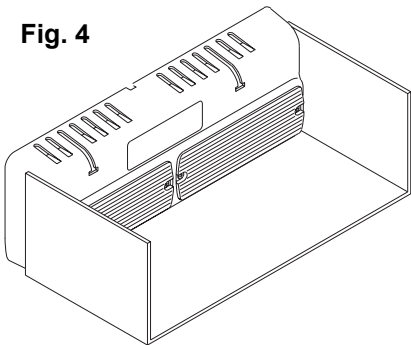
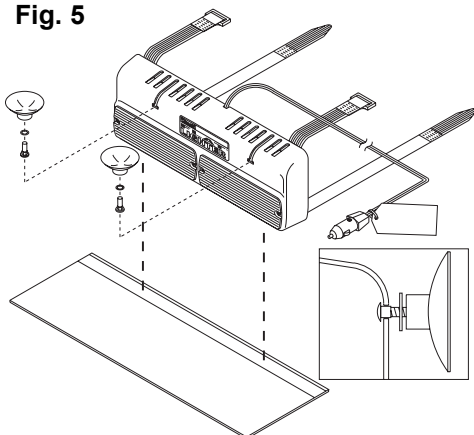

Fig. 5



Installing the FLKIT onto your new Flatlighter...

CAUTION: Nighttime operation of this product may produce reflected light within the vehicle! Use With Caution!

Shroud assembly

1. Lay the shroud flat so that the adhesive strip is facing upwards (Fig. 1). Mark the shroud with a guideline that runs the length of the shroud. This guideline should be positioned 5/8" (.625) away from the edge of the shroud nearest to the adhesive strip.
2. Position the Flatlighter face down on the shroud. Make sure that the lenses are nearest to the adhesive and that the Flatlighter is centered on the shroud. Now align the Flatlighter with the guideline as shown in Fig. 2. You can now remove the protective covering on the adhesive.
3. With the Flatlighter in position, carefully stand the unit on its bottom end as shown in Fig. 3. It is important to make sure that the shroud does not completely cover the vent slots along the bottom of the Flatlighter. Now fold the shroud up along the sides of the Flatlighter as shown in Fig. 4.

Suction cup assembly

1. Create a suction cup assembly by placing a lockwasher onto a carriage bolt (Fig. 5). Now screw a suction cup onto this bolt. It is only necessary to get the cup started on the bolt. Repeat this process for the remaining mounting hardware.
2. Although it is not necessary for windshield mounting, the velcro straps can be removed from the Flatlighter. To accomplish this, remove the four screws located at the corners of the back panel. Gently pull the strap so that it is about 1/2" away from the circuit board and slide the strap out. Repeat for remaining strap.
3. Insert a suction cup assembly into the Flatlighter case as shown in Fig. 5 (inset). Be sure that the lockwasher is positioned between the suction cup and the case. Move the assembly into the desired position and hand tighten suction cup to hold it in place.
4. Hold the Flatlighter in its desired mounting location and when the optimum position is achieved, tighten the suction cups so the proper angle is maintained. Carefully trim off any excess shroud material with a utility knife so the shroud follows the angle of the windshield.
5. Route the power cord to the vehicle's cigarette lighter so it is not in the air bag deployment zone (refer to vehicle owner's manual for air bag deployment zone locations).
6. When the cigar cord plug is inserted into the cigarette lighter port, the Flatlighter is activated by sliding the power switch to the on position.

Warning: Do not activate your Flatlighter until it's lights are facing out of the vehicle!

CAUTION: This product has been designed to rest on top of the vehicle's dashboard when used with this kit. Suction cups are provided to prevent lateral movement while the vehicle is in motion. These suction cups should not be used to suspend this product above the dashboard.

Parts Available from Whelen

Qty	Description	Part Number
2	Suction Cups	08-1516441-00
1	Windshield Shroud	11-662401-000

Parts Available at Hardware Store

2	#10 Internal Tooth Lockwashers
2	#8-32 x 3/8" Carriage Bolts