

Route 145, Winthrop Road
Chester, Ct 06412-0684
TELEPHONE: (860) 526-9504
TOLL FREE: 1-800-637-4736
FACSIMILE: (860) 526-4784

WFX SERIES EXPLOSION-PROOF FLUORESCENT LIGHTING 115VAC

SEE OTHER SIDE
OF PAGE FOR
REPLACEMENT
PARTS LISTING.

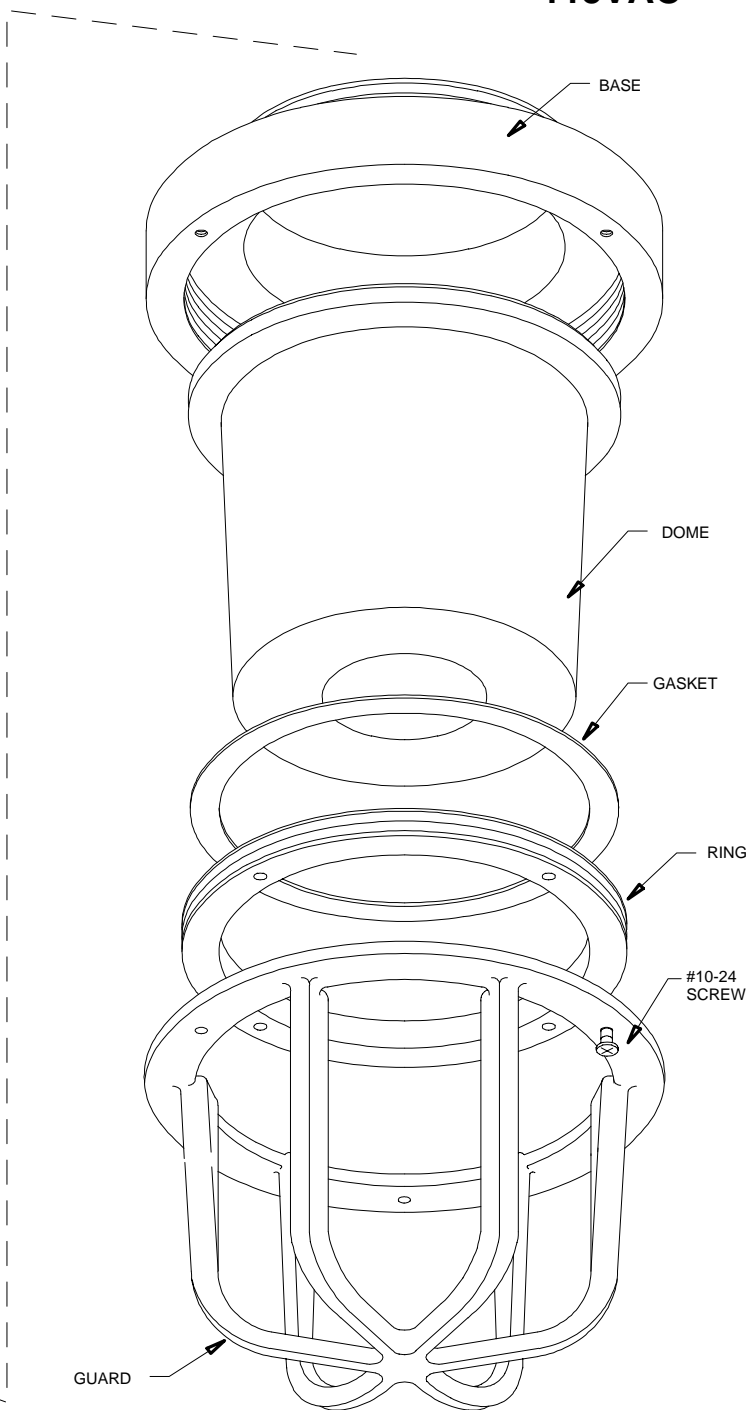
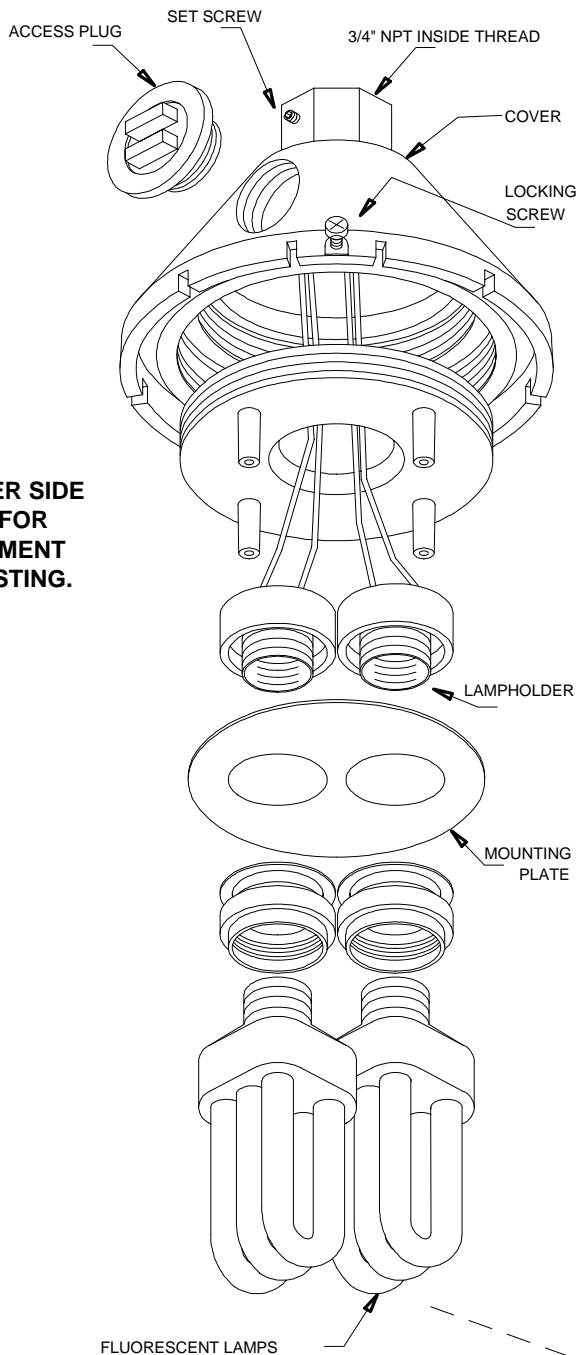

REPLACEMENT PARTS LISTING FOR WFX LIGHTS

23 Watt Fluorescent Light

Whelen P/N 34-0016478-00

MOUNTING & WIRING INSTRUCTIONS

The WFX Fluorescent Lights are designed for mounting to a pendant with a 3/4" NPT thread.

1. Feed the power source cable through the pipe.
2. Remove the Access Plug from the Cover of the WFX Light.
3. Screw the WFX Fluorescent Light to the pipe threads. Make sure that the power wires are not pinched or severely twisted. Tighten the Set Screw.

4. Working through the access hole. Connect the GREEN wire to the AC service green wire (ground).

5. Connect the BLACK wire to the AC service black wire (hot).

6. Connect the WHITE wire to the AC service white wire (neutral).

7. Securely install the access plug when wiring is complete.

Note: All internal threads must remain coated with the antiseize compound, as manufactured. Do not wipe the compound off of the threads, during installation or service.