

PRODUCT DESCRIPTION

Model WSXPL6Tx*, EXPLOSION PROOF SPEAKER ASSEMBLY

Part # 01C1461237-0x*
Doc. # 04-0113173-01

GENERAL-

Whelen Model WSXPL6Tx* is an explosion proof 60 watt speaker assembly intended for use in indoor personnel warning applications, where high sound level output is required.

The speaker flare is made from fiberglass, with a spun aluminum re-entrant section. A speaker driver, housed in an explosion proof housing, is assembled to the speaker. A heavy duty, painted steel mounting bracket allows the installer to position the speaker in a number of different ways.

An internal impedance matching transformer allows the user to select reduced power levels.

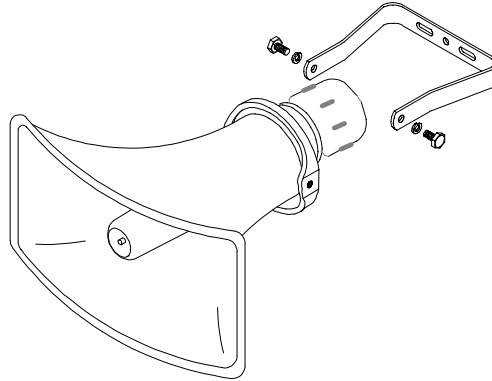

INSTALLATION-

Determine the location of the speaker. Mount to a rigid structure, using the supplied mounting bracket. The bracket dimensions are shown in the detail drawing. Position the speaker as required. Do not position the speaker pointing upward, if there is a possibility of filling with water.

Speaker connections are made by carefully removing the back cover of the driver housing. Notice that each solder tab on the transformer is labeled. Solder the two internal driver wires to the transformer lugs marked 16Ω and C. Solder one of the siren audio speaker wires to the lug marked COM. Solder the other speaker audio wire to the lug at the desired power setting.

Prior to re-assembly, make certain that the machined surfaces of the housing are clean. Do not use any type of gasket or sealing compound. Tighten all housing bolts completely.

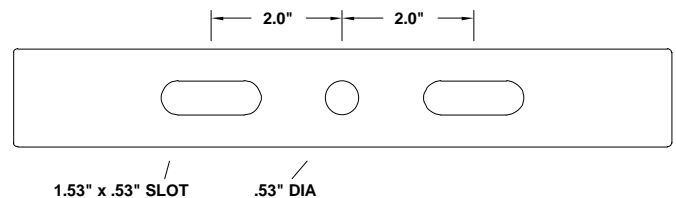

Mounting Bracket Detail

PIONEERS IN WARNING SIGNALS
WHELEN®

ENGINEERING COMPANY

Route 145, Winthrop Rd., Chester, CT 06412-0684
Tel.: (800) 63 SIREN • Fax: (860) 526-4784

Dimensions

Height: 12" (30.4 cm)
 Width: 22" (55.8 cm)
 Depth: 25.5" (58.3 cm)
 Weight: 27 lbs. (12.2 kg)

Finish

Speaker: Black

Performance

SPL: 60W 123 dbA (at 4 ft., 500 Hz)
 40W 121 dbA
 20W 118 dbA
 10W 115 dbA
 5W 112 dbA
 2.5W 109 dbA

Dispersion: 120° x 60°

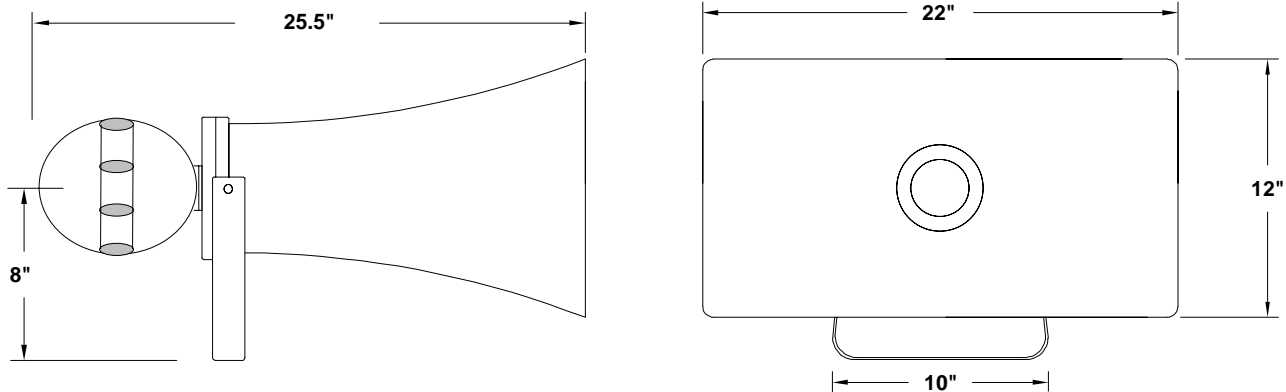

DIMENSIONS

- Notes: 1. Specify classified area.
 * x = 1 for Class I, Groups C,D
 2 for Class I, Groups C,D and Class II, Groups E, F, G
 3 for Class I, Groups B, C, D
 2. Hazardous location listings per Model HLE-30, by Atlas/Soundolier, Fenton, Missouri.
 3. SPL (Sound Pressure Level) readings are +/- 2 dbA.
 4. Sound measurements based on Whelen Amplifier 01-0285564-00C.

PIONEERS IN WARNING SIGNALS
WHELEN®
 ENGINEERING COMPANY
 Route 145, Winthrop Rd., Chester, CT 06412-0684
 Tel.: (800) 63 SIREN • Fax: (860) 526-4784