

Route 145, Winthrop Road
Chester, Ct 06412-0684
TELEPHONE: (860) 526-9504
TOLL FREE: 1-800-637-4736
FACSIMILE: (860) 526-4784

SHD SERIES STROBE BEACONS

SHD120, 120 VOLTS AC
SHD012, 12/24 VOLTS DC

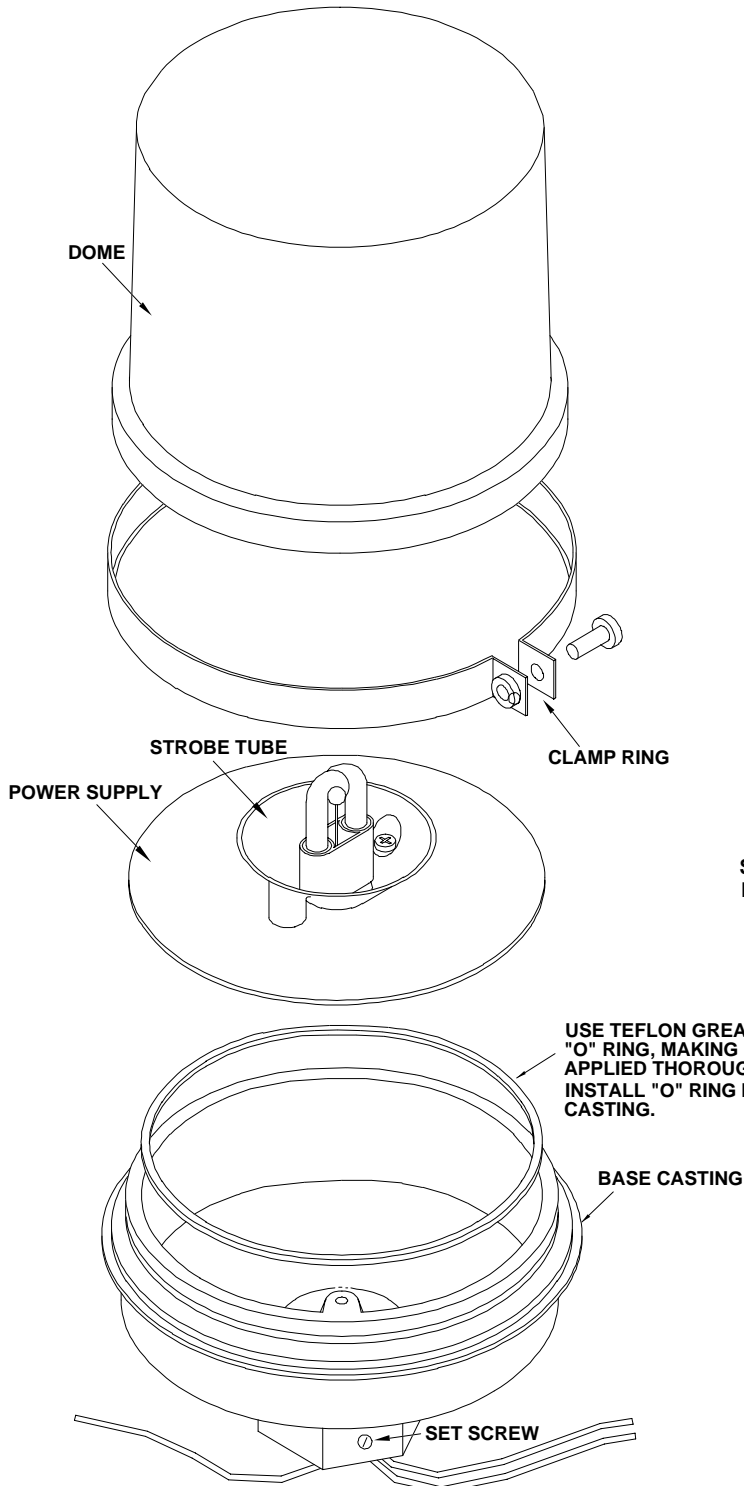

SEE OTHER SIDE OF PAGE FOR
REPLACEMENT PARTS LISTING.

USE TEFLON GREASE ON THE
"O" RING, MAKING SURE GREASE IS
APPLIED THOROUGHLY AROUND "O" RING.
INSTALL "O" RING INTO GROOVE OF
CASTING.

WARNING... DISCONNECT THE
POWER SOURCE BEFORE
INSTALLING OR SERVICING
THE BEACON.

REPLACEMENT PARTS LIST FOR SHD SERIES BEACONS

DESCRIPTION	QTY.	PART NUMBER	SHD120	SHD012
STROBE TUBE ASSEMBLY	1	36-0342400-00	■	■
POWER SUPPLY, SHD120	1	02-0168262-00	■	
POWER SUPPLY, SHD012	1	02-0168277-00		■
DOME, AMBER, LOW	1	68-4180452-10	■	■
DOME, BLUE, LOW	1	68-4180452-20	■	■
DOME, CLEAR, LOW	1	68-4180452-30	■	■
DOME, GREEN, LOW	1	68-4180452-40	■	■
DOME, RED, LOW	1	68-4180452-50	■	■

MOUNTING & WIRING INSTRUCTIONS

The SHD Series of Strobe Beacons are designed for mounting to a pendant with a 3/4" NPT thread.

1. Feed the power source cable through the pipe.
2. Connect the power cable as described below.

MODEL SHD120

1. Connect the GREEN wire to the AC service green wire (ground).
2. Connect the BLACK wire to the AC service black wire (hot).
3. Connect the WHITE wire to the AC service white wire (neutral).

MODEL SHD012

1. Connect the RED wire to the DC positive voltage.
2. Connect the BLACK wire to the DC ground.

3. Mount the Beacon to the pipe threads. Make sure that the power wires are not pinched or severely twisted. Tighten the Set Screw.

(An **anti-seize** compound is recommended in corrosive environments.)

INTERNAL CONTROL RELAY (ICR), WIRING INSTRUCTIONS (SHD120 only)

The SHD120 Strobe Beacon features an Internal Control Relay for low power (< 1mA) on/off control. A contact closure or switch may be connected to the ORANGE and GRAY ICR control lines.

The control lines are connected, at the factory, with a butt terminal. If the ICR feature is not used, ignore this section.

To use this feature:

1. Feed the control cable through the pipe.
2. Cut the butt terminal off of the ORANGE and GRAY control lines.

3. Connect the control cable to the ORANGE and GRAY wires. Polarity does not matter for a closure.

STROBE TUBE REPLACEMENT

1. Disconnect power. Wait 10 minutes for the power supply to discharge.
2. Remove the Clamp Ring. Remove the Dome from the Base.

Note: There is **teflon grease** on the O-ring. Do not wipe it off.

3. Remove two #4 Phillips head screws holding the Strobe Tube Assembly to the Power Supply. Pull the Strobe Tube Assembly out of its socket. Re-assemble the beacon. The angled lip of the Clamp Ring mounts on the Dome side. The flatter lip mounts toward the Base.

POWER SUPPLY REPLACEMENT

1. Disconnect power. Wait 10 minutes for the power supply to discharge.
2. Remove the Clamp Ring. Remove the Dome from the Base.

Note: There is **teflon grease** on the O-ring. Do not wipe it off.

3. Remove (3) #6-32 flathead screws holding the Power Supply board to the Base. Disconnect the two position plug. Disconnect the ICR wires, if used. Replace the Power Supply.
4. Re-assemble the unit. The angled lip of the Clamp Ring mounts on the Dome side. The flatter lip mounts toward the Base.