

WHELEN[®]

ENGINEERING COMPANY INC.

Route 145, Winthrop Road,
Chester, Connecticut 06412

Phone: (860) 526-9504

Fax: (860) 526-4078

Internet: www.whelen.com

Sales e-mail: autosale@whelen.com

Canadian Sales e-mail: autocan@whelen.com

Customer Service e-mail: custserv@whelen.com

Installation Guide TA836A Traffic Advisor

Safety First

This document provides all the necessary information to allow your Whelen product to be properly and safely installed. Before beginning the installation and/or operation of your new product, the installation technician and operator must read this manual completely. Important information is contained herein that could prevent serious injury or damage.

- **Proper installation of this product requires the installer to have a good understanding of automotive electronics, systems and procedures.**
- **If mounting this product requires drilling holes, the installer MUST be sure that no vehicle components or other vital parts could be damaged by the drilling process. Check both sides of the mounting surface before drilling begins. Also de-burr any holes and remove any metal shards or remnants. Install grommets into all wire passage holes.**
- **If this product is mounted with tape or Velcro™, clean the mounting surface with a 50/50 mix of isopropyl alcohol and water and dry thoroughly.**
- **Do not install this product or route any wires in the deployment area of your air bag. Equipment mounted or located in the air bag deployment area will damage or reduce the effectiveness of the air bag, or become a projectile that could cause serious personal injury or death. Refer to your vehicle owners manual for the air bag deployment area. The User/Installer assumes full responsibility to determine proper mounting location, based on providing ultimate safety to all passengers inside the vehicle.**
- **For this product to operate at optimum efficiency, a good electrical connection to chassis ground must be made. The recommended procedure requires the product ground wire to be connected directly to the NEGATIVE (-) battery post.**
- **If this product uses a remote device to activate or control this product, make sure that this control is located in an area that allows both the vehicle and the control to be operated safely in any driving condition.**
- **Do not attempt to activate or control this device in a hazardous driving situation.**
- **This product contains either strobe light(s), halogen light(s), high-intensity LEDs or a combination of these lights. Do not stare directly into these lights. Momentary blindness and/or eye damage could result.**
- **Use only soap and water to clean the outer lens. Use of other chemicals could result in premature lens cracking (crazing) and discoloration. Lens in this condition have significantly reduced effectiveness and should be replaced immediately. Inspect and operate this product regularly to confirm its proper operation and mounting condition. Do not use a pressure washer to clean this product.**
- **It is recommended that these instructions be stored in a safe place and referred to when performing maintenance and/or reinstallation of this product.**
- **FAILURE TO FOLLOW THESE SAFETY PRECAUTIONS AND INSTRUCTIONS COULD RESULT IN DAMAGE TO THE PRODUCT OR VEHICLE AND/OR SERIOUS INJURY TO YOU AND YOUR PASSENGERS!**

Installation: Mounting the Traffic Advisor

WARNING! When the Traffic Advisor is mounted to the rear of the vehicle, the cable exit must be on the passenger side. If not, the flash pattern sequence you choose on the control head will be incorrect. For example, a left flashing pattern will flash right.

Caution: Do not connect the T/A System to power until the installation is completed. When servicing or trouble shooting always disconnect it from the power source.

1. Remove the two lower brackets of the mounting feet from the mounting kit and secure them to the upper brackets with the supplied hardware.
 2. Slide the mounting feet to their desired position inside the groove, and secure them with the hardware supplied.
 3. Slightly loosen the hex nuts holding the upper and lower brackets together and place the T/A in the desired position on the proposed mounting surface. Adjust the lower brackets of the mounting feet to rest firmly on the mounting surface. Trace the outline of these brackets on that surface. If the T/A's power cable is to pass through the mounting surface, be sure to mark the area for this passage hole.
 4. Remove the T/A from the mounting surface and separate the lower brackets of the mounting feet from the upper brackets. Align these brackets with the outlines traced in the previous step. Trace mounting hole locations onto mounting surface.
- Note:** Make sure that the lower bracket is facing in the same direction as it was facing, when it was outlined on the mounting surface as indicated in step 3.
5. Examine the back side of the mounting surface to insure that no damage will occur when drilling the mounting holes. Drill mounting holes with a 7/32" drill. If a wire passage hole has been marked, drill the hole using a drill bit sized for the cable and for an appropriately sized grommet (customer supplied).
 6. Secure lower brackets to mounting surface.
 7. Lower the T/A assembly onto the two lower brackets secured to the mounting surface. Secure both brackets together with the supplied hex head screw, internal tooth lock washer, split lock washer and hex nut, in

the same order as indicated below. Before tightening the upper and lower brackets together, adjust the T/A to an angle best suited to its mounting location.

Note: There are two holes that can be used when assembling lower and upper brackets together, to position the T/A assembly at two different heights.

8. Slide the cable through the wire passage hole and route the cable to the control head mounting location. Refer to diagram below, and your control head manual for wiring.

Halogen Lamp Replacement:

WARNING! Replacing any bulb requires the use of safety glasses to prevent injury. To avoid injury, do not attempt to replace the lamp with your fingers. Use a lamp replacement tool or other suitable tool.

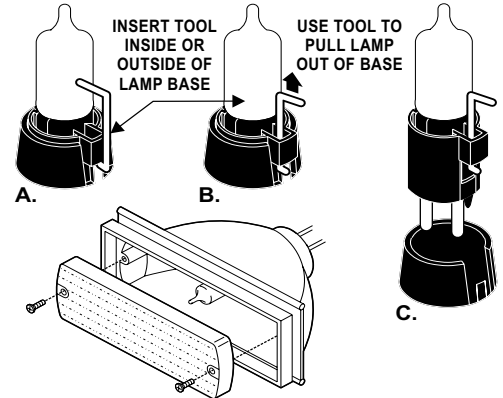

To Replace a Snap-In Bulb:

1. Be sure the power to the lamp is off. Remove the two screws holding the lens to the reflector housing, and remove the lens.
2. Locate the removal tool included with your new bulb. Use the small end of the tool on either the outside (A) or inside (B) of the base to lift the base of the bulb assembly away from the socket as shown. Continue to lift until bulb is free.
3. Insert the alignment tab of the new bulb into the bulb holder and press downwards to lock the new bulb into place.

ITEM	QTY	DESCRIPTION	PART NUMBER	ITEM	QTY	DESCRIPTION	PART NUMBER
1	2	ENDCAP	11-261326-000	9	2	1/4-20 X 7/16" HEX NUT	13-130120-070
2	6/8	#6-32 X 1/2" PPH SELF TAP MACH. SCREW	14-062216-083	10	2	1/4" SPLIT LOCK WASHER	16-1331520-65
3	8	52 HALOGEN REFLECTOR HOUSING	02-0283375-00	11	2	#10-24 WHIZ NUT	13-014111-063
4	8	SNAP-IN HALOGEN LAMP - 12V / 20W	34-0041987-04	12	4	MOUNTING BRACKET	07-261325-000
4	8	SNAP-IN HALOGEN LAMP - 28V / 35W	34-0041987-02	13	2	1/4" EXTERNAL TOOTH LOCK WASHER	16-1310820-02
5	16	#6 X 1/2" PPH THREAD FORMING SCREW	15-065419-080	14	2	#14 X 1/2" PPH "A" PT. SHEET MTL SCREW	15-211416-082
6	8	POLYCARBONATE OPTIC LENS / AMBER	68-1161313-10	15	2	1/4" INTERNAL TOOTH LOCK WASHER	16-1321560-02
7	1	HOUSING BASE / ALUMINUM	11-314126-000	16	2	1/4-20 X 3/4" HEX HEAD SCREW	14-130436-120
8	2	#10-24 X 1-1/4" PPH MACHINE SCREW	14-104216-200				

SPECIFICATIONS

Input Voltage	12.8 VDC ±20% (25.6 VDC ±20%)
Back Light Voltage	12.8 VDC ±20% (25.6 VDC ±20%)
Power Per Lamp	20W(12V) / 35W(28V)
Input Current	1.5 AMPS / LAMP (12V & 24V)
Back Light Current	100MA(12V) / 50MA(24V)
Candel Power High	770 CANDELA (AMBER)
Candel Power Low	300 CANDELA (AMBER)
Sweep Rate	40 CYCLES PER. (MIN.)

