

# WHELEN<sup>®</sup>

ENGINEERING COMPANY INC.

Route 145, Winthrop Road,  
Chester, Connecticut 06412

Phone: (860) 526-9504

Fax: (860) 526-4078

Internet: [www.whelen.com](http://www.whelen.com)

Sales e-mail: [autosale@whelen.com](mailto:autosale@whelen.com)

Canadian Sales e-mail: [autocan@whelen.com](mailto:autocan@whelen.com)

Customer Service e-mail: [custserv@whelen.com](mailto:custserv@whelen.com)

## Installation Guide: Model 52 LED Lighthouse

### Safety First

This document provides all the necessary information to allow your Whelen product to be properly and safely installed. Before beginning the installation and/or operation of your new product, the installation technician and operator must read this manual completely. Important information is contained herein that could prevent serious injury or damage.

- **Proper installation of this product requires the installer to have a good understanding of automotive electronics, systems and procedures.**
- **If mounting this product requires drilling holes, the installer MUST be sure that no vehicle components or other vital parts could be damaged by the drilling process. Check both sides of the mounting surface before drilling begins. Also de-burr any holes and remove any metal shards or remnants. Install grommets into all wire passage holes.**
- **If this product is mounted with tape or Velcro™, clean the mounting surface with a 50/50 mix of isopropyl alcohol and water and dry thoroughly.**
- **Do not install this product or route any wires in the deployment area of your air bag. Equipment mounted or located in the air bag deployment area will damage or reduce the effectiveness of the air bag, or become a projectile that could cause serious personal injury or death. Refer to your vehicle owners manual for the air bag deployment area. The User/Installer assumes full responsibility to determine proper mounting location, based on providing ultimate safety to all passengers inside the vehicle.**
- **For this product to operate at optimum efficiency, a good electrical connection to chassis ground must be made. The recommended procedure requires the product ground wire to be connected directly to the NEGATIVE (-) battery post.**
- **If this product uses a remote device to activate or control this product, make sure that this control is located in an area that allows both the vehicle and the control to be operated safely in any driving condition.**
- **Do not attempt to activate or control this device in a hazardous driving situation.**
- **This product contains either strobe light(s), halogen light(s), high-intensity LEDs or a combination of these lights. Do not stare directly into these lights. Momentary blindness and/or eye damage could result.**
- **Use only soap and water to clean the outer lens. Use of other chemicals could result in premature lens cracking (crazing) and discoloration. Lenses in this condition have significantly reduced effectiveness and should be replaced immediately. Inspect and operate this product regularly to confirm its proper operation and mounting condition. Do not use a pressure washer to clean this product.**
- **It is recommended that these instructions be stored in a safe place and referred to when performing maintenance and/or reinstallation of this product.**
- **FAILURE TO FOLLOW THESE SAFETY PRECAUTIONS AND INSTRUCTIONS COULD RESULT IN DAMAGE TO THE PRODUCT OR VEHICLE AND/OR SERIOUS INJURY TO YOU AND YOUR PASSENGERS!**

## Installation:

1. First mark the mounting holes using the measurements in the mounting diagram. In a straight line, mark the 2 screw holes and the wire access hole to the distances shown. Drill the mounting and wire access holes to the sizes in the mounting diagram.
2. Thread the wires through the rubber seal, through the wire access hole and to your power source. You should use a rubber grommet (Customer supplied) to protect the wires from the sharp metal edge of the access hole.
3. Attach light housing securely to vehicle using the supplied Phillips screws.
4. Connect the two wires to your power source, Black to Negative (-) and the remaining wire (Wire color will vary. matches LED color) to Positive (+) and test the light.

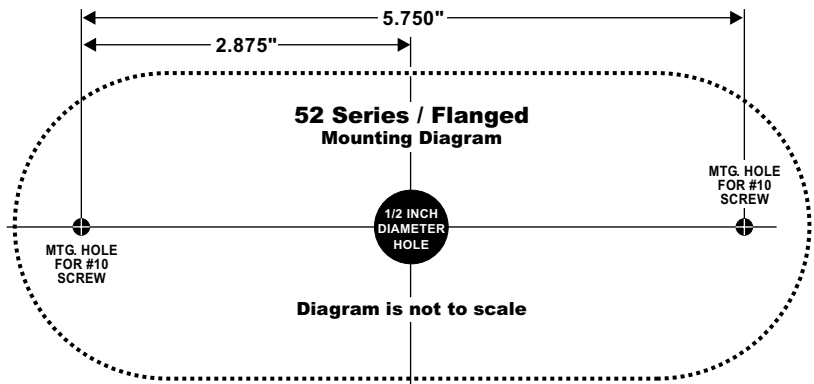
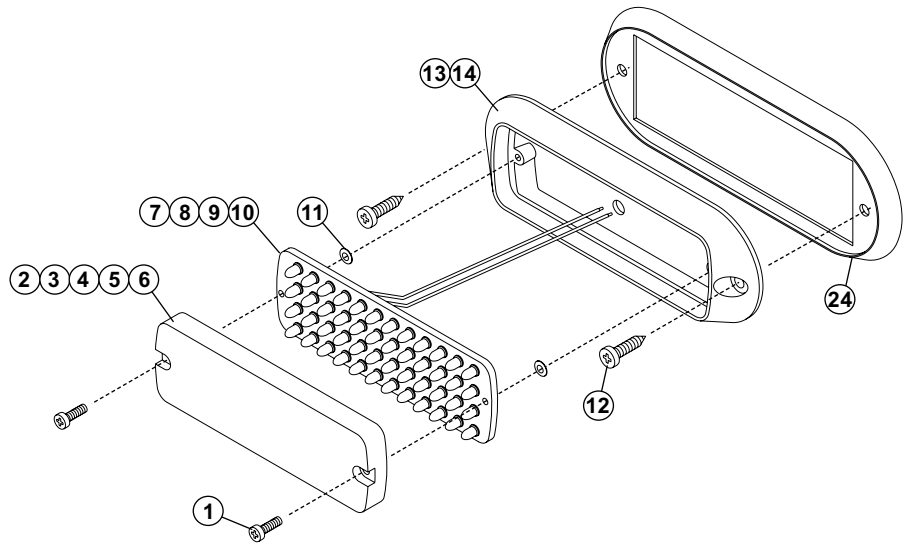

**Note:** All customer supplied wires that connect to the positive terminal of the battery, must be sized to supply at least 125% of the maximum operating current, and fused at the battery to carry that load.

## 52 Series LED Specifications:

**Input Voltage** . . . . . 12.8 VDC +/- 20%

**Input Current** . . . . . MAX. .50 AMP

**Fuse / Customer Supplied** . . . . . 3 AMP

**Flashrate / Flasher only.** . . . . . 400 FPM

### Typical Current at 12.8 VDC:

#### STEADY

RED . . . . . 40 AMP

AMBER . . . . . 40 AMP

BLUE . . . . . 29 AMP

GREEN . . . . . 29 AMP

#### FLASHER

RED . . . . . 19 AMP

AMBER . . . . . 19 AMP

BLUE . . . . . 14 AMP

GREEN . . . . . 14 AMP

QTY	QTY	QTY	QTY	QTY	QTY	QTY	QTY	QTY	ITEM	PART NUMBER	DESCRIPTION
								*		01-06830308AA	LIGHTHEAD MODEL 52 LED FLASHER AMBER / BLACK
								*		01-06830308BB	LIGHTHEAD MODEL 52 LED FLASHER BLUE / BLACK
								*		01-06830308GG	LIGHTHEAD MODEL 52 LED FLASHER GREEN / BLACK
								*		01-06830308RR	LIGHTHEAD MODEL 52 LED FLASHER RED / BLACK
			*							01-06830309AA	LIGHTHEAD MODEL 52 LED FLASHER AMBER / POLISHED
		*								01-06830309BB	LIGHTHEAD MODEL 52 LED FLASHER BLUE / POLISHED
	*									01-06830309GG	LIGHTHEAD MODEL 52 LED FLASHER GREEN / POLISHED
*										01-06830309RR	LIGHTHEAD MODEL 52 LED FLASHER RED / POLISHED
2	2	2	2	2	2	2	2	2	1	14-062216-080	SCREW / 6-32 X 1/2" PPHMS SS
-	-	-	1	-	-	-	-	1	2	68-3963199-1S	LENS / AMBER with SEAL
-	-	1	-	-	-	-	-	1	3	68-3963199-2S	LENS / BLUE with SEAL
A/R	A/R	A/R	A/R	A/R	A/R	A/R	A/R	A/R	4	68-3963199-3S	LENS / CLEAR with SEAL
-	1	-	-	-	1	-	-	-	5	68-3963199-4S	LENS / GREEN with SEAL
1	-	-	-	1	-	-	-	-	6	68-3963199-5S	LENS / RED with SEAL
-	-	-	1	-	-	-	-	1	7	02-0168340-01	ASSY / PCB 52 LED FLASHER - AMBER
-	-	1	-	-	-	-	-	1	8	02-0168652-20	ASSY / PCB 52 LED FLASHER - BLUE
-	1	-	-	-	1	-	-	-	9	02-0168652-40	ASSY / PCB 52 LED FLASHER - GREEN
1	-	-	-	1	-	-	-	-	10	02-0168340-00	ASSY / PCB 52 LED FLASHER - RED
2	2	2	2	2	2	2	2	2	11	16-0501230-31	WASHER / NYLON
2	2	2	2	2	2	2	2	2	12	15-101416-120	SCREW / #10 X 3/4" PPHMS
-	-	-	-	1	1	1	1	1	13	11-482944-007	HOUSING / BLACK
1	1	1	1	-	-	-	-	-	14	11-482944-011	HOUSING / POLISHED
1	1	1	1	1	1	1	1	1	15	10-0920855-00	LABEL / "HEAVY DUTY"
-	-	-	-	-	-	-	-	1	16	10-0522388-02	LABEL / 52 LED FLASHER - AMBER / BLACK
-	-	-	-	-	-	-	1	-	17	10-0522668-02	LABEL / 52 LED FLASHER - BLUE / BLACK
-	-	-	-	-	-	1	-	-	18	10-0522669-02	LABEL / 52 LED FLASHER - GREEN / BLACK
-	-	-	-	1	-	-	-	-	19	10-0522387-02	LABEL / 52 LED FLASHER - RED / BLACK
-	-	-	1	-	-	-	-	-	20	10-0522375-02	LABEL / 52 LED FLASHER - AMBER / POLISHED
-	-	1	-	-	-	-	-	-	21	10-0522666-02	LABEL / 52 LED FLASHER - BLUE / POLISHED
-	1	-	-	-	-	-	-	-	22	10-0522667-02	LABEL / 52 LED FLASHER - GREEN / POLISHED
1	-	-	-	-	-	-	-	-	23	10-0522374-02	LABEL / 52 LED FLASHER - RED / POLISHED
1	1	1	1	1	1	1	1	1	24	38-0461299-00	SEAL

**PART NUMBER KEY**  
01-0683030

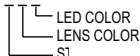

#### LED COLOR

A = AMBER C = CLEAR R = RED  
B = BLUE G = GREEN

#### LENS COLOR

A = AMBER G = GREEN  
B = BLUE R = RED

#### STYLE

8 = FLASHER / BLACK  
9 = FLASHER / POLISHED