

# WHELEN<sup>®</sup>

ENGINEERING COMPANY INC.

Route 145, Winthrop Road,  
Chester, Connecticut 06412

Phone: (860) 526-9504

Fax: (860) 526-4078

Internet: [www.whelen.com](http://www.whelen.com)

Sales e-mail: [autosale@whelen.com](mailto:autosale@whelen.com)

Canadian Sales e-mail: [autocan@whelen.com](mailto:autocan@whelen.com)

Customer Service e-mail: [custserv@whelen.com](mailto:custserv@whelen.com)

## Installation Guide: West Coast Mirror Brackets

### Safety First

This document provides all the necessary information to allow your Whelen product to be properly and safely installed. Before beginning the installation and/or operation of your new product, the installation technician and operator must read this manual completely. Important information is contained herein that could prevent serious injury or damage.

- **Proper installation of this product requires the installer to have a good understanding of automotive electronics, systems and procedures.**
- **If mounting this product requires drilling holes, the installer MUST be sure that no vehicle components or other vital parts could be damaged by the drilling process. Check both sides of the mounting surface before drilling begins. Also de-burr the holes and remove any metal shards or remnants. Install grommets into all wire passage holes.**
- **If this manual states that this product may be mounted with suction cups, magnets, tape or Velcro™, clean the mounting surface with a 50/50 mix of isopropyl alcohol and water and dry thoroughly.**
- **Do not install this product or route any wires in the deployment area of your air bag. Equipment mounted or located in the air bag deployment area will damage or reduce the effectiveness of the air bag, or become a projectile that could cause serious personal injury or death. Refer to your vehicle owners manual for the air bag deployment area. The User/Installer assumes full responsibility to determine proper mounting location, based on providing ultimate safety to all passengers inside the vehicle.**
- **For this product to operate at optimum efficiency, a good electrical connection to chassis ground must be made. The recommended procedure requires the product ground wire to be connected directly to the NEGATIVE (-) battery post (this does not include products that use cigar power cords).**
- **If this product uses a remote device for activation or control, make sure that this device is located in an area that allows both the vehicle and the device to be operated safely in any driving condition.**
- **Do not attempt to activate or control this device in a hazardous driving situation.**
- **This product contains either strobe light(s), halogen light(s), high-intensity LEDs or a combination of these lights. Do not stare directly into these lights. Momentary blindness and/or eye damage could result.**
- **Use only soap and water to clean the outer lens. Use of other chemicals could result in premature lens cracking (crazing) and discoloration. Lenses in this condition have significantly reduced effectiveness and should be replaced immediately. Inspect and operate this product regularly to confirm its proper operation and mounting condition. Do not use a pressure washer to clean this product.**
- **It is recommended that these instructions be stored in a safe place and referred to when performing maintenance and/or reinstallation of this product.**
- **FAILURE TO FOLLOW THESE SAFETY PRECAUTIONS AND INSTRUCTIONS COULD RESULT IN DAMAGE TO THE PRODUCT OR VEHICLE AND/OR SERIOUS INJURY TO YOU AND YOUR PASSENGERS!**

**For warranty information regarding this product, visit [www.whelen.com/warranty](http://www.whelen.com/warranty)**

Shatter-proof Lexan® optic lens available in all safety colors. (NOTE: Shown is the remote strobe light head assembly used on the Model "R" mirror mount).

7" extension and retraction arm to protect strobe light assembly against damage by retracting when hit. Arm also extends light head outward from vehicle for optimum rear visibility.

3/16" x 1-1/2" aluminum brackets.

Secure strobe light cable to aluminum brackets with heavy duty ty-wraps (customer supplied).

Cable to remote strobe power supply.

Whiz nuts.

"U" bolts to hold mirror mount to mirror tubes.

When installing make sure remote strobe light head assembly is level and all nuts are tight. The aluminum brackets may be bent with a large adjustable wrench.

Whelen Engineering offers the West Coast mirror mount bracket to be used with two of its remote strobe light head assemblies: Models "R", and "SS-364". Parts listing of these models are featured on the other side of this page.

**IMPORTANT NOTE:**  
The remote strobe light head assembly is secured to the mirror mount by a 1/2 - 13 hex head stainless steel bolt and a 1/2" split lock washer. It is important, depending on the mounting mode used, to use the proper length bolt as indicated in Fig.1 on the right, to prevent damage to wiring inside the base of the strobe light head assembly.

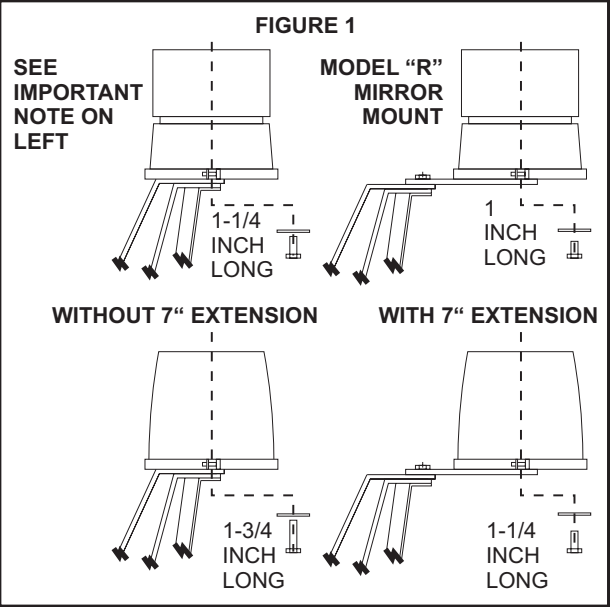
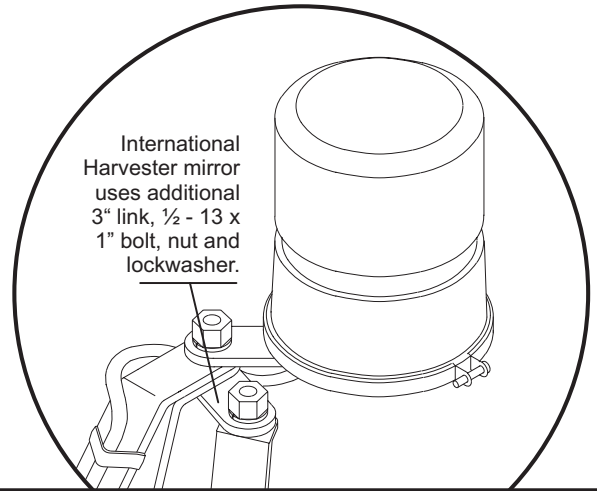

ITEM	QTY.	DESCRIPTION	PART NUMBER
1	1	UPPER MIRROR MOUNT BRACKET	07-280869-001
2	1	CENTER MIRROR MOUNT BRACKET	07-280869-002
3	1	BOTTOM MIRROR MOUNT BRACKET	07-280869-003
4	1	MIRROR MOUNT LINK, 7"	07-280868-003
5	1	1/2 - 13 STAINLESS STEEL HEX NUT	13-173120-120
6	2	1/2" SPLIT LOCKWASHER	16-1732720-14
7	1	1/2 - 13 x 1-1/2" HEX HEAD S.S. BOLT	14-173436-240
8	1	1/2 - 13 x 1" HEX HEAD S.S. BOLT	14-173436-160
9	1	3/8 - 16 x 1" HEX HEAD S.S. NUT	13-156120-090
10	1	3/8" SPLIT LOCKWASHER	16-1532220-10
11	1	3/8 - 16 x 1" HEX HEAD S.S. BOLT	14-156436-160
12	8	10-24 WHIZ NUT CADIUM PLATED	13-104111-063
13	4	10-24 S.S. "U" BOLT	14-104646-240

ITEM QTY.	DESCRIPTION	PART NUMBER
1 1	CAST ALUMINUM BASE	54-180408-601
2 1	STEEL CLAMP RING	19-260442-000
3 1	10-24 x 3/4" PHILLIPS P.H.M. SCREW	14-104216-120
4 1	OCTAL SOCKET	40-0710800-10
5 2	6-32 x 1/4" PHILLIPS P.H.M. SCREW	14-062216-040
6 1	STROBE FLASH TUBE (Z 360)	36-0260451-00
7 1	3-CONDUCTOR CABLE;15 FEET	46-0615395-00
8 1	INNER OPTIC LENS (CLEAR)	68-2180412-30
9 1	LEXAN® OPTIC DOME (RED)*	68-2180347-50
9 1	LEXAN® OPTIC DOME (GREEN)*	68-2180347-40
9 1	LEXAN® OPTIC DOME (CLEAR)*	68-2180347-30
9 1	LEXAN® OPTIC DOME (BLUE)*	68-2180347-20
9 1	LEXAN® OPTIC DOME (AMBER)*	68-2180347-10
10 1	"SUN" SHADE DECAL	38-0140320-00

\*DOMES AVAILABLE IN SPLIT COLORS

## MODEL "SS-364" MIRROR MOUNT

The Whelen West Coast mirror bracket models are available with two different remote strobe light assemblies. Shown on this page are the parts listing for these two lights.

**IMPORTANT NOTE:** Carefully read the information concerning the mounting of the strobe light head assemblies on the mirror mount brackets as indicated in Figure 1 shown on the other side of this page.

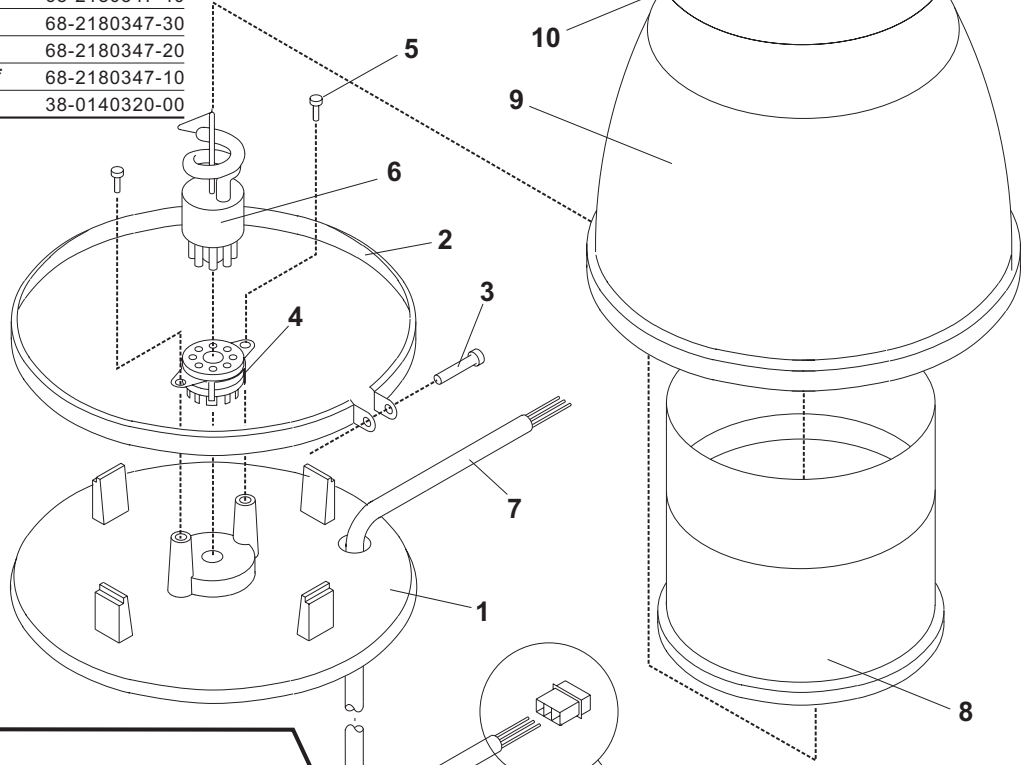
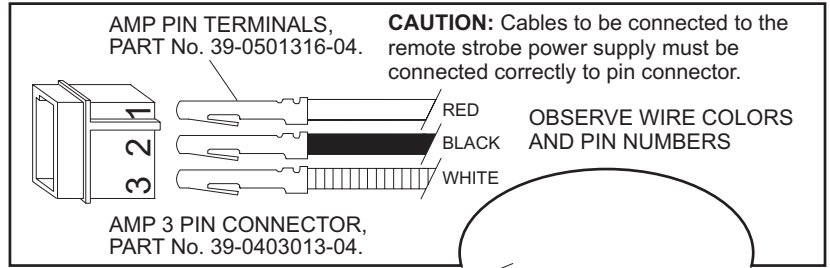

**NOTE: READ IMPORTANT INFORMATION IN FIGURE 2 ABOVE.**

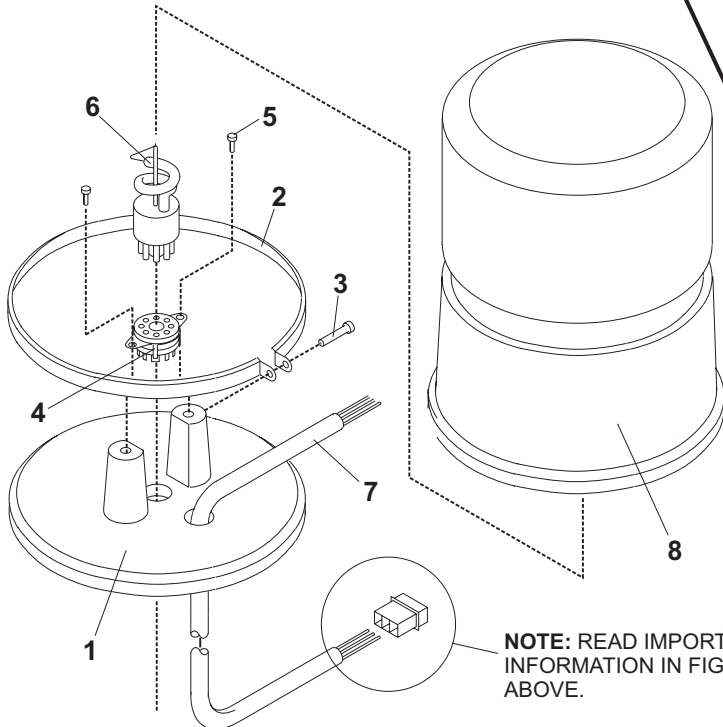

**NOTE: READ IMPORTANT INFORMATION IN FIGURE 2 ABOVE.**

ITEM QTY.	DESCRIPTION	PART NUMBER
1 1	CAST ALUMINUM BASE (FLANGE MT)	54-160218-601
2 1	STEEL CLAMP RING	19-240213-000
3 1	10-24 x 3/4" PHILLIPS P.H.M. SCREW	14-104216-120
4 1	OCTAL SOCKET	40-0710800-10
5 2	6-32 x 1/4" PHILLIPS P.H.M. SCREW	14-062216-040
6 1	STROBE FLASH TUBE (S 406)	36-0211063-00
7 1	3-CONDUCTOR CABLE; 15 FEET	46-0615395-00
8 1	LEXAN® OPTIC DOME (RED)*	68-2180483-50
8 1	LEXAN® OPTIC DOME (GREEN)*	68-2180483-40
8 1	LEXAN® OPTIC DOME (CLEAR)*	68-2180483-30
8 1	LEXAN® OPTIC DOME (BLUE)*	68-2180483-20
8 1	LEXAN® OPTIC DOME (AMBER)*	68-2180483-10

\*DOMES AVAILABLE IN SPLIT COLORS