

# WHELEN<sup>®</sup>

ENGINEERING COMPANY INC.

51 Winthrop Road  
Chester, Connecticut 06412-0684  
Phone: (860) 526-9504  
Fax: (860) 526-4078  
Internet: [www.whelen.com](http://www.whelen.com)  
Sales e-mail: [autosale@whelen.com](mailto:autosale@whelen.com)  
Canadian Sales e-mail: [autocan@whelen.com](mailto:autocan@whelen.com)  
Customer Service e-mail: [custserv@whelen.com](mailto:custserv@whelen.com)

## Installation Guide: Centurion™ Lightbar Option Kit Model KCRUISE (Cruise Lights)

### Safety First

This document provides all the necessary information to allow your Whelen product to be properly and safely installed. Before beginning the installation and/or operation of your new product, the installation technician and operator must read this manual completely. Important information is contained herein that could prevent serious injury or damage.

- Proper installation of this product requires the installer to have a good understanding of automotive electronics, systems and procedures.
- If mounting this product requires drilling holes, the installer **MUST** be sure that no vehicle components or other vital parts could be damaged by the drilling process. Check both sides of the mounting surface before drilling begins. Also de-burr any holes and remove any metal shards or remnants. Install grommets into all wire passage holes.
- If this manual states that this product may be mounted with suction cups, magnets, tape or Velcro®, clean the mounting surface with a 50/50 mix of isopropyl alcohol and water and dry thoroughly.
- Do not install this product or route any wires in the deployment area of your air bag. Equipment mounted or located in the air bag deployment area will damage or reduce the effectiveness of the air bag, or become a projectile that could cause serious personal injury or death. Refer to your vehicle owner's manual for the air bag deployment area. The User/Installer assumes full responsibility to determine proper mounting location, based on providing ultimate safety to all passengers inside the vehicle.
- For this product to operate at optimum efficiency, a good electrical connection to chassis ground must be made. The recommended procedure requires the product ground wire to be connected directly to the **NEGATIVE (-)** battery post.
- If this product uses a remote device to activate or control this product, make sure that this control is located in an area that allows both the vehicle and the control to be operated safely in any driving condition.
- Do not attempt to activate or control this device in a hazardous driving situation.
- This product contains either strobe light(s), halogen light(s), high-intensity LEDs or a combination of these lights. Do not stare directly into these lights. Momentary blindness and/or eye damage could result.
- Use only soap and water to clean the outer lens. Use of other chemicals could result in premature lens cracking (crazing) and discoloration. Lenses in this condition have significantly reduced effectiveness and should be replaced immediately. Inspect and operate this product regularly to confirm its proper operation and mounting condition. Do not use a pressure washer to clean this product.
- It is recommended that these instructions be stored in a safe place and referred to when performing maintenance and/or reinstallation of this product.
- **FAILURE TO FOLLOW THESE SAFETY PRECAUTIONS AND INSTRUCTIONS COULD RESULT IN DAMAGE TO THE PRODUCT OR VEHICLE AND/OR SERIOUS INJURY TO YOU AND YOUR PASSENGERS!**

**For warranty information regarding this product, visit [www.whelen.com/warranty](http://www.whelen.com/warranty)**

**Preparation:**

Remove the two Torx head screws that secure the end cap to the base and slide the lens sections and dividers off of the end of the base so that you may gain access to the lightbar base. (Fig. 2) Be sure to note the order in which the lenses were installed on the lightbar.

**IMPORTANT NOTE:** You will notice that the lenses are seated very tightly into the lens divider gaskets to prevent leaks. You will need to insert a screwdriver at each corner (between the black endcap and aluminum base) and gently pry the lens out to break it free from the dividers. Pry each side out just a little at a time, alternating from one side to the other until the lens slides out easily. Before reassembling, apply a very small amount of liquid dish detergent to the sides of the rubber gaskets to help them slide in easier and obtain a better seal.

**Installation: Cruise Light Option with Alley Lights:**

1. Following the diagram on the next page, install your cruise lights. Using the #6-32 whiz nut and #6-32 X 5/16" Phillips machine screw (supplied), attach the cruise light socket assembly to the alley light bracket as shown.
2. Repeat step 1 for the drivers side.

**Installation: Cruise Light Option without Alley Lights:**

1. Following the diagram on the next page, attach the cruise light assembly to the lightbar base using the # 8 X 3/8" Phillips hex head screw provided.

**Wiring:**

1. First secure the ground lugs for both cruise light assemblies to the channel in the base, using the 1/4" hex head screws as shown in the illustration.
2. Now plug the other wire coming from the light into the 3 connector extension provided.
3. Following the diagram, plug the middle plug of the 3 connector extension into any wire that is not being used on the lightbar wiring harness.

**NOTE:** The cable coming from the lightbar must be fused (see Fuse & Switch Information).

4. Then run the wire that comes out of that plug along the lightbar base and plug it into the drivers side harness.

**NOTE:** Neatly dress and place all wires under the cable clamps provided, to avoid interference with other lighting options.

**NOTE:** The outer surfaces of this product may be cleaned with mild soap and water. Use of any other chemicals may void product warranty. Do not use a pressure washer.

Fig. 1

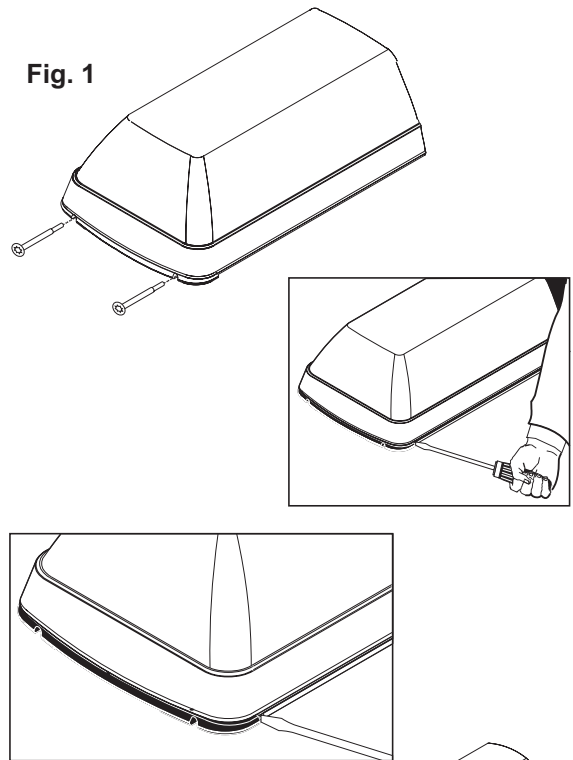
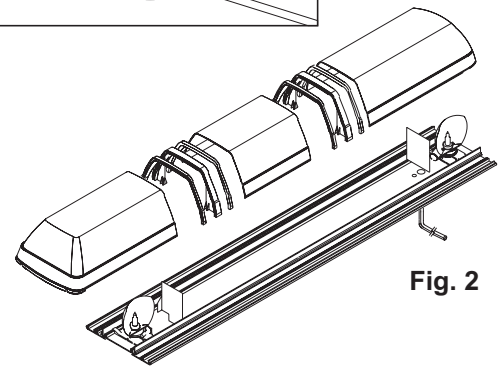
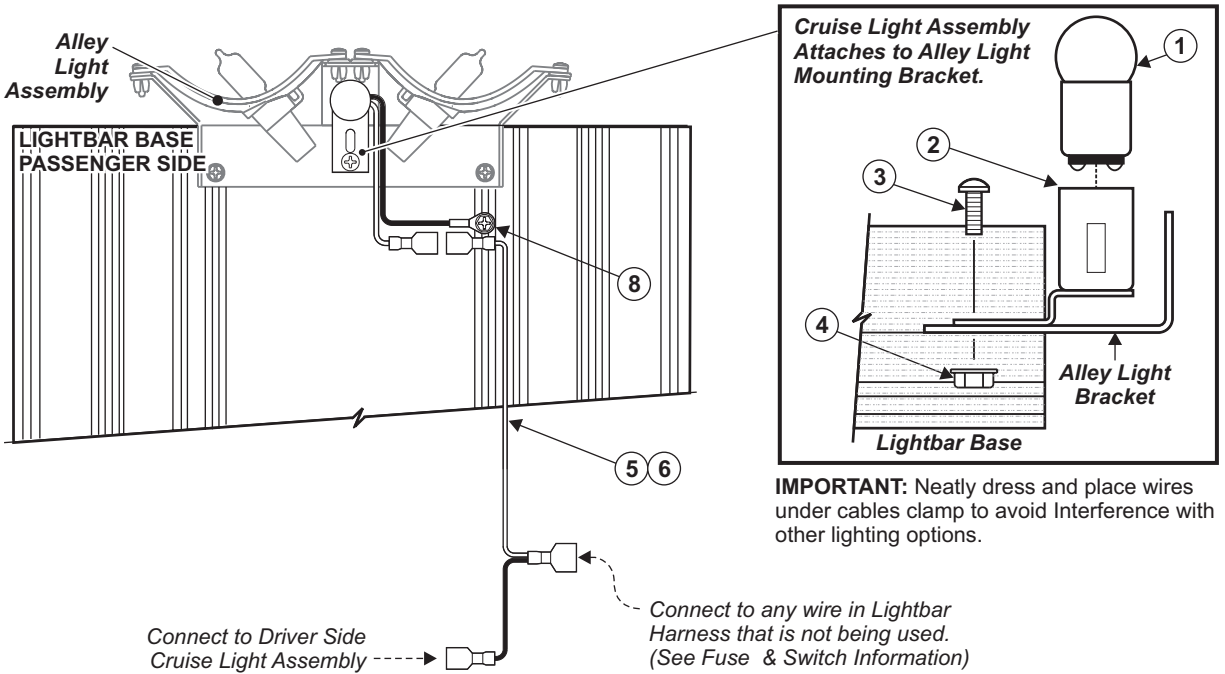

Fig. 2



QTY.	QTY.	ITEM	PART NUMBER	DESCRIPTION
	*		02-0362997-C1	ASS'Y. / CRUISE LIGHTS - CENTURION™(22", 48", 52")
*			02-0362997-C2	ASS'Y. / CRUISE LIGHTS - CENTURION™(60", 72")
2	2	1	34-0412050-40	68W CRUISE LIGHT
2	2	2	02-0342644-00	SOCKET ASSEMBLY / CRUISE LIGHT
2	2	3	14-062216-050	#6-32 x 5/16" PPHMS
2	2	4	13-062111-053	#6-32 WHIZ NUT
-	1	5	46-0763010-00	HARNESS / CRUISE LIGHTS - 22" /48" /52"
1	-	6	46-0763010-01	HARNESS / CRUSIE LIGHTS - 60"/72"
2	2	7	15-081916-066	SCREW / #8 x 3/8" PHEXWASHHD SS TYPE "B"
2	2	8	15-081916-046	SCREW / #8 x 1/4" PHEXWASHHD SS TYPE "B"

## CRUISE LIGHT OPTION WITH ALLEY LIGHT ASS'Y.



## CRUISE LIGHT OPTION WITHOUT ALLEY LIGHT ASS'Y.

