

# WHELEN<sup>®</sup>

ENGINEERING COMPANY INC.

51 Winthrop Road  
Chester, Connecticut 06412-0684  
Phone: (860) 526-9504  
Fax: (860) 526-4078  
Internet: [www.whelen.com](http://www.whelen.com)  
Sales e-mail: [autosale@whelen.com](mailto:autosale@whelen.com)  
Canadian Sales e-mail: [autocan@whelen.com](mailto:autocan@whelen.com)  
Customer Service e-mail: [custserv@whelen.com](mailto:custserv@whelen.com)

## Installation Guide: Centurion™ Lightbar Option Kit Model KDBTT (Brake/Tail/Turn)

### Safety First

This document provides all the necessary information to allow your Whelen product to be properly and safely installed. Before beginning the installation and/or operation of your new product, the installation technician and operator must read this manual completely. Important information is contained herein that could prevent serious injury or damage.

- Proper installation of this product requires the installer to have a good understanding of automotive electronics, systems and procedures.
- If mounting this product requires drilling holes, the installer **MUST** be sure that no vehicle components or other vital parts could be damaged by the drilling process. Check both sides of the mounting surface before drilling begins. Also de-burr any holes and remove any metal shards or remnants. Install grommets into all wire passage holes.
- If this manual states that this product may be mounted with suction cups, magnets, tape or Velcro®, clean the mounting surface with a 50/50 mix of isopropyl alcohol and water and dry thoroughly.
- Do not install this product or route any wires in the deployment area of your air bag. Equipment mounted or located in the air bag deployment area will damage or reduce the effectiveness of the air bag, or become a projectile that could cause serious personal injury or death. Refer to your vehicle owner's manual for the air bag deployment area. The User/Installer assumes full responsibility to determine proper mounting location, based on providing ultimate safety to all passengers inside the vehicle.
- For this product to operate at optimum efficiency, a good electrical connection to chassis ground must be made. The recommended procedure requires the product ground wire to be connected directly to the **NEGATIVE (-)** battery post.
- If this product uses a remote device to activate or control this product, make sure that this control is located in an area that allows both the vehicle and the control to be operated safely in any driving condition.
- Do not attempt to activate or control this device in a hazardous driving situation.
- This product contains either strobe light(s), halogen light(s), high-intensity LEDs or a combination of these lights. Do not stare directly into these lights. Momentary blindness and/or eye damage could result.
- Use only soap and water to clean the outer lens. Use of other chemicals could result in premature lens cracking (crazing) and discoloration. Lenses in this condition have significantly reduced effectiveness and should be replaced immediately. Inspect and operate this product regularly to confirm its proper operation and mounting condition. Do not use a pressure washer to clean this product.
- It is recommended that these instructions be stored in a safe place and referred to when performing maintenance and/or reinstallation of this product.
- **FAILURE TO FOLLOW THESE SAFETY PRECAUTIONS AND INSTRUCTIONS COULD RESULT IN DAMAGE TO THE PRODUCT OR VEHICLE AND/OR SERIOUS INJURY TO YOU AND YOUR PASSENGERS!**

**For warranty information regarding this product, visit [www.whelen.com/warranty](http://www.whelen.com/warranty)**

## Installation:

1. Remove the two Torx head screws that secure the end cap to the base and slide the lens sections and dividers off of the end of the base so that you may gain access to the lightbar base (see figures 1 and 2).

**IMPORTANT NOTE:** You will notice that the lenses are seated very tightly into the lens divider gaskets to prevent leaks. You will need to insert a screwdriver at each corner (between the black endcap and aluminum base) and gently pry the lens out to break it free from the dividers. Pry each side out just a little at a time, alternating from one side to the other until the lens slides out easily. Before reassembling, apply a very small amount of liquid dish detergent to the sides of the rubber gaskets to help them slide in easier and obtain a better seal.

2. Place the Brake-Tail-Turn assembly on the lightbar base as shown in figure 4. There is a lip running the length of the assembly that you must insert into the slot running the length of the base. Be sure to follow all measurements and instructions carefully. Secure the assembly to the channel in the lightbar base using two of the 3/8" hex head screws provided. Repeat this step for the other side of the lightbar.

## Wiring:

1. Secure the ground lug for the Brake-Tail-Turn assemblies to the channel in the lightbar base as shown, using the 1/4" hex head screws provided (fig. 4).
2. Using the connectors provided Connect the BLACK output wire from the driver's side Brake-Tail-Turn assembly to the YELLOW wire in the lightbar wiring harness (or any unused wire) and the BLACK output wire from the passenger side assembly to the GREEN wire in the lightbar wiring harness (or any unused wire).
3. Using the BROWN double connector provided, plug the two RED wires from the Brake-Tail-Turn assemblies into the two plugs in the double connector as shown. Then plug the single plug at the other end of the connector into the BROWN wire (or any unused wire) in the lightbar wiring harness.
4. Neatly dress and place any loose wires under the cable clamps to avoid interference with any moving parts.
5. Replace and secure domes.

**NOTE:** If you wish to run two 22" bars as used for tow trucks, make sure you use the wiring diagram for 22 inch bars. (fig. 5)

The outer surfaces of this product may be cleaned with mild soap and water. Use of any other chemicals may void product warranty. Do not use a pressure washer.

Fig. 1

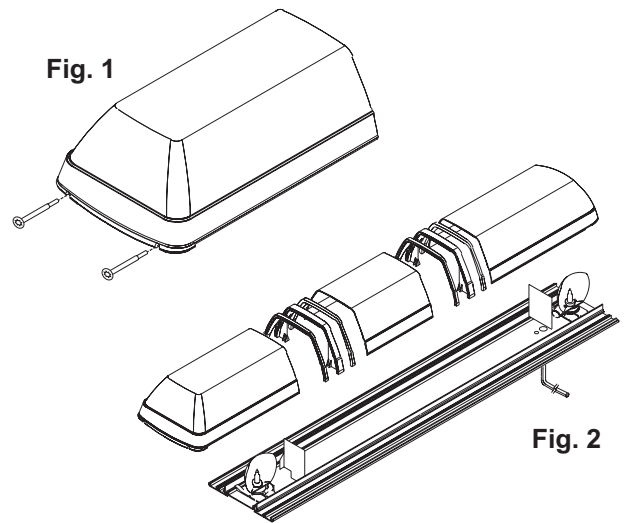

Fig. 2

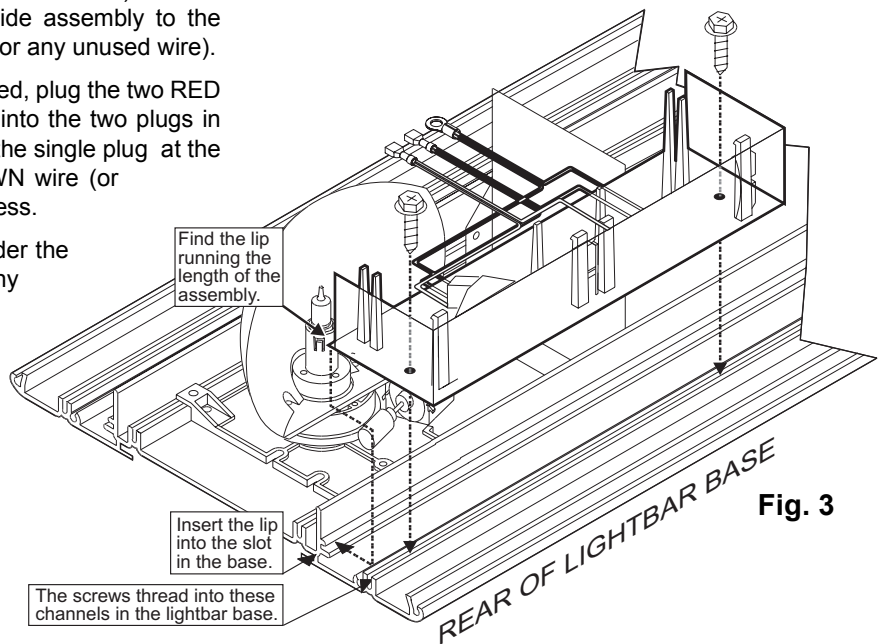
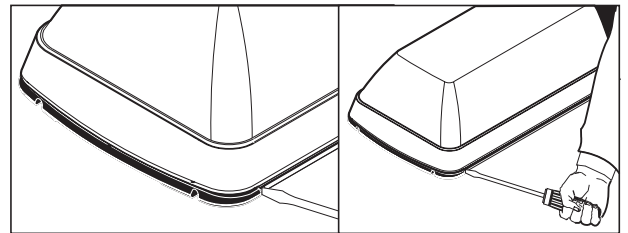
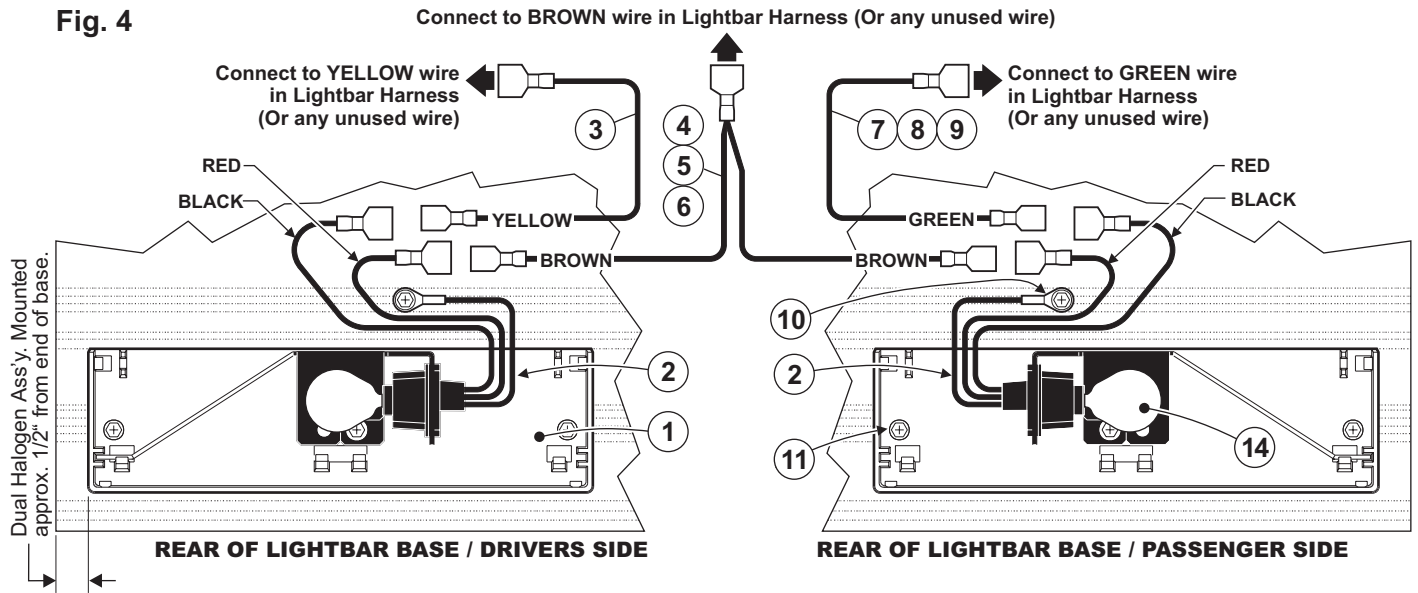
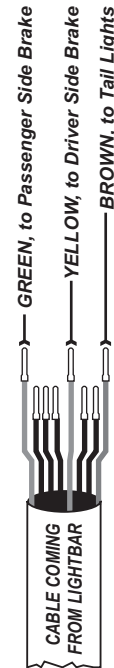

Fig. 3

**Fig. 4**



QTY.	QTY.	QTY.	QTY.	ITEM	PART NUMBER	DESCRIPTION
			*		02-0363008-R0	ASSEMBLY / BRAKE/TAIL LIGHTS CENTURION - 22"
		*			02-0363008-R1	ASSEMBLY / BRAKE / TAIL LIGHTS CENTURION - 48" & 52"
	*				02-0363008-R2	ASSEMBLY / BRAKE / TAIL LIGHTS CENTURION - 60"
*					02-0363008-R3	ASSEMBLY / BRAKE / TAIL LIGHTS CENTURION - 72"
2	2	2	1	1	68-3182929-50	FILTER BRACKET / RED
2	2	2	1	2	02-0363014-00	ASSY / REFLECTOR BRAKE / TAIL / TURN
1	1	1	1	3	67-1F91844110	WIRE / 18 AWG YELLOW W / FASTONS - 11" / DRIVER BRAKE
-	-	1	-	4	46-0742645-00	HARNESS ASSEMBLY / BROWN / TAIL LIGHT / 48" & 52" BAR
-	1	-	-	5	46-0742645-01	HARNESS ASSEMBLY / BROWN / TAIL LIGHT / 60" BAR
1	-	-	-	6	46-0742645-02	HARNESS ASSEMBLY / BROWN TAIL LIGHT / 72" BAR
-	-	1	-	7	67-1F91855360	WIRE / 18 AWG GREEN W/ FASTONS - 36" / PASS. BRAKE
-	1	-	-	8	67-1F91855440	WIRE / 18 AWG GREEN W/ FASTONS - 44" / PASS. BRAKE
1	-	-	-	9	67-1F91855560	WIRE / 18 AWG GREEN W/ FASTONS - 56" / PASS. BRAKE
2	2	2	1	10	15-081916-046	SCREW / #8 x 1/4" PHEXWASHHD SS TYPE "B"
6	6	6	3	11	15-081916-066	SCREW / #8 x 3/8" PHEXWASHHD SS TYPE "B"
-	-	-	1	12	67-1F91811110	WIRE / 18 AWG BROWN W/ FASTONS - 11" / TAIL LIGHT
-	-	-	1	13	67-1F91855110	WIRE / 18 AWG GREEN W/ FASTONS - 11" / PASS. BRAKE
-	-	-	-	14	01-0462389-00C	KIT / STOPSN12 REPLACEMENT



**Fig. 5 22" LIGHTBARS ONLY**

