

Route 145, Winthrop Road  
Chester, CT 06412-0684  
TELEPHONE: (860) 526-9504  
TOLL FREE: 1-800-637-4736  
FACSIMILE: (860) 526-4784

## ISHL SERIES STROBE BEACONS

ISHL120, 120 VOLTS AC

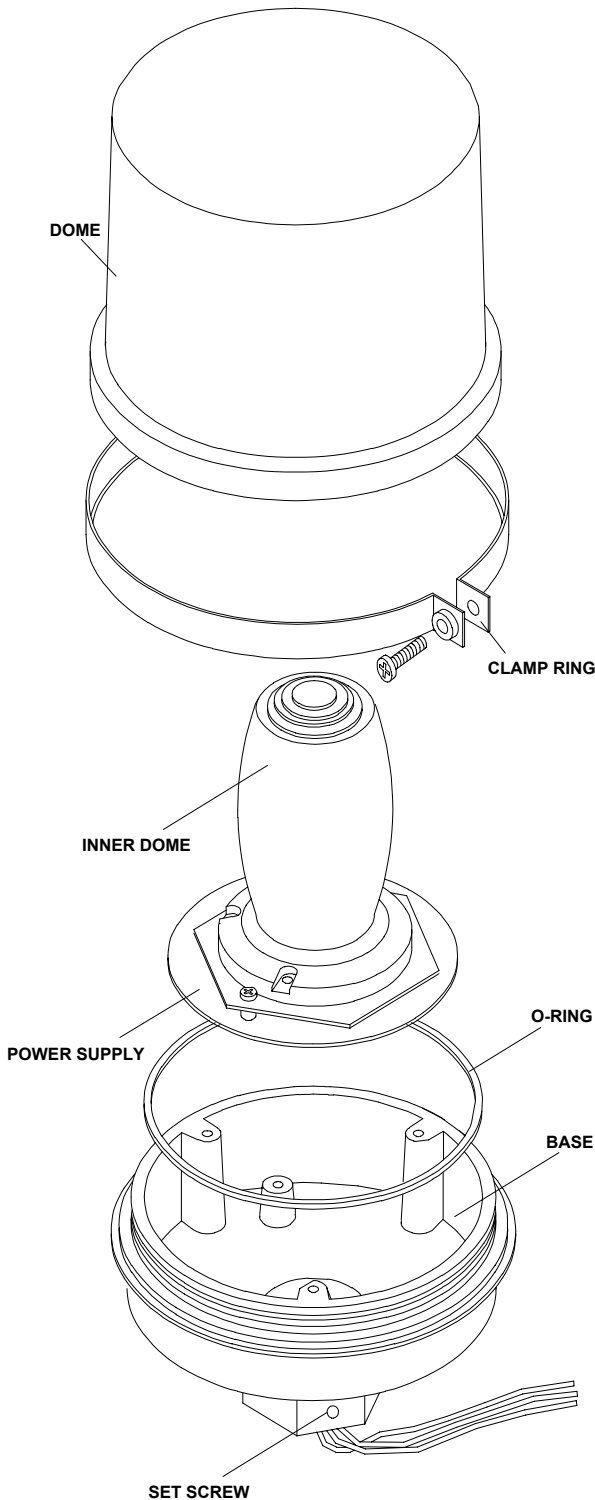

SEE OTHER SIDE OF PAGE FOR  
REPLACEMENT PARTS LISTING.

USE TEFLON GREASE ON THE  
"O" RING, MAKING SURE GREASE IS  
APPLIED THOROUGHLY AROUND "O" RING.  
INSTALL "O" RING INTO GROOVE OF  
CASTING.

**WARNING...** DISCONNECT THE  
POWER SOURCE BEFORE  
INSTALLING OR SERVICING  
THE BEACON.

## REPLACEMENT PARTS LIST FOR ISHL SERIES BEACONS

DESCRIPTION	QTY.	PART NUMBER	ISHL120
STROBE TUBE ASSEMBLY	1	01-0661454-C0	■
POWER SUPPLY, ISHL	1	02-0168618-00	■
DOME, AMBER	1	68-4180190-10	■
DOME, BLUE	1	68-4180190-20	■
DOME, CLEAR	1	68-4180190-30	■
DOME, GREEN	1	68-4180190-40	■
DOME, RED	1	68-4180190-50	■

### MOUNTING & WIRING INSTRUCTIONS

The ISHL Series of Strobe Beacons are designed for mounting to a pendant with a 3/4" NPT thread.

1. Feed the power source cable through the pipe.
2. Connect the power cable as described below.

#### MODEL ISHL120

1. Connect the GREEN wire to the AC service green wire (ground).
  2. Connect the BLACK wire to the AC service black wire (hot).
  3. Connect the WHITE wire to the AC service white wire (neutral).
3. Mount the Beacon to the pipe threads. Make sure that the power wires are not pinched or severely twisted. Tighten the Set Screw.

### INTERNAL CONTROL RELAY (ICR), WIRING INSTRUCTIONS

The ISHL Series of Strobe Beacons feature an Internal Control Relay for low power (< 1mA) on/off control. A contact closure or switch may be connected to the ORANGE and GRAY ICR control lines.

The control lines are connected, at the factory, with a butt terminal. If the ICR feature is not used, ignore this section.

To use this feature:

1. Feed the control cable through the pipe.
2. Cut the butt terminal off of the ORANGE and GRAY control lines.
3. Connect the control cable to the ORANGE and GRAY wires. Polarity does not matter for a closure.

### STROBE TUBE ASSEMBLY REPLACEMENT

1. Disconnect power. Wait 10 minutes for the power supply to discharge.
2. Remove the Clamp Ring. Remove the Dome from the Base.

**Note:** There is **teflon grease** on the O-ring. Do not wipe it off.

3. Remove three #6 Phillips head screws holding the Strobe Tube Assembly to the Power Supply. Pull the Strobe Tube Assembly out of its socket. Re-assemble the beacon. The angled lip of the Clamp Ring mounts on the Dome side. The flatter lip mounts toward the Base.

### POWER SUPPLY REPLACEMENT

1. Disconnect power. Wait 10 minutes for the power supply to discharge.
  2. Remove the Clamp Ring. Remove the Dome from the Base.
- Note:** There is **teflon grease** on the O-ring. Do not wipe it off.
3. Remove the Strobe Tube Assembly and the aluminum plate by removing two #6-32 screws.
  4. Remove (3) #6-32 screws holding the Power Supply board to the Base. Disconnect the two position plug. Disconnect the ICR wires, if used. Replace the Power Supply.
  5. Re-assemble the unit. The angled lip of the Clamp Ring mounts on the Dome side. The flatter lip mounts toward the Base.