

WHELEN[®]

ENGINEERING COMPANY INC.

Route 145, Winthrop Road,
Chester, Connecticut 06412

Phone: (860) 526-9504

Fax: (860) 526-4078

Internet: www.whelen.com

Sales e-mail: autosale@whelen.com

Canadian Sales e-mail: autocan@whelen.com

Customer Service e-mail: custserv@whelen.com

Installation Guide for 64 Series LED Lighthoods

Safety First

This document provides all the necessary information to allow your Whelen product to be properly and safely installed. Before beginning the installation and/or operation of your new product, the installation technician and operator must read this manual completely. Important information is contained herein that could prevent serious injury or damage.

- **Proper installation of this product requires the installer to have a good understanding of automotive electronics, systems and procedures.**
- **If mounting this product requires drilling holes, the installer MUST be sure that no vehicle components or other vital parts could be damaged by the drilling process. Check both sides of the mounting surface before drilling begins. Also de-burr any holes and remove any metal shards or remnants. Install grommets into all wire passage holes.**
- **If this product is mounted with tape or Velcro™, clean the mounting surface with a 50/50 mix of isopropyl alcohol and water and dry thoroughly.**
- **Do not install this product or route any wires in the deployment area of your air bag. Equipment mounted or located in the air bag deployment area will damage or reduce the effectiveness of the air bag, or become a projectile that could cause serious personal injury or death. Refer to your vehicle owners manual for the air bag deployment area. The User/Installer assumes full responsibility to determine proper mounting location, based on providing ultimate safety to all passengers inside the vehicle.**
- **For this product to operate at optimum efficiency, a good electrical connection to chassis ground must be made. The recommended procedure requires the product ground wire to be connected directly to the NEGATIVE (-) battery post.**
- **If this product uses a remote device to activate or control this product, make sure that this control is located in an area that allows both the vehicle and the control to be operated safely in any driving condition.**
- **Do not attempt to activate or control this device in a hazardous driving situation.**
- **This product contains either strobe light(s), halogen light(s), high-intensity LEDs or a combination of these lights. Do not stare directly into these lights. Momentary blindness and/or eye damage could result.**
- **Use only soap and water to clean the outer lens. Use of other chemicals could result in premature lens cracking (crazing) and discoloration. Lenses in this condition have significantly reduced effectiveness and should be replaced immediately. Inspect and operate this product regularly to confirm its proper operation and mounting condition. Do not use a pressure washer to clean this product.**
- **It is recommended that these instructions be stored in a safe place and referred to when performing maintenance and/or reinstallation of this product.**
- **FAILURE TO FOLLOW THESE SAFETY PRECAUTIONS AND INSTRUCTIONS COULD RESULT IN DAMAGE TO THE PRODUCT OR VEHICLE AND/OR SERIOUS INJURY TO YOU AND YOUR PASSENGERS!**

Installation:

1. Using the dimensions from the template, mark off and drill the two 5/16 inch diameter vent tube holes and the 1 inch center wire hole into the mounting surface. Make sure lighthouse will not interfere with existing equipment and be aware of any items on the opposite side of the mounting surface.
2. Insert the two vent tubes extending from the rear of the lighthouse into their holes. Using a scribe or similar tool, mark off the 4 mounting holes.
3. Using a drill bit sized for a #6 sheet metal screw (and the thickness of the mounting surface), drill the four mounting holes. Install a grommet (customer supplied) into the 1 inch wire hole.
4. Using appropriately sized wires (Minimum wire size / 18 AWG), run the lighthouse wires to their connections. (See the color / function table for the lighthouse being installed) Fuse the +12VDC connections at 3 Amps and test the operation of the lighthouse before securing it to the vehicle.
5. Position the lighthouse components onto the mounting surface and secure to the vehicle using four #6 x 1-1/2" sheet metal screws.

Note: This product draws significantly less current than a standard incandescent automotive bulb. If your flasher does not operate properly, it may be necessary to replace your existing flasher module with a Whelen 3TERM flasher module. Contact your sales representative for specific vehicle application.

WARNING! The outer surfaces of this product may be cleaned with mild soap and water. Use of any other chemicals may void product warranty. Do not use a pressure washer.

Specifications:

BRAKE / TAIL / TURN (max)

LED Assembly - 360 LED's
Input Voltage - 12.8 VDC $\pm 20\%$
Input Current - Tail - 0.095 AMPS
Brake - 0.72 AMPS

Default Flash Pattern - Signal Alert™ Brake

BRAKE / TAIL / TURN (min)

LED Assembly / 96 LED's
Input Voltage - 12.8 VDC $\pm 20\%$
Input Current - Tail - 0.054 AMPS
Brake - 0.34 AMPS

Default Flash Pattern - Signal Alert™ Brake

E-SPEC

Input Voltage - 12.8 VDC $\pm 20\%$
Input Current - 0.68 AMPS
Default Pattern - Signal Alert™

ARROW

Input Voltage - 12.8 VDC $\pm 20\%$
Input Current - 0.35 AMPS

Default Flash Pattern - Sequence™ Arrow 150

FLASHER

Input Voltage - 12.8 VDC $\pm 20\%$
Input Current - 0.700 AMPS
Default Pattern - Signal Alert™

BACK-UP / FLOOD

Input Voltage - 12.8 VDC $\pm 20\%$
Input Current - Flood 0.475 AMPS
Back-Up 0.225

Default Pattern - Steady™

Pattern Selection Procedure:

IMPORTANT: Pattern selection requires the L.E.D. to be turned on.
DO NOT LOOK DIRECTLY AT L.E.D.s WHILE UNIT IS IN OPERATION.

NOTE: Although the location of the pins varies for each LED board, this procedure is applicable to all LED boards that offer selectable patterns. The location of these pins will vary between models, but they will always be on the LED side of the circuit board. Electrical components will not be visible on encapsulated LED boards.

1. Remove the lens and Locate the Pattern Activation Pins for your model L.E.D. (Section of typical L.E.D. board below shows pins.)

2. Turn the L.E.D. flasher on.

3A. TO CYCLE FORWARD THROUGH ALL PATTERNS:

Use a penny (or any electrical conducting item) to contact both Pattern Activation Pins for less than 1 second and release. Repeat for next pattern.

3B. TO CHOOSE A PATTERN:

While cycling through the patterns, allow a pattern to run for more than 5 seconds, this will become the default pattern until it is changed

3C. TO CYCLE BACKWARDS THROUGH ALL PATTERNS:

Hold penny against Activation Pins for more than 1 second and release.

4. When you've chosen a pattern, turn off power and re-mount lens.

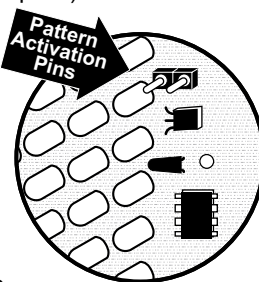

Available Flash Patterns:

RAPIDFIRE™ 375 - 375 Single Flashes Per Minute

RAPIDFIRE™ 150 - 150 Single Flashes Per Minute

RAPIDFIRE™ 75 - 75 Single Flashes Per Minute

RAPIDFIRE™ 30 - 30 Single Flashes Per Minute

DOUBLE FLASH 150 - 150 Double Flashes Per Minute

DOUBLE FLASH 75 - 75 Double Flashes Per Minute

COMET FLASH® - 75 Comet Flashes Per Minute

ACTION FLASH™ - 2 Comet Flash / 4 X 150 SFP / 2 Comet

MODU FLASH™ - 75 to 360 Single Flashes Per Minute

SIGNAL ALERT™ 150 - 150 Flashes Per Minute

SIGNAL ALERT™ 75 - 75 Flashes Per Minute

SCAN - 2 Cycles of Patterns 3 thru 12

SIGNAL ALERT™ BRAKE - 4 Flashes Cycle For 200 MS
Followed by Steady Burn

STANDARD BRAKE - Steady Burn

ARROW L.E.D. ONLY:

SIGNAL ALERT™ ARROW 375 - 375 Flashes Per Minute

SIGNAL ALERT™ ARROW 150 - 150 Flashes Per Minute

SEQUENCE ARROW 150 - 150 Flashes Per Minute

SEQUENCE ARROW 60 - 60 Flashes Per Minute

ORDERING:

EXAMPLE OF PART NUMBER:

01-0683476-5RR



STYLE

- 1 = E-SPEC WARNING
- 2 = BRAKE-TAIL-TURN / MIN
- 3 = ARROW
- 4 = TURN
- 5 = FLASHER
- 6 = FLOOD
- 7 = BACK-UP
- B = BRAKE-TAIL-TURN / MAX

COLOR OF L.E.D.

- A = AMBER
- B = BLUE
- G = GREEN
- R = RED
- W = WHITE

LENS COLOR

- A = AMBER
- B = BLUE
- C = CLEAR
- G = GREEN
- R = RED
- 5 = E-SPEC RED

BRAKE / TAIL / TURN

Wire Color	Function
Yellow	Stop, Turn / + 12 VDC
Brown	Taillight / +12 VDC
White	To Chassis Ground

ARROW / E-SPEC / FLASHER

Wire Color	Function
Colored	+12 VDC Wire color will be whatever the color of its LED is. (When light is switched on.)
Black	Ground

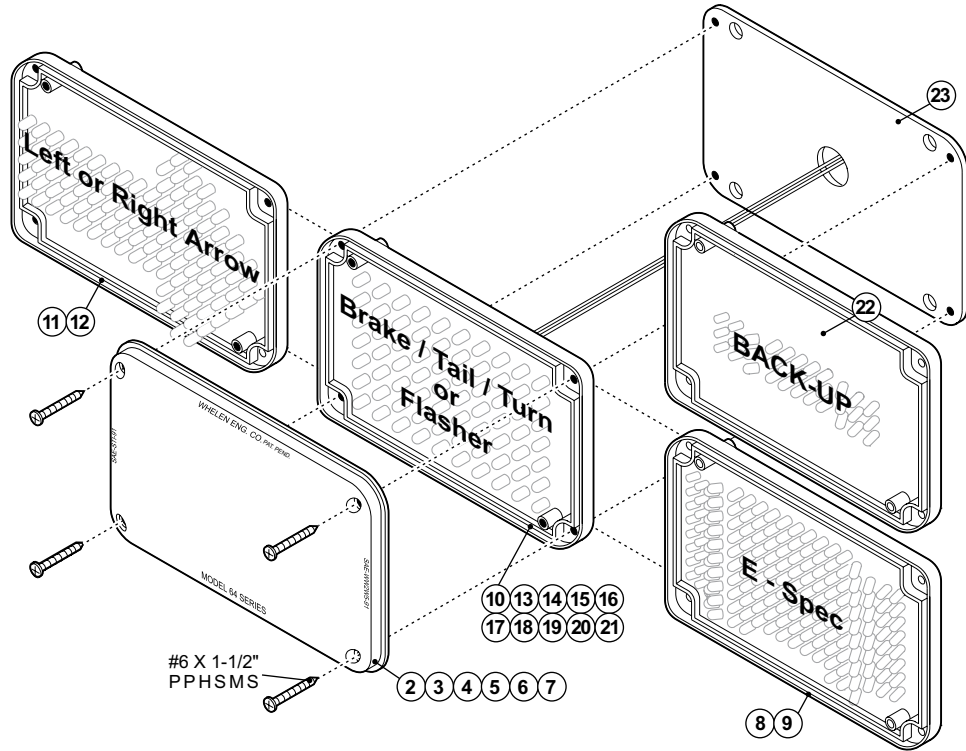

QTY.	QTY.	QTY.	QTY.	QTY.	QTY.	QTY.	QTY.	QTY.	QTY.	QTY.	QTY.	QTY.	QTY.	QTY.	ITEM	PART NUMBER	DESCRIPTION
														*		01-06834761AA	ASSEMBLY / LIGHTHEAD FLUSH MT 64 LED E-SPEC / AMBER
														*		01-068347615R	ASSEMBLY / LIGHTHEAD FLUSH MT 64 LED E-SPEC / RED
														*		01-06834762RR	ASSEMBLY / LIGHTHEAD FLUSH MT 64 LED BRAKE-TAIL-TURN / MIN
														*		01-06834763AA	ASSEMBLY / LIGHTHEAD FLUSH MT 64 LED ARROW / AMBER
														*		01-06834763RR	ASSEMBLY / LIGHTHEAD FLUSH MT 64 LED ARROW / RED
														*		01-06834764AA	ASSEMBLY / LIGHTHEAD FLUSH MT 64 LED TURN / AMBER
														*		01-06834765AA	ASSEMBLY / LIGHTHEAD FLUSH MT 64 LED FLASHER / AMBER
														*		01-06834765BB	ASSEMBLY / LIGHTHEAD FLUSH MT 64 LED FLASHER / BLUE
														*		01-06834765GG	ASSEMBLY / LIGHTHEAD FLUSH MT 64 LED FLASHER / GREEN
														*		01-06834765RR	ASSEMBLY / LIGHTHEAD FLUSH MT 64 LED FLASHER / RED
														*		01-0683476BRR	ASSEMBLY / LIGHTHEAD FLUSH MT 64 LED BRAKE-TAIL-TURN / MAX
														*		01-06834765CW	ASSEMBLY / LIGHTHEAD FLUSH MT 64 LED FLASHER - WHITE
														*		01-06834764RR	ASSEMBLY / LIGHTHEAD FLUSH MT 64 LED TURN - RED
														*		01-06834766CW	ASSEMBLY / LIGHTHEAD FLUSH MT 64 LED FLOOD - WHITE
*																01-06834767CW	ASSEMBLY / LIGHTHEAD FLUSH MT 64 LED BACK-UP - WHITE
4	4	4	4	4	4	4	4	4	4	4	4	4	4	4	1	15-061416-240	#6 X 1-1/2" PHILLIPS PAN HEAD SHEET METAL SCREW
-	-	-	-	-	-	-	-	-	1	1	-	-	-	1	2	68-1182117-11	LENS / MODEL 64 LINEAR - AMBER W/ LIP
-	-	-	-	-	-	-	-	-	1	-	-	-	-	-	3	68-1182117-21	LENS / MODEL 64 LINEAR - BLUE W/ LIP
1	1	-	1	-	-	-	-	-	-	-	-	-	-	-	4	68-1182117-31	LENS / MODEL 64 LINEAR - CLEAR W/ LIP
-	-	-	-	-	-	-	1	-	-	-	-	-	-	-	5	68-1182117-41	LENS / MODEL 64 LINEAR - GREEN W/ LIP
-	-	1	-	1	1	-	-	-	-	-	1	-	1	-	6	68-1182117-51	LENS / MODEL 64 LINEAR - RED W/ LIP
-	-	-	-	-	-	-	-	-	-	-	-	-	1	-	7	68-1182117E51	LENS / MODEL 64 LINEAR - E-SPEC RED W/ LIP
-	-	-	-	-	-	-	-	-	-	-	-	-	-	1	8	01-0283441-A0	SUB ASSEMBLY / 64 LED E-SPEC AMBER
-	-	-	-	-	-	-	-	-	-	-	-	-	1	-	9	01-0283441-R0	SUB ASSEMBLY / 64 LED E-SPEC RED
-	-	-	-	-	-	-	-	-	-	-	-	-	1	-	10	01-0283460-52	SUB ASSEMBLY / 64 LED BRAKE-TAIL-TURN / MIN
-	-	-	-	-	-	-	-	-	-	-	-	1	-	-	11	01-0283460-13	SUB ASSEMBLY / 64 LED ARROW - AMBER
-	-	-	-	-	-	-	-	-	-	1	-	-	-	-	12	01-0283460-53	SUB ASSEMBLY / 64 LED ARROW - RED
-	-	-	-	-	-	-	-	-	-	1	-	-	-	-	13	01-0283460-15	SUB ASSEMBLY / 64 LED FLASHER - AMBER
-	-	-	-	-	-	-	-	-	-	1	-	-	-	-	14	01-0283460-25	SUB ASSEMBLY / 64 LED FLASHER - BLUE
-	-	-	-	-	-	-	-	-	-	1	-	-	-	-	15	01-0283460-45	SUB ASSEMBLY / 64 LED FLASHER - GREEN
-	-	-	-	-	-	-	-	-	-	1	-	-	-	-	16	01-0283460-55	SUB ASSEMBLY / 64 LED FLASHER - RED
-	-	-	-	-	-	-	-	-	-	1	-	-	-	-	17	01-0283460-5B	SUB ASSEMBLY / 64 LED BRAKE-TAIL-TURN / MAX
-	-	-	1	-	-	-	-	-	-	-	-	-	-	-	18	01-0283460-35	SUB ASSEMBLY / 64 LED FLASHER - WHITE
-	-	-	-	-	-	-	-	-	-	1	-	-	-	-	19	01-0283460-14	SUB ASSEMBLY / 64 LED TURN - AMBER
-	-	1	-	-	-	-	-	-	-	-	-	-	-	-	20	01-0283460-54	SUB ASSEMBLY / 64 LED TURN - RED
-	1	-	-	-	-	-	-	-	-	1	-	-	-	-	21	01-0283460-36	SUB ASSEMBLY / 64 LED FLOOD - WHITE
1	-	-	-	-	-	-	-	-	-	-	-	-	-	-	22	01-0268971-03	SUB ASSEMBLY / 64 LED BACK-UP - WHITE
1	1	1	1	1	1	1	1	1	1	1	1	1	1	1	23	38-0242627-00	GASKET

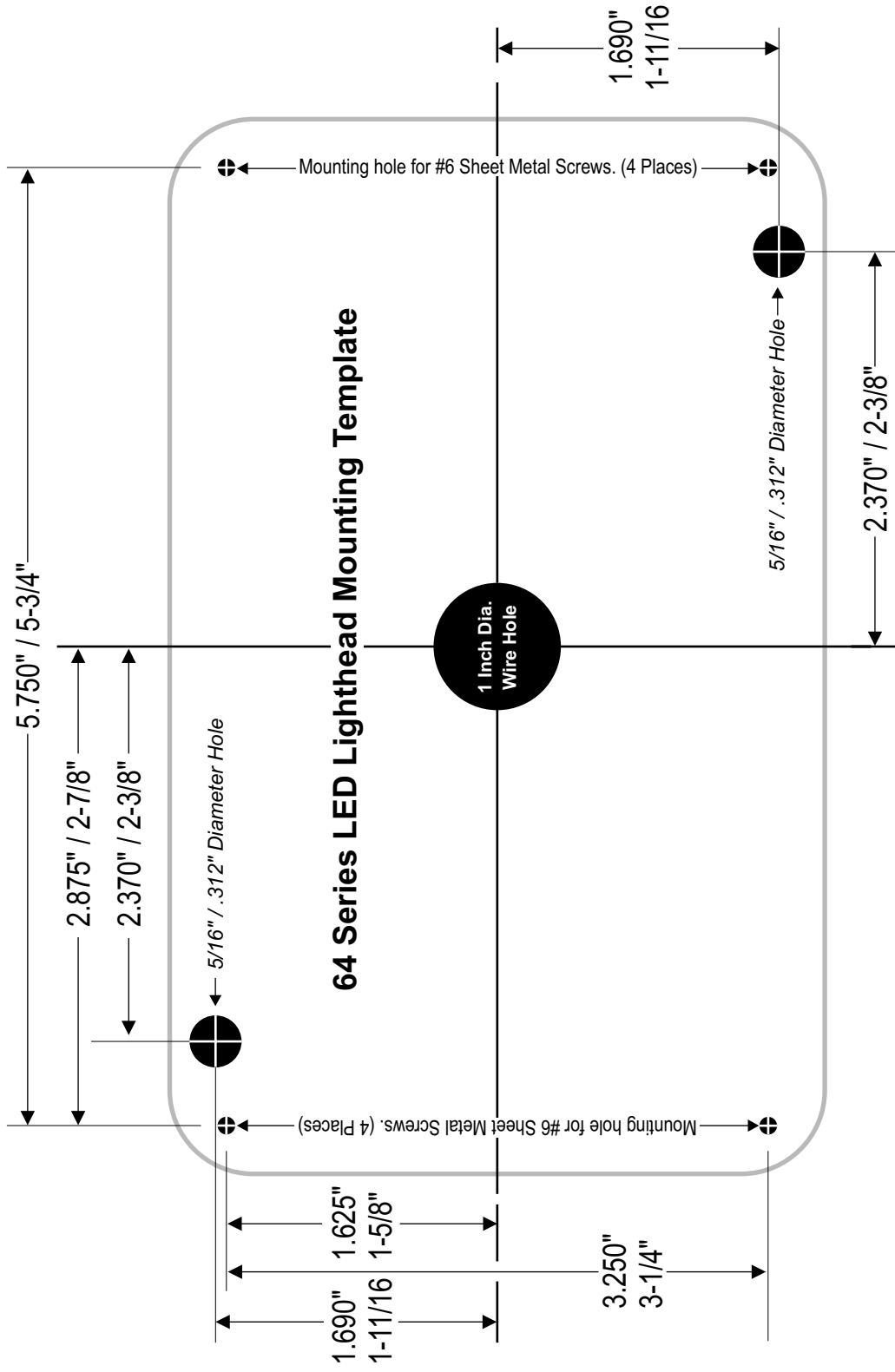

64 Series LED Lighthouse Mounting Template

IMPORTANT: Templates may not be exactly to scale. Always check all measurements before drilling. Measurements are given in both Decimals and Fractions for convenience. For a more accurate measurement and installation, we recommend you use the Decimals.