

WHELEN[®]

ENGINEERING COMPANY INC.

51 Winthrop Road
Chester, Connecticut 06412-0684
Phone: (860) 526-9504
Fax: (860) 526-4078
Internet: www.whelen.com
Sales e-mail: autosale@whelen.com
Canadian Sales e-mail: autocan@whelen.com
Customer Service e-mail: custserv@whelen.com

Conversion Guide: Edge[®] Multi-Reflector to Micro-R Corner Strobe Modules

Safety First

This document provides all the necessary information to allow your Whelen product to be properly and safely installed. Before beginning the installation and/or operation of your new product, the installation technician and operator must read this manual completely. Important information is contained herein that could prevent serious injury or damage.

- Proper installation of this product requires the installer to have a good understanding of automotive electronics, systems and procedures.
- If mounting this product requires drilling holes, the installer **MUST** be sure that no vehicle components or other vital parts could be damaged by the drilling process. Check both sides of the mounting surface before drilling begins. Also de-burr any holes and remove any metal shards or remnants. Install grommets into all wire passage holes.
- If this manual states that this product may be mounted with suction cups, magnets, tape or Velcro[®], clean the mounting surface with a 50/50 mix of isopropyl alcohol and water and dry thoroughly.
- Do not install this product or route any wires in the deployment area of your air bag. Equipment mounted or located in the air bag deployment area will damage or reduce the effectiveness of the air bag, or become a projectile that could cause serious personal injury or death. Refer to your vehicle owner's manual for the air bag deployment area. The User/Installer assumes full responsibility to determine proper mounting location, based on providing ultimate safety to all passengers inside the vehicle.
- For this product to operate at optimum efficiency, a good electrical connection to chassis ground must be made. The recommended procedure requires the product ground wire to be connected directly to the **NEGATIVE (-)** battery post.
- If this product uses a remote device to activate or control this product, make sure that this control is located in an area that allows both the vehicle and the control to be operated safely in any driving condition.
- Do not attempt to activate or control this device in a hazardous driving situation.
- This product contains either strobe light(s), halogen light(s), high-intensity LEDs or a combination of these lights. Do not stare directly into these lights. Momentary blindness and/or eye damage could result.
- Use only soap and water to clean the outer lens. Use of other chemicals could result in premature lens cracking (crazing) and discoloration. Lenses in this condition have significantly reduced effectiveness and should be replaced immediately. Inspect and operate this product regularly to confirm its proper operation and mounting condition. Do not use a pressure washer to clean this product.
- It is recommended that these instructions be stored in a safe place and referred to when performing maintenance and/or reinstallation of this product.
- **FAILURE TO FOLLOW THESE SAFETY PRECAUTIONS AND INSTRUCTIONS COULD RESULT IN DAMAGE TO THE PRODUCT OR VEHICLE AND/OR SERIOUS INJURY TO YOU AND YOUR PASSENGERS!**

For warranty information regarding this product, visit www.whelen.com/warranty

Note: The Micro-R / Corner Strobe modules are a replacement for the discontinued Edge® Multi-Reflector assembly.

Installation:

IMPORTANT! DO NOT BEGIN ANY DISASSEMBLY UNTIL THE LIGHTBAR HAS BEEN TURNED OFF FOR A MINIMUM OF 15 MINUTES!

1. Remove the endcap and lenses to gain access to the existing multi-reflector assembly.
2. Remove the 4 (four) screws that secure the multi-reflector to the lightbar.
3. Pull the multi-reflector away from the lightbar. Do not disconnect any wires!
4. Note the location of the twist-in lamp assemblies present in the multi-reflector and which assemblies are connected to which harness plugs. It is critical that the position and connections of these lamp assemblies are maintained with the new reflectors.
5. Disconnect the connectors and remove the multi-reflector from the lightbar. Remove the twist-in lamp assemblies from the multi-reflector. Make sure to record where each lamp assembly was positioned.
6. Remove any and all twist-in lamp assemblies (strobe and/or halogen) from the multi-reflector.
7. Secure the light head bracket to the corner strobe assembly as shown.

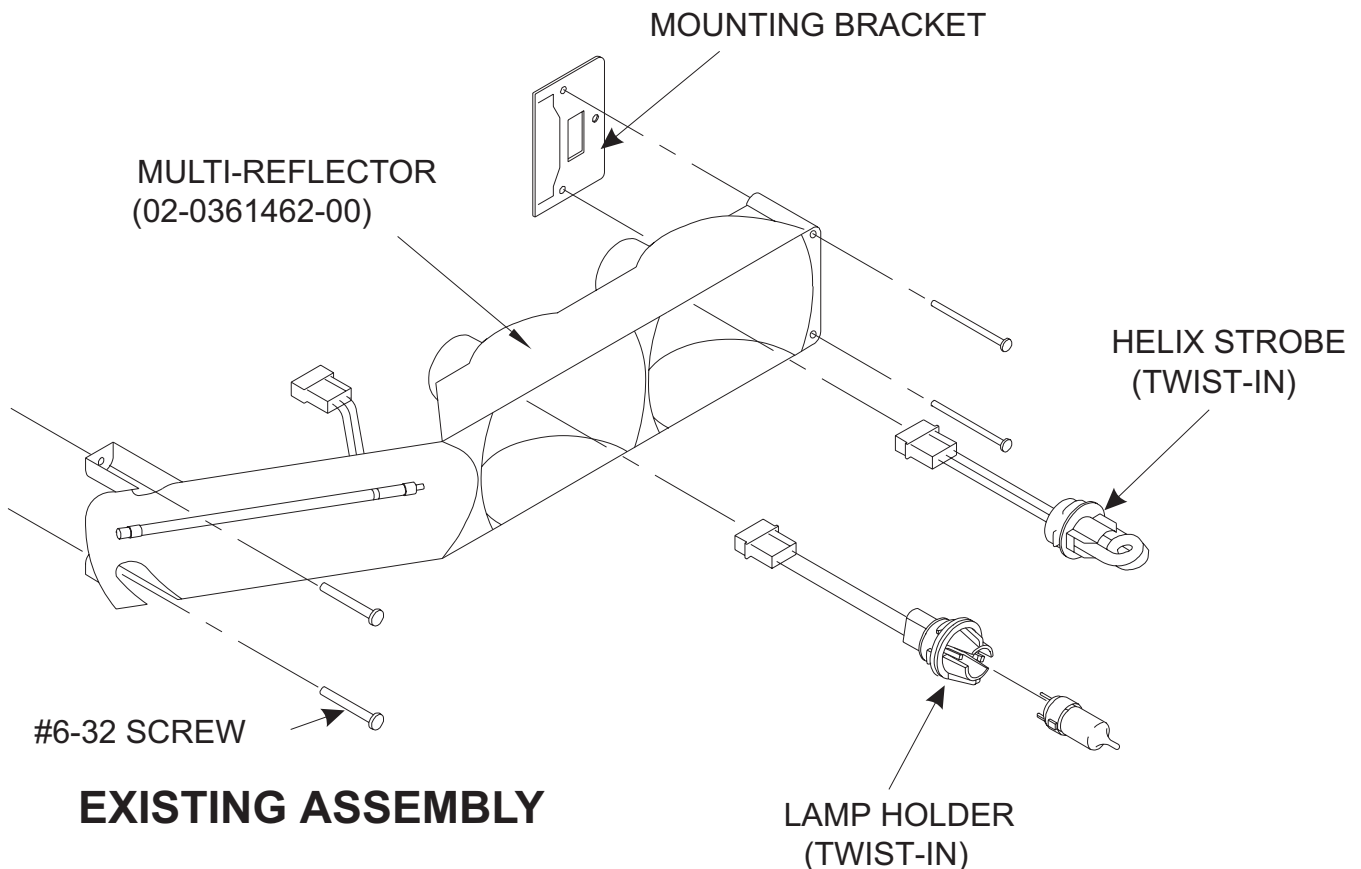

8. Slide both of the new Micro-R reflectors into the lightbar, making sure to separate them with the .375" spacer (#6) as shown.
9. Slide the corner strobe assembly into the lightbar until its mounting holes line up with the holes in the extrusion.
10. Secure the corner strobe assembly to the lightbar using the same screws that secured the previous multi-reflector.
11. Position the Micro-R reflectors and spacer so that all three of the new reflectors are snug.
12. Measure the gap (if any) between the edge of the inboard Micro-R reflector and the power supply, center option or reflector on the opposite end of the lightbar.
13. Trim the filler panel (included) to a length that will span this distance.

WARNING: If both multi-reflectors on the same side (front or rear) are being replaced, AND there is no power supply or center option between the multi-reflectors, DO NOT measure the distance for the filler panel until both existing multi-reflectors have been removed and the new Micro-R & corner strobe reflectors have been positioned in their new mounting location!

14. Remove all 3 of the new reflectors and slide the trimmed filler panel into position.
15. Slide the inboard Micro-R reflector into position and install the lamp assembly taken from the inboard reflector of the multi-reflector. Make sure to plug this lamp assembly into the correct wiring harness socket!
16. Repeat the previous step using the remaining Micro-R reflector and the appropriate lamp assembly.
17. Connect the corner strobe assembly plug to the appropriate wiring harness socket, position the assembly into the lightbar and secure the assembly using the #6 - 32 screws used to hold the multi-reflector in position.

ITEM	PART NUMBER	DESCRIPTION
1	15-041816-160	#4 X 1" PPHSMS (WASHER HEAD)
2	02-0362733-00	STROBE ASSEMBLY, CORNER
3	07-241014-000	BRACKET, LIGHTHEAD MOUNTING
4	68-5981731-01	MICRO-R REFLECTOR (TWIST-IN)
5	09-1341933-25	FILLER PANEL 17.00"
6	09-1341933-09	FILLER PANEL .375"

The outer surfaces of this product may be cleaned with mild soap and water. Use of any other chemicals may void product warranty. Do not use a pressure washer.

