

ROUTE 145, WINTHROP ROAD
 CHESTER, CONNECTICUT 06412-0684
 TELEPHONE: (860) 526-9504
 FAX: (860) 526-4078

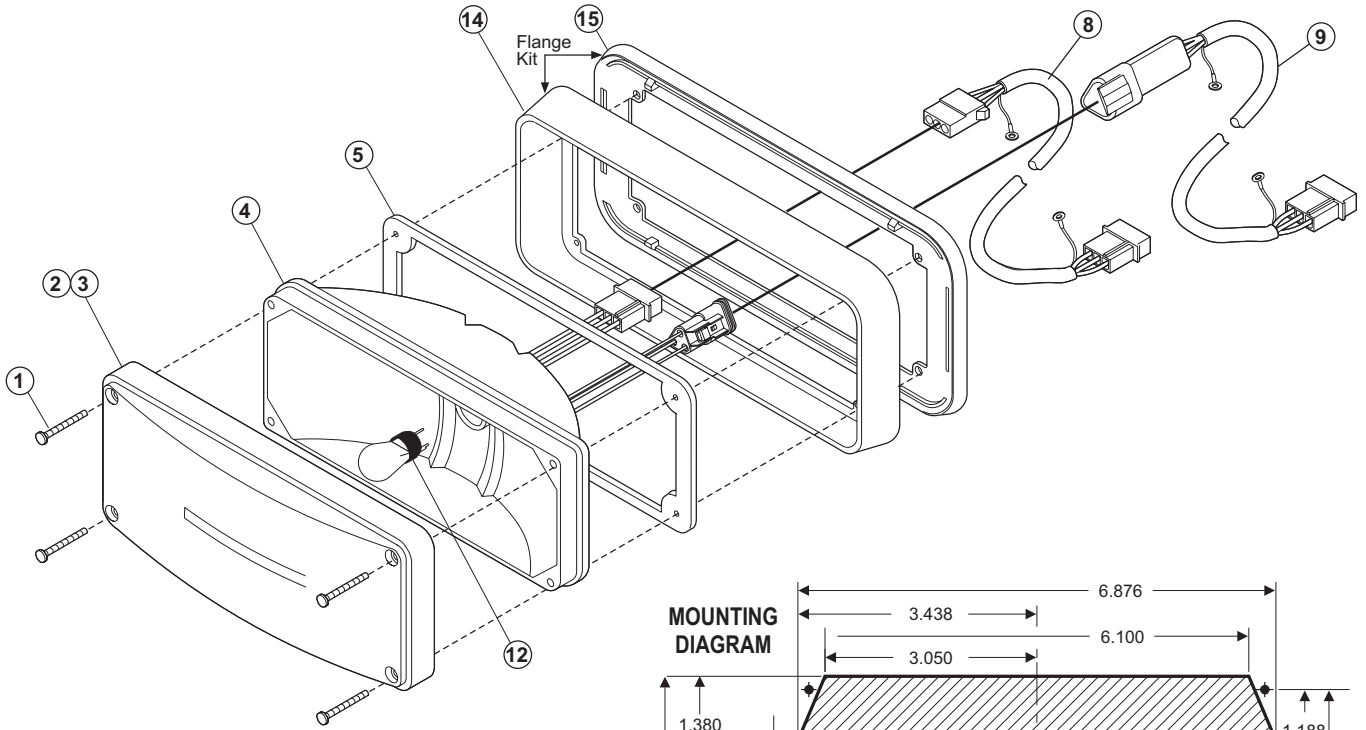

Installation Instructions . . .

1. Using the measurements in the mounting diagram mark off all of the mounting holes you must cut or drill .

NOTE: The mounting diagram is not to scale. Use for reference only. **WARNING!** This installation will require drilling. It is absolutely necessary to make sure that nothing will be damaged in the process. If damage is possible, select another mounting location.

2. Drill or cut all the mounting and access holes to the sizes noted in the mounting diagram.

3. Thread the wires to your power source.

IMPORTANT: All customer supplied wires that connect to the positive terminal of the battery, must be sized to supply at least 125% of the maximum operating current, and fused at the battery to carry that load.

4. Attach the light housing securely to the vehicle using the 4 Phillips Sheet Metal screws supplied.

5. Connect the wires to your power source.

IMPORTANT: The outer surfaces of this product may be cleaned with mild soap and water. Use of any other chemicals may void product warranty.

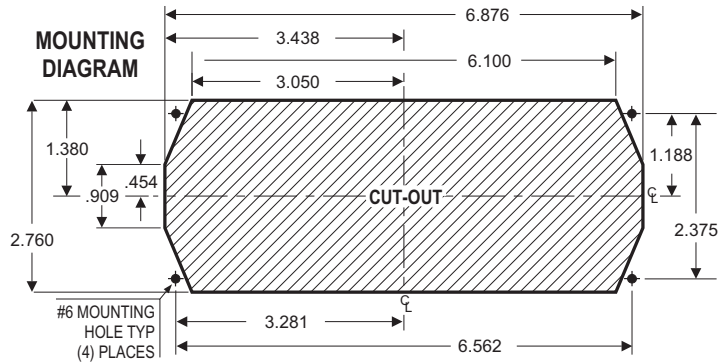

QTY.	ITEM	PART NUMBER	DESCRIPTION
*	*	01-0683254-()	MODEL 7E STOP / TAIL / TURN ASSEMBLY
4	1	15-061416-240	#6 X 1 1/2" PHIL PAN HD SMS
A/R	2	68-1183136-1S	LENS / 7E HALOGEN / AMBER WITH SEAL
A/R	3	68-1183136-5S	LENS / 7E HALOGEN / RED WITH SEAL
1	4	02-0283254-00C	7E HALOGEN REFLECTOR / AMP CONNECTOR
1	4	02-0283254-01C	7E HALOGEN REFLECTOR / DEUTCH CONNECTOR
1	5	38-0262643-00	GASKET
A/R	8	01-0440624-15	KIT / CABLE ASSEMBLY
A/R	9	01-0442199-15	KIT / CABLE ASSEMBLY / WATERPROOF
A/R	10	46-0742624-01	SNAP-IN CLIP ASSEMBLY / 3 WIRE
A/R	11	46-0742651-01	SNAP-IN CLIP ASSEMBLY / 3 WIRE / WATERPROOF
1	12	34-0062389-00	LAMP ASSEMBLY / 12.8V-14V / 27/12W
-	-	01-0462920-00	MODEL 7E SERIES FLANGE KIT WITHOUT SEAL
-	14	11-783141-001	FLANGE WITHOUT SEAL
-	15	38-0461354-00	FLANGE GASKET