

ROUTE 145, WINTHROP ROAD
 CHESTER, CONNECTICUT 06412-0684
 TELEPHONE: (860) 526-9504
 FAX: (860) 526-4078

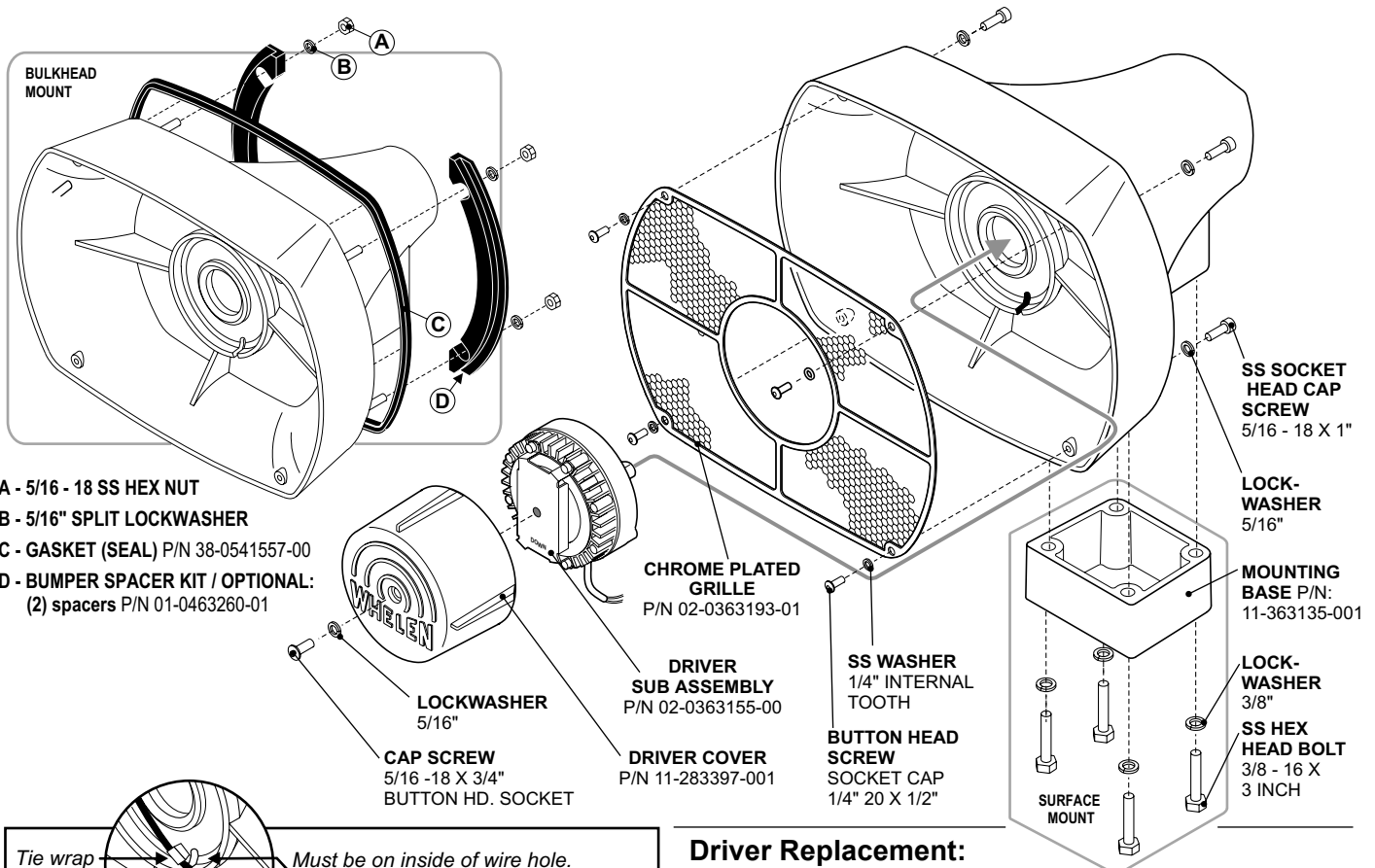

- A - 5/16 - 18 SS HEX NUT
- B - 5/16" SPLIT LOCKWASHER
- C - GASKET (SEAL) P/N 38-0541557-00
- D - BUMPER SPACER KIT / OPTIONAL:
 (2) spacers P/N 01-0463260-01

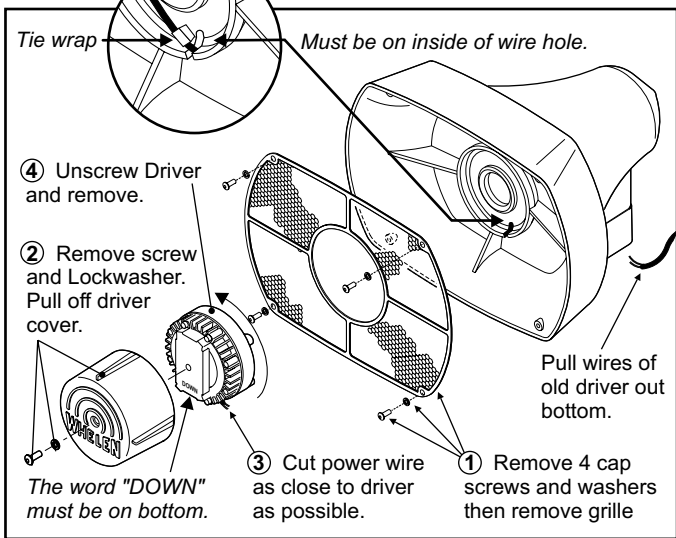

Driver Replacement:

1. Remove the 4 cap screws and lock washers that hold the grille on then remove the grille.
2. Remove the cap screw and lockwasher that hold on the driver cover and remove the cover.
3. Cut the power wire coming from the bottom of the driver, as close to the driver as possible.
4. Pull the old power wires out the bottom, then unscrew the siren driver in a counter clockwise direction and remove it.

WARNING: When installing the new driver, you *must* apply Anti-seize (not supplied) to all threaded parts. Failure to do so will cause thread galling and void product warranty.

Reassembly: Screw the new driver into the speaker assembly and tighten it firmly being careful not to catch the power wire between the driver and housing. **IMPORTANT:** When installing the new driver, you must be sure the word "DOWN" that is scribed on the front of the driver is on the *bottom of the siren*. If

this does not line up when the driver is fully tightened, you will need to loosen the driver and turn the inner horn (See Fig. 4). This horn has stops to prevent turning during operation and will turn 1/4 turn at a time before it catches on its stops. Now slip the power wire into the wire hole making sure the tie wrap is on the inside (near the driver) and replace the cover. Once the driver is tightened, thread the power wires of the new driver into the wire hole and out the base and replace the grille.

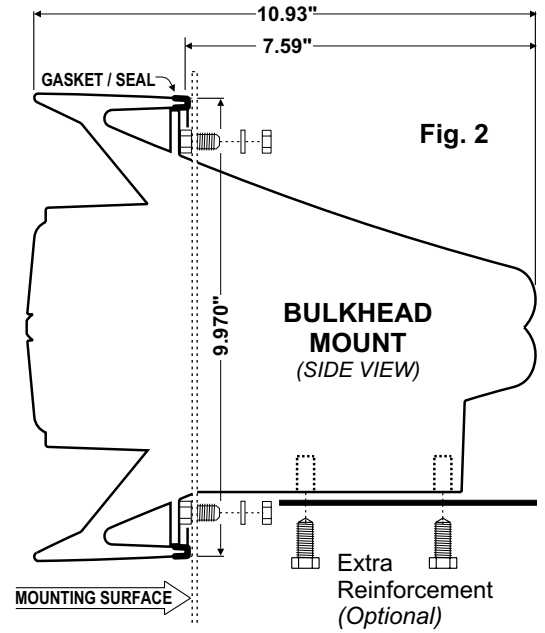
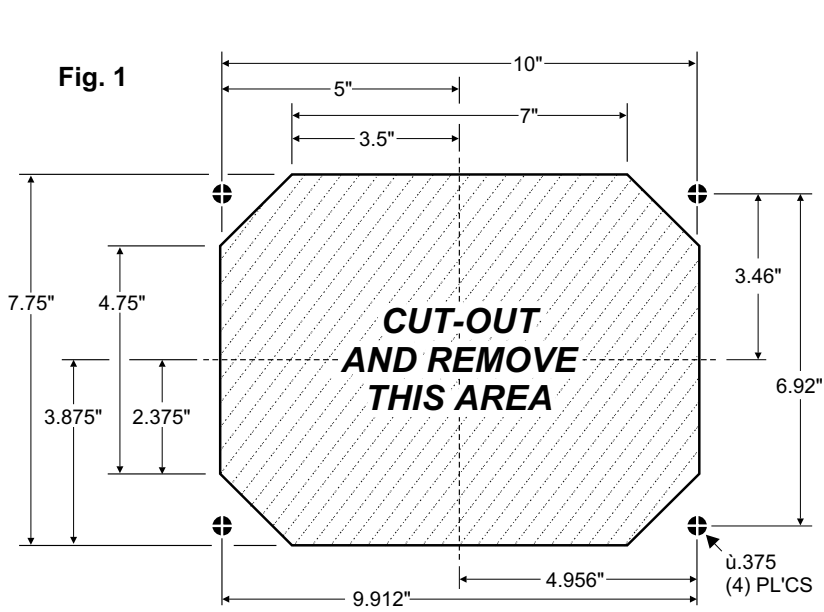

Bulkhead Mount:

1. Mark the measurements from Fig. 1 onto the mounting area using a scribe or other suitable tool.
2. Drill the 4 mounting holes using an appropriately sized drill, then cut the mounting area out.
3. Slide the siren into the mounting hole from the front of the vehicle, while sliding the 4 mounting bases into the 4 mounting holes. Make sure that the rubber gasket is properly seated between the siren and mounting surface (Item "C", on Pg. 1 & Fig. 2 on pg. 2).
4. Secure the siren to the vehicle with the 4 supplied washers and bolts, then run the wires to power, and hookup.

Surface Mount:

1. Using the mounting base as a template, mark off the four mounting holes and wire access hole onto the mounting area, using a scribe or other suitable tool.
2. Drill the four mounting holes and wire access hole.
3. Now attach the siren to the vehicle as shown, using the supplied Hex head bolts and lock washers. (Fig. 4)
4. Run the wires to power, and hookup.

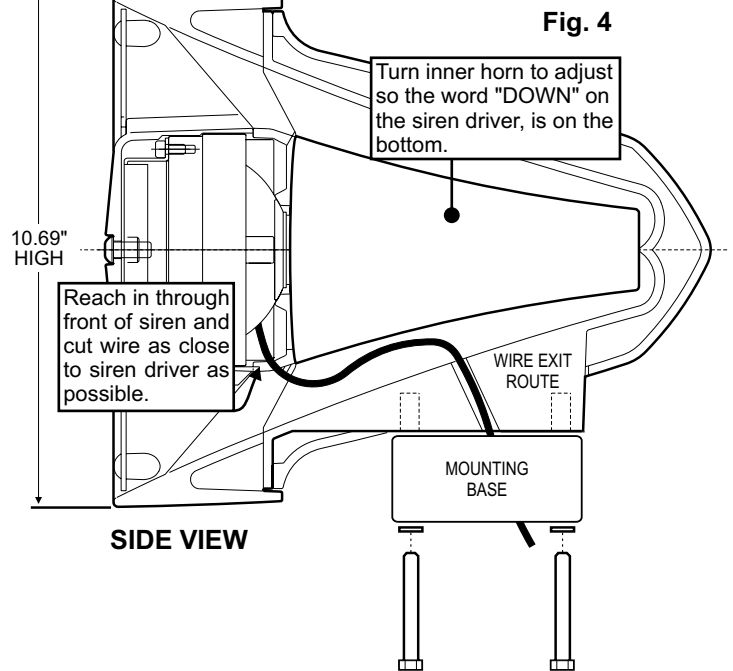
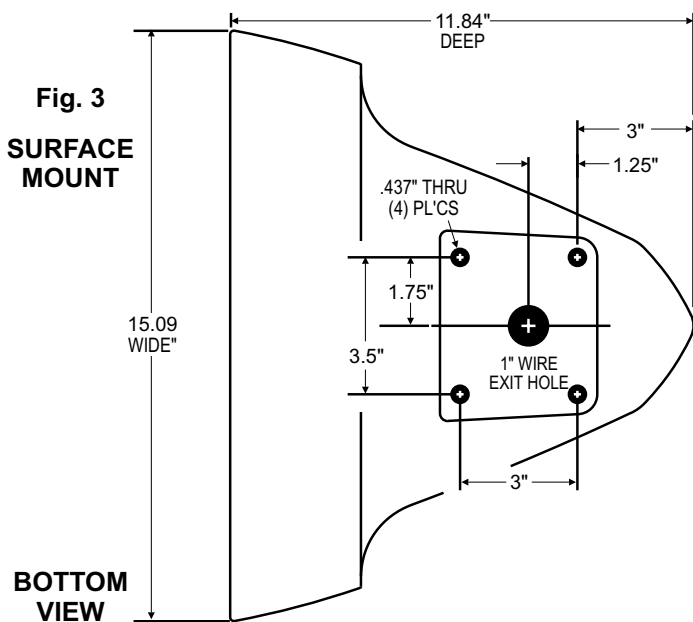

CAUTION: Loud siren noise can cause hearing loss. Minimize exposure. Close windows when using