

51 Winthrop Road
Chester, Connecticut 06412-0684
Phone: (860) 526-9504
Fax: (860) 526-4078
Sales Email: autosale@whelen.com
Canadian Sales: canadiansales@whelen.com
Customer Service: custserv@whelen.com

Safety First: This document provides all the necessary information to allow your Whelen product to be properly and safely installed. Before beginning the installation and/or operation of your new product, the installation technician and operator must read this manual completely. Important information is contained herein that could prevent serious injury or damage.

- Proper installation of this product requires the installer to have a good understanding of automotive electronics, systems and procedures.
- Whelen Engineering requires the use of waterproof butt splices and/or connectors if that connector could be exposed to moisture.
- Any holes, either created or utilized by this product, should be made both air- and watertight using a sealant recommended by your vehicle manufacturer.
- Failure to use specified installation parts and/or hardware will void the product warranty!
- If mounting this product requires drilling holes, the installer **MUST** be sure that no vehicle components or other vital parts could be damaged by the drilling process. Check both sides of the mounting surface before drilling begins. Also de-burr any holes and remove any metal shards or remnants. Install grommets into all wire passage holes.
- Do not install this product or route any wires in the deployment area of your air bag. Equipment mounted or located in the air bag deployment area will damage or reduce the effectiveness of the air bag, or become a projectile that could cause serious personal injury or death. Refer to your vehicle owner's manual for the air bag deployment area. The User/Installer assumes full responsibility to determine proper mounting location, based on providing ultimate safety to all passengers inside the vehicle.
- For this product to operate at optimum efficiency, a good electrical connection to chassis ground must be made. The recommended procedure requires the product ground wire to be connected directly to the **NEGATIVE (-)** battery post.
- If this product uses a remote device to activate or control this product, make sure that this control is located in an area that allows both the vehicle and the control to be operated safely in any driving condition.
- Do not attempt to activate or control this device in a hazardous driving situation.
- This product contains either strobe light(s), halogen light(s), high-intensity LEDs or a combination of these lights. Do not stare directly into these lights. Momentary blindness and/or eye damage could result.
- Use only soap and water to clean the outer lens. Use of other chemicals could result in premature lens cracking (crazing) and discoloration. Lenses in this condition have significantly reduced effectiveness and should be replaced immediately. Inspect and operate this product regularly to confirm its proper operation and mounting condition. Do not use a pressure washer to clean this product.
- **WARNING!** All customer supplied wires that connect to the positive (+) terminal of the battery must be sized to supply at least 125% of the maximum operating current and **FUSED** "at the battery" to carry that load. **DO NOT USE CIRCUIT BREAKERS WITH THIS PRODUCT!**
- **FAILURE TO FOLLOW THESE PRECAUTIONS AND INSTRUCTIONS COULD RESULT IN DAMAGE TO THE PRODUCT OR VEHICLE AND/OR SERIOUS INJURY TO YOU AND YOUR PASSENGERS!**

Installation...

1. Position the base reflector onto its proposed mounting surface. Locate the 3 mounting holes shown.
2. Using an awl or other suitable tool, scribe the surface where the mounting hole are to be drilled. Use the base as a guide.

CAUTION! Mounting this light will require drilling into its mounting surface. It is absolutely necessary to make sure that no other vehicle components could be damaged in the process. Check both sides of the mounting surface before starting. If damage is likely, select a different mounting location.

3. Carefully drill the mounting holes in the areas scribed in step 2. The size of the drill bit should be determined by the size of the mounting hardware (#6 x 3/4" PPHSMS) and the thickness of the mounting surface.
4. After the mounting holes have been drilled, position the mounting gasket onto the mounting surface. Insert the mounting screws through the holes in this gasket and into the mounting surface to hold the gasket in place.
5. Locate the wire passage hole in the gasket. Scribe a mark on the mounting surface at the location of this hole. Remove the gasket from the mounting surface.

6. Using a 3/8" (.375") drill bit, drill a wire passage hole into the mounting surface at the area scribed in step 5. After drilling, de-burr and grommet (customer supplied) this hole.
7. Route the RED and BLACK lamp wires through the wire passage hole in the mounting gasket. Using appropriately sized wires, extend the RED lamp wire to a switched, +12VDC power source capable of accommodating an additional 2 Amp load. Extend the BLACK wire to chassis ground.

All customer supplied wires, that connect to the positive terminal of the battery, must be sized to supply at least 125% of the maximum operating current, & fused at the battery to carry the load.

8. Feed all excess wire through the cable access hole away from the lamp base. Do not allow any wires between the surface and gasket. Test the lamp for proper operation before proceeding.
9. Position the mounting gasket and lamp base onto the mounting surface. Secure the base to the surface using the provided hardware. Mount the lens onto the base and secure using the #10 x 5/8" PPHSMS.

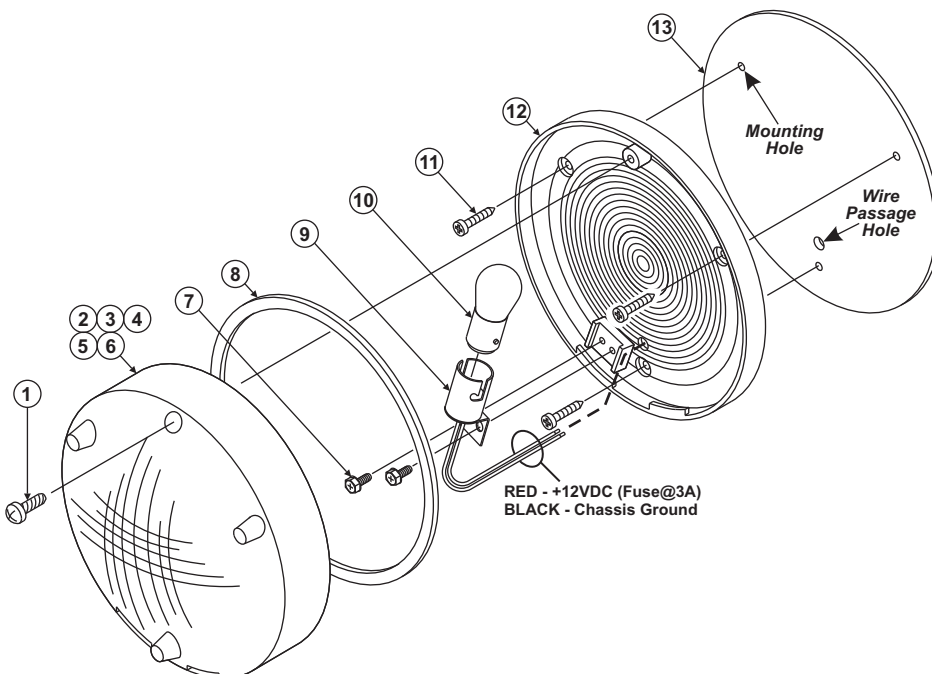

56-series Compartment Light

Item	Description	Part Number
1	#10 x 5/8" PPH Sheet Metal Screw	-----
2	Lens, Red	68-1181783-R0
3	Lens, Green	68-1181783-G0
4	Lens, Blue	68-1181783-B0
5	Lens, Amber	68-1181783-A0
6	Lens, Clear	68-1181783-C0
7	#6 x 5/16" Hex Washer Head Screw	-----
8	Lens Gasket	38-0261637-00
9	Bulb Holder	33-05621560-0
10	Bulb, 23 Watt (1076)	-----
11	#6 x 3/4" PPH Sheet Metal Screw	-----
12	Base Reflector	68-5981901-01
13	Mounting Gasket	38-0261657-00

56-series Compartment Light w/Switch (not shown)

Item	Description	Part Number
1	#10 x 5/8" PPH Sheet Metal Screw	-----
2	Lens, Optic Directional, Red w/Hole	68-1163244-R0
3	Lens, Optic Directional, Green w/Hole	68-1163244-G0
4	Lens, Optic Directional, Blue w/Hole	68-1163244-B0
5	Lens, Optic Directional, Amber w/Hole	68-1163244-A0
6	Lens, Optic Directional, Clear w/Hole	68-1163244-C0
7	#6 x 5/16" Hex Washer Head Screw	-----
8	Lens Gasket	38-0261637-00
9	Bulb Holder	33-05621560-0
10	Bulb, 23 Watt (1076)	-----
11	#6 x 3/4" PPH Sheet Metal Screw	-----
12	Base Reflector	68-5981901-01
13	Mounting Gasket	38-0261657-00
	On/Off Switch (not shown)	41-0101010-00

Warnings to Installers

Whelen's emergency vehicle warning devices must be properly mounted and wired in order to be effective and safe. Read and follow all of Whelen's written instructions when installing or using this device. Emergency vehicles are often operated under high speed stressful conditions which must be accounted for when installing all emergency warning devices. Controls should be placed within convenient reach of the operator so that he can operate the system without taking his eyes off the roadway. Emergency warning devices can require high electrical voltages and/or currents. Properly protect and use caution around live electrical connections. Grounding or shorting of electrical connections can cause high current arcing, which can cause personal injury and/or vehicle damage, including fire. Many electronic devices used in emergency vehicles can create or be affected by electromagnetic interference. Therefore, after installation of any electronic device it is necessary to test all electronic equipment simultaneously to insure that they operate free of interference from other components within the vehicle. Never power emergency warning equipment from the same circuit or share the same grounding circuit with radio communication equipment. All devices should be mounted in accordance with the manufacturer's instructions and securely fastened to vehicle elements of sufficient strength to withstand the forces applied to the device. Driver and/or passenger air bags (SRS) will affect the way equipment should be mounted. This device should be mounted by permanent installation and within the zones specified by the vehicle manufacturer, if any. Any device mounted in the deployment area of an air bag will damage or reduce the effectiveness of the air bag and may damage or dislodge the device. Installer must be sure that this device, its mounting hardware and electrical supply wiring does not interfere with the air bag or the SRS wiring or sensors. Mounting the unit inside the vehicle by a method other than permanent installation is not recommended as unit may become dislodged during swerving; sudden braking or collision. Failure to follow instructions can result in personal injury. Whelen assumes no liability for any loss resulting from the use of this warning device. **PROPER INSTALLATION COMBINED WITH OPERATOR TRAINING IN THE PROPER USE OF EMERGENCY WARNING DEVICES IS ESSENTIAL TO INSURE THE SAFETY OF EMERGENCY PERSONNEL AND THE PUBLIC.**

Warnings to Users

Whelen's emergency vehicle warning devices are intended to alert other operators and pedestrians to the presence and operation of emergency vehicles and personnel. However, the use of this or any other Whelen emergency warning device does not guarantee that you will have the right-of-way or that other drivers and pedestrians will properly heed an emergency warning signal. Never assume you have the right-of-way. It is your responsibility to proceed safely before entering an intersection, driving against traffic, responding at a high rate of speed, or walking on or around traffic lanes. Emergency vehicle warning devices should be tested on a daily basis to ensure that they operate properly. When in actual use, the operator must ensure that both visual and audible warnings are not blocked by vehicle components (i.e.: open trunks or compartment doors), people, vehicles, or other obstructions. It is the user's responsibility to understand and obey all laws regarding emergency warning devices. The user should be familiar with all applicable laws and regulations prior to the use of any emergency vehicle warning device. Whelen's audible warning devices are designed to project sound in a forward direction away from the vehicle occupants. However, because sustained periodic exposure to loud sounds can cause hearing loss, all audible warning devices should be installed and operated in accordance with the standards established by the National Fire Protection Association.