

ROUTE 145, WINTHROP ROAD
CHESTER, CONNECTICUT 06412-0684
TELEPHONE: (860) 526-9504
FAX: (860) 526-4078

Mounting Style #1 . . .

1. Select a mounting location. Make sure that the 97 will not interfere with any existing equipment. Be aware of any and all items on the opposite side of the mounting surface to prevent any possible damage to existing components.
2. Using the dimensions shown on page 3, carefully remove the area of the mounting surface where the reflector will be installed.
Do not remove the mounting surface area where the mounting holes are to be drilled!
3. Using a drill bit sized for a #10 sheet metal screw (and the thickness of the mounting surface), drill the mounting holes as shown on Page 3.
4. Route the cable assembly through the wiring hole towards the necessary power supply. Be sure that both ring terminals are grounded to the vehicle chassis ground.
5. Now pass the cable through the mounting components as shown. Plug the 97 lighthead into the cable and plug the cable into the power supply. Test operation of the 97 before securing it to the vehicle.

6. Position the 97 components onto the mounting surface and secure to the vehicle using four #10 x 1" (#10 x 1.25" for use with flange mount) sheet metal screws.

Mounting Style #2 . . .

1. Same as step 1 of Style #1.
2. Using the dimensions shown on page 4, carefully remove the area of the mounting surface where the reflector will be installed.
Note: Mounting style #2 is designed to use Fastex[®] grommets (customer supplied) to secure the 97 to its mounting surface.
3. Same as step 4 of style #1.
4. Same as step 5 of style #1.
5. Same as step 6 of style #1 except the grommets must be inserted into the areas indicated on page 4.

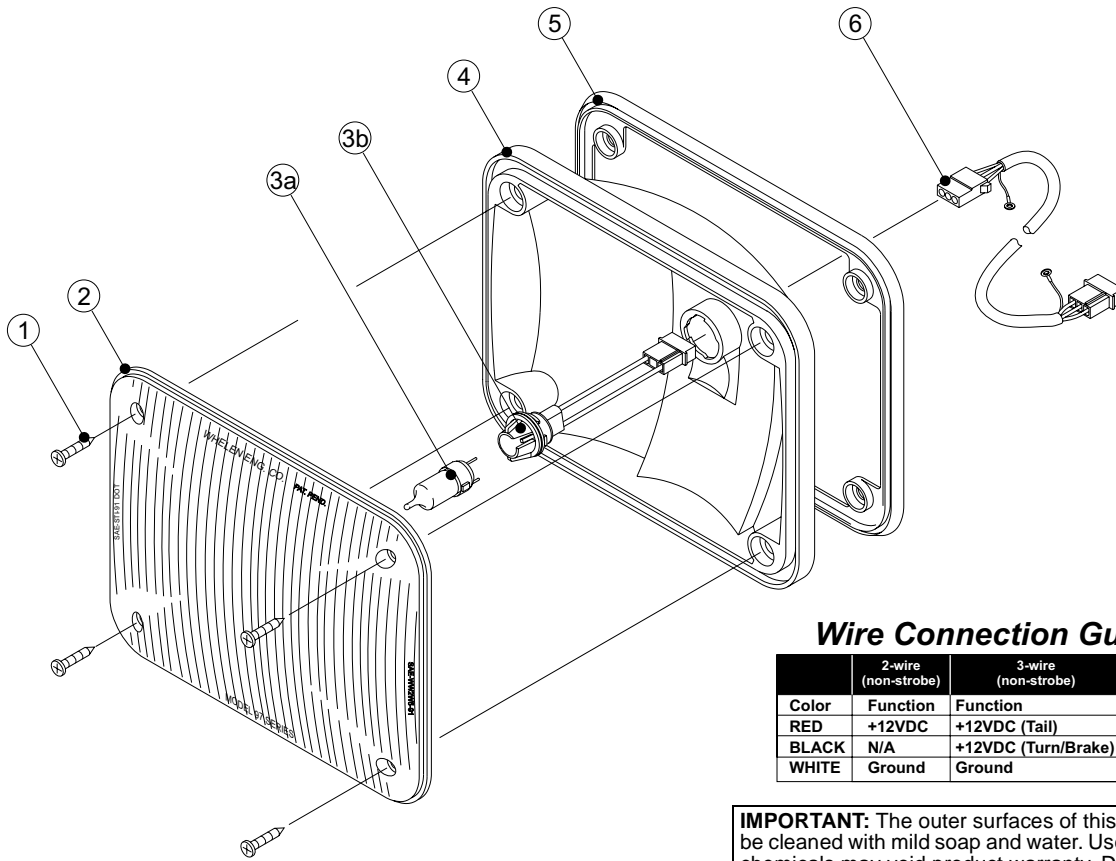

Wire Connection Guide

	2-wire (non-strobe)	3-wire (non-strobe)	3-wire (strobe)
Color	Function	Function	Function
RED	+12VDC	+12VDC (Tail)	Anode
BLACK	N/A	+12VDC (Turn/Brake)	Cathode
WHITE	Ground	Ground	Trigger

IMPORTANT: The outer surfaces of this product may be cleaned with mild soap and water. Use of any other chemicals may void product warranty. Do not use a pressure washer.

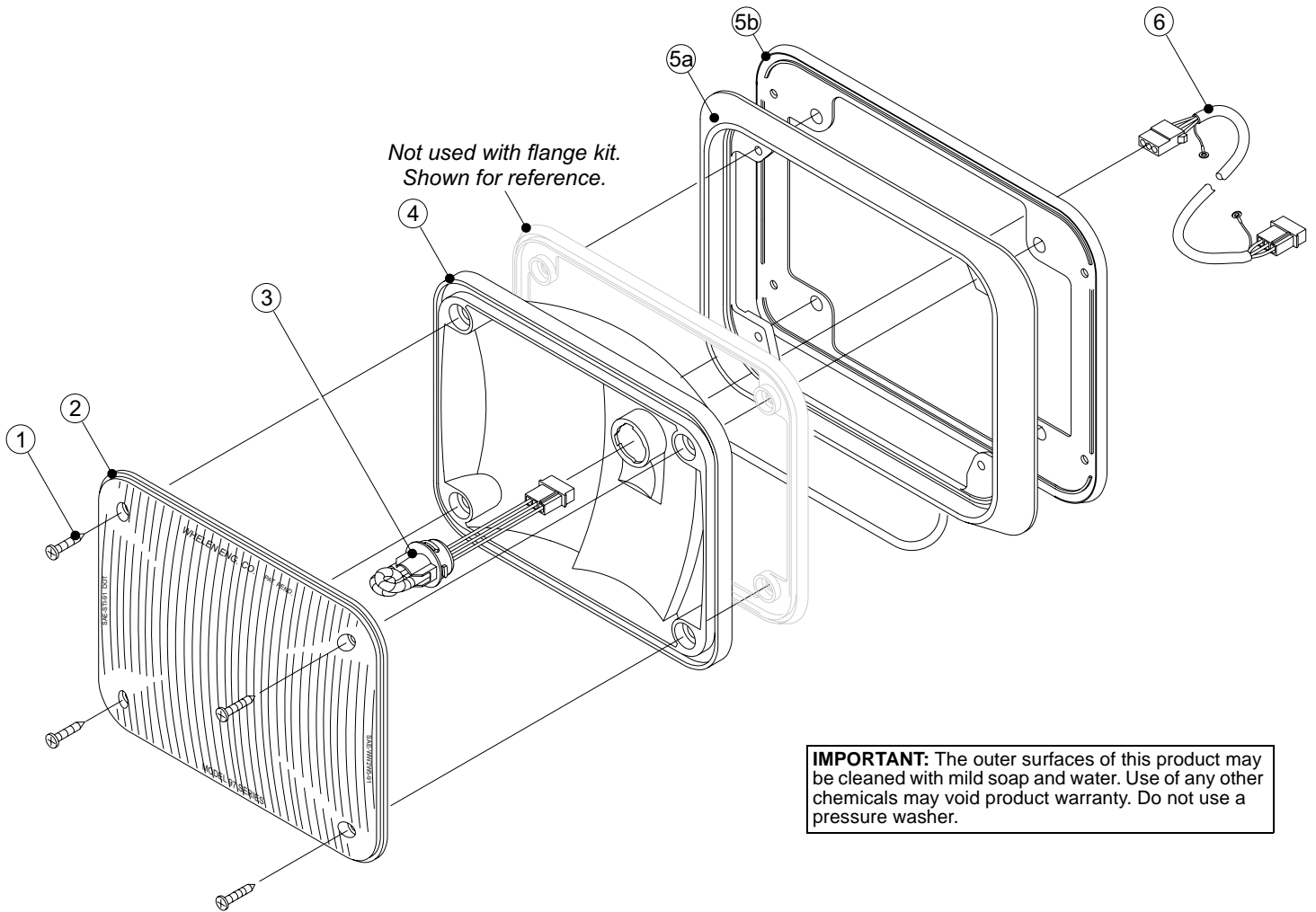

IMPORTANT: The outer surfaces of this product may be cleaned with mild soap and water. Use of any other chemicals may void product warranty. Do not use a pressure washer.

ITEM	QTY	PART NUMBER	DESCRIPTION
1	4	N/A	#10 x 1" P.P.H.S.M.S. (1/4" if flange mount is used)
2	A/R	68-1181349-10	LENS, AMBER
2	A/R	68-1181349-20	LENS, BLUE
2	A/R	68-1181349-30	LENS, CLEAR
2	A/R	68-1181349-40	LENS, GREEN
2	A/R	68-1181349-50	LENS, RED
2	A/R	02-0361457-13	LENS, 13° SCENELIGHT ASSY.
2	A/R	02-0361457-26	LENS, 26° SCENELIGHT ASSY.
2	A/R	68-1182293-30	LENS, 8° - 32° SCENELIGHT
2	A/R	02-0381749-()	LENS, SPLIT
2	A/R	68-1181745L()	LENS, ARROW
3	A/R	36-0361281-00	S30TL TWIST-IN STROBE
3a	A/R	34-0041987-00	LAMP, 35H HALOGEN
3a	A/R	34-0041987-01	LAMP, 50H HALOGEN
3a	A/R	34-0062389-00	LAMP, STOP/TAIL INCANDESCENT (3-WIRE USAGE)
3b	A/R	33-0042141-00	ASSY., LAMP HOLDER (2-WIRE/SHOWN)
3b	A/R	33-0042203-00	ASSY., LAMP HOLDER (3-WIRE/NOT SHOWN)
4	A/R	68-5981389-06	REFLECTOR (METALIZED)
4	A/R	68-5981389-07	REFLECTOR (MATTE)
5	1	38-0481690-00	GASKET, REFLECTOR (NOT USED w/FLANGE KIT)
5a	1	11-783130-001	FLANGE
5b	1	38-0481440-00	GASKET, FLANGE
6	1	01-0440624-15	CABLE, 15 FT.

Mounting Style #1

NOTE: The dimensions shown in this illustration are shown to the third decimal place. Although the tools capable of cutting this opening are not usually this accurate, it is absolutely necessary to try and stay as close to these dimensions as possible.

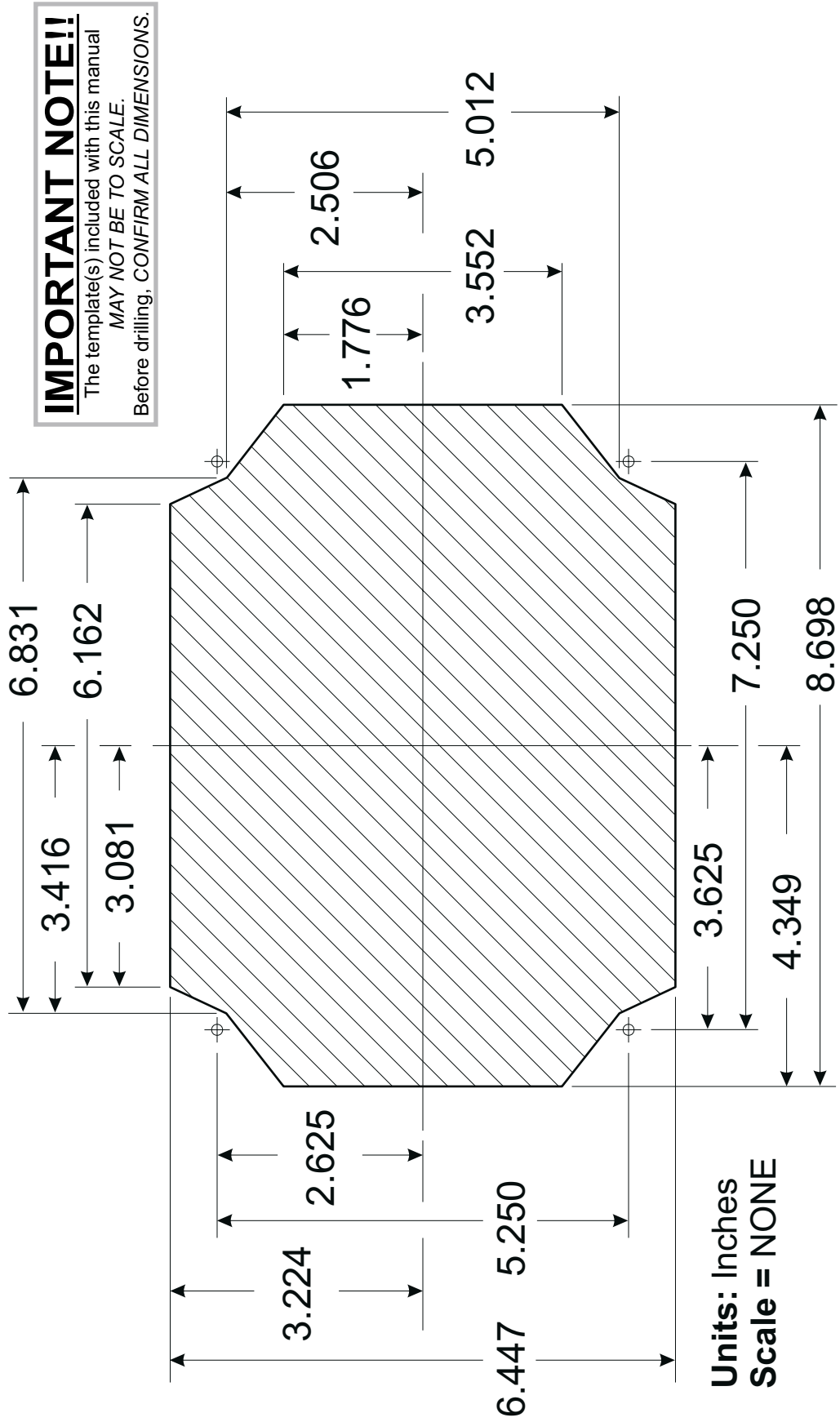

Mounting Style #2

NOTE: The dimensions shown in this illustration are shown to the third decimal place. Although the tools capable of cutting this opening are not usually this accurate, it is absolutely necessary to try and stay as close to these dimensions as possible.

