

# WHELEN®

## ENGINEERING COMPANY INC.

Route 145, Winthrop Road,  
Chester, Connecticut 06412

Phone: (860) 526-9504

Fax: (860) 526-4078

Internet: [www.whelen.com](http://www.whelen.com)

Sales e-mail: [autosale@whelen.com](mailto:autosale@whelen.com)

Canadian Sales e-mail: [autocan@whelen.com](mailto:autocan@whelen.com)

Customer Service e-mail: [custserv@whelen.com](mailto:custserv@whelen.com)

## Installation Guide: Solo Strobe

### SPECIFICATIONS

V INPUT	12.8VDC or (25.6VDC) +/-20%
I INPUT @ 12.8V	1.25 AMPS
I INPUT @ 25.6V	0.75AMPS
OUTPUT POWER	10 WATTS
FLASHRATE	COMET FLASH - 75 CFPM

NOTE: Other flashrates are available for the Solo-Strobe.  
Contact Whelen Engineering for more information.

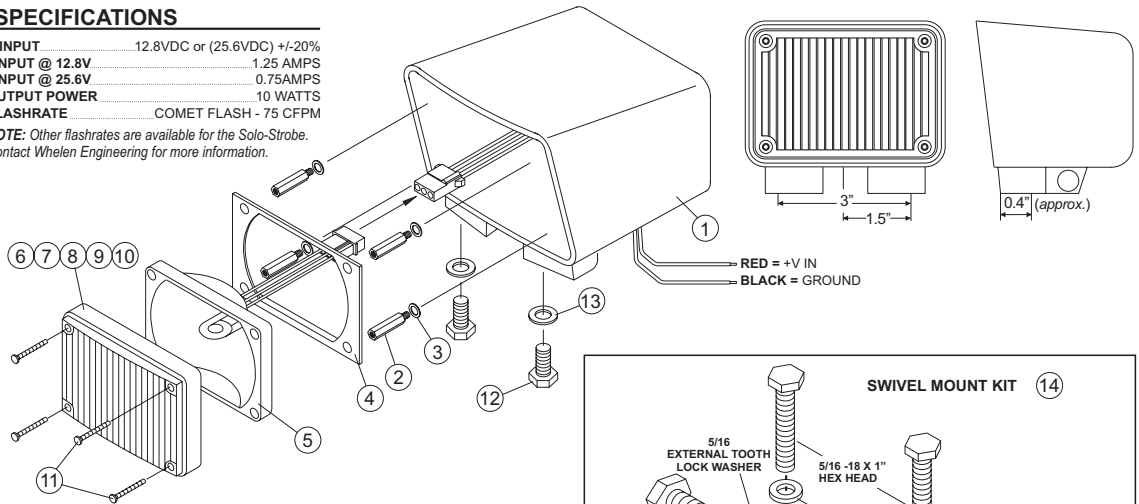

QTY	ITEM	PART NUMBER	DESCRIPTION
1	1	01-0268956-00	ELECTRONIC ASSEMBLY, SOLO STROBE
4	2	20-4008062303	1 1/4L X 1/4D X 6-32 HEX M/F STANDOFF
4	3		NO.6 INTERNAL TOOTH LOCK WASHER
1	4	38-0460853-00	SEAL, HOUSING
1	5	02-0360709-00	MICRO MAX BEAM STROBE ASSEMBLY
OPT	6	68-1180646-1S	LENS, AMBER W/SEAL
OPT	7	68-1180646-2S	LENS, BLUE W/SEAL
OPT	8	68-1180646-3S	LENS, CLEAR W/SEAL
OPT	9	68-1180646-4S	LENS, GREEN W/SEAL
OPT	10	68-1180646-5S	LENS, RED W/SEAL
4	11		6-32 X 1" PHILLIPS PHMS
2	12		5/16-18 X 3/4" HEX HEAD BOLT SS
2	13		5/16" LOCK WASHER
1	14	02-0380677-00	KIT, SWIVEL MOUNT
		01-0663239-*0	FINAL ASSY, SOLO-STROBE, WATER RESISTANT

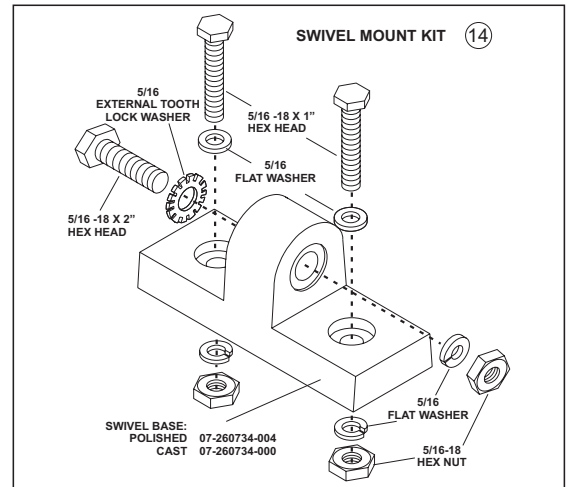

**WARNING:** All customer supplied wires must be sized to supply at least 125% of the maximum operating current, and fused at the battery, to carry that load.

**SAFETY WARNING:** The strobe power supply is a high voltage device. Do not touch the strobe tube assembly or power supply assembly while the unit is in operation. Wait 10 minutes after turning power off to starting any work or trouble shooting.

#### Method 1 (Surface Mount)

- Position the housing onto the desired mounting surface. Using the dimensions in the illustration, drill two, 11/32" holes 3 inches apart. The center of these holes are 0.4" from the leading edge of the base.
- Using the provided hardware, secure the housing to the mounting surface.
- Connect the RED wire to an appropriately sized switch. Extend this wire to either 12 VDC and fuse at 5 Amps, or 24 VDC and fuse at 3 Amps (see Warning). Connect the BLACK wire to chassis ground.

#### Method 2 (Swivel Mount)

- Position the swivel base onto the desired mounting surface. Using the base as a template, scribe the location of the two mounting holes to be drilled.
- Drill two 11/32" holes in these locations and use the included hardware to secure the base to the mounting surface.
- Position the housing onto the base so that the vertical mounting holes straddle the base.
- Using the hardware shown, insert the "swivel" bolt through the housing, the base and out through the housing. Be sure to note the hardware items used and the locations.
- Adjust the housing to the desired angle and secure the assembly to prevent unwanted lighthouse movement.
- Connect the RED wire to an appropriately sized switch. Extend this wire to either 12 VDC and fuse at 5 Amps, or 24 VDC and fuse at 3 Amps (see Warning). Connect the BLACK wire to chassis ground.