

WHELEN[®] ENGINEERING COMPANY INC.

51 Winthrop Road
 Chester, Connecticut 06412-0684
 Phone: (860) 526-9504
 Fax: (860) 526-4078
 Internet: www.whelen.com
 Sales e-mail: autosale@whelen.com
 Canadian Sales e-mail: autocan@whelen.com
 Customer Service e-mail: custserv@whelen.com

Installation Guide: Model SA314E*P Siren/Light Combination

DANGER! Sirens produces extremely loud emergency warning tones! Exposure to these tones without proper and adequate hearing protection, could cause ear damage and/or hearing loss! The Occupational Safety & Health Administration (www.osha.gov) provides information necessary to determine safe exposure times in Occupational Noise Exposure Section 1910.95. Until you have determined the safe exposure times for your specific application, operators and anyone else in the immediate vicinity should be required to wear an approved hearing protection device. **FAILURE TO FOLLOW THIS RECOMMENDATION COULD CAUSE HEARING LOSS!**

Safety First

This document provides all the necessary information to allow your Whelen product to be properly and safely installed. Before beginning the installation and/or operation of your new product, the installation technician and operator must read this manual completely. Important information is contained herein that could prevent serious injury or damage.

- Proper installation of this product requires the installer to have a good understanding of automotive electronics, systems and procedures.
- If mounting this product requires drilling holes, the installer **MUST** be sure that no vehicle components or other vital parts could be damaged by the drilling process. Check both sides of the mounting surface before drilling begins. Also de-burr any holes and remove any metal shards or remnants. Install grommets into all wire passage holes.
- If this manual states that this product may be mounted with suction cups, magnets, tape or Velcro™, clean the mounting surface with a 50/50 mix of isopropyl alcohol and water and dry thoroughly.
- Do not install this product or route any wires in the deployment area of your air bag. Equipment mounted or located in the air bag deployment area will damage or reduce the effectiveness of the air bag, or become a projectile that could cause serious personal injury or death. Refer to your vehicle owners manual for the air bag deployment area. The User/Installer assumes full responsibility to determine proper mounting location, based on providing ultimate safety to all passengers inside the vehicle.
- For this product to operate at optimum efficiency, a good electrical connection to chassis ground must be made. The recommended procedure requires the product ground wire to be connected directly to the **NEGATIVE (-)** battery post.
- If this product uses a remote device to activate or control this product, make sure this control is located in an area that allows both the vehicle and the control to be operated safely in any driving condition. **DO NOT ATTEMPT TO ACTIVATE OR CONTROL THIS DEVICE IN A HAZARDOUS DRIVING SITUATION.**
- It is recommended that these instructions be stored in a safe place and referred to when performing maintenance and/or reinstallation of this product.
- **FAILURE TO FOLLOW THESE SAFETY PRECAUTIONS AND INSTRUCTIONS COULD RESULT IN DAMAGE TO THE PRODUCT OR VEHICLE AND/OR SERIOUS INJURY TO YOU AND YOUR PASSENGERS!**

ACTIVATION OF THIS SIREN MAY DAMAGE UNPROTECTED EARS!	
 Wear Protection!	CAUTION Loud siren noise can cause hearing damage and/or loss. Refer to OSHA Section 1910.95 prior to putting ANY siren into service!

For warranty information regarding this product, visit www.whelen.com/warranty

Installation

1. Determine the vertical center line for the vehicle's front bumper.
2. From the center line, measure out 27.5" inches along the top of the bumper. Mark this distance on rear edge of the top of the bumper.
3. Locate the mounting templates included with this manual. CAREFULLY cut these templates out along the indicated lines. **IMPORTANT! The dimensions indicated on these templates are accurate, however the template itself may not be. Confirm all dimensions BEFORE proceeding with this installation. The accurate location of the mounting holes are critical to the proper installation of this product.**
4. Locate the mark scribed in step 2. Position the top edge of the template so that it is flush with the rear edge of the top of the bumper. Align the vertical center line of the template with this mark. The template should lie flat across the surface of the bumper following its contours.

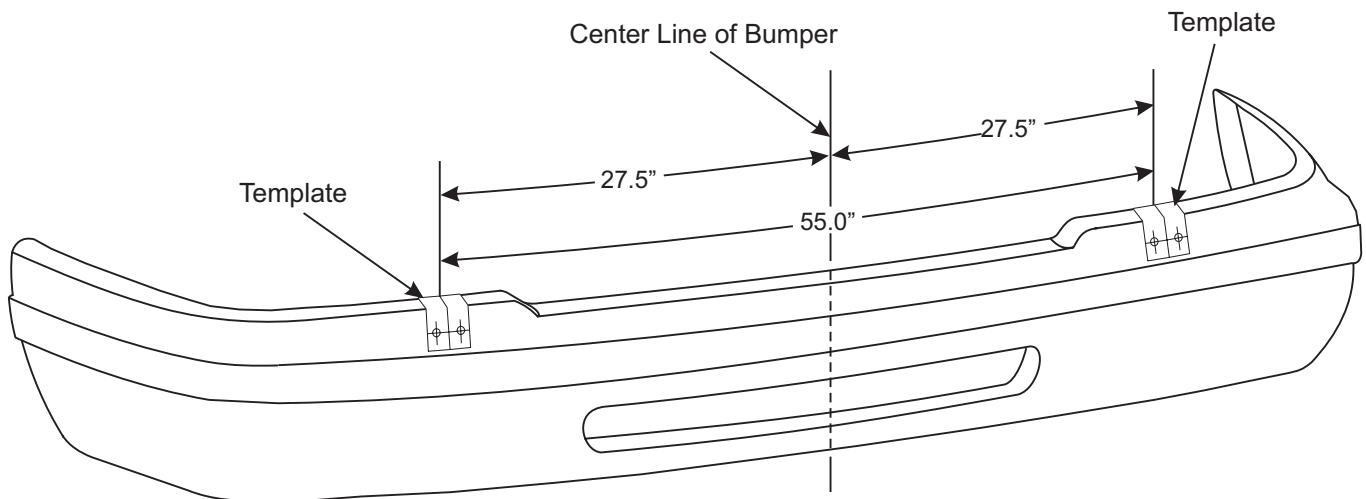

5. With the template in its correct position, mark the center of the two holes with a punch or suitable tool. Drill two, 5/8" (0.625") diameter holes in the areas marked.
6. Remove the template from the bumper and insert the mounting studs on the housing through the holes drilled in the previous step. *NOTE: The housings are designed so that when mounted, the siren-side is towards the center line of the vehicle.* The contour of the bumper should mate smoothly with the housing.
7. Remove the housing from the bumper. Extend the WHITE (Positive) and BLACK (Negative) speaker wires to your siren amplifier and connect as outlined in your siren amplifier's instruction sheet. Route the cables provided with your lighthoods (optional) from the housing mounting area to their appropriate power supply. *NOTE: When routing the cables, it is important to choose a path that will keep these wires away from excessive heat and from any vehicle equipment that could compromise the integrity of the wires.*
8. Return the housing to its mounting location on the vehicle bumper. Install the backing plate onto the mounting studs and secure with the hardware provided. *NOTE: The backing plate must be oriented exactly as shown in the illustration on the following page.*
9. Thoroughly test the siren and light(s) to confirm proper operation before returning the vehicle to active duty.

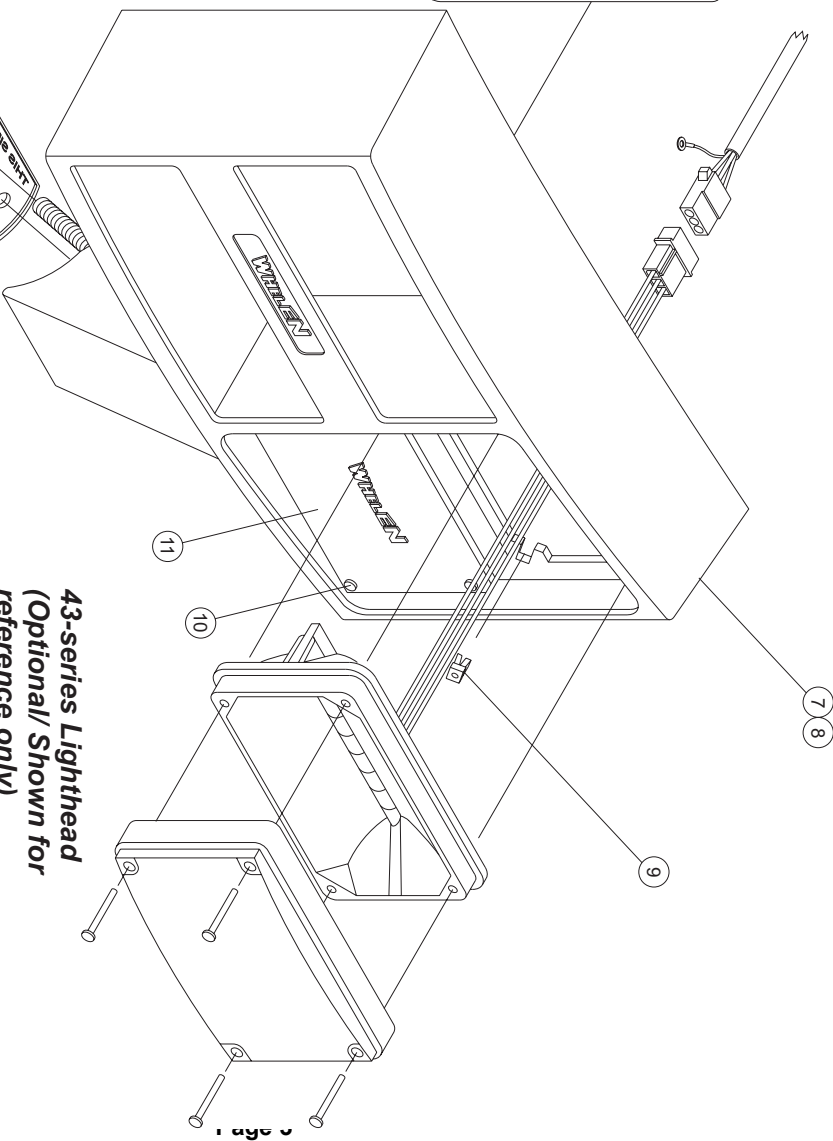
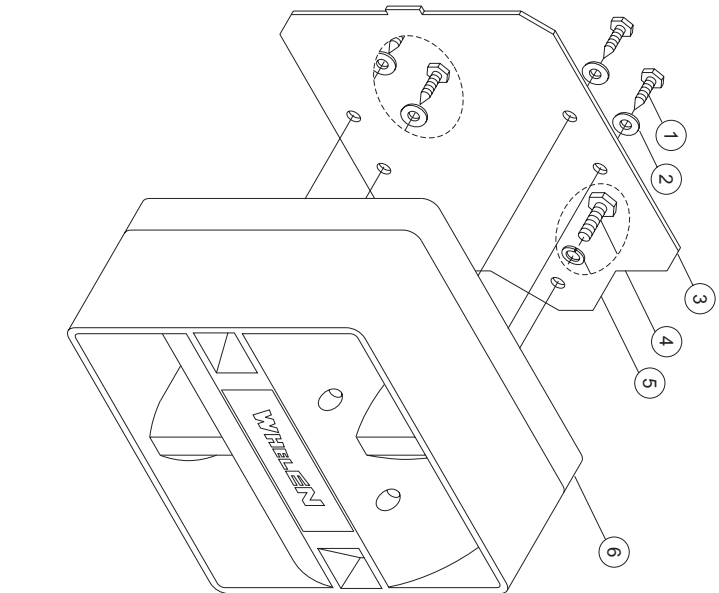

**43-series Lighthead
(Optional/ Shown for
reference only)**

**Make sure that the
Backing Plate is oriented
as shown.**

ITEM	DESCRIPTION	QTY.	PART NUMBER
1	#14 x 1" Phillips Pan Head Screw	4	N/A
2	1/4" Internal Tooth Lock Washer	4	N/A
3	Speaker Retaining Strap	1	07-763303-000
4	1/4-20 x 5/8" Phillips Machine Screw	1	N/A
5	1/4" Split Lock Washer	1	1
6	SA314 Siren Speaker Housing	1	01-0883513-00
7	Siren/Light Housing (Driver)	A/R	11-483546-*
8	Siren/Light Housing (Passenger)	A/R	11-483547-*
9	#6 Fastex Screw Grommet	8	N/A
10	#6 x 1/2" PPHSMS	4	N/A
11	43-series Filler Panel	1	09-1363158-00
12	Backing Plate	1	07-742776-000
13	1/2 Flat Washer	2	N/A
14	1/2" Split Lock Washer	2	N/A
15	1/2-13 Hex Nut	2	N/A

* add 000 for natural cast housing
add 011 for polished cast housing

