

# WHELEN<sup>®</sup>

ENGINEERING COMPANY INC.

51 Winthrop Road  
Chester, Connecticut 06412-0684  
Phone: (860) 526-9504  
Fax: (860) 526-4078  
Internet: [www.whelen.com](http://www.whelen.com)  
Sales e-mail: [autosale@whelen.com](mailto:autosale@whelen.com)  
Canadian Sales e-mail: [autocan@whelen.com](mailto:autocan@whelen.com)  
Customer Service e-mail: [custserv@whelen.com](mailto:custserv@whelen.com)

## Installation Guide: 500 Series Halogen Lighthouse

### Safety First

This document provides all the necessary information to allow your Whelen product to be properly and safely installed. Before beginning the installation and/or operation of your new product, the installation technician and operator must read this manual completely. Important information is contained herein that could prevent serious injury or damage.

- **Proper installation of this product requires the installer to have a good understanding of automotive electronics, systems and procedures.**
- **If mounting this product requires drilling holes, the installer MUST be sure that no vehicle components or other vital parts could be damaged by the drilling process. Check both sides of the mounting surface before drilling begins. Also de-burr any holes and remove any metal shards or remnants. Install grommets into all wire passage holes.**
- **If this manual states that this product may be mounted with suction cups, magnets, tape or Velcro<sup>®</sup>, clean the mounting surface with a 50/50 mix of isopropyl alcohol and water and dry thoroughly.**
- **Do not install this product or route any wires in the deployment area of your air bag. Equipment mounted or located in the air bag deployment area will damage or reduce the effectiveness of the air bag, or become a projectile that could cause serious personal injury or death. Refer to your vehicle owner's manual for the air bag deployment area. The User/Installer assumes full responsibility to determine proper mounting location, based on providing ultimate safety to all passengers inside the vehicle.**
- **For this product to operate at optimum efficiency, a good electrical connection to chassis ground must be made. The recommended procedure requires the product ground wire to be connected directly to the NEGATIVE (-) battery post.**
- **If this product uses a remote device to activate or control this product, make sure that this control is located in an area that allows both the vehicle and the control to be operated safely in any driving condition.**
- **Do not attempt to activate or control this device in a hazardous driving situation.**
- **This product contains either strobe light(s), halogen light(s), high-intensity LEDs or a combination of these lights. Do not stare directly into these lights. Momentary blindness and/or eye damage could result.**
- **Use only soap and water to clean the outer lens. Use of other chemicals could result in premature lens cracking (crazing) and discoloration. Lenses in this condition have significantly reduced effectiveness and should be replaced immediately. Inspect and operate this product regularly to confirm its proper operation and mounting condition. Do not use a pressure washer to clean this product.**
- **It is recommended that these instructions be stored in a safe place and referred to when performing maintenance and/or reinstallation of this product.**
- **FAILURE TO FOLLOW THESE SAFETY PRECAUTIONS AND INSTRUCTIONS COULD RESULT IN DAMAGE TO THE PRODUCT OR VEHICLE AND/OR SERIOUS INJURY TO YOU AND YOUR PASSENGERS!**

**For warranty information regarding this product, visit [www.whelen.com/warranty](http://www.whelen.com/warranty)**

# Installation:

1. Position the lighthead in its approximate mounting location and make sure that the lighthead will not interfere with any existing equipment. Also be aware of any items on the opposite side of the mounting surface to prevent any possible damage to existing components.
2. Using the measurements supplied, mark off the mounting holes and lighthead cut-out hole onto the mounting surface.
3. Drill the 2 screw holes and cut the mounting hole out as indicated.
4. Wire the lighthead as shown below and secure it to the mounting location using the supplied sheet metal screws.

**Note:** All customer supplied wires that connect to the positive terminal of the battery must be sized to supply at least 125% of the maximum operating current and **FUSED** at the battery to carry that load. **DO NOT USE CIRCUIT BREAKERS WITH THIS PRODUCT!**

**Caution:** The replacement of any halogen bulb requires the use of safety glasses to prevent injury. Do not handle the bulb with bare hands. Use gloves to prevent possible injuries.

**IMPORTANT!** Before returning this vehicle to active service, visually confirm the proper operation of this product, as well as all vehicle components/equipment.

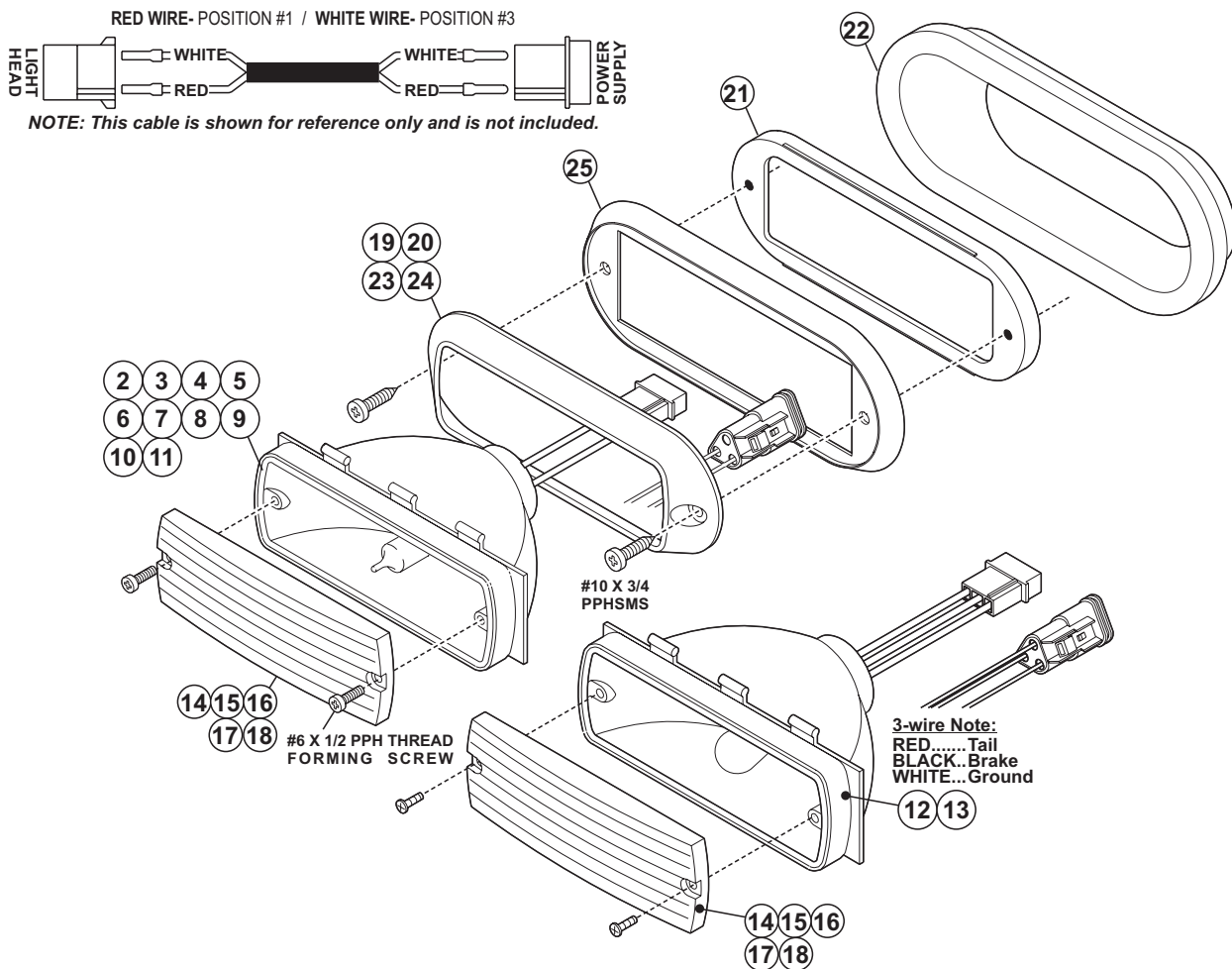

QTY.	QTY.	QTY.	QTY.	QTY.	QTY.	QTY.	QTY.	QTY.	QTY.	QTY.	QTY.	QTY.	QTY.	ITEM	PART NUMBER	DESCRIPTION	
													*		01-06835770_0	ASSEMBLY / 52 HALOGEN 2 WIRE 3 POS AMP 12V-35H	
													*		01-06835770_2	ASSEMBLY / 52 HALOGEN 2 WIRE 3 POS AMP 28V-35W	
													*		01-06835771_0	ASSEMBLY / 52 HALOGEN 2 WIRE DEUTSCH 12V-35H	
													*		01-06835771_2	ASSEMBLY / 52 HALOGEN 2 WIRE DEUTSCH 28V-35W	
													*		01-06835771_3	ASSEMBLY / 52 HALOGEN 2 WIRE DEUTSCH 12V-27H	
													*		01-06835771_4	ASSEMBLY / 52 HALOGEN 2 WIRE DEUTSCH 12V-20W	
													*		01-06835771_5	ASSEMBLY / 52 HALOGEN 2 WIRE DEUTSCH 14V-35W	
													*		01-06835772_2	ASSEMBLY / 52 HALOGEN 2 WIRE 2 POS AMP 28V-35W	
													*		01-06835772_3	ASSEMBLY / 52 HALOGEN 2 WIRE 2 POS AMP 12V-27H	
													*		01-06835772_4	ASSEMBLY / 52 HALOGEN 2 WIRE 2 POS AMP 12V-20W	
													*		01-06835773_B	ASSEMBLY / 52 HALOGEN 3 WIRE 3 POS AMP 12.8V-14V 27/12W	
													*		01-06835774_B	ASSEMBLY / 52 HALOGEN 3 WIRE DEUTSCH 12.8V-14V 27/12W	
2	2	2	2	2	2	2	2	2	2	2	2	2	2	1		SCREW / #6 X 1/2" PPH THREAD FORMING	
-	-	-	-	-	-	-	-	-	-	-	-	-	-	1	2	02-0383577-00	SUB-ASSEMBLY / 52 HALOGEN 2 WIRE 3 POS AMP 12V-35H
-	-	-	-	-	-	-	-	-	-	-	-	-	-	1	3	02-0383577-02	SUB-ASSEMBLY / 52 HALOGEN 2 WIRE 3 POS AMP 28V-35W
-	-	-	-	-	-	-	-	-	-	-	-	-	-	1	4	02-0383577-10	SUB-ASSEMBLY / 52 HALOGEN 2 WIRE DEUTSCH 12V-35H
-	-	-	-	-	-	-	-	-	-	-	-	-	-	1	5	02-0383577-12	SUB-ASSEMBLY / 52 HALOGEN 2 WIRE DEUTSCH 28V-35W
-	-	-	-	-	-	-	-	-	-	-	-	-	-	1	6	02-0383577-13	SUB-ASSEMBLY / 52 HALOGEN 2 WIRE DEUTSCH 12V-27H
-	-	-	-	-	-	-	-	-	-	-	-	-	-	1	7	02-0383577-14	SUB-ASSEMBLY / 52 HALOGEN 2 WIRE DEUTSCH 12V-20W
-	-	-	-	-	-	-	-	-	-	-	-	-	-	1	8	02-0383577-15	SUB-ASSEMBLY / 52 HALOGEN 2 WIRE DEUTSCH 14V-35W
-	-	-	-	-	-	-	-	-	-	-	-	-	-	1	9	02-0383577-22	SUB-ASSEMBLY / 52 HALOGEN 2 WIRE 2 POS AMP 28V-35W
-	-	-	-	-	-	-	-	-	-	-	-	-	-	1	10	02-0383577-23	SUB-ASSEMBLY / 52 HALOGEN 2 WIRE 2 POS AMP 12V-27H
-	-	-	-	-	-	-	-	-	-	-	-	-	-	1	11	02-0383577-24	SUB-ASSEMBLY / 52 HALOGEN 2 WIRE 2 POS AMP 12V-20W
-	-	-	-	-	-	-	-	-	-	-	-	-	-	1	12	02-0383577-3B	SUB-ASSEMBLY / 52 HALOGEN 3 WIRE 3 POS AMP 12.8V-14V 27/12W
1	-	-	-	-	-	-	-	-	-	-	-	-	-	-	13	02-0383577-4B	SUB-ASSEMBLY / 52 HALOGEN 3 WIRE DEUTSCH 12.8V-14V 27/12W
A/R	A/R	A/R	A/R	A/R	A/R	A/R	A/R	A/R	A/R	A/R	A/R	A/R	A/R	14	68-1963237-10	LENS / MODEL 52 - AMBER	
A/R	A/R	A/R	A/R	A/R	A/R	A/R	A/R	A/R	A/R	A/R	A/R	A/R	A/R	15	68-1963237-20	LENS / MODEL 52 - BLUE	
A/R	A/R	A/R	A/R	A/R	A/R	A/R	A/R	A/R	A/R	A/R	A/R	A/R	A/R	16	68-1963237-30	LENS / MODEL 52 - CLEAR	
A/R	A/R	A/R	A/R	A/R	A/R	A/R	A/R	A/R	A/R	A/R	A/R	A/R	A/R	17	68-1963237-40	LENS / MODEL 52 - GREEN	
A/R	A/R	A/R	A/R	A/R	A/R	A/R	A/R	A/R	A/R	A/R	A/R	A/R	A/R	18	68-1963237-50	LENS / MODEL 52 - RED	

**ORDERING INFORMATION:**

**EXAMPLE OF PART NUMBER**  
0 1 - 0 6 8 3 5 7 7 -

T BULB WATTAGE  
 T LENS COLOR  
 T CONNECTOR

**BULB WATTAGE**  
 0 = 12V-35H  
 2 = 28V-35W  
 3 = 12V-27H  
 4 = 12V-20W  
 5 = 14V-35W  
 B = 12.8V/14V-27/12 WATT

**LENS COLOR**  
 A = AMBER  
 B = BLUE  
 C = CLEAR  
 G = GREEN  
 R = RED

**CONNECTOR**  
 0 = 2 WIRE 3 POS AMP  
 1 = 2 WIRE 3 POS DEUTSCH  
 3 = 3 WIRE 3 POS AMP  
 4 = 3 WIRE 3 POS DEUTSCH

**IMPORTANT:** When replacing a halogen bulb, always be sure to replace it with one of the exact same specifications.

**MOUNTING KITS**

QTY.	QTY.	ITEM	PART NUMBER	DESCRIPTION
*	-	-	01-0463308-01	GROMMET MOUNT KIT / MODEL 500 SERIES / CHROME
*	-	-	01-0463308-00	GROMMET MOUNT KIT / MODEL 500 SERIES / BLACK
1	-	19	11-763226-000	FLANGE / MODEL 500 SERIES / BLACK
-	1	20	11-763226-001	FLANGE / MODEL 500 SERIES / CHROME
1	1	21	07-563241-000	ADAPTER / D.O.T. / MODEL 500 SERIES
1	1	22	21-0064188-00	GROMMET
2	2	-		SCREW / #10 X 3/4" PPHSMS

QTY.	QTY.	ITEM	PART NUMBER	DESCRIPTION
*	-	-	01-0463297-01	FLANGE MOUNT KIT / MODEL 500 SERIES / CHROME
*	-	-	01-0463297-00	FLANGE MOUNT KIT / MODEL 500 SERIES / BLACK
1	-	23	11-763226-000	FLANGE / MODEL 500 SERIES / BLACK
-	1	24	11-763226-001	FLANGE / MODEL 500 SERIES / CHROME
1	1	25	38-0461299-00	GASKET
2	2	-		SCREW / #10 X 3/4" PPHSMS

**MOUNTING CONFIGURATION for GROMMET MOUNT**

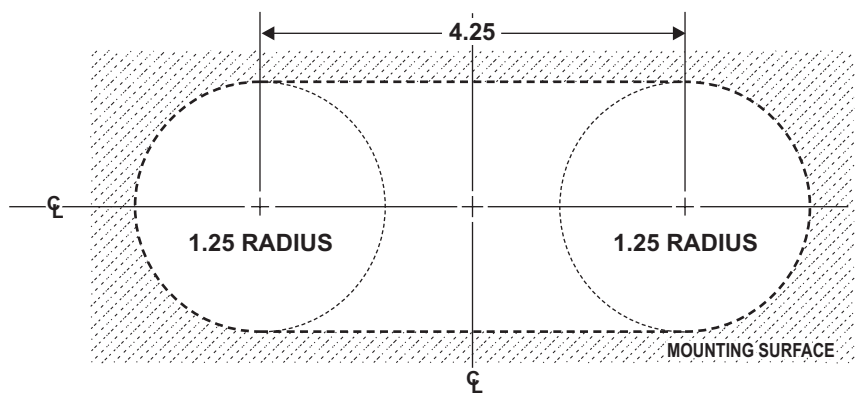

**MOUNTING CONFIGURATION for FLANGE MOUNT**

