

ROUTE 145, WINTHROP ROAD
CHESTER, CONNECTICUT 06412-0684
TELEPHONE: (860) 526-9504
FAX: (860) 526-4078

Installation:

NOTE: There are two ways to mount the 835 lighthouse, each offering its own benefits:

- Secured to the vehicle using the supplied sheet metal screws.
- Secured to the vehicle using an industry-strength, double-sided adhesive tape, like Scotch[™] brand VHB[™] model 4956 foam tape.

This manual will outline the first procedure:

1. Remove the lenses and position the reflector assembly on its mounting location. Make sure the lighthouse will not interfere with any existing equipment. Also be aware of all items on the opposite side of the mounting surface to prevent any possible damage to existing components.
2. With the reflector assembly positioned on the mounting location, temporarily secure it to the surface with masking tape. Be sure the reflector assembly is FLAT against the surface.

3. Mark the 4 mounting holes and the 1 wire access holes using the reflector as a template. (See below)

4. Now remove the reflector and drill the mounting holes with an appropriately sized drill.

5. It is a good idea to deburr the wire holes and install a rubber grommet (customer supplied) to protect the wires.

WARNING: All customer supplied wires that connect to the positive (+) terminal of the battery, must be sized to supply at least 125% of the maximum operating current, and fused "at the battery" to carry that load.

6. Wire the light using the wiring diagram on the next page.

7. Mount lenses onto reflector and secure with supplied lens screws. **NOTE:** When mounting the lenses make sure the drain hole is on the bottom.

IMPORTANT: The outer surfaces of this product may be cleaned with mild soap and water. Use of any other chemicals may void product warranty. Do not use a pressure washer.

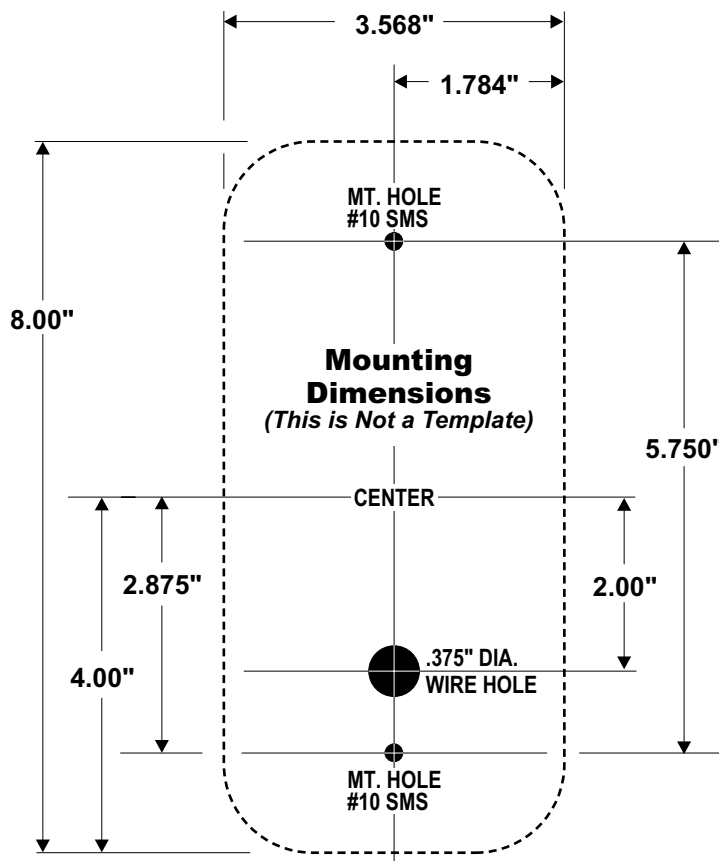

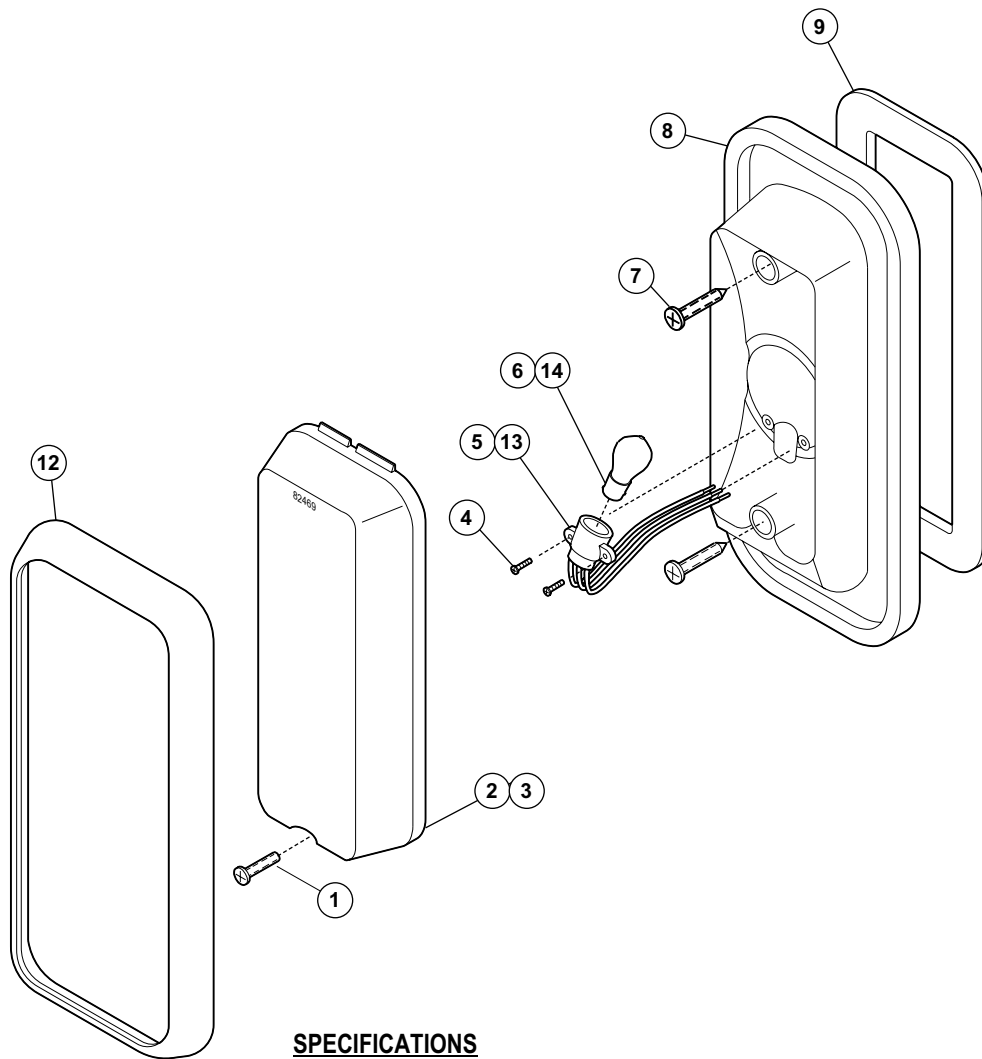

SPECIFICATIONS

INPUT VOLTAGE: 13.5VDC +/- 20%
 INPUT CURRENT: @12.8VDC - 3.9 AMPS

MODEL 830 SERIES FLUSH MOUNT LIGHTHEAD / DUAL FILAMENT

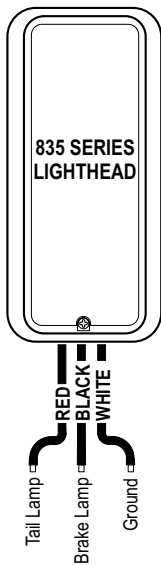

QTY.	ITEM	PART NUMBER	DESCRIPTION
*		01-0662393()	MODEL 830 SERIES ASSEMBLY
1	1	14-082216-080	8-32 X 1/2 PPHMS SS
A/R	2	68-1182469-10	LENS / AMBER
A/R	3	68-1182469-50	LENS / RED
2	4	15-065419-070	#6x7/16" PPH PLASTI-LOK
A/R	5	33-0042149-00	DUAL FILAMENT LAMPHOLDER ASSEMBLY
A/R	6	34-0062389-00	LAMP ASSY / 12.8V-14V, 27/12 WATT
2	7	15-101416-160	#10 x 1" PPHSMS
1	8	68-5982541-02	DIRECTIONAL REFLECTOR / METAL with SEAL
1	9	38-0262283-00	REFLECTOR GASKET
A/R	10	66-0422788-03	VHB 3" TAPE
A/R	11	66-0422788-04	VHB 4" TAPE
A/R	12	11-783522-002	FLANGE COVER
A/R	13	33-0042822-00	LAMPHOLDER ASSY / BAYONET DUAL FILAMENT
A/R	14	34-0021562-00	LAMP / STOP-TAIL-TURN #1157

PART NUMBER KEY:
 BASIC P/N LAMP COLOR FLANGE

01-0662393

LAMP: - = SNAP-IN
 1 = BAYONET
 FLANGE: 0 = without CHROME COVER
 1 = with CHROME COVER
 COLOR: A = AMBER
 R = RED