

## ***Safety First!***

This document provides all the necessary information to allow your Whelen product to be properly and safely installed. Before beginning the installation and/or operation of your new product, the installation technician and operator must read this manual completely. Important information is contained herein that could prevent serious injury or damage.

- ***Proper installation of this product requires the installer to have a good understanding of automotive electronics, systems and procedures.***
- ***If mounting this product requires drilling holes into the vehicle, the installer MUST be sure that no vehicle components or other vital parts could be damaged by the drilling process. Check both sides of the mounting surface before drilling begins. If this product is mounted using Velcro or other adhesive, the mounting surface must be thoroughly cleaned and free from grease, oil, dirt, dust and moisture.***
- ***Do not install this product or route any wires in the deployment area of your air bag. Equipment mounted or located in the air bag deployment area will damage or reduce the effectiveness of the air bag, or become a projectile that could cause serious personal injury or death. Refer to your vehicle owners manual for the air bag deployment area. The User/Installer assumes full responsibility to determine proper mounting location, based on providing ultimate safety to all passengers inside the vehicle.***
- ***For this product to operate at optimum efficiency, a good electrical connection to chassis ground must be made. The recommended procedure requires the product ground wire to be connected directly to the NEGATIVE (-) battery post.***
- ***If this product uses a remote device to activate or control this product, make sure that this control is located in an area that allows both the vehicle and the control to be operated safely in any driving condition.***
- ***Do not attempt to activate or control this device in a hazardous driving situation.***
- ***If this product contains strobe light(s), halogen light(s) or high-intensity LEDs, do not stare directly into these lights at a close distance. Momentary blindness and/or eye damage could result.***
- ***Inspect and operate this product regularly to confirm its proper operation and mounting condition.***
- ***It is recommended that these instructions be stored in a safe place and referred to when performing maintenance and/or reinstallation of this product.***
- ***FAILURE TO FOLLOW THESE SAFETY PRECAUTIONS AND INSTRUCTIONS COULD RESULT IN DAMAGE TO THE PRODUCT OR VEHICLE AND/OR SERIOUS INJURY TO YOU AND YOUR PASSENGERS!***

Whelen Engineering Co. Inc.  
Route 145, Winthrop Road  
Chester, Connecticut 06412 - 0684  
[www.whelen.com](http://www.whelen.com)

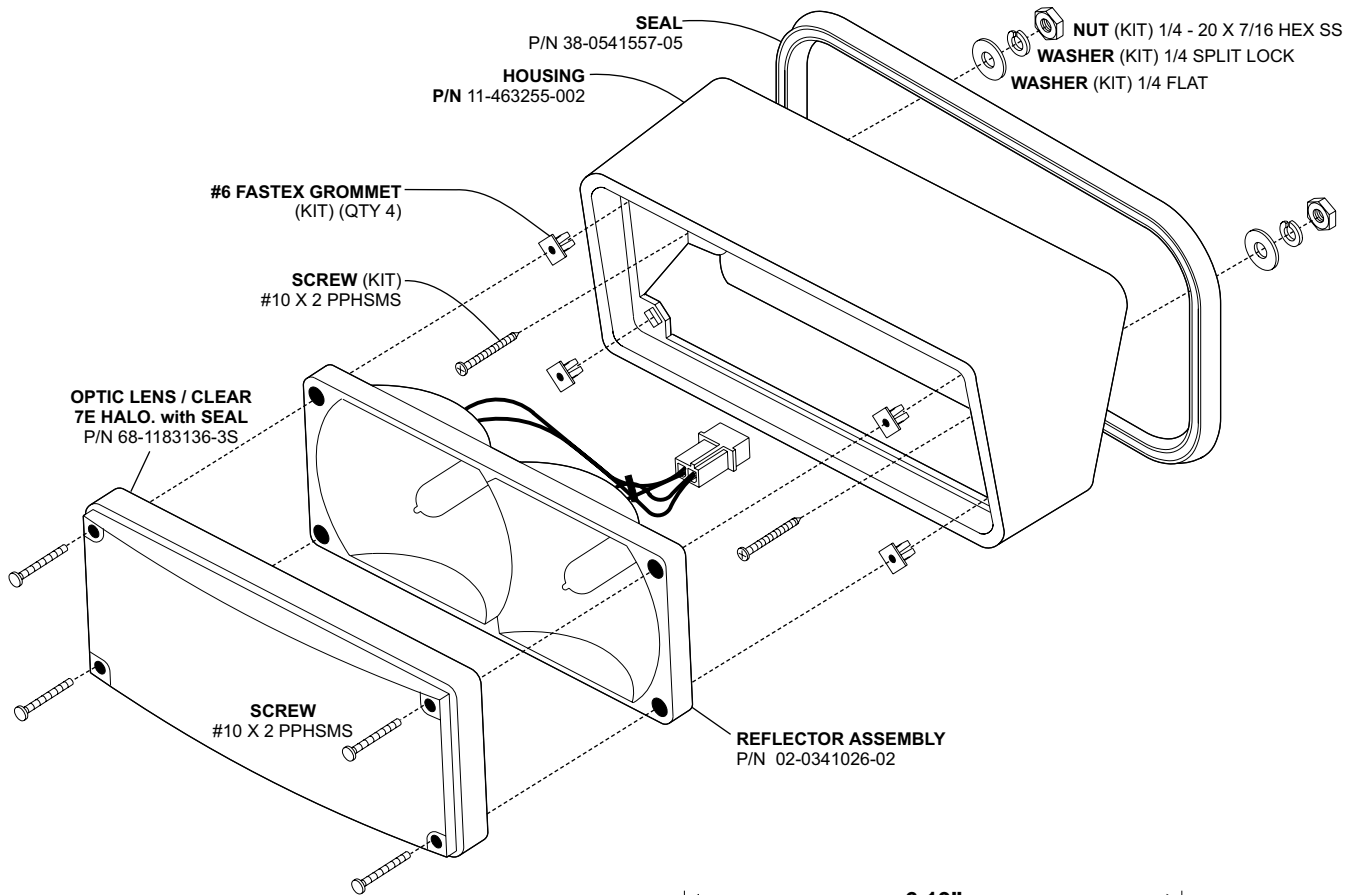

**Installation:** Check to make sure that no vehicle components will interfere with the selected mounting location of this unit.

**CAUTION:** Mounting will require drilling. It is absolutely necessary to make sure that no other vehicle components will be damaged in the process. Check both sides of the mounting surface before starting and if damage is possible, select a new mounting location.

1. Mark the 2 mounting holes off onto the mounting surface using the measurements supplied or using the lighthouse housing as a template. **NOTE:** You will need to cut the mounting gasket enclosed as shown, for it to fit onto this cast flange.

2. Drill the mounting holes in the areas scribed in step 1. The diameter of these holes will be determined by the size of the mounting hardware (#10 X 2 PPHSMS) and the thickness of the mounting surface.

3. Mount the light as shown above, then run the wire to your power source (12 volt) and connect the lighthouse to power.

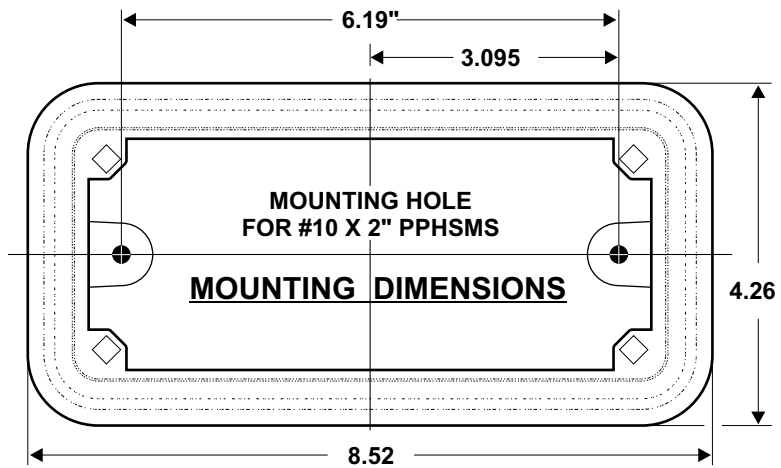

**FIG. 1** You must cut the inner lip of the mounting gasket so it will fit over the two mounting tabs on the cast housing. Be careful not to cut the outer lip or the gasket will leak.

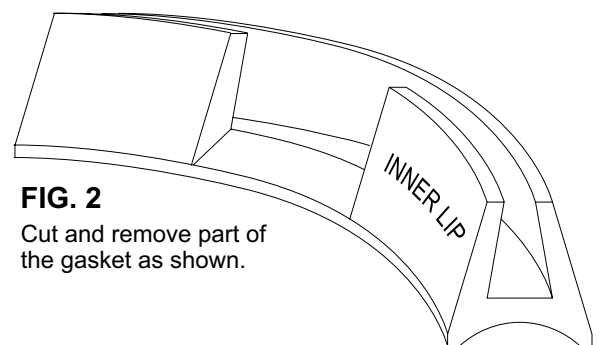
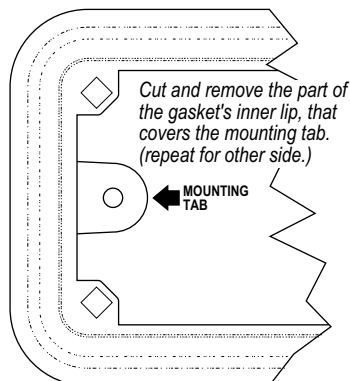

**FIG. 2** Cut and remove part of the gasket as shown.