

WHELEN[®]

ENGINEERING COMPANY INC.

Route 145, Winthrop Road,
Chester, Connecticut 06412

Phone: (860) 526-9504

Fax: (860) 526-4078

Internet: www.whelen.com

Sales e-mail: autosale@whelen.com

Canadian Sales e-mail: autocan@whelen.com

Customer Service e-mail: custserv@whelen.com

Grille-Master™ Swivel Bracket for 4E/43-series Lighthoods Models 4EGRILP (polished chrome finish) 4EGRILB (black finish)

Safety First

This document provides all the necessary information to allow your Whelen product to be properly and safely installed. Before beginning the installation and/or operation of your new product, the installation technician and operator must read this manual completely. Important information is contained herein that could prevent serious injury or damage.

- **Proper installation of this product requires the installer to have a good understanding of automotive electronics, systems and procedures.**
- **If mounting this product requires drilling holes, the installer MUST be sure that no vehicle components or other vital parts could be damaged by the drilling process. Check both sides of the mounting surface before drilling begins. Also de-burr any holes and remove any metal shards or remnants. Install grommets into all wire passage holes.**
- **If this product is mounted with tape or Velcro™, clean the mounting surface with a 50/50 mix of isopropyl (rubbing) alcohol and water and dry thoroughly.**
- **Do not install this product or route any wires in the deployment area of your air bag. Equipment mounted or located in the air bag deployment area will damage or reduce the effectiveness of the air bag, or become a projectile that could cause serious personal injury or death. Refer to your vehicle owners manual for the air bag deployment area. The User/Installer assumes full responsibility to determine proper mounting location, based on providing ultimate safety to all passengers inside the vehicle.**
- **For this product to operate at optimum efficiency, a good electrical connection to chassis ground must be made. The recommended procedure requires the product ground wire to be connected directly to the NEGATIVE (-) battery post.**
- **If this product uses a remote device to activate or control this product, make sure that this control is located in an area that allows both the vehicle and the control to be operated safely in any driving condition.**
- **Do not attempt to activate or control this device in a hazardous driving situation.**
- **This product contains either strobe light(s), halogen light(s), high-intensity LED's or a combination of these lights. Do not stare directly into these lights. Momentary blindness and/or eye damage could result.**
- **Use only soap and water to clean any outer lens. Use of other chemicals could result in premature lens cracking (crazing) and discoloration. Lens' in this condition have significantly reduced effectiveness and should be replaced immediately. Inspect and operate this product regularly to confirm its proper operation and mounting condition.**
- **It is recommended that these instructions be stored in a safe place and referred to when performing maintenance and/or reinstallation of this product.**
- **FAILURE TO FOLLOW THESE SAFETY PRECAUTIONS AND INSTRUCTIONS COULD RESULT IN DAMAGE TO THE PRODUCT OR VEHICLE AND/OR SERIOUS INJURY TO YOU AND YOUR PASSENGERS!**

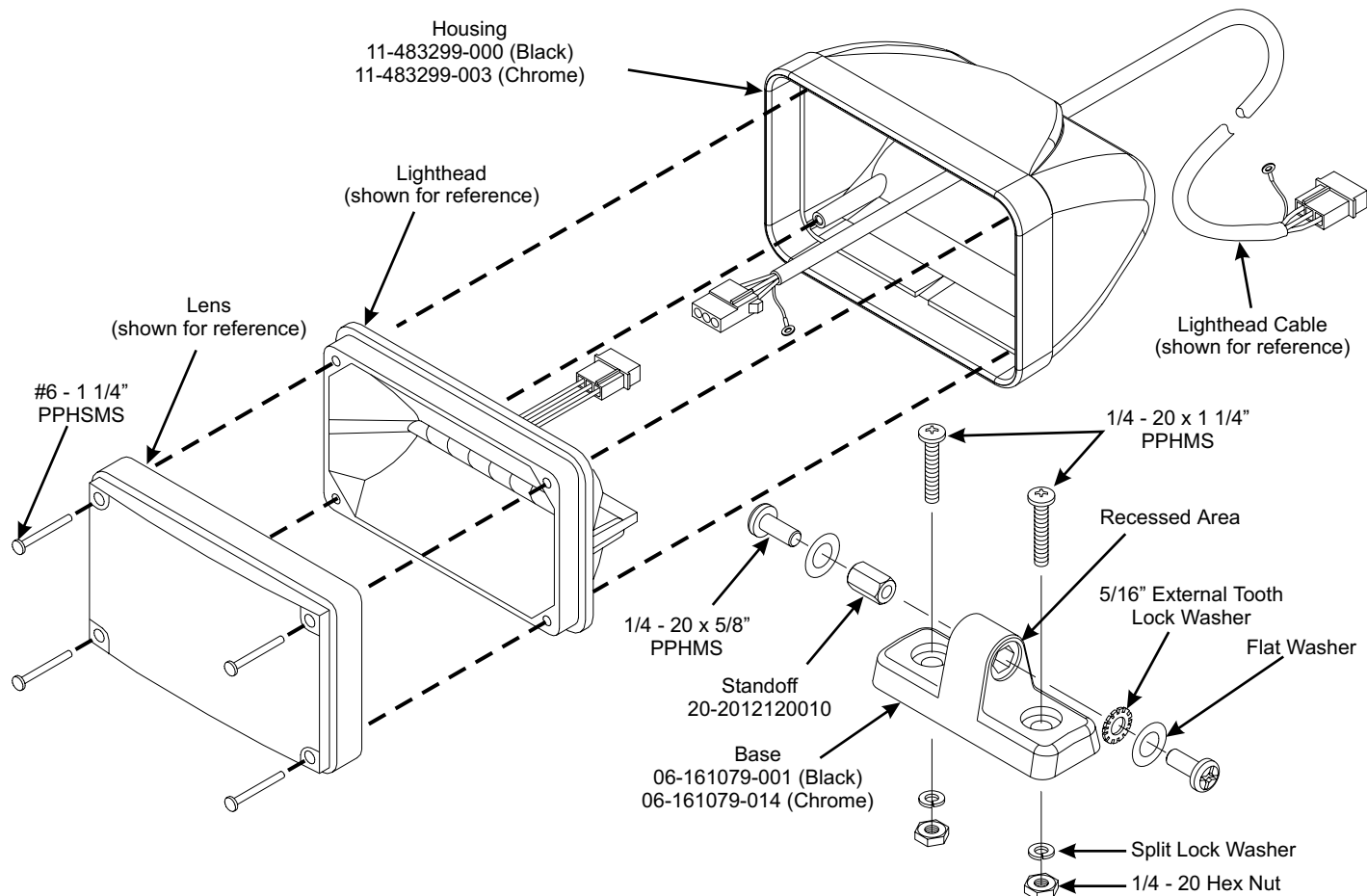

Installation

1. Position the base on the desired mounting surface (see other page for mounting guidelines).
2. Using the base as a template, mark the mounting surface with a suitable tool where the two mounting holes are to be drilled. Remove the base and drill 2, appropriately sized clearance holes for the mounting bolts .
3. Route the "socketed" end of your lighthouse cable from your power supply to the lighthouse mounting location. **Make sure that this cable is not connected to any power source!**
4. Locate the housing. Insert the cable wires into the lighthouse housing through the opening in the rear of the housing.
5. Insert the "socketed" wire terminals into the proper connector using the information provided with the cable. Plug this connector into the lighthouse connector. Using the #6 - 20 x 1 1/4" sheet metal screws included with your swivel mount kit, install the lighthouse into the housing. Do not allow any excess cable to remain in the housing cavity.
6. Insert the standoff into the base as shown. Position the external tooth lock washer into the recessed side of the base. Position the housing so that its mounting flanges straddle the base without disturbing the external tooth lock washer. Install a flat washer onto both 1/4-20 x 5/8" machine screws. Thread each of these into either end of the standoff until they lightly bottom out. Do not tighten these yet.
7. Return the Lighthouse/Housing/Base assembly to its mounting location and secure firmly as shown using the supplied hardware. It will be necessary to rotate the housing so that its aim is perpendicular to the mounting surface in order to install the mounting bolts into the base.
8. With the base secured firmly to the mounting surface, aim the housing in the desired direction and firmly tighten the hardware at the "swivel" point.
9. Connect the lighthouse cable to its power source and test for proper operation.