

WHELEN[®]

ENGINEERING COMPANY INC.

51 Winthrop Road
Chester, Connecticut 06412-0684
Phone: (860) 526-9504
Fax: (860) 526-4078
Internet: www.whelen.com
Sales e-mail: autosale@whelen.com
Canadian Sales e-mail: autocan@whelen.com
Customer Service e-mail: custserv@whelen.com

Installation Guide: 600 Series Strobe Lighthouse

Safety First

This document provides all the necessary information to allow your Whelen product to be properly and safely installed. Before beginning the installation and/or operation of your new product, the installation technician and operator must read this manual completely. Important information is contained herein that could prevent serious injury or damage.

- **Proper installation of this product requires the installer to have a good understanding of automotive electronics, systems and procedures.**
- **If mounting this product requires drilling holes, the installer MUST be sure that no vehicle components or other vital parts could be damaged by the drilling process. Check both sides of the mounting surface before drilling begins. Also de-burr any holes and remove any metal shards or remnants. Install grommets into all wire passage holes.**
- **If this manual states that this product may be mounted with suction cups, magnets, tape or Velcro[®], clean the mounting surface with a 50/50 mix of isopropyl alcohol and water and dry thoroughly.**
- **Do not install this product or route any wires in the deployment area of your air bag. Equipment mounted or located in the air bag deployment area will damage or reduce the effectiveness of the air bag, or become a projectile that could cause serious personal injury or death. Refer to your vehicle owner's manual for the air bag deployment area. The User/Installer assumes full responsibility to determine proper mounting location, based on providing ultimate safety to all passengers inside the vehicle.**
- **For this product to operate at optimum efficiency, a good electrical connection to chassis ground must be made. The recommended procedure requires the product ground wire to be connected directly to the NEGATIVE (-) battery post.**
- **If this product uses a remote device to activate or control this product, make sure that this control is located in an area that allows both the vehicle and the control to be operated safely in any driving condition.**
- **Do not attempt to activate or control this device in a hazardous driving situation.**
- **This product contains either strobe light(s), halogen light(s), high-intensity LEDs or a combination of these lights. Do not stare directly into these lights. Momentary blindness and/or eye damage could result.**
- **Use only soap and water to clean the outer lens. Use of other chemicals could result in premature lens cracking (crazing) and discoloration. Lenses in this condition have significantly reduced effectiveness and should be replaced immediately. Inspect and operate this product regularly to confirm its proper operation and mounting condition. Do not use a pressure washer to clean this product.**
- **It is recommended that these instructions be stored in a safe place and referred to when performing maintenance and/or reinstallation of this product.**
- **FAILURE TO FOLLOW THESE SAFETY PRECAUTIONS AND INSTRUCTIONS COULD RESULT IN DAMAGE TO THE PRODUCT OR VEHICLE AND/OR SERIOUS INJURY TO YOU AND YOUR PASSENGERS!**

For warranty information regarding this product, visit www.whelen.com/warranty

Installation:

WARNING! All customer supplied wires that connect to the positive terminal of the battery must be sized to supply at least 125% of the maximum operating current and FUSED at the battery to carry that load. **DO NOT USE CIRCUIT BREAKERS WITH THIS PRODUCT!**

WARNING! The strobe light power supply is a high voltage device. Do not touch or remove the strobe tube assembly while in operation. Wait 10 minutes after disconnecting the unit from its power source before starting any work or trouble shooting.

1. First check behind the proposed mounting area. Note that the mounting surface must be flat. There must be at least 2" clearance behind the lighthouse.
2. Using the measurements supplied, mark the locations for the mounting holes and lighthouse cut-out hole onto the mounting surface. Be sure to double-check all your measurements before cutting or drilling.
3. Drill the four .250" mounting holes for the screw grommet flange then cut the lighthouse cut-out hole as indicated.
4. Connect the wires to your Strobe Power Supply (refer to your power supply manual for wiring information). Be sure to test for proper operation of your lighthouse prior to use.

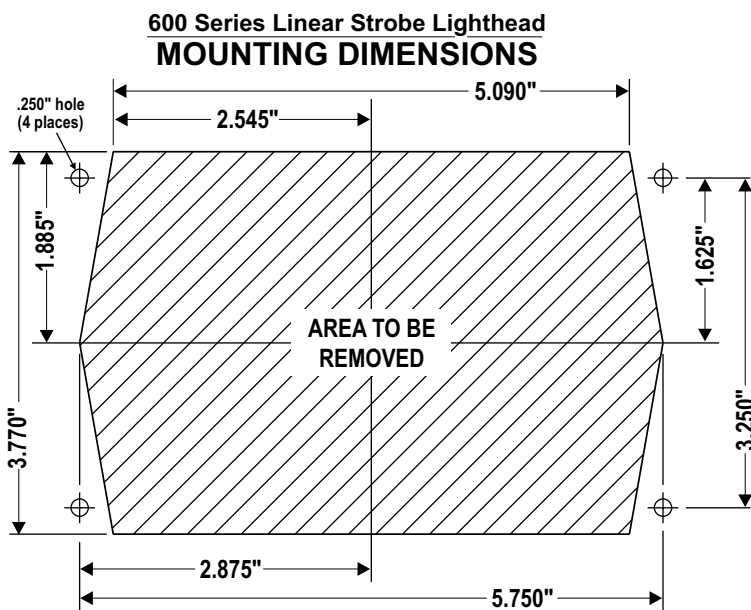
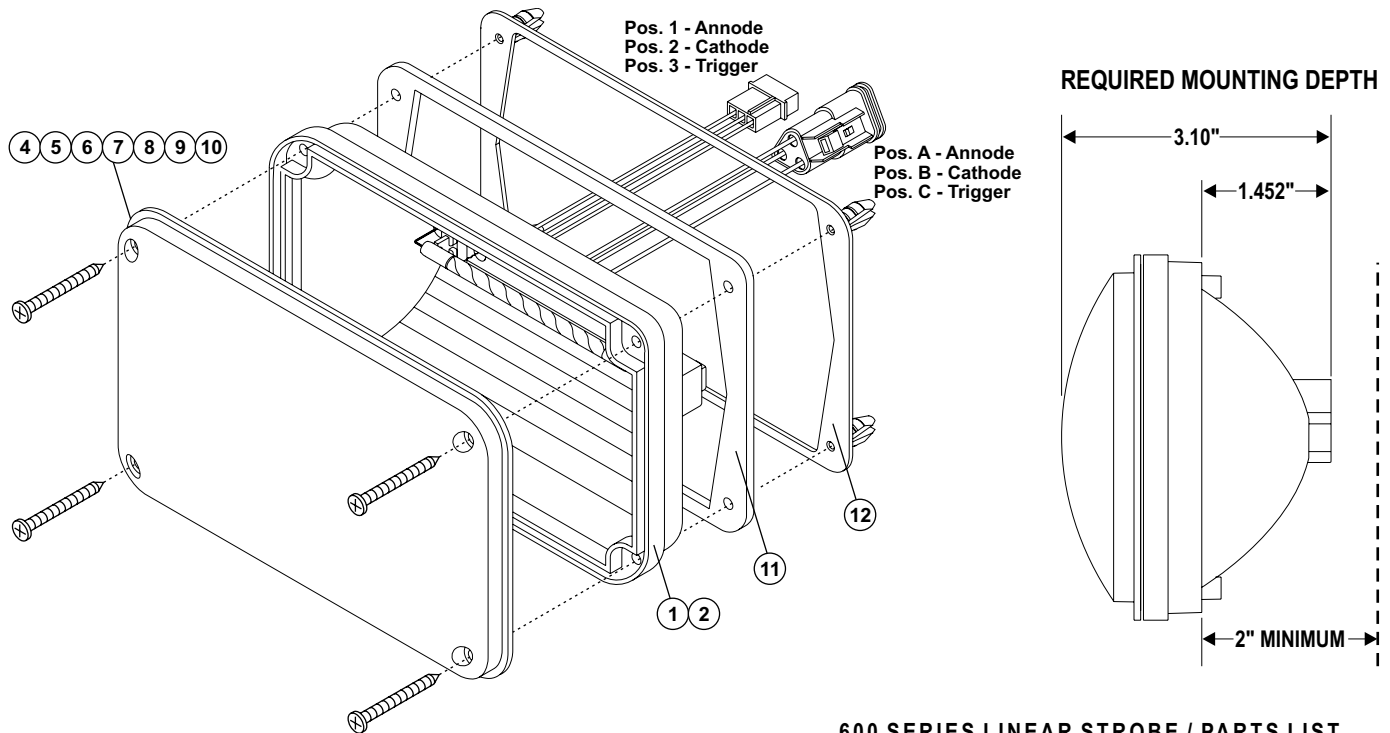

600 SERIES LINEAR STROBE / PARTS LIST

QTY	ITEM	PART NUMBER	DESCRIPTION
*		01-0663415-()	REFLECTOR ASSEMBLY
A/R	1	02-0363173-00	600 LINEAR STROBE / AMP CONN
A/R	2	02-0363173-01	600 LINEAR STROBE / DEUTSCH CONN
4	3	15-061416-280	SCREW / #6 X 1-3/4" PPHSMS
A/R	4	68-3183587-10	LENS / MODEL 600 / AMBER
A/R	5	68-3183587-20	LENS / MODEL 600 / BLUE
A/R	6	68-3183587-30	LENS / MODEL 600 / CLEAR
A/R	7	68-3183587-40	LENS / MODEL 600 / GREEN
A/R	8	68-3183587-50	LENS / MODEL 600 / RED
A/R	9	68-3183587E50	LENS / MODEL 600 / KKKE-SPEC RED
A/R	10	02-0363416-()	LENS / SPLIT / 600
1	11	38-0242717-00	GASKET
1	12	11-76D258-000	SCREW GROMMET FLANGE

PART NUMBER KEY:

BASIC P/N COLOR CONNECTOR
01-0663415-[-]

COLOR: R = RED
B = BLUE
G = GREEN
A = AMBER
C = CLEAR
* = SPLIT
5 = KKKE-SPEC RED
CONNECTOR: 0 = AMP CONNECTOR
1 = DEUTSCH CONNECTOR