

WHELEN[®]

ENGINEERING COMPANY INC.

Route 145, Winthrop Road,

Chester, Connecticut 06412

Phone: (860) 526-9504

Fax: (860) 526-4078

Internet: www.whelen.com

Sales e-mail: autosale@whelen.com

Canadian Sales e-mail: autocan@whelen.com

Customer Service e-mail: custserv@whelen.com

Installation Guide: Model RB6PAPS Rotating Beacon

Safety First

This document provides all the necessary information to allow your Whelen product to be properly and safely installed. Before beginning the installation and/or operation of your new product, the installation technician and operator must read this manual completely. Important information is contained herein that could prevent serious injury or damage.

- **Proper installation of this product requires the installer to have a good understanding of automotive electronics, systems and procedures.**
- **If mounting this product requires drilling holes, the installer MUST be sure that no vehicle components or other vital parts could be damaged by the drilling process. Check both sides of the mounting surface before drilling begins. Also de-burr the holes and remove any metal shards or remnants. Install grommets into all wire passage holes.**
- **If this product is mounted with tape or Velcro™, clean the mounting surface with a 50/50 mix of isopropyl alcohol and water and dry thoroughly.**
- **Do not install this product or route any wires in the deployment area of your air bag. Equipment mounted or located in the air bag deployment area will damage or reduce the effectiveness of the air bag, or become a projectile that could cause serious personal injury or death. Refer to your vehicle owners manual for the air bag deployment area. The User/Installer assumes full responsibility to determine proper mounting location, based on providing ultimate safety to all passengers inside the vehicle.**
- **For this product to operate at optimum efficiency, a good electrical connection to chassis ground must be made. The recommended procedure requires the product ground wire to be connected directly to the NEGATIVE (-) battery post (this does not include products that use cigar power cords).**
- **If this product uses a remote device for activation or control, make sure that this device is located in an area that allows both the vehicle and the device to be operated safely in any driving condition.**
- **Do not attempt to activate or control this device in a hazardous driving situation.**
- **This product contains either strobe light(s), halogen light(s), high-intensity LED's or a combination of these lights. Do not stare directly into these lights. Momentary blindness and/or eye damage could result.**
- **Use only soap and water to clean the outer lens. Use of other chemicals could result in premature lens cracking (crazing) and discoloration. Lens' in this condition have significantly reduced effectiveness and should be replaced immediately. Inspect and operate this product regularly to confirm its proper operation and mounting condition. Do not use a pressure washer to clean this product.**
- **It is recommended that these instructions be stored in a safe place and referred to when performing maintenance and/or reinstallation of this product.**
- **FAILURE TO FOLLOW THESE SAFETY PRECAUTIONS AND INSTRUCTIONS COULD RESULT IN DAMAGE TO THE PRODUCT OR VEHICLE AND/OR SERIOUS INJURY TO YOU AND YOUR PASSENGERS!**

The **RB6 Series Beacon** may be mounted 4 ways. It is designed for a normal dome-up position. If mounted inverted, seal the wire exit hole and any mounting holes with silicone seal. A magnet or mirror mount kit is also available for purchase separately.

IMPORTANT: This beacon takes either a 35 or 50 watt replacement bulb. Always use a bulb with the same specifications as the one you are replacing. **FUSING:** If your beacon has a 35 watt bulb, fuse the RED wire at 5 amps. If your beacon has a 50 watt bulb, fuse the RED wire at 7.5 amps.

CAUTION: This unit is polarity sensitive!

WARNING! All customer supplied wires that connect to the positive terminal of the battery, must be sized to supply at least 125% of the maximum operating current and be fused at the battery to carry that load.

1" N.P.T. Pipe Mount:

1. Feed the beacon wires through the pipe and extend the RED wire to +12VDC (See "fusing") and the BLACK wire to chassis ground.

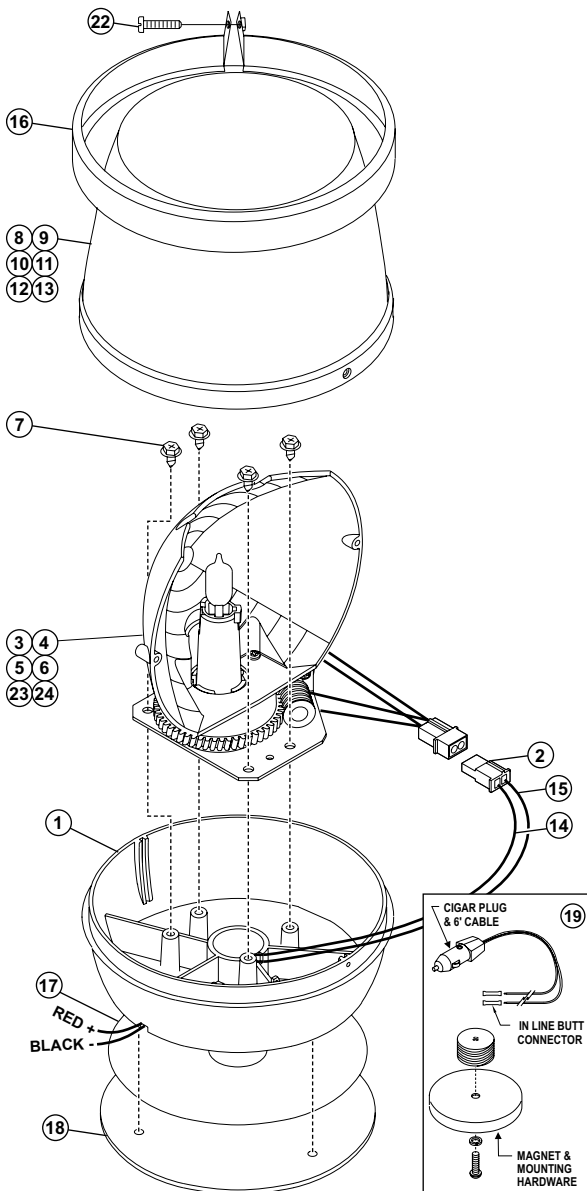

2. Screw the beacon onto the pipe, being careful not to pinch or strain the wires. Hand tighten the unit onto the pipe.

Permanent Surface Mount:

1. Remove the clamp ring securing the dome to the base and remove the dome.
2. Locate the 3 mounting hole indentations on the inside bottom of the base and drill 3 openings for the mounting screws (customer supplied).
3. Using the base as a template, mark the location of the 3 mounting holes and wire access hole onto the mounting surface.
4. Drill the 3 mounting holes (Size the drill bit based on mounting hardware and thickness of the mounting surface).
5. Drill the wire access hole using a 1/4" drill bit. Deburr the wire access hole and install a rubber grommet (customer supplied) to protect the wires.
6. Feed the wires through the wire access hole in the mounting gasket and the mounting surface.
7. Align the mounting holes in the base, gasket, and mounting surface and secure the base with the sheet metal screws.
8. Extend the RED wire to +12VDC (See "fusing") and the BLACK wire to a chassis ground (-).

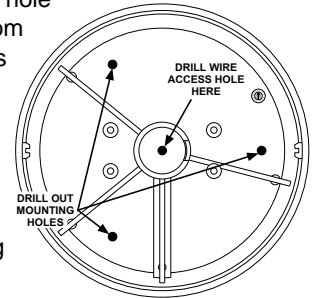

QTY	QTY	QTY	QTY	QTY	QTY	ITEM	PART NUMBER	DESCRIPTION
				*			01-06837681	FINAL ASSY. / 14 VOLT / 50W 150
				*			01-06837682	FINAL ASSY. / 28 VOLT / 35W 150
				*			01-06837683	FINAL ASSY. / 14 VOLT / 50W 175
		*					01-06837684	FINAL ASSY. / 28 VOLT / 35W 175
	*						01-06837685	FINAL ASSY. / 14 VOLT / 50W 64
*							01-06837686	FINAL ASSY. / 28 VOLT / 35W 64
1	1	1	1	1	1	1	11-381574-000	BASE / HOUSING
1	1	1	1	1	1	2	39-0402023-04	2 POS SOCKET HOUSING
-	-	-	-	-	1	3	02-0363445-00	ASSY / ROTATING MECHANISM 150-12-50
-	-	-	-	1	-	4	02-0363445-02	ASSY / ROTATING MECHANISM 150-24-35
-	-	-	1	-	-	5	02-0363445-01	ASSY / ROTATING MECHANISM 175-12-50
-	-	1	-	-	-	6	02-0363445-03	ASSY / ROTATING MECHANISM 175-24-35
4	4	4	4	4	4	7	15-081916-066	SCREW / 8 X 3/8 PHEXWASHHD SS
A/R	A/R	A/R	A/R	A/R	A/R	8	68-4161381-10	LENS / AMBER
A/R	A/R	A/R	A/R	A/R	A/R	9	68-4161381-20	LENS / BLUE
A/R	A/R	A/R	A/R	A/R	A/R	10	68-4161381-30	LENS / CLEAR
A/R	A/R	A/R	A/R	A/R	A/R	11	68-4161381-40	LENS / GREEN
A/R	A/R	A/R	A/R	A/R	A/R	12	68-4161381-50	LENS / RED
A/R	A/R	A/R	A/R	A/R	A/R	13	68-4161381-V0	LENS / VIOLET
1	1	1	1	1	1	14	67-1021600120	WIRE / 16 GA 12" BLK 61117-1 SKT/STRIP
1	1	1	1	1	1	15	67-1021622120	WIRE / 16 GA 12" RED 61117-1 SKT/STRIP
1	1	1	1	1	1	16	19-261465-000	CLAMP RING
1	1	1	1	1	1	17	38-0141549-00	BASE DECAL
1	1	1	1	1	1	18	38-0241504-00	GASKET
A/R	A/R	A/R	A/R	A/R	A/R	19	01-2861506-00	MAGNET MOUNT KIT (not shown)
A/R	A/R	A/R	A/R	A/R	A/R	20	01-2861522-00	MIRROR MOUNT KIT (not shown)
3	3	3	3	3	3	21	15-101416-100	#10 X 5/8" P.P.H. SHEET METAL SCREW
1	1	1	1	1	1	22	15-101416-120	#10 X 3/4" PPHSMS TYPE A SCREW
-	1	-	-	-	-	23	02-0363445-04	ROTATING MECHANISM 64-12-50
1	-	-	-	-	-	24	02-0363445-05	ROTATING MECHANISM 64-24-35

PART NUMBER KEY: BASIC NUMBER VOLTAGE COLOR BASE

1 = 14V 50W / 150 4 = 28V 35W / 175
 2 = 28V 35W / 150 5 = 14V 50W / 64
 3 = 14V 50W / 175 6 = 28V 35W / 64

COLOR: R = RED A = AMBER B = BLUE C = CLEAR G = GREEN V = VIOLET

BASE: S = STANDARD M = MAGNET R = MIRROR

01 - 2483768