

WHELEN[®]

ENGINEERING COMPANY INC.

Route 145, Winthrop Road,

Chester, Connecticut 06412

Phone: (860) 526-9504

Fax: (860) 526-4078

Internet: www.whelen.com

Sales e-mail: autosale@whelen.com

Canadian Sales e-mail: autocan@whelen.com

Customer Service e-mail: custserv@whelen.com

Installation Guide: Harley Davidson 5 LED Power Box and Lighthead System

Safety First

This document provides all the necessary information to allow your Whelen product to be properly and safely installed. Before beginning the installation and/or operation of your new product, the installation technician and operator must read this manual completely. Important information is contained herein that could prevent serious injury or damage.

- **Proper installation of this product requires the installer to have a good understanding of automotive electronics, systems and procedures.**
- **If mounting this product requires drilling holes, the installer MUST be sure that no vehicle components or other vital parts could be damaged by the drilling process. Check both sides of the mounting surface before drilling begins. Also de-burr the holes and remove any metal shards or remnants. Install grommets into all wire passage holes.**
- **If this product is mounted with tape or Velcro™, clean the mounting surface with a 50/50 mix of isopropyl alcohol and water and dry thoroughly.**
- **Do not install this product or route any wires in the deployment area of your air bag. Equipment mounted or located in the air bag deployment area will damage or reduce the effectiveness of the air bag, or become a projectile that could cause serious personal injury or death. Refer to your vehicle owners manual for the air bag deployment area. The User/Installer assumes full responsibility to determine proper mounting location, based on providing ultimate safety to all passengers inside the vehicle.**
- **For this product to operate at optimum efficiency, a good electrical connection to chassis ground must be made. The recommended procedure requires the product ground wire to be connected directly to the NEGATIVE (-) battery post.**
- **If this product uses a remote device to activate or control this product, make sure that this control is located in an area that allows both the vehicle and the control to be operated safely in any driving condition.**
- **Do not attempt to activate or control this device in a hazardous driving situation.**
- **If this product contains strobe light(s), halogen light(s) or high-intensity LEDs, do not stare directly into these lights at a close distance. Momentary blindness and/or eye damage could result.**
- **If this product contains strobe light(s), halogen light(s) or high-intensity LEDs, use only soap and water to clean the lamp lens. Use of other chemicals could result in premature lens cracking (crazing) and discoloration. Lenses in this condition have significantly reduced effectiveness and should be replaced immediately. Inspect and operate this product regularly to confirm its proper operation and mounting condition. Do not use a pressure washer to clean this product.**
- **It is recommended that these instructions be stored in a safe place and referred to when performing maintenance and/or reinstallation of this product.**
- **FAILURE TO FOLLOW THESE SAFETY PRECAUTIONS AND INSTRUCTIONS COULD RESULT IN DAMAGE TO THE PRODUCT OR VEHICLE AND/OR SERIOUS INJURY TO YOU AND YOUR PASSENGERS!**

This Harley Davidson LED lighting system is designed for easy installation and replacement of some of your existing motorcycle lights. The 4" round lightheads will replace the existing front spots. The two 500 Series TIR Lightheads will mount to your front fenders. The power box is equipped with one 500 Series Brake-Tail-Turn lighthead and four 400 Series Split linear LED lightheads. It is also equipped with an internal battery charger with an external charging outlet.

Mounting:

1. Locate the luggage rack directly behind the motorcycle seat and place the box onto the rack exactly where it will be mounted.
2. Mark the location of the six .281" mounting holes off onto the luggage rack. To locate the holes, you may either use the holes drilled in the box as a template or use the measurements shown below.
3. Remove box (if present) and drill six .281" mounting holes.

Note: Your luggage rack may already have the correct mounting holes drilled. Check the measurements below and if these holes already exist at the proper distance, remove any existing mounting hardware from the holes and secure the box with the supplied mounting hardware.

4. Place the box into its mounting position on the deck and secure it with the supplied mounting hardware as shown in the diagram.

Wiring:

This product is shipped with the box completely wired. With the exception of the Brake-Tail-Turn lighthead installed in the cover of the box (which you will connect as shown) the only wiring you will have to do is for the front lightheads and to connect to power. Hook-up of an optional customer supplied battery is shown. This optional battery should not be needed because of the lower current required with LED's.

In the front: the two 4" Round lightheads will replace your two front spotlights and the two 500 Series TIR flashers will mount to the front fenders (always follow vehicle specifications). The individual lighthead manuals supplied, will show you operation and flash pattern selection (if available with the lighthead).

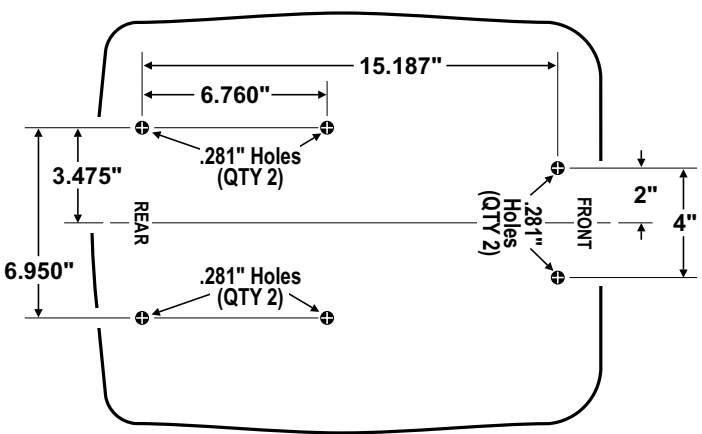
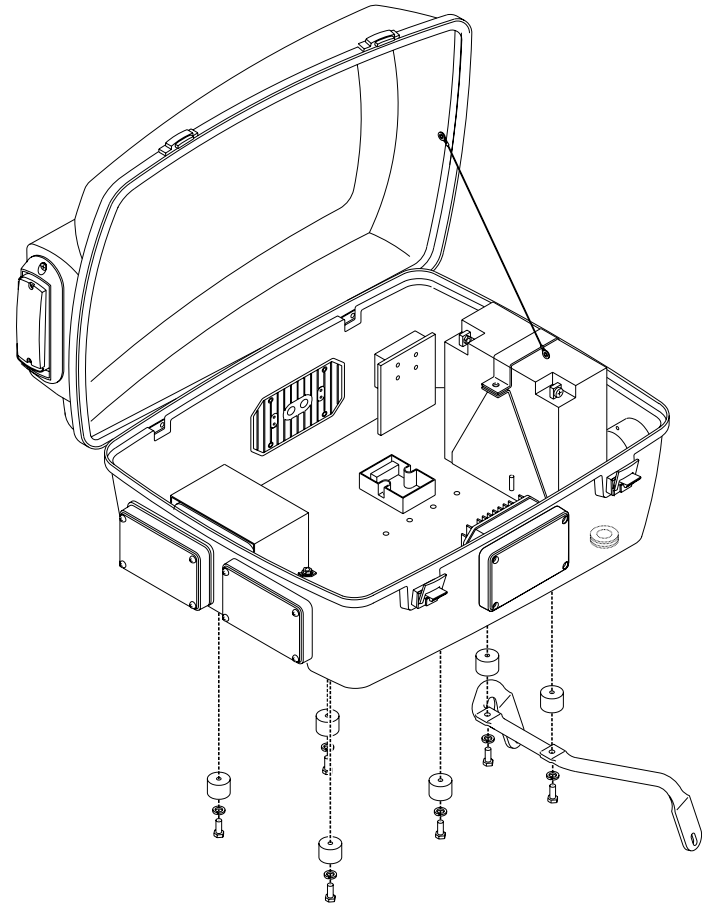

Mounting Configuration

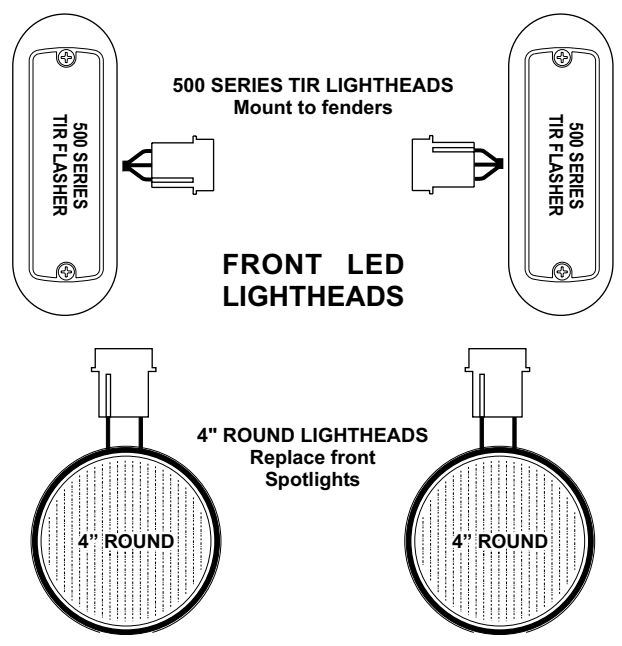

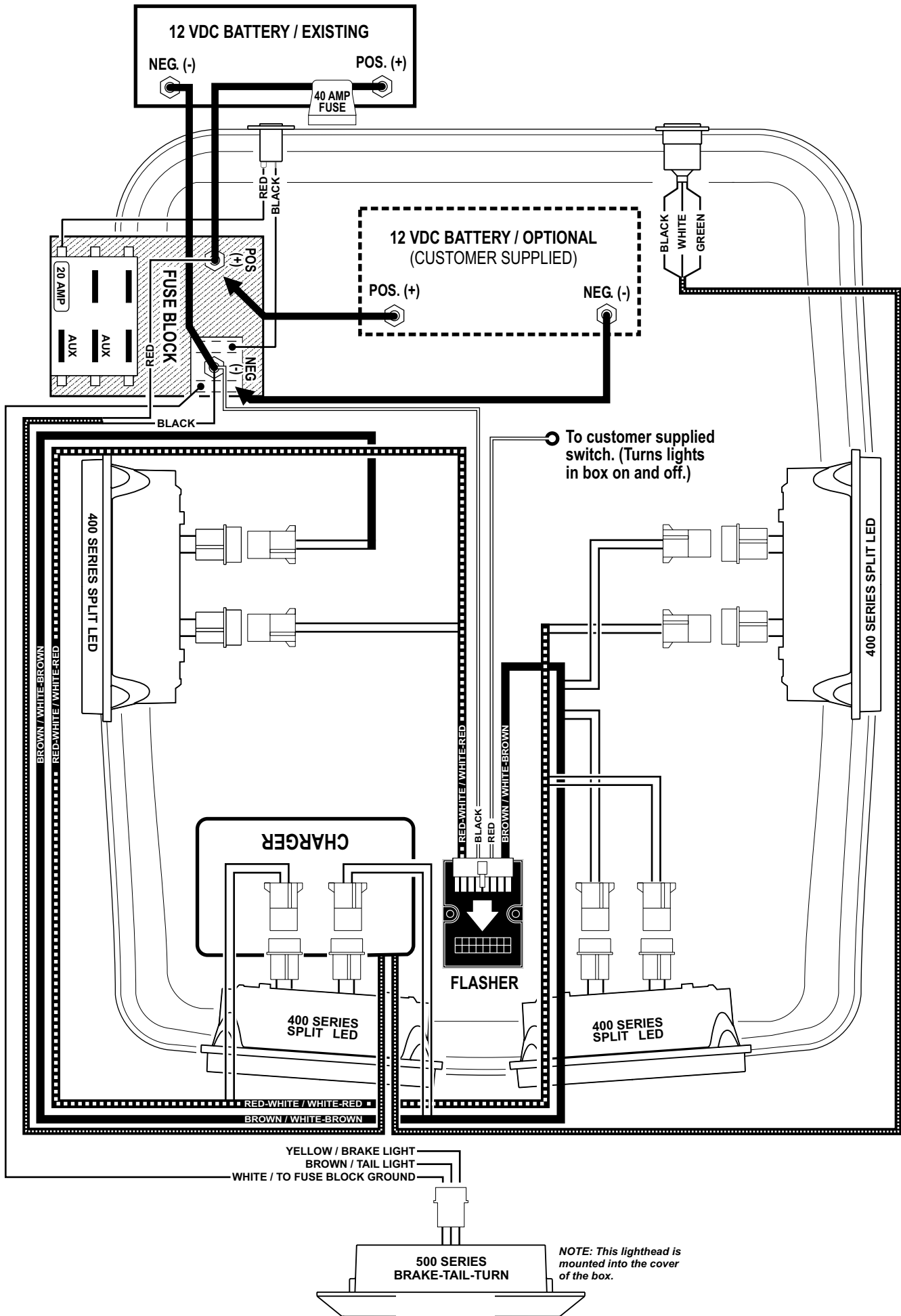

| QTY | QTY/ITEM | PART NUMBER | DESCRIPTION |
|-----|----------|----------------|--|
| * | | 01-0684021-00 | HOUSING LED LINEAR BOX1-1/4"BLACK |
| * | | 01-0684021-01 | HOUSING LED LINEAR BOX1-1/4"BIROCH WHITE |
| 1 | 1 | 02-0363754-00 | POWER SUPPLY ASSY |
| 1 | 2 | 33-17216156-0 | FUSE PANEL |
| 2 | 3 | 16-1011320-20 | #10 INTERNAL TOOTH LOCKWASHER |
| 4 | 4 | 14-104216-160 | #10-24 X 1" PPHMS SS |
| 1 | 5 | 11-482476-000 | HOUSING1-1/4"BATTERY TRAY |
| 1 | 6 | 44-0612016359 | BATTERY1-1/4"12V1-1/4"OTORCYCLE |
| 1 | 7 | 19-362202-000 | CLAMP1-1/4"BATTERY STRAP |
| 10 | 8 | 16-1321560-02 | 1/4" LOCKWASHER |
| 6 | 9 | 14-130436-120 | 1/4-20 X 3/4" HEX HEAD MACH. SCREW |
| 2 | 10 | 14-130436-160 | 1/4-20 X 1" HEX HEAD MACH. SCREW |
| 2 | 11 | 14-082116-100 | #8-32 X 5/8" PPHMS |
| 1 | 12 | 35-0722220-07 | RECEPTICAL 12VDC |
| 2 | 13 | 13-104111-063 | #10-24 WIZ LOCKNUT |
| 3 | 14 | 14-062216-100 | #6-32 X 5/8" PPHMS |
| 1 | 15 | 35-01113110-07 | INLET 120VAC |
| 3 | 16 | 13-062111-053 | #6-32 X 5/16" WIZ LOCNUT |
| 1 | 17 | 21-11324004-0 | 1-1/4" GROMMET |
| - | 18 | 02-0382811-04 | HOUSING ASSY with EXTRA LG HOLES / BLACK |
| 1 | 19 | 38-0241390-00 | GASKET |
| 1 | 20 | 11-763226-000 | FLANGE / BLACK |
| 1 | 21 | 02-0383558BR3 | SUB ASSY / 500 LED FLANGED B-T-T / MAX / RED 3 POS AMP |
| 6 | 22 | 08-1316323-00 | 1" SHOCK MOUNT / FEMALE-FEMALE |
| 1 | 23 | 07-282369-000 | BRACKET |
| 1 | 24 | 46-0763756-00 | HARNES |

| QTY | QTY/ITEM | PART NUMBER | DESCRIPTION |
|-----|----------|---------------|---|
| * | | 01-0684021-00 | HOUSING LED LINEAR BOX1-1/4"BLACK |
| * | | 01-0684021-01 | HOUSING LED LINEAR BOX1-1/4"BIROCH WHITE |
| 1 | 25 | 67-1581600060 | ACCESSORY GROUND WIRE ASSY. |
| 1 | 26 | 67-1C10822100 | POWER JUMPER WIRE ASSY. / +RED |
| 1 | 27 | 67-1581622060 | ACCESSORY POWER WIRE ASSY. |
| 1 | 28 | 67-1270822720 | POWER CABLE ASSY. |
| 1 | 29 | 02-0242064-00 | POWER FUSE ASSY. |
| 1 | 30 | 67-1C10800100 | GROUND JUMPER WIRE ASSY. -BLACK |
| 12 | 32 | 26-0215001-06 | 6" TY-RAP |
| 2 | 33 | 13-082111-053 | #8-32 WIZ LOCKNUT |
| 1 | 34 | 38-0125020-00 | SPACER / with PSA BACKING |
| 2 | 35 | 14-130436-200 | 1/4 - 20 X 1 1/4 HEX HEAD BOLT |
| 1 | 36 | 02-0382811-05 | HOUSING ASSY with EXTRA LG HOLES / BIROCH WHITE |
| 1 | 37 | 26-0115037-04 | 1/4" CABLE CLAMP |
| 16 | 38 | 13-062120-052 | 6-32 X 5/16 ELASTIC STOP NUT |
| 16 | 39 | 14-062216-200 | #6-32 X 1 1/4 PPHMS |
| 3 | 40 | 25-0710553-05 | PUSH-ON CONN. / FEMALE 18-16 GA. |
| 1 | 41 | 25-0510923-14 | #8 AWG BUTT CONN. |
| 2 | 42 | 25-0116920-03 | 1/4" #8 AWG RING LUG |
| 4 | 43 | 02-0363722225 | SUB ASSY /400 LED SPLIT BLUE-RED 2 POS AMP |
| 4 | 44 | 68-3183725-3S | LENS / NON OPTIC - CLEAR with SEAL |
| A/R | A/R | 45 | ANTENNA KIT |
| 7 | 46 | 07-514464-000 | CLIP / 021-0375 DEK |
| 2 | 47 | 14-082216-100 | #8-32 X 5/8 PPHMS |
| 1 | 48 | 01-0269642-00 | FLASHER |

