

WHELEN[®]

ENGINEERING COMPANY INC.

51 Winthrop Road
Chester, Connecticut 06412-0684
Phone: (860) 526-9504
Fax: (860) 526-4078
Internet: www.whelen.com
Sales e-mail: autosale@whelen.com
Canadian Sales e-mail: autocan@whelen.com
Customer Service e-mail: custserv@whelen.com

Installation Guide: Perm / Pipe Mount Kit with Branch Guard For L31 and L32 Series Beacons

Safety First

This document provides all the necessary information to allow your Whelen product to be properly and safely installed. Before beginning the installation and/or operation of your new product, the installation technician and operator must read this manual completely. Important information is contained herein that could prevent serious injury or damage.

- Proper installation of this product requires the installer to have a good understanding of automotive electronics, systems and procedures.
- If mounting this product requires drilling holes, the installer **MUST** be sure that no vehicle components or other vital parts could be damaged by the drilling process. Check both sides of the mounting surface before drilling begins. Also de-burr the holes and remove any metal shards or remnants. Install grommets into all wire passage holes.
- If this manual states that this product may be mounted with suction cups, magnets, tape or Velcro[®], clean the mounting surface with a 50/50 mix of isopropyl alcohol and water and dry thoroughly.
- Do not install this product or route any wires in the deployment area of your air bag. Equipment mounted or located in the air bag deployment area will damage or reduce the effectiveness of the air bag, or become a projectile that could cause serious personal injury or death. Refer to your vehicle owner's manual for the air bag deployment area. The User/Installer assumes full responsibility to determine proper mounting location, based on providing ultimate safety to all passengers inside the vehicle.
- For this product to operate at optimum efficiency, a good electrical connection to chassis ground must be made. The recommended procedure requires the product ground wire to be connected directly to the **NEGATIVE (-)** battery post (this does not include products that use cigar power cords).
- If this product uses a remote device for activation or control, make sure that this device is located in an area that allows both the vehicle and the device to be operated safely in any driving condition.
- Do not attempt to activate or control this device in a hazardous driving situation.
- This product contains either strobe light(s), halogen light(s), high-intensity LEDs or a combination of these lights. Do not stare directly into these lights. Momentary blindness and/or eye damage could result.
- Use only soap and water to clean the outer lens. Use of other chemicals could result in premature lens cracking (crazing) and discoloration. Lenses in this condition have significantly reduced effectiveness and should be replaced immediately. Inspect and operate this product regularly to confirm its proper operation and mounting condition. Do not use a pressure washer to clean this product.
- It is recommended that these instructions be stored in a safe place and referred to when performing maintenance and/or reinstallation of this product.
- **FAILURE TO FOLLOW THESE SAFETY PRECAUTIONS AND INSTRUCTIONS COULD RESULT IN DAMAGE TO THE PRODUCT OR VEHICLE AND/OR SERIOUS INJURY TO YOU AND YOUR PASSENGERS!**

For warranty information regarding this product, visit www.whelen.com/warranty

Installation: Permanent Mount

1. Remove the mounting gasket from the beacons base (if present) and discard.
2. Install the 3 fin pine tree clips into the drain holes of the beacons base by pushing them firmly into the 3 holes indicated in figure 1.
3. Install the Fastex grommets into the 3, square mounting holes in the bottom of the beacons base (Fig. 1).
4. Secure the base plate to the beacon base by screwing the 3 sheet metal screws into the Fastex grommets you installed in step 3.

NOTE: The way you re-assemble the beacon will determine which way the beacon faces when mounted to the vehicle. Take note in figure 1 as to where the cable exit slot and cage bars should be located when assembled correctly. If assembled improperly, the cage will block the LED display and front and rear flash patterns will be reversed.

5. Place the base plate (with beacon) onto the mounting surface in the exact mounting location and mark the 4 mounting holes off onto the mounting surface.
6. Remove the base plate and drill the 4 mounting holes into the mounting surface using an appropriately sized drill for the #10 X 3/4" sheet metal screws.
7. Place the mounting gasket onto the mounting surface lining up the mounting holes you drilled in step 5 with the holes in the gasket.
8. Place the assembled beacon and base plate onto the mounting surface lining up the mounting holes with the holes in the base plate and secure the beacon to the surface with the #10 X 3/4" sheet metal screws.
9. Insert the cage bars into the base plate as shown and secure them with the set screws.
10. Extend the wires to your power source and refer to the beacons manual for wiring and operation.

Installation: 1" NPT Pipe Mount:

1. Turn the beacon upside-down and remove the base gasket from the base and discard it. Install the Fastex grommets into the 3, square mounting holes in the bottom of the base.

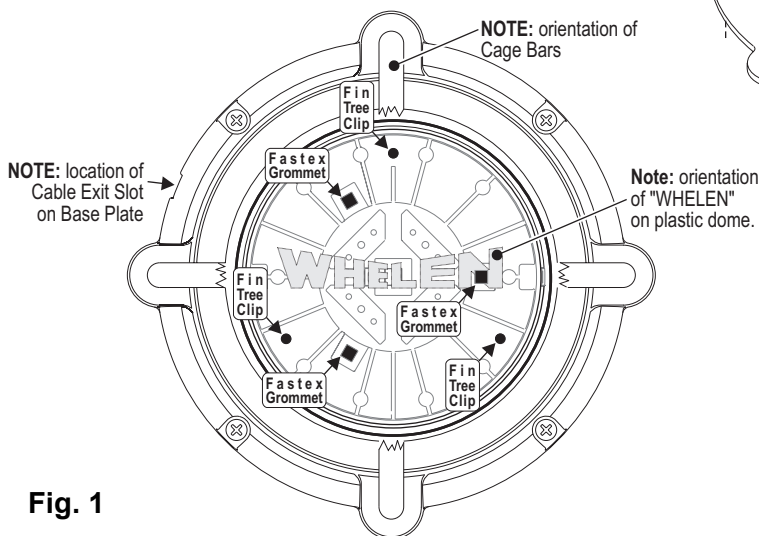
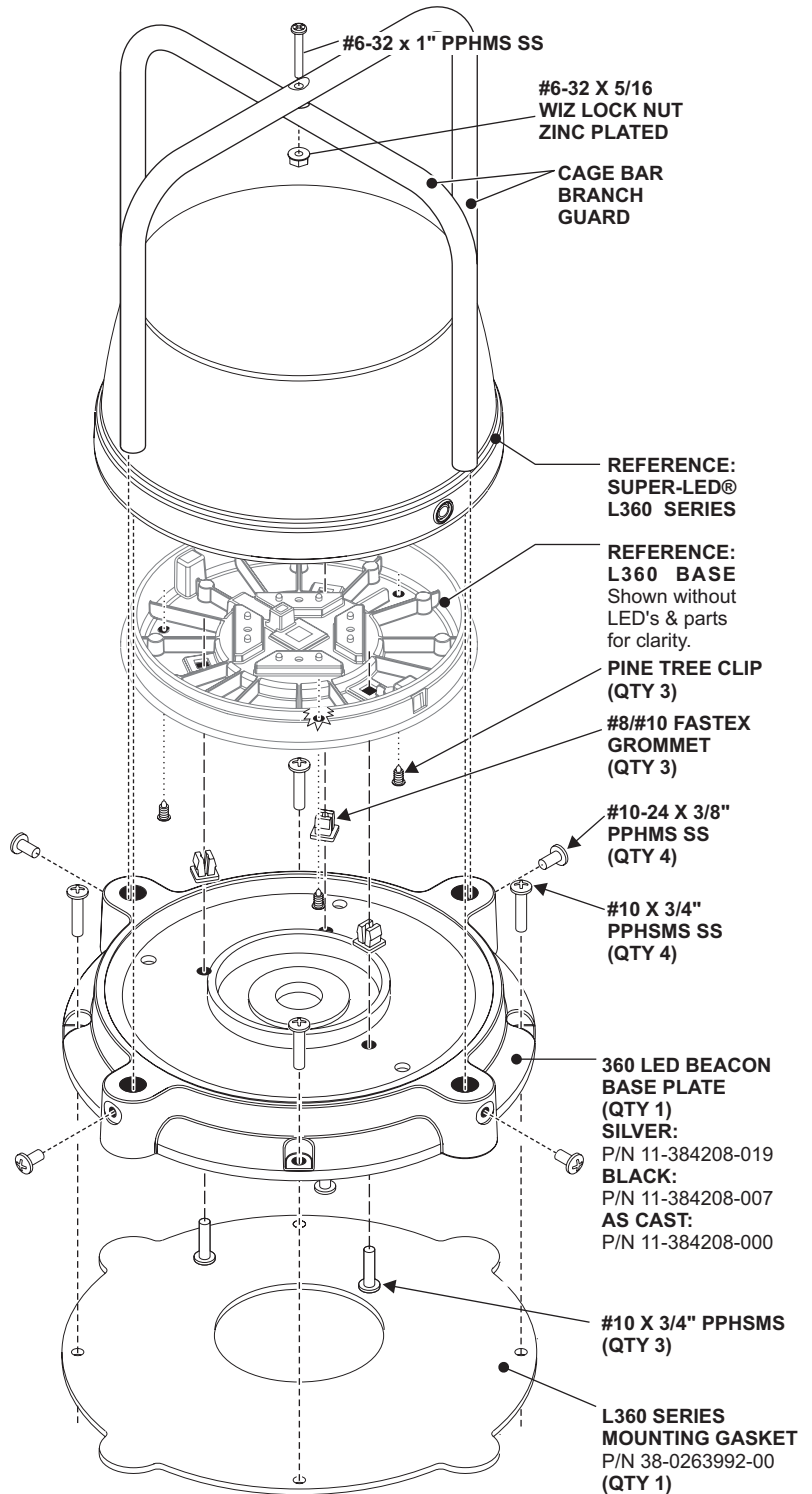

Fig. 1



2. Install the 3 fin pine tree clips into the drain holes of the base by pushing them firmly into the 3 holes (Fig. 1).
3. Feed the beacon wires through the base plate and secure the base plate to the beacon base, by screwing the 3 sheet metal screws into the Fastex grommets you installed in step 3. **(See re-assembly note in step 3 perm. mount)**
4. Feed the beacon wires through the pipe then screw the beacon onto the pipe, being careful not to pinch or strain the wires. *Hand tighten* the unit onto pipe.
5. Extend the wires to your power source and refer to the beacons manual for wiring and operation.