

# WHELEN®

ENGINEERING COMPANY INC.

Route 145, Winthrop Road,  
 Chester, Connecticut 06412  
 Phone: (860) 526-9504  
 Fax: (860) 526-2009  
 Internet: [www.whelen.com](http://www.whelen.com)  
 Sales/Service e-mail: [aviation@whelen.com](mailto:aviation@whelen.com)

## Installation Guide: Models 7097001 (Green) and 7097002 (Red) P/N:01-0770970-01 and 01-0770970-02, LED Forward Position Light for 90159( ) or 90206( )



TSO-C30c  
 TYPE I & II  
 APPROVED



The conditions and tests required for TSO approval of this article are minimum performance standards. It is the responsibility of those installing this article either on or within a specific type or class of aircraft to determine that the aircraft installation conditions are within the TSO standards. TSO articles must have separate approval for installation in aircraft. The article may be installed only if performed under 14 CFR part 43 or the applicable airworthiness requirements.

### OPERATING INSTRUCTIONS:

**Nominal Voltage:** . . . . . 28 VDC  
**Input Current:** . . . . . 0.3 Amps  
**Weight:** . . . . . 0.17 lbs.

**EQUIPMENT LIMITATIONS:** The LED position light is approved as an incandescent lamp replacement module, for installation in Whelen Model 90159( ) or Whelen Model 90206( ).

**CONTINUED AIRWORTHINESS:** The LED position light is designed with 6 LED's. If any one LED fails, the unit must be repaired or replaced. Inspect the lens for excessive scratches or pitting. Replace if necessary.

### Removal Procedure...

1. Remove retainer screws, retainer, lens and gasket from the wingtip assembly. Save these components.
2. Remove and save the two position light retainer screws.
3. Remove the position light retainer, lens, lamp and lens gasket. These items may be saved for use as spares.

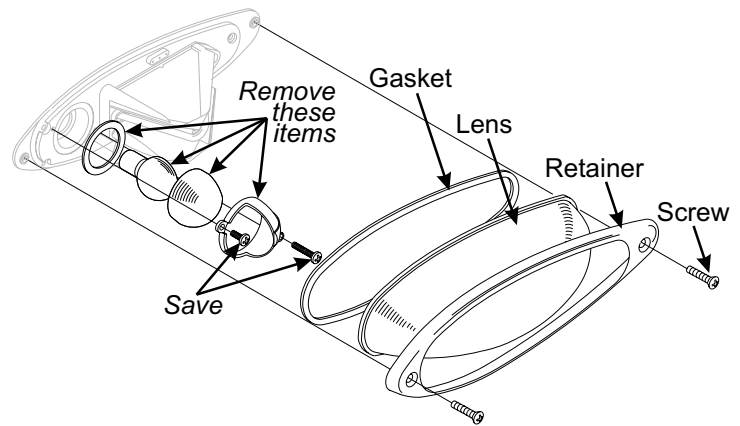

### Replacement Procedure...

1. Insert the LED assembly into the now vacant lamp socket. The contact is 28VDC. The chassis is ground.
2. Secure the 70970 LED assembly using the position light retainer screws from Step 2. Tighten these screws equally to maximum torque value of 13 in./lbs.
3. Reinstall the gasket, lens, retainer and retainer screws in their original location. Tighten these screws equally to maximum torque value of 13 in./lbs.
4. Update aircraft records, complete form 337 and obtain FAA field approval for installation.

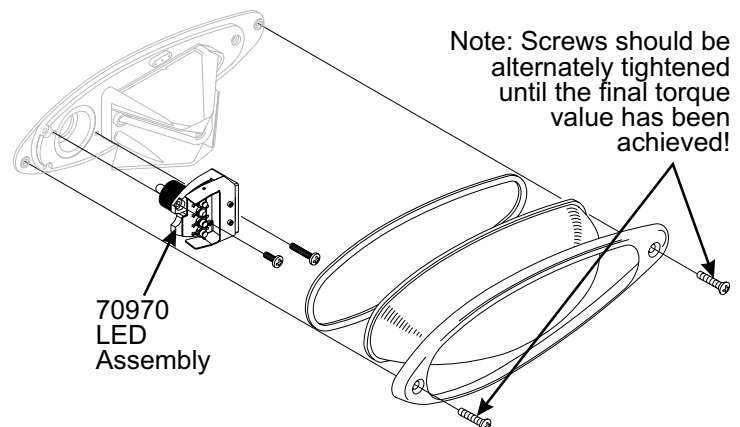

Aviation