

# WHELEN<sup>®</sup>

ENGINEERING COMPANY INC.

Route 145, Winthrop Road,  
Chester, Connecticut 06412  
Phone: (860) 526-9504  
Fax: (860) 526-4078

Internet: [www.whelen.com](http://www.whelen.com)  
Sales e-mail: [autosale@whelen.com](mailto:autosale@whelen.com)  
Canadian Sales e-mail: [autocan@whelen.com](mailto:autocan@whelen.com)  
Customer Service e-mail: [custserv@whelen.com](mailto:custserv@whelen.com)

## Installation Guide: SA314 Mounting Bracket 2005 Ford Escape Hybrid

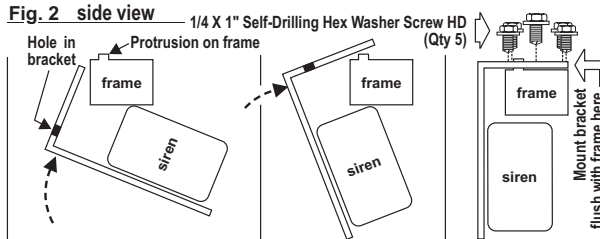
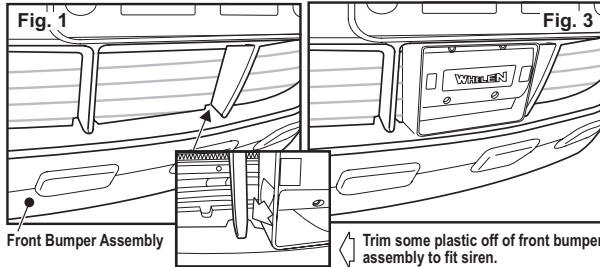

Slip the bracket (with siren attached) onto the frame. The square hole in the top of the bracket will fit over the protrusion in the frame.

### Installation:

1. Mount the siren to the mounting bracket as shown here.
2. Remove the one piece front bumper assembly from the vehicle (Fig. 1). Refer to the factory manual for the removal procedure.
3. Slip the bracket/siren onto the center of the lower frame of the vehicle. There is a square hole in the top of the bracket that fits over a small protrusion on the top of the frame (Fig. 2).
4. Secure the bracket to the frame with the supplied self tapping screws. You will need a drill equipped with a 3/8" socket to drive the screws in. Do not over tighten.
5. Replace the front bumper assembly. You will have to trim some plastic off of the bumper assembly to make the siren fit properly.
6. Extend the WHITE (positive) and BLACK (negative) speaker wires to your siren amplifier and connect as shown in the amplifiers instructions.

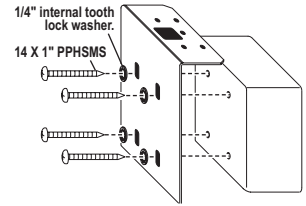

©2005 Whelen Engineering Company Inc.  
Form No. 13970B (050808)

For warranty information regarding this product, visit [www.whelen.com/warranty](http://www.whelen.com/warranty)

# WHELEN<sup>®</sup>

ENGINEERING COMPANY INC.

Route 145, Winthrop Road,  
Chester, Connecticut 06412  
Phone: (860) 526-9504  
Fax: (860) 526-4078

Internet: [www.whelen.com](http://www.whelen.com)  
Sales e-mail: [autosale@whelen.com](mailto:autosale@whelen.com)  
Canadian Sales e-mail: [autocan@whelen.com](mailto:autocan@whelen.com)  
Customer Service e-mail: [custserv@whelen.com](mailto:custserv@whelen.com)

## Installation Guide: SA314 Mounting Bracket 2005 Ford Escape Hybrid

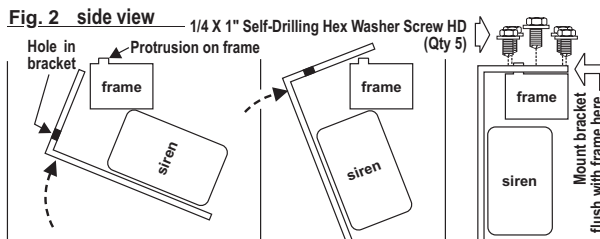
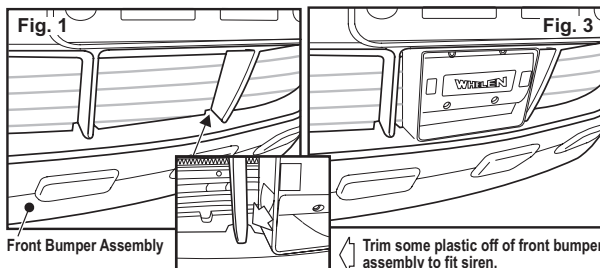

Slip the bracket (with siren attached) onto the frame. The square hole in the top of the bracket will fit over the protrusion in the frame.

### Installation:

1. Mount the siren to the mounting bracket as shown here.
2. Remove the one piece front bumper assembly from the vehicle (Fig. 1). Refer to the factory manual for the removal procedure.
3. Slip the bracket/siren onto the center of the lower frame of the vehicle. There is a square hole in the top of the bracket that fits over a small protrusion on the top of the frame (Fig. 2).
4. Secure the bracket to the frame with the supplied self tapping screws. You will need a drill equipped with a 3/8" socket to drive the screws in. Do not over tighten.
5. Replace the front bumper assembly. You will have to trim some plastic off of the bumper assembly to make the siren fit properly.
6. Extend the WHITE (positive) and BLACK (negative) speaker wires to your siren amplifier and connect as shown in the amplifiers instructions.

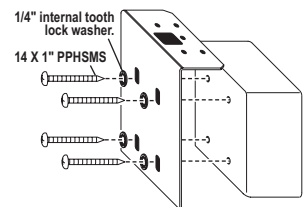

©2005 Whelen Engineering Company Inc.  
Form No. 13970B (050808)

For warranty information regarding this product, visit [www.whelen.com/warranty](http://www.whelen.com/warranty)

**IMPORTANT!** It is the responsibility of the installation technician to make sure that the installation and operation of this product will not interfere with or compromise the operation or efficiency of any vehicle equipment! Before returning the vehicle to active service, visually confirm the proper operation of this product, as well as all vehicle components and equipment.

**DANGER!** Sirens produces extremely loud emergency warning tones! Exposure to these tones without proper and adequate hearing protection, could cause ear damage and/or hearing loss! The Occupational Safety & Health Administration ([www.osha.gov](http://www.osha.gov)) provides information necessary to determine safe exposure times in Occupational Noise Exposure Section 1910.95. Until you have determined the safe exposure times for your specific application, operators and anyone else in the immediate vicinity should be required to wear an approved hearing protection device. **FAILURE TO FOLLOW THIS RECOMMENDATION COULD CAUSE HEARING LOSS!**

<b>ACTIVATION OF THIS SIREN MAY DAMAGE UNPROTECTED EARS!</b>	
 <b>Wear Protection!</b>	<b>! CAUTION</b>
	Loud siren noise can cause hearing damage and/or loss. Refer to OSHA Section 1910.95 prior to putting ANY siren into service!

**IMPORTANT!** It is the responsibility of the installation technician to make sure that the installation and operation of this product will not interfere with or compromise the operation or efficiency of any vehicle equipment! Before returning the vehicle to active service, visually confirm the proper operation of this product, as well as all vehicle components and equipment.

**DANGER!** Sirens produces extremely loud emergency warning tones! Exposure to these tones without proper and adequate hearing protection, could cause ear damage and/or hearing loss! The Occupational Safety & Health Administration ([www.osha.gov](http://www.osha.gov)) provides information necessary to determine safe exposure times in Occupational Noise Exposure Section 1910.95. Until you have determined the safe exposure times for your specific application, operators and anyone else in the immediate vicinity should be required to wear an approved hearing protection device. **FAILURE TO FOLLOW THIS RECOMMENDATION COULD CAUSE HEARING LOSS!**

<b>ACTIVATION OF THIS SIREN MAY DAMAGE UNPROTECTED EARS!</b>	
 <b>Wear Protection!</b>	<b>! CAUTION</b>
	Loud siren noise can cause hearing damage and/or loss. Refer to OSHA Section 1910.95 prior to putting ANY siren into service!