

WHELEN[®]

ENGINEERING COMPANY INC.

Route 145, Winthrop Road,
 Chester, Connecticut 06412
 Phone: (860) 526-9504
 Fax: (860) 526-2009
 Internet: www.whelen.com
 Sales/Service e-mail: aviation@whelen.com



Installation Guide Model 70239() Series Wingtip Strobe Anti-collision/Position Light Assembly



TSO-C30c
 TYPES I & II APPROVED

TSO-C96a
 CLASS II APPROVED

The conditions and tests required for TSO approval of this article are minimum performance standards. It is the responsibility of those installing this article either on or within a specific type or class of aircraft to determine that the aircraft installation conditions are within the TSO standards. TSO articles must have separate approval for installation in aircraft. The article may be installed only if performed under 14 CFR part 43 or the applicable airworthiness requirements.

INSTALLATION: The 70239 Series must be properly mounted to comply with FAR Part 91.205(c-2) & (c-3). The light assembly must be mounted so that the light distribution pattern is not obstructed by any parts of the aircraft. A limited amount of obstruction is permitted (Ref. FAR Part 23.1401 for anti-collision lights, and PAR 23.1387 for position lights).

The baseplate must be mounted parallel to the vertical and horizontal centerlines of the aircraft to project the patterns properly.

CONTINUED AIRWORTHINESS: Inspect the lenses for excessive scratches or pitting. Replace if necessary

MOUNTING...

1. If necessary, fabricate the mounting pattern using dimensions found in fig. 1.
2. Make the necessary wiring connections using 18 gage wire for the position lights, and Whelen 16 gage 3/c cable for the strobe lights. All connections must use FAA approved techniques.
3. Remove the (6-32 x .312) retainer mounting screw and retainer.
4. Attach the base assembly to the wingtip using (3) #6-32 countersunk screws (unit may be sealed around periphery with RTV or equivalent).
5. Re-attach lens retainer.

Fig. 1

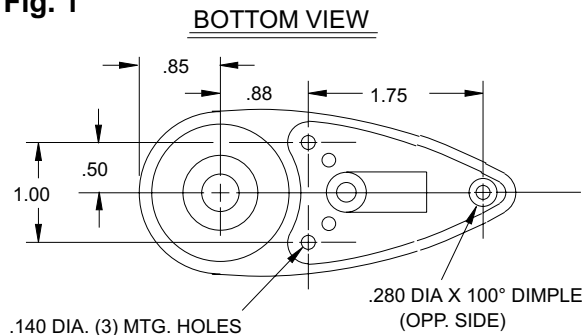

WIRING: The strobe connector should plug into the Whelen 16 gage interconnecting cable, or a Whelen strobe power supply.

Observe the following strobe color coding:

- PIN 1 - RED (Anode)
- PIN 2 - BLACK (Cathode)
- PIN 3 - WHITE (Trigger)

Caution: When pins 1 & 2 or pins 2 & 3 are reversed, the system will appear to operate normally, however this condition will cause premature flash tube failure.

1. Connect the forward position light wires as follows, using 18 gage approved aviation wire or cable:

RED: (+) 28 volts
 BLACK: (-) Ground

Fig. 2

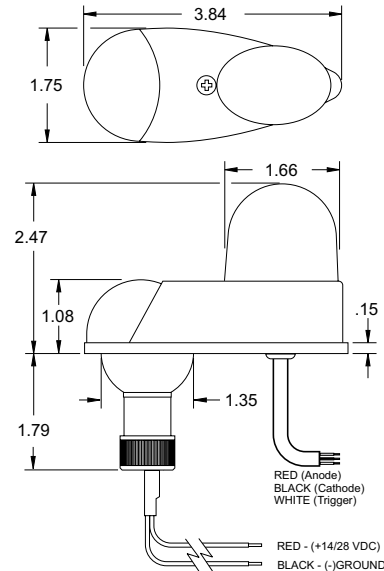

Specifications:

Position Lights -

Current Draw..... 1.0 Amps @ 28 Volts D.C.
 Weight..... 0.6 lbs.

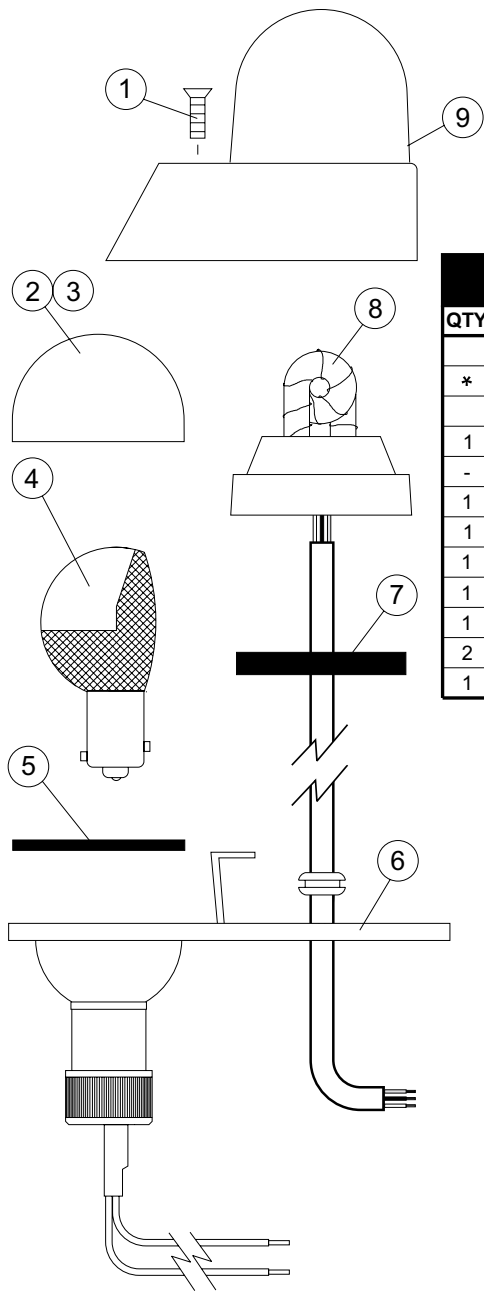

REPLACEMENT PARTS				
QTY	QTY	ITEM	PART NUMBER	DESCRIPTION
	*		01-0770239-05	28V STROBE/POSITION ASSEMBLY (RED)
	*		01-0770239-06	28V STROBE/POSITION ASSEMBLY (GREEN)
1	1	1		#6-32 X 5/16 PHILLIPS FHMS (MS51959-27)
-	1	2	68-4230020-50	LENS, RED
1	-	3	68-4230020-40	LENS, GREEN
1	1	4	34-0428020-65	LAMP, 28V
1	1	5	38-0230021-00	GASKET
1	1	6	02-0350003-02	BASE PLATE ASSEMBLY
1	1	7	38-0130106-00	GASKET, FLASHTUBE
2	2	8	36-0270455-03	FLASH TUBE ASSEMBLY (A610)
1	1	9	02-0350072-35	LENS/RETAINER ASSEMBLY