

WHELEN[®]

ENGINEERING COMPANY INC.

51 Winthrop Road
Chester, Connecticut 06412-0684
Phone: (860) 526-9504
Fax: (860) 526-4078
Internet: www.whelen.com
Sales e-mail: autosale@whelen.com
Canadian Sales e-mail: autocan@whelen.com
Customer Service e-mail: custserv@whelen.com

Installation Guide: Inner Edge[®] Rear Deck Interior Lightbar 2005 Ford Crown Victoria

Safety First

This document provides all the necessary information to allow your Whelen product to be properly and safely installed. Before beginning the installation and/or operation of your new product, the installation technician and operator must read this manual completely. Important information is contained herein that could prevent serious injury or damage.

- **Proper installation of this product requires the installer to have a good understanding of automotive electronics, systems and procedures.**
- **If mounting this product requires drilling holes, the installer MUST be sure that no vehicle components or other vital parts could be damaged by the drilling process. Check both sides of the mounting surface before drilling begins. Also de-burr any holes and remove any metal shards or remnants. Install grommets into all wire passage holes.**
- **If this manual states that this product may be mounted with suction cups, magnets, tape or Velcro[®], clean the mounting surface with a 50/50 mix of isopropyl alcohol and water and dry thoroughly.**
- **Do not install this product or route any wires in the deployment area of your air bag. Equipment mounted or located in the air bag deployment area will damage or reduce the effectiveness of the air bag, or become a projectile that could cause serious personal injury or death. Refer to your vehicle owner's manual for the air bag deployment area. The User/Installer assumes full responsibility to determine proper mounting location, based on providing ultimate safety to all passengers inside the vehicle.**
- **For this product to operate at optimum efficiency, a good electrical connection to chassis ground must be made. The recommended procedure requires the product ground wire to be connected directly to the NEGATIVE (-) battery post.**
- **If this product uses a remote device to activate or control this product, make sure that this control is located in an area that allows both the vehicle and the control to be operated safely in any driving condition.**
- **Do not attempt to activate or control this device in a hazardous driving situation.**
- **This product contains either strobe light(s), halogen light(s), high-intensity LEDs or a combination of these lights. Do not stare directly into these lights. Momentary blindness and/or eye damage could result.**
- **Use only soap and water to clean the outer lens. Use of other chemicals could result in premature lens cracking (crazing) and discoloration. Lens in this condition have significantly reduced effectiveness and should be replaced immediately. Inspect and operate this product regularly to confirm its proper operation and mounting condition. Do not use a pressure washer to clean this product.**
- **It is recommended that these instructions be stored in a safe place and referred to when performing maintenance and/or reinstallation of this product.**
- **FAILURE TO FOLLOW THESE SAFETY PRECAUTIONS AND INSTRUCTIONS COULD RESULT IN DAMAGE TO THE PRODUCT OR VEHICLE AND/OR SERIOUS INJURY TO YOU AND YOUR PASSENGERS!**

For warranty information regarding this product, visit www.whelen.com/warranty

IMPORTANT! It is the responsibility of the installation technician to make sure that the installation and operation of this product will not interfere with or compromise the operation or efficiency of any vehicle equipment!

IMPORTANT AIR BAG WARNING! Do not install this product or route any wires in the air bag deployment zone of your vehicle. Equipment mounted or located in air bag deployment zones will damage or reduce the effectiveness of the air bag, or become a projectile that could cause serious personal injury or death. Refer to your vehicle owners manual to learn the air bag deployment zones for the vehicle. The User/Installer assumes full responsibility to determine proper mounting location, based on providing ultimate safety to all passengers inside the vehicle.

Installation:

IMPORTANT! The lightbar should be located a minimum of 16" from any radio antennas!

1. On the rear deck, locate the 2 outboard caps covering the child restraint strap holders. Remove the plastic covers to access the tether strap holders (Fig. 1).
2. Install the 2 mounting brackets as shown in Fig 2. It is important that these brackets be positioned so that the housing rests flatly on top of them. **Be sure to tighten the mounting hardware firmly.**
3. Secure the lightbar to the mounting brackets as shown using the provided hardware. Confirm that the unit is level and clears the 3rd brake light.
4. Route the input cable to your control head (refer to the installation manual included with your control head for important mounting and wiring information). It is left to the installation technician's discretion to select a path for this cable that will both protect it from possible damage and not interfere with the operation of any other vehicle components or equipment.

IMPORTANT! When routing the lightbar cable, it is left to the installation technician's discretion to select a path for these cables that will both protect the cables from possible damage and not interfere with the operation of any other vehicle components or equipment. Refer to the instructions included with your switches for switch wiring information.

A windshield seal is included and should be installed to eliminate vibration against the rear glass.

WARNING! All customer supplied wires that connect to the positive terminal of the battery must be sized to supply at least 125% of the maximum operating current and **FUSED** at the battery to carry that load. **DO NOT USE CIRCUIT BREAKERS WITH THIS PRODUCT!**

Scan-Lock (WHT)™

TO CYCLE THROUGH ALL PATTERNS: Apply +12 volts to the WHT wire for less than 1 second and release to cycle forward. Apply +12 volts to the WHT wire for more than 1 second and release to cycle backward.

TO SET A PATTERN AS DEFAULT: When the desired pattern is displayed, allow it to run for more than 5 seconds. The lighthouse will now display this pattern when active.

TO RESET TO THE FACTORY DEFAULT PATTERN: Turn off power, apply +12 volts to the WHT wire, then turn power on.

A normally open momentary switch can be used to control Scan-Lock operation.

Low Power Operation (ORG)

NOTE: Low Power is not available with units equipped with end flashers

FOR LOW POWER OPERATION: Apply +12VDC to the ORG wire. The unit will continue to operate in Low Power mode until this voltage is removed.

A Single Pole / Single Throw switch can be used to control Low Power operation.

IMPORTANT! Before returning the vehicle to active service, visually confirm the proper operation of this product, as well as all vehicle components/equipment.

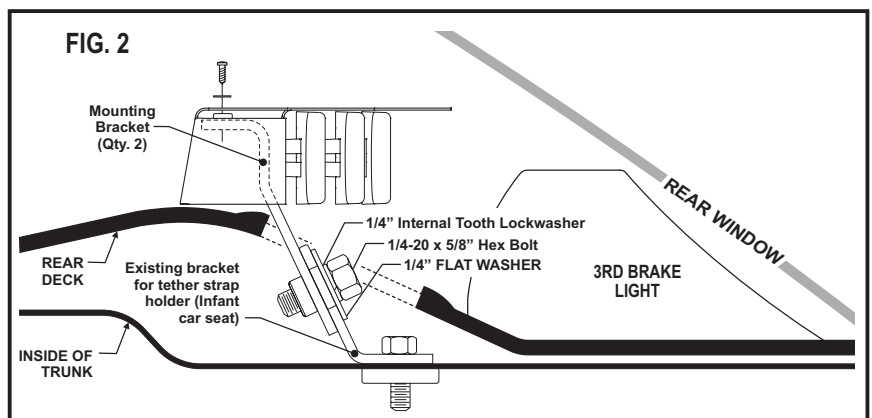
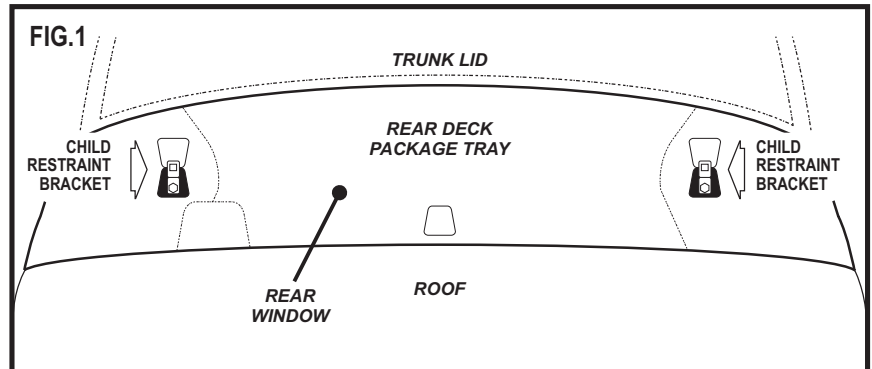

6-Light TA

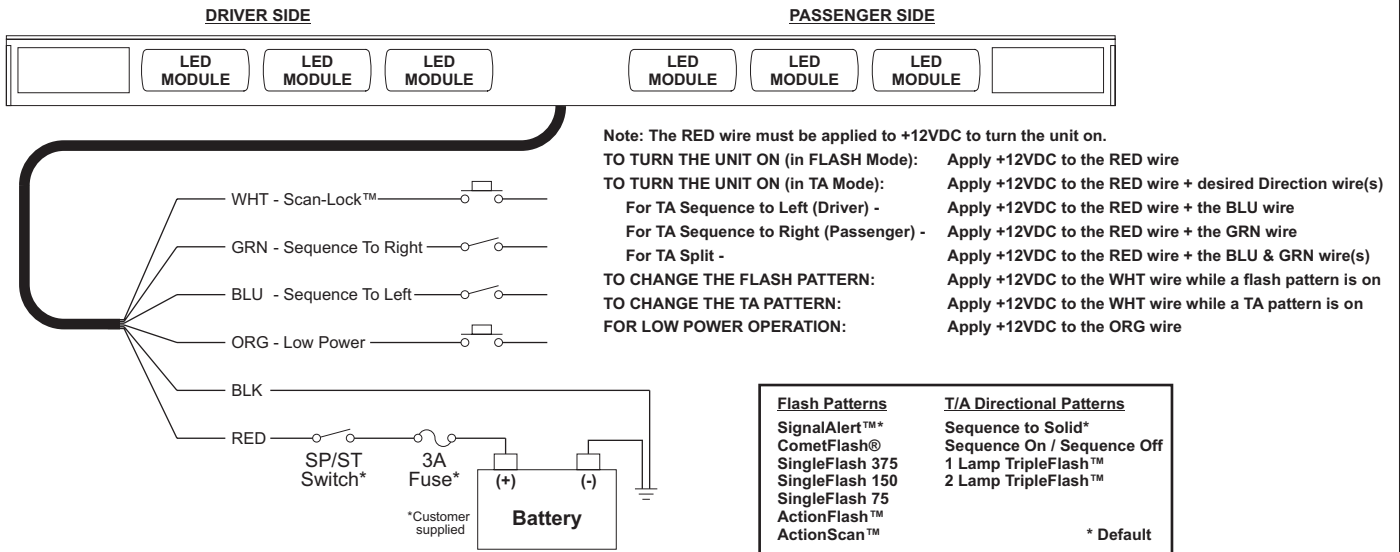

8-Light TA

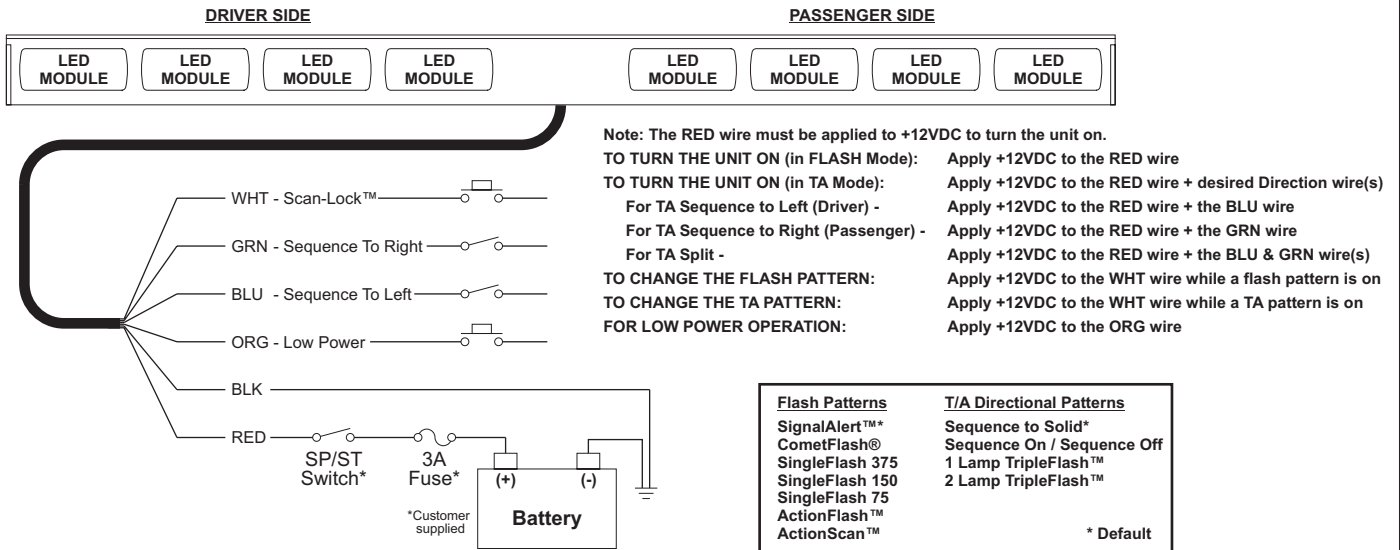

6-Light TA w/End Flashers

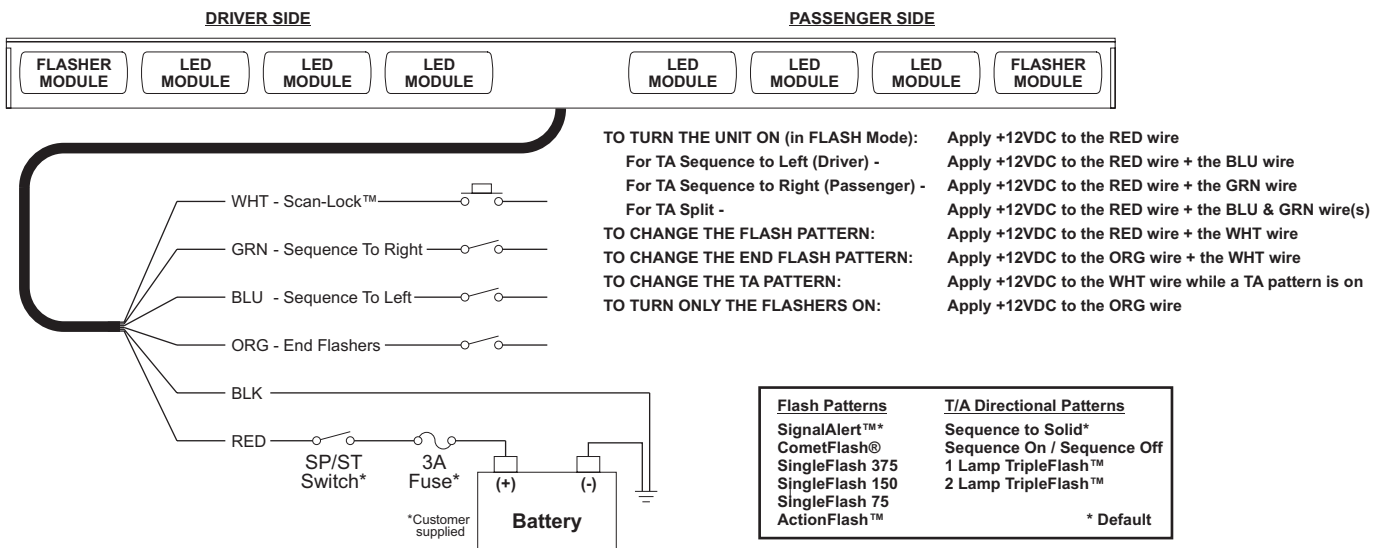



Refer to the wiring table on the previous page for wiring and operational information for your specific lightbar

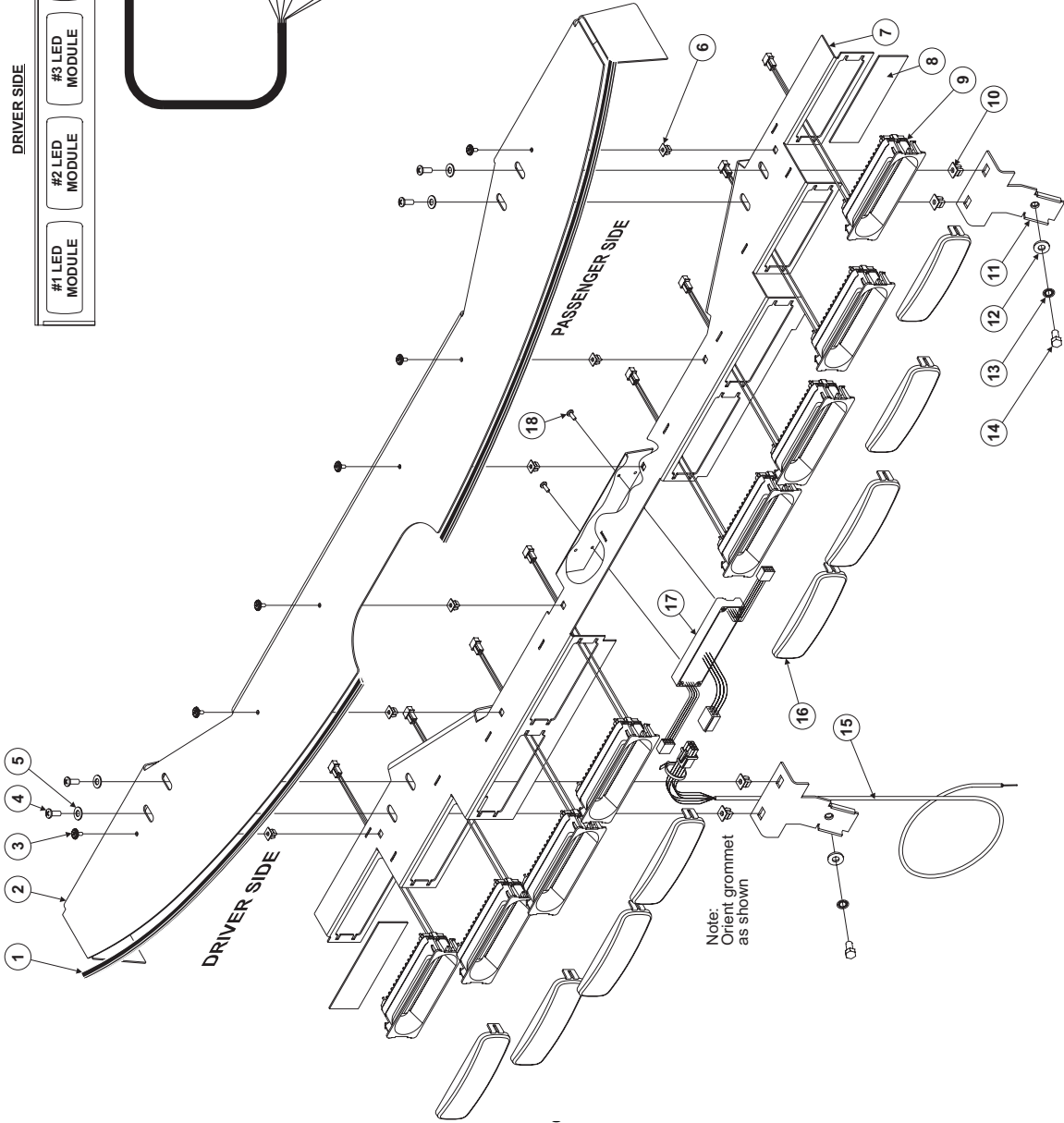
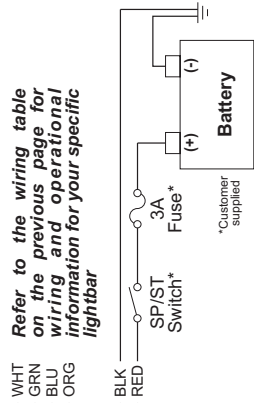

QTY	QTY / ITEM	PART NUMBER	DESCRIPTION	
*	*	01-0684452-01	Inner Edge® Interior Lightbar (6) 500 Linear	
*	*	01-0684452-02	Inner Edge® Interior Lightbar (8) 500 Linear	
*	*	01-0684452-03	Inner Edge® Interior Lightbar (w/end flashers)	
2	2	38-0543284-22	Windshield Seal	
1	1	11-284408-007	Inner Edge® Interior Lightbar Housing (Rear Deck)	
6	6	15-M23B1C-120	Screw, M4.2 x 12mm Phillips w/shouldered	
4	4	15-10174B-102	Screw, #10 x 5/8 Slotted Hex Washer. Self-tapping, SS	
4	4	16-1002227-50	#10 Flat Washer	
6	6	13-062C40-16J	#6 / #8 Screw Grommet	
1	1	07-284370-023	500 Series Linear Mounting Bracket	
-	2	09-1323251-00	Filler Panel	
A/R	A/R	01-0264260-12	500 Series Linear-LED® (Snap-In) - Amber	
A/R	A/R	01-0264260-22	500 Series Linear-LED® (Snap-In) - Blue	
A/R	A/R	01-0264260-32	500 Series Linear-LED® (Snap-In) - White	
A/R	A/R	01-0264260-42	500 Series Linear-LED® (Snap-In) - Green	
A/R	A/R	01-0264260-52	500 Series Linear-LED® (Snap-In) - Red	
4	4	21-17060704-3	#8 / #10 Screw Grommet	
2	2	07-264337-000	Inner Edge® Rear Deck Light Mounting Bracket	
2	2	16-1302820-06	Flat Washer (1/4" 7/8 OD, 17/64 ID, SS)	
2	2	16-1321560-02	1/4" Internal Tooth Lockwasher	
2	2	14-130436-100	Screw, 1/4 - 20 x 5/8 Hex Head SS	
1	1	46-0743335-00	Input Cable (6-conductor / 16 AWG / 20')	
8	8	68-3963604-30	Lens, Clear, Non-optic, Snap-on	
-	1	17	01-0264629-06	Inner Edge® TIR3™ Flasher Assembly (6-Lamp)
-	1	17	01-0264629-08	Inner Edge® TIR3™ Flasher Assembly (8-Lamp)
1	-	17	01-0264629-6F	Inner Edge® TIR3™ Flasher Assy (6-Lamp w/flashers)
2	2	18	15-06521B-080	Screw, 6 x 1/2 PPH Plast-Lok, SS, Black