

# WHELEN<sup>®</sup>

ENGINEERING COMPANY INC.

51 Winthrop Road  
Chester, Connecticut 06412-0684  
Phone: (860) 526-9504  
Fax: (860) 526-4078  
Internet: [www.whelen.com](http://www.whelen.com)  
Sales e-mail: [autosale@whelen.com](mailto:autosale@whelen.com)  
Canadian Sales e-mail: [autocan@whelen.com](mailto:autocan@whelen.com)  
Customer Service e-mail: [custserv@whelen.com](mailto:custserv@whelen.com)

## Installation Guide: Super-LED<sup>®</sup> Hide-A-Way (Front) 2006 - 2007 Ford Crown Victoria

### Safety First

This document provides all the necessary information to allow your Whelen product to be properly and safely installed. Before beginning the installation and/or operation of your new product, the installation technician and operator must read this manual completely. Important information is contained herein that could prevent serious injury or damage.

- **Proper installation of this product requires the installer to have a good understanding of automotive electronics, systems and procedures.**
- **If mounting this product requires drilling holes, the installer MUST be sure that no vehicle components or other vital parts could be damaged by the drilling process. Check both sides of the mounting surface before drilling begins. Also de-burr any holes and remove any metal shards or remnants. Install grommets into all wire passage holes.**
- **If this manual states that this product may be mounted with suction cups, magnets, tape or Velcro<sup>®</sup>, clean the mounting surface with a 50/50 mix of isopropyl alcohol and water and dry thoroughly.**
- **Do not install this product or route any wires in the deployment area of your air bag. Equipment mounted or located in the air bag deployment area will damage or reduce the effectiveness of the air bag, or become a projectile that could cause serious personal injury or death. Refer to your vehicle owner's manual for the air bag deployment area. The User/Installer assumes full responsibility to determine proper mounting location, based on providing ultimate safety to all passengers inside the vehicle.**
- **For this product to operate at optimum efficiency, a good electrical connection to chassis ground must be made. The recommended procedure requires the product ground wire to be connected directly to the NEGATIVE (-) battery post.**
- **If this product uses a remote device to activate or control this product, make sure that this control is located in an area that allows both the vehicle and the control to be operated safely in any driving condition.**
- **Do not attempt to activate or control this device in a hazardous driving situation.**
- **This product contains either strobe light(s), halogen light(s), high-intensity LEDs or a combination of these lights. Do not stare directly into these lights. Momentary blindness and/or eye damage could result.**
- **Use only soap and water to clean the outer lens. Use of other chemicals could result in premature lens cracking (crazing) and discoloration. Lenses in this condition have significantly reduced effectiveness and should be replaced immediately. Inspect and operate this product regularly to confirm its proper operation and mounting condition. Do not use a pressure washer to clean this product.**
- **It is recommended that these instructions be stored in a safe place and referred to when performing maintenance and/or reinstallation of this product.**
- **FAILURE TO FOLLOW THESE SAFETY PRECAUTIONS AND INSTRUCTIONS COULD RESULT IN DAMAGE TO THE PRODUCT OR VEHICLE AND/OR SERIOUS INJURY TO YOU AND YOUR PASSENGERS!**

**For warranty information regarding this product, visit [www.whelen.com/warranty](http://www.whelen.com/warranty)**

# Installation

**Advisory!** When installed properly, this product is compliant with all applicable Federal Motor Vehicle Safety Standards for Park/Turn (Front) systems for the production years of the vehicle make and model only, as indicated. The use of this equipment on any other vehicle (Year/Make/Model) is not recommended and is at the sole discretion and risk of the user.

1. On the front of the engine compartment, remove the 3 fasteners holding on the plastic protective shroud that runs the width of the vehicle and remove the shroud from the vehicle.
2. Following manufacturers instructions, remove the headlight assembly.
3. Unplug and remove the parking light from the headlight assembly.
4. Using the supplied bracket and mounting hardware, mount the flasher to the radiator support, behind the headlight assembly (Fig. 1).
5. Cut the 3 wires that go to your parking light leaving enough wire to the parking light so you may attach a connector (Figs. 2 & 3).
6. Attach the supplied PIN connector to the wires coming from the parking light and the supplied SOCKET connector to the vehicle wires that you cut (Figs. 2 & 3) (see "The Deutsch Waterproof Connector" on the next page).
7. Replace the parking light bulb with the LED lighthouse, and plug it back into the headlight assembly. The lighthouse will not work if plugged into the socket incorrectly. Refer to the illustration shown below for correct bulb orientation.

**NOTE:** The Hide-A-Way will only fit into the parking light hole in one specific position. You must tilt the head of the light as you insert it into the socket. It will not slide straight in. Do not try to force it.

### LIGHTHEAD INSTALLATION

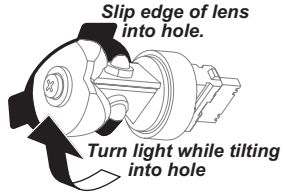

### ORIENTATION

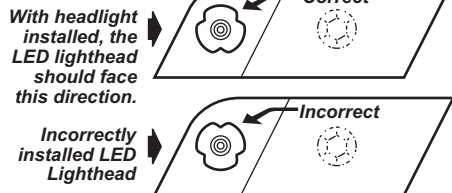

8. Remount the headlight assembly and connect it to the flasher using the supplied harness as shown in the wiring diagram.
9. Connect flasher to power (RED) and ground (BLACK) and test.

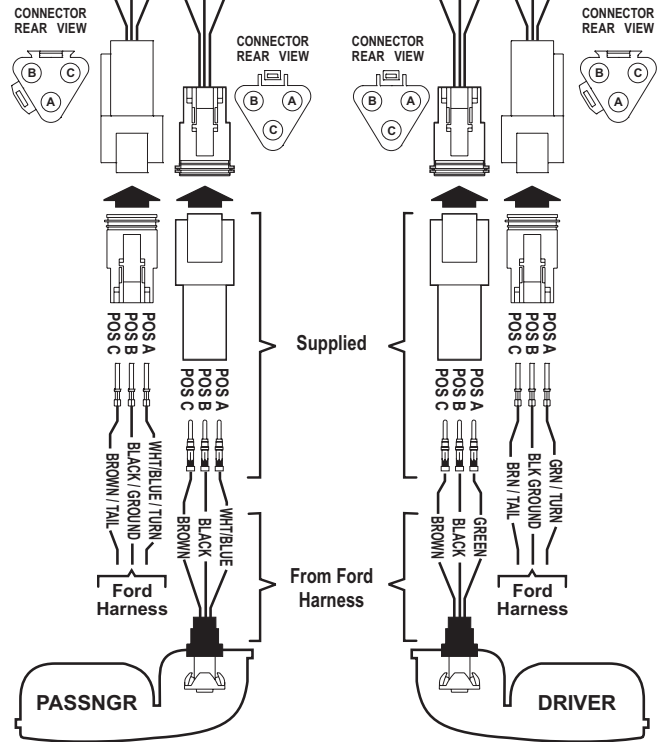
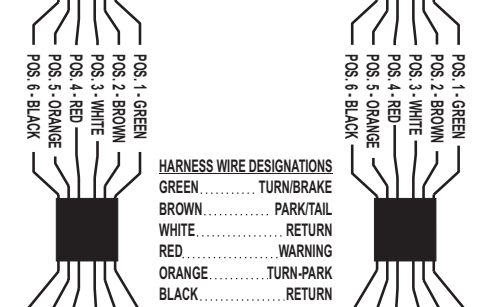
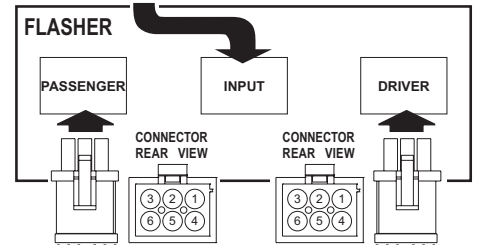
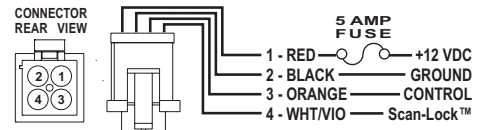
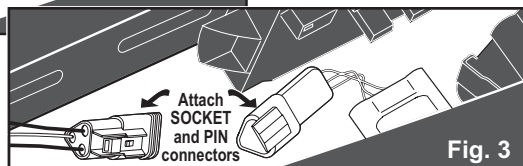
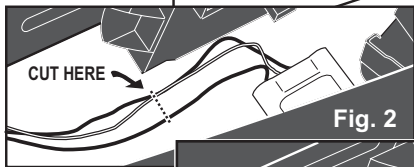
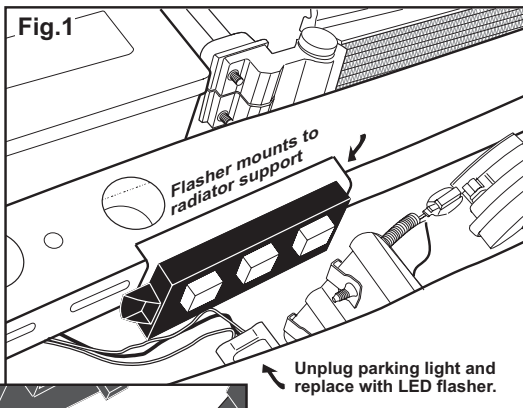

**IMPORTANT WARNING!** All customer supplied wires that connect to the positive terminal of the battery must be sized to supply at least 125% of the maximum operating current and FUSED at the battery to carry the load. DO NOT USE CIRCUIT BREAKERS WITH THIS PRODUCT!

## Operation:

This flasher is powered and controlled by the 4 wires coming from the input connector. **RED: 12 volts VDC (Fuse @ 5 AMPS)** **BLACK: Ground** **ORANGE: Control (Activates warning lights)** **WHT/VIO: Scan-Lock™**

**IMPORTANT WARNING: Do not attempt to use the LED lighthead without the flasher module connected.**

## Scan-Lock™ (White/Violet)

To change the flash pattern of:

**Warning Lights:** Only the warning lights must be activated. Parking and turn should be off.

**Turn Signal:** Must have the parking lights and hazard lights activated and warning lights off.

**TO CHANGE PATTERNS:** Apply +12 volts to the WHITE/VIOLET wire for less than 1 second and release to cycle forward to the next available pattern. Apply +12 volts to the WHITE/VIOLET wire for more than 1 second and release to cycle back to the previous pattern.

**TO CHANGE THE DEFAULT PATTERN:** Select the desired pattern and allow it to run for more than 5 seconds.

**TO RESTORE THE FACTORY DEFAULT PATTERN: This will reset all patterns back to the factory default settings.** Disconnect main power and apply power to Scan-Lock. With power applied to Scan-Lock, turn main power back on.

A Normally Open momentary switch can be used to control Scan-Lock.

**Default settings: Warning - SignalAlert™ Signal - SteadyBrake**  
**Available Flash Patterns: ALT = Alternating SIM = Simultaneous**

### WARNING PATTERNS:

1. SignalAlert™ / ALT
2. SignalAlert / SIM
3. SignalAlert / ALT-SIM
4. CometFlash® / SIM
5. CometFlash / ALT-SIM
6. LongBurst™ / ALT
7. LongBurst / SIM
8. LongBurst / ALT-SIM
9. SingleFlash 75 / ALT
10. SingleFlash 75 / SIM
11. SingleFlash 75 / ALT-SIM
12. SingleFlash 150 / ALT
13. SingleFlash 150 / SIM

14. SingleFlash 150 / ALT-SIM
15. SingleFlash 375 / ALT
16. SingleFlash 375 / SIM
17. SingleFlash 375 / ALT-SIM
18. DoubleFlash 75 / ALT
19. DoubleFlash 75 / SIM
20. DoubleFlash 75 / ALT-SIM
21. ActionFlash™ / ALT
22. ActionFlash / SIM
23. ModuFlash™ / ALT
24. ActionScan™ / ALT

### SIGNAL PATTERNS:

1. BrakeAlert
2. Steady Brake

The Deutsch waterproof connector will not function properly unless it is connected exactly as the manufacturer intended. A Deutsch crimping tool (Whelen P/N 66T0516435119C) is required for proper terminal crimping and should be used whenever possible. If a non-Deutsch crimp tool is used, the cable wires must first be pushed through the rubber connector grommet BEFORE the pin terminal is crimped. This will reduce the possibility of damaging the water-tight seal around the wires. Whelen Engineering does not recognize the use of a non-Deutsch crimping tool, any resulting damage would void the warranty.

Wires coming from the lamp MUST be connected to the receptacle housing and wires from the power supply to the plug housing. Refer to Figure 4 for an overview of all related components. Be sure to insert the wires into the receptacle so that they will connect with the correct plug wire. Example: The wire in receptacle section A is the wire that is designated to be connected to the wire in plug section A.

**Assembly:** Locate the cable that will be used between the lamp and the receptacle section of the waterproof connector. Locate the leads that have the "barrel"-style pins crimped onto the wires. Grasp the wire approximately 1" behind the contact barrel. Hold the receptacle so that the grommet is facing you. Push the pin straight into the grommet until a "click" is felt. A gentle tug will confirm that it is locked into place. Once all the pins are installed, insert the wedge into the receptacle. Be sure that the arrow on the wedge is pointing towards the exterior lock.

**NOTE: Although the above text outlines the procedure for assembling the receptacle, the same procedure is used for the plug. The plug utilizes a faceplate instead of a wedge. It can be removed with a small screwdriver.**

**Contact Removal:** Remove the wedge with either a pair of needle nose pliers (if removing contacts from the receptacle section) or a small, regular screwdriver (for the faceplate of the plug section). To remove the contacts, gently pull the desired wire back away from the grommet. At the same time, release the locking finger by moving it away from the contact with a screwdriver. Be sure to hold the rear seal in place, as removing the contact will disrupt its position.

DESCRIPTION	PART NUMBER	QTY
<b>HA02FAA FRONT HIDE-A-WAY / AMB-AMB (06-07 CROWN VIC)</b>	<b>01-1517669-AA</b>	
FRONT LED HIDE-A-WAY FLASHER.....	01-0264403-00.....	1
LED HIDE-A-WAY LAMP / AMBER.....	01-0264445-11.....	2
LED HIDE-A-WAY FLASHER KIT.....	01-0454403-00.....	1
<b>HA02FBB FRONT HIDE-A-WAY / BLU-BLU (06-07 CROWN VIC)</b>	<b>01-1517669-BB</b>	
FRONT LED HIDE-A-WAY FLASHER.....	01-0264403-00.....	1
LED HIDE-A-WAY LAMP / BLUE.....	01-0264445-21.....	2
LED HIDE-A-WAY FLASHER KIT.....	01-0464403-00.....	1
<b>HA02FCC FRONT HIDE-A-WAY / WHT-WHT (06-07 CROWN VIC)</b>	<b>01-1517669-CC</b>	
FRONT LED HIDE-A-WAY FLASHER.....	01-0264403-00.....	1
LED HIDE-A-WAY LAMP / WHT.....	01-0264445-31.....	2
LED HIDE-A-WAY FLASHER KIT.....	01-0464403-00.....	1
<b>HA02FRB FRONT HIDE-A-WAY / RED-BLU (06-07 CROWN VIC)</b>	<b>01-1517669-RB</b>	
FRONT LED HIDE-A-WAY FLASHER.....	01-0264403-00.....	1
LED HIDE-A-WAY LAMP / BLU-AMB.....	01-0264445-21.....	1
LED HIDE-A-WAY LAMP / RED-AMB.....	01-0264445-51.....	1
LED HIDE-A-WAY FLASHER KIT.....	01-0464403-00.....	1
<b>HA02FRR FRONT HIDE-A-WAY / RED-RED (06-07 CROWN VIC)</b>	<b>01-1517669-RR</b>	
FRONT LED HIDE-A-WAY FLASHER.....	01-0264403-00.....	1
LED HIDE-A-WAY LAMP / RED.....	01-0264445-51.....	2
LED HIDE-A-WAY FLASHER KIT.....	01-0464403-00.....	1
<b>LED HIDE-A-WAY FLASHER KIT</b>		
FLASHER MOUNTING BRACKET.....	07-264712-00.....	1
10-24 CAD PLATED WIZ NUT.....	13-104111-063.....	2
10 X 3/8" PPHSMS.....	15-101116-06.....	2
3 POSITION WATERPROOF PIN HOUSING.....	39-1H03014-35.....	6
3 POSITION WATERPROOF SOCKET HOUSING.....	39-1H03024-35.....	6
3 POSITION WATERPROOF PIN WEDGE.....	39-1H16424-3P.....	2
3 POSITION WATERPROOF SOCKET WEDGE.....	39-1H16424-3S.....	2
2 CHANNEL INPUT HARNESS.....	46-0764711-00.....	1
18" OUTPUT HARNESS.....	46-0764711-01.....	1
5" OUTPUT HARNESS.....	46-0764711-02.....	1

**IMPORTANT! Before returning this vehicle to active service, visually confirm the proper operation of this product, as well as all vehicle components/equipment.**

**IMPORTANT WARNING!**  
**CAUTION! DO NOT LOOK DIRECTLY AT THESE LEDS WHILE THEY ARE ON. MOMENTARY BLINDNESS AND/OR EYE DAMAGE COULD RESULT!**

