

WHELEN[®]

ENGINEERING COMPANY INC.

51 Winthrop Road
Chester, Connecticut 06412-0684
Phone: (860) 526-9504
Fax: (860) 526-4078
Internet: www.whelen.com
Sales e-mail: autosale@whelen.com
Canadian Sales e-mail: autocan@whelen.com
Customer Service e-mail: custserv@whelen.com

Installation Guide: Wireless Traffic Advisor™ Controller

Safety First

This document provides all the necessary information to allow your Whelen product to be properly and safely installed. Before beginning the installation and/or operation of your new product, the installation technician and operator must read this manual completely. Important information is contained herein that could prevent serious injury or damage.

- **Proper installation of this product requires the installer to have a good understanding of automotive electronics, systems and procedures.**
- **If mounting this product requires drilling holes, the installer MUST be sure that no vehicle components or other vital parts could be damaged by the drilling process. Check both sides of the mounting surface before drilling begins. Also de-burr any holes and remove any metal shards or remnants. Install grommets into all wire passage holes.**
- **If this manual states that this product may be mounted with suction cups, magnets, tape or Velcro®, clean the mounting surface with a 50/50 mix of isopropyl alcohol and water and dry thoroughly.**
- **Do not install this product or route any wires in the deployment area of your air bag. Equipment mounted or located in the air bag deployment area will damage or reduce the effectiveness of the air bag, or become a projectile that could cause serious personal injury or death. Refer to your vehicle owner's manual for the air bag deployment area. The User/Installer assumes full responsibility to determine proper mounting location, based on providing ultimate safety to all passengers inside the vehicle.**
- **For this product to operate at optimum efficiency, a good electrical connection to chassis ground must be made. The recommended procedure requires the product ground wire to be connected directly to the NEGATIVE (-) battery post.**
- **If this product uses a remote device to activate or control this product, make sure that this control is located in an area that allows both the vehicle and the control to be operated safely in any driving condition.**
- **Do not attempt to activate or control this device in a hazardous driving situation.**
- **This product contains either strobe light(s), halogen light(s), high-intensity LEDs or a combination of these lights. Do not stare directly into these lights. Momentary blindness and/or eye damage could result.**
- **Use only soap and water to clean the outer lens. Use of other chemicals could result in premature lens cracking (crazing) and discoloration. Lens in this condition have significantly reduced effectiveness and should be replaced immediately. Inspect and operate this product regularly to confirm its proper operation and mounting condition. Do not use a pressure washer to clean this product.**
- **It is recommended that these instructions be stored in a safe place and referred to when performing maintenance and/or reinstallation of this product.**
- **FAILURE TO FOLLOW THESE SAFETY PRECAUTIONS AND INSTRUCTIONS COULD RESULT IN DAMAGE TO THE PRODUCT OR VEHICLE AND/OR SERIOUS INJURY TO YOU AND YOUR PASSENGERS!**

For warranty information regarding this product, visit www.whelen.com/warranty

Note! This controller will only work with Traffic Advisor™ models that have been equipped at the factory with wireless receivers.

Battery Installation

1. Remove the 4 Phillips head screws that secure the back cover onto the controller. Remove and retain the screws and cover from the controller.
2. Locate and install the two (2) AAA size batteries included with the controller. Be sure to install the batteries so that their orientation and polarity match the battery outline on the circuit board.
3. Return the rear cover to its original position and secure it onto the controller using the screws removed in step 1.

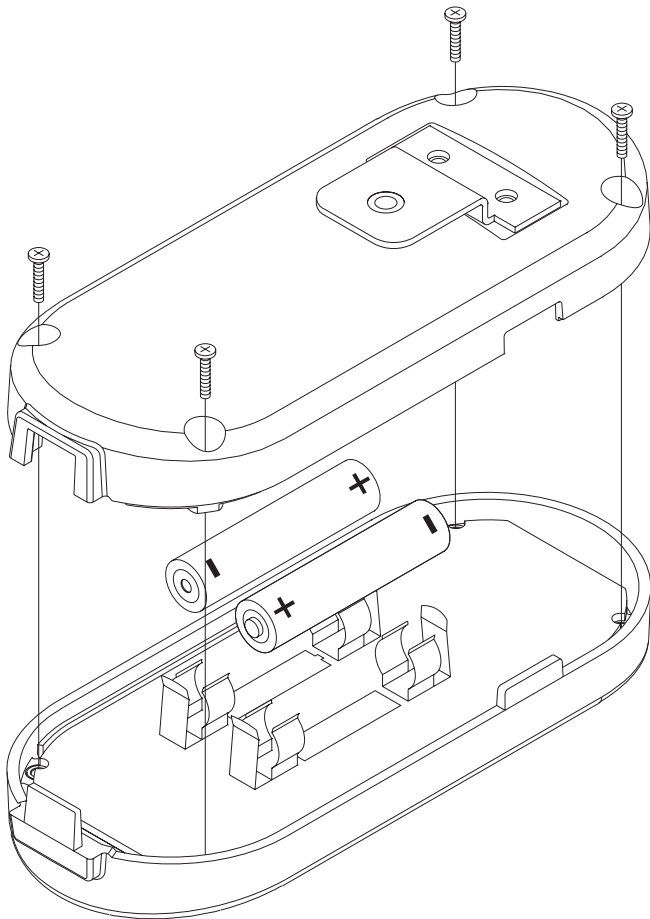

Binding Procedure

The Traffic Advisor and its controller are pre-bound at the factory to work right out of the box. However, if either of these are replaced, the binding procedure must be performed before the Traffic Advisor and its controller can be put into service.

The binding procedure will configure the controller so that it will only operate the Traffic Advisor to which it is bound. Keep in mind that a controller can not be bound to more than one Traffic Advisor at a time.

1. Turn the power to the Traffic Advisor on. There should be no pattern displayed during this procedure.
2. Locate the receiver module mounted on the Traffic Advisor array. On arrow-style arrays this module is typically located in the upper-left section of the array as shown.

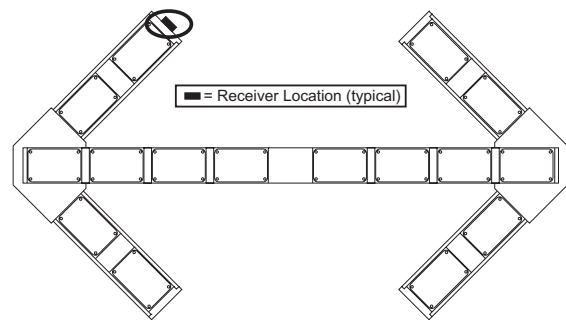

1. On bar-style arrays, the receiver module is mounted on the endcap as shown.

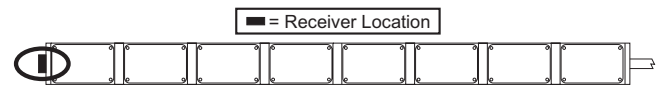

2. Place and hold the controller against the receiver module. Make sure that the LED indicators on the controller can clearly be seen. **The controller MUST remain in contact with the receiver module during the entire binding procedure (70 seconds max.)**
3. Input the following sequence on the controller. **IMPORTANT! Do not allow more than one (1) second between key presses!**

Binding Sequence

S/L > S/L > S/L > Left Arrow > S/L > Right Arrow > S/L

If this sequence has been successfully entered, the center LED indicator will flash to indicate that the binding process has begun. This process will last a maximum of seventy (70) seconds.

If the binding procedure is successful, the center three (3) LED indicators will simultaneously flash for three (3) seconds. Test the controller to confirm proper operation.

If the binding procedure is unsuccessful, the center LED will stop flashing. In this event, wait for the controller backlight to go out and repeat the binding procedure from the beginning. If the binding procedure is unsuccessful after 2 more attempts, contact Whelen Customer Service.

Operation

As shown here, the controller is comprised of six (6) buttons and 5 LED indicators

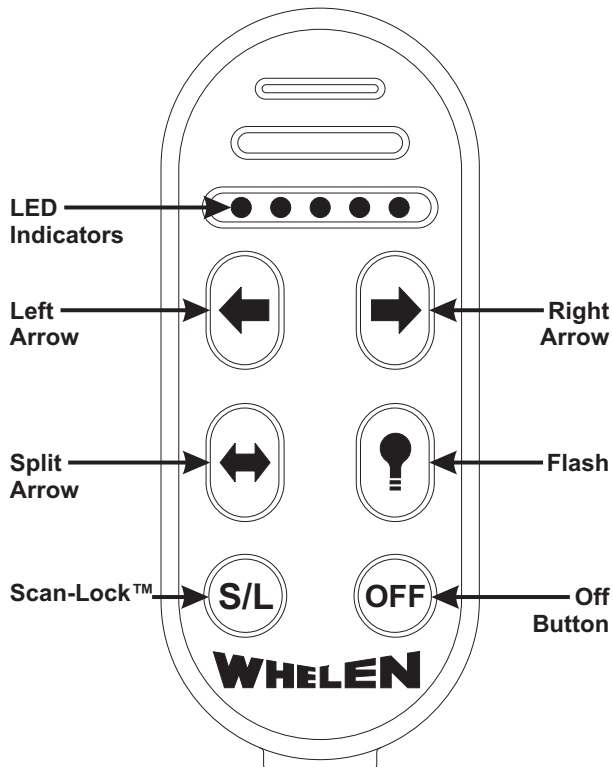

Arrow Buttons - There are three Arrow buttons; Left, Right and Split. Pressing these buttons will initiate their designated sequence. There are five (5) different sequence styles in which these sequences are displayed. The selected sequence style is applied to all three arrow buttons.

The sequence style selected will be used for all three buttons. The 5 styles are as follows:

- Solid Arrow (default)
- Solid Half Arrow
- Sequence to TripleFlash™
- Sequence to Solid
- Sequence On / Sequence Off

For information on changing styles, please refer to the “Scan-Lock” section of this manual.

Flash Button - The Flash button will activate one of three (3) available displays. They are as follows:

- Flash Tips (default)
- Flash Bar
- Flash Tips and Bar

For information on changing displays, please refer to the “Scan-Lock” section of this manual.

Scan-Lock - The Scan-Lock button is used to change the styles used for the Arrow buttons and the display used by the Flash button. This button operates as follows:

1. Press and hold the desired Arrow (Left, Right, Split) or Flash button.
2. While holding the Arrow or Flash buttons, press and hold the Scan-Lock (S/L) button for less than one (1) second and release. This will advance the current style or display to the next style or display.
3. Release the Scan-Lock button and allow the selection to run for a minimum of 5 seconds to designate it the default style/display.

IMPORTANT! In areas where the type of pattern displayed is mandated by State, County or Municipal authorities, this function may be disabled. In these regions, the Scan-Lock button will still be used for the binding procedure.

Off - The Off button is used to turn off the Traffic Advisor™.

LED Indicators - There are five (5) LED Indicators located on the face of the controller. These LEDs provide a brief visual representation of the Sequence or Display selected.

These indicators also provide important information during the Binding process. Refer to the “**Binding Procedure**” section for more information.

Backlight - The controller features backlighting to aid nighttime operation. Backlighting is activated whenever any button is pressed and will remain on for approximately 3 seconds after the last button press.

Low Battery Indicator - When it is time to replace the controller batteries, the OFF button will periodically flash red. If this behavior is noticed, replace the batteries immediately.

Controller Mounting Clip - A mounting clip is included with this controller. This provides a place for the operator to keep the controller when it is not in use. When determining a mounting location for this clip, it is important to select a location that does not place either the clip or the clip/controller where it could interfere with any existing equipment.

IMPORTANT AIR BAG WARNING! Do not install this product in the air bag deployment zone of your vehicle. Equipment mounted or located in air bag deployment zones will damage or reduce the effectiveness of the air bag, or become a projectile that could cause serious personal injury or death. Refer to your vehicle owners manual to learn the air bag deployment zones for the vehicle. The User/Installer assumes full responsibility to determine proper mounting location, based on providing ultimate safety to all passengers inside the vehicle.