

WHELEN[®]

ENGINEERING COMPANY INC.

51 Winthrop Road
Chester, Connecticut 06412-0684
Phone: (860) 526-9504
Fax: (860) 526-4078
Internet: www.whelen.com
Sales e-mail: autosale@whelen.com
Canadian Sales e-mail: autocan@whelen.com
Customer Service e-mail: custserv@whelen.com

Installation Guide: Super-LED[®] Hide-A-Way System (Rear) 2006 - 2009 Ford Crown Victoria

Safety First

This document provides all the necessary information to allow your Whelen product to be properly and safely installed. Before beginning the installation and/or operation of your new product, the installation technician and operator must read this manual completely. Important information is contained herein that could prevent serious injury or damage.

- **Proper installation of this product requires the installer to have a good understanding of automotive electronics, systems and procedures.**
- **If mounting this product requires drilling holes, the installer MUST be sure that no vehicle components or other vital parts could be damaged by the drilling process. Check both sides of the mounting surface before drilling begins. Also de-burr any holes and remove any metal shards or remnants. Install grommets into all wire passage holes.**
- **If this manual states that this product may be mounted with suction cups, magnets, tape or Velcro[®], clean the mounting surface with a 50/50 mix of isopropyl alcohol and water and dry thoroughly.**
- **Do not install this product or route any wires in the deployment area of your air bag. Equipment mounted or located in the air bag deployment area will damage or reduce the effectiveness of the air bag, or become a projectile that could cause serious personal injury or death. Refer to your vehicle owner's manual for the air bag deployment area. The User/Installer assumes full responsibility to determine proper mounting location, based on providing ultimate safety to all passengers inside the vehicle.**
- **For this product to operate at optimum efficiency, a good electrical connection to chassis ground must be made. The recommended procedure requires the product ground wire to be connected directly to the NEGATIVE (-) battery post.**
- **If this product uses a remote device to activate or control this product, make sure that this control is located in an area that allows both the vehicle and the control to be operated safely in any driving condition.**
- **Do not attempt to activate or control this device in a hazardous driving situation.**
- **This product contains either strobe light(s), halogen light(s), high-intensity LEDs or a combination of these lights. Do not stare directly into these lights. Momentary blindness and/or eye damage could result.**
- **Use only soap and water to clean the outer lens. Use of other chemicals could result in premature lens cracking (crazing) and discoloration. Lenses in this condition have significantly reduced effectiveness and should be replaced immediately. Inspect and operate this product regularly to confirm its proper operation and mounting condition. Do not use a pressure washer to clean this product.**
- **It is recommended that these instructions be stored in a safe place and referred to when performing maintenance and/or reinstallation of this product.**
- **FAILURE TO FOLLOW THESE SAFETY PRECAUTIONS AND INSTRUCTIONS COULD RESULT IN DAMAGE TO THE PRODUCT OR VEHICLE AND/OR SERIOUS INJURY TO YOU AND YOUR PASSENGERS!**

For warranty information regarding this product, visit www.whelen.com/warranty

2007 - 09 Crown Victoria:
Preparing the lamp sockets

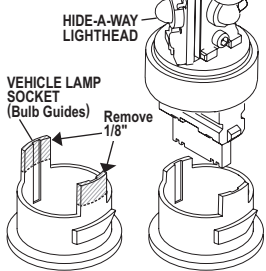

LIGHTHEAD INSTALLATION

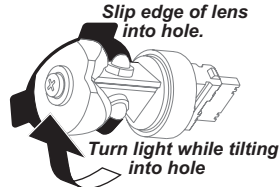

NOTE: The Hide-A-Way will only fit into the parking light hole in one specific position. You must tilt the head as you insert it into the socket. It will not slide straight in. Do not try to force it.

2007 - 2009 CROWN VICTORIA NOTE: Before installation into the vehicle's socket, the socket guides on the vehicle housing will need to have approx. 1/8" trimmed off (see illustration). Without trimming, the lamp will not be seated far enough into the socket to snap into place and could come loose.

IMPORTANT: If the vehicles wiring does not match either of the existing vehicle wiring, stop the installation process and contact Whelen technical support for assistance.

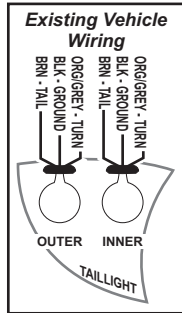

2006 - 2007 1/2

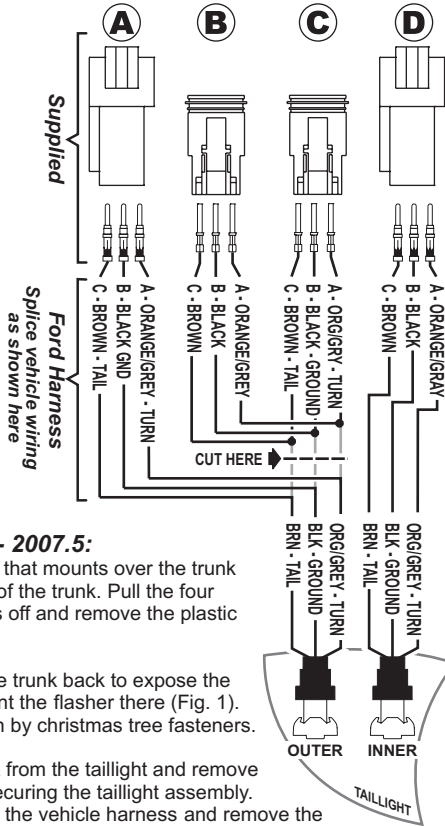

Installation / 2006 - 2007.5:

1. Locate the plastic piece that mounts over the trunk latch running the width of the trunk. Pull the four christmas tree fasteners off and remove the plastic piece.
2. Peel the insulation in the trunk back to expose the rear frame rail and mount the flasher there (Fig. 1). The insulation is held on by christmas tree fasteners.
3. Peel the insulation back from the taillight and remove the three 11mm bolts securing the taillight assembly. Unplug the taillight from the vehicle harness and remove the taillight assembly.
4. Following the wiring diagram, cut the 3 wires that go to the outer taillight. Be sure to leave enough wire on each end to attach a connector.
5. Attach a PIN connector to the end of the wires coming from the taillight and a SOCKET connector to the end of the wires coming from the vehicle. Repeat this step for the 3 inner taillight wires.
6. Plug the harness into the flasher as shown then plug the other end of the harness into the connectors you attached in step 5. Repeat steps 3 through 5 for the other taillight.
7. Locate the input connector and plug it into the flasher. Extend the RED wire to +12 volts and fuse @ 7.5 amps Extend the BLACK wire to ground and test the system.
8. The lighthead will not work if plugged into the socket incorrectly. If any of the lights do not light up, pull the lighthead out and re-insert them reversing the orientation and test again.

Wiring Diagram

Driver side shown. Passenger side will connect the same. Connect to vehicle depending on your vehicles wiring. (See below)

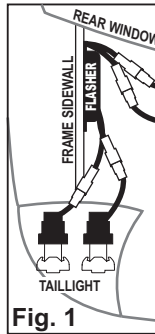
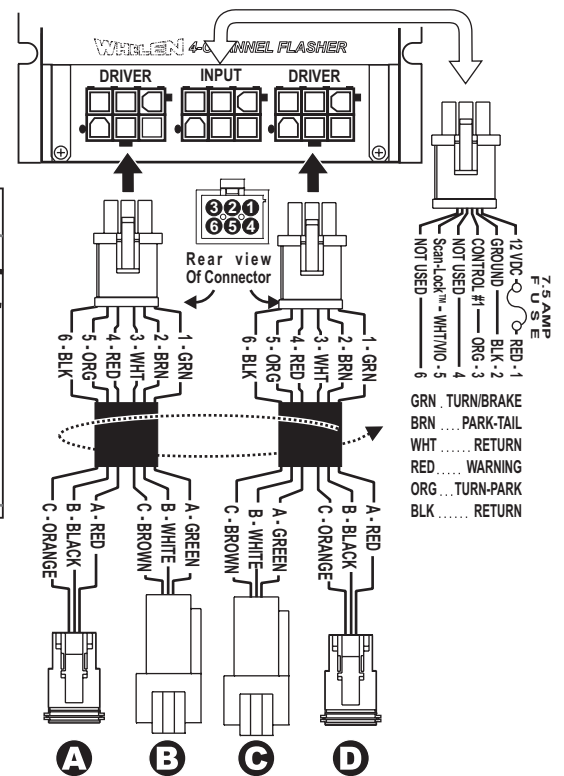
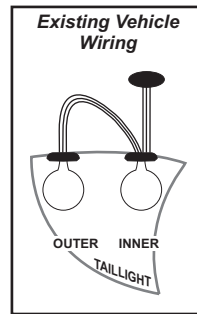

Fig. 1



Splice vehicle wiring as shown here



2007 1/2 - 2009

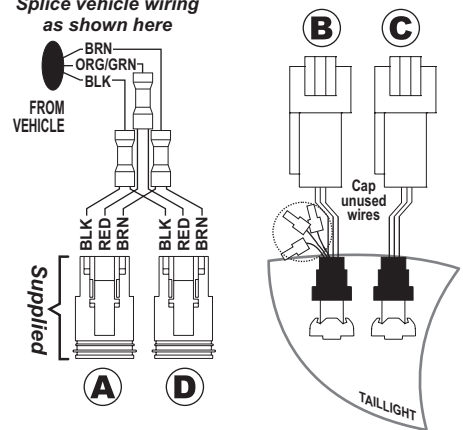

Installation / 2007.5 - 2009

1. Locate the plastic piece that mounts over the trunk latch running the width of the trunk. Pull the four christmas tree fasteners off then remove the plastic piece.
2. Peel the insulation in the trunk back to expose the rear frame rail and mount the flasher there (Fig. 1). The insulation is held on by christmas tree fasteners.
3. Peel the insulation back from the taillight and remove the three 11mm bolts securing the taillight assembly. Unplug the taillight from the vehicle harness and remove the taillight assembly.
4. Find the wires coming from the vehicle to the taillight and splice them into the 2 supplied connectors as shown.
5. Plug the harness into the flasher as shown then plug the other end of the harness into the connectors you attached in step 4. Repeat for other taillight.
6. Locate the input connector and plug it into the flasher. Extend the RED wire to +12 volts and fuse @ 7.5 amps Extend the BLACK wire to ground and test the system.
7. The lighthead will not work if plugged into the socket incorrectly. If any of the lights do not light up, pull the lighthead out and reinsert them reversing the orientation and test again.
8. Install the lighthead into the taillight housings and remount the housings.

Wiring & Operation:

The flasher is powered & controlled by 5 wires in the control cable:

RED: 12 volts VDC (Fuse @ 7.5 amps) BLACK: Ground ORANGE: Control Wire Apply 12 volts to activate warning lights. (Fuse @ 1 amp) **WHITE/ VIOLET: Scan-Lock™ Flash pattern selection.** (Fuse @ 1 amp)

IMPORTANT WARNING: Do not attempt to use the LED lighthouse without the flasher module connected.

IMPORTANT WARNING! All customer supplied wires that connect to the positive terminal of the battery must be sized to supply at least 125% of the maximum operating current and FUSED at the battery to carry the load. DO NOT USE CIRCUIT BREAKERS WITH THIS PRODUCT!

Scan-Lock™ (WHITE/VIOLET)

To change the flash patterns for the following features, observe these conditions:

Warning Lights: Only warning lights must be activated. Parking and turn should be off.

Turn Signal/Brake: Parking lights and hazard lights activated and warning lights off.

With the appropriate function activated:

TO CHANGE PATTERNS: Apply +12 volts to the WHT/VIO wire for less than 1 second and release to cycle forward to the next available pattern. Apply +12 volts to the WHT/VIO wire for more than 1 second and release to cycle back to the previous pattern.

TO CHANGE THE DEFAULT PATTERN: When the desired pattern is displayed, allow it to run for more than 5 seconds. The lighthouse will now display this pattern when initially activated.

TO RESTORE THE FACTORY DEFAULT PATTERN: This will reset all patterns back to their default settings. Disconnect main power and apply power to the WHT/VIO wire. With power applied to the WHT/VIO wire, turn main power back on.

A Normally Open momentary switch can be used to control Scan-Lock™ operation.

Scan-Lock Default settings:

Warning SignalAlert™
Signal SteadyBrake

Turn Signal Override:

Active/Default Turn signal (or brake) overrides warning light

Available Flash Patterns:

1.SignalAlert™ ALT	17.SingleFlash 375 SIM
2.SignalAlert™ SIM	18.SingleFlash 375 ALT-SIM
3.SignalAlert™ ALT-SIM	19.DoubleFlash 75 ALT
4.Comet Flash® ALT	20.DoubleFlash 75 SIM
5.Comet Flash® SIM	21.DoubleFlash 75 ALT-SIM
6.Comet Flash® ALT-SIM	22.ActionFlash™ SIM
7.LongBurst™ ALT	23.ModuFlash™
8.LongBurst™ SIM	24.ActionScan™
9.LongBurst™ ALT-SIM	25.Signal: BrakeAlert
10.SingleFlash 75 ALT	26.SteadyBrake
11.SingleFlash 75 SIM	ALT = Alternating
12.SingleFlash 75 ALT-SIM	SIM = Simultaneous
13.SingleFlash 150 ALT	ALT/SIM = Alternating-Simultaneous
14.SingleFlash 150 SIM	
15.SingleFlash 150 ALT-SIM	
16.SingleFlash 375 ALT	

IMPORTANT WARNING!
CAUTION! DO NOT LOOK DIRECTLY AT THESE LED'S WHILE THEY ARE ON. MOMENTARY BLINDNESS OR EYE DAMAGE COULD RESULT!

IMPORTANT! Before returning this vehicle to active service, visually confirm the proper operation of this product, as well as all vehicle components and equipment.

The Deutsch water-proof connector will not function properly unless it is connected exactly as the manufacturer intended. A Deutsch crimping tool (Whelen p/n 66T0516435119C) is required for proper terminal crimping and should be used whenever possible. If a non-Deutsch crimp tool is used, the cable wires must first be pushed through the rubber connector grommet BEFORE the pin terminal is crimped. This will reduce the possibility of damaging the water-tight seal around the wires. Whelen Engineering does not recognize the use of a non-Deutsch crimping tool, any resulting damage would void the warranty.

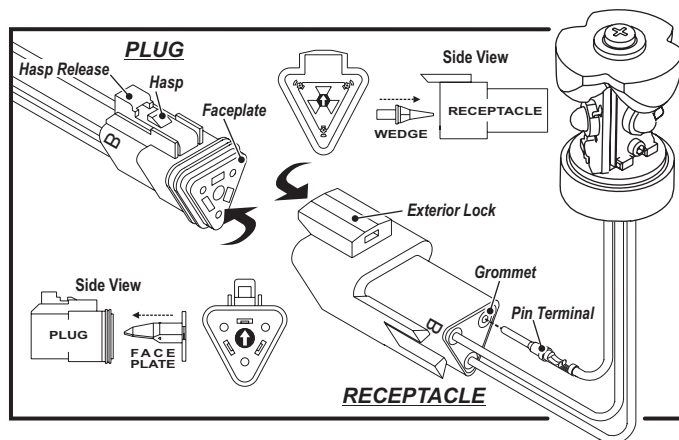

Wires coming from the lamp MUST be connected to the receptacle housing. Wires from the power supply MUST be connected to the plug housing. Refer to Figure 4 for an overview of all related components. Be sure to insert the wires into the receptacle so that they will connect with the correct plug wire. Example: The wire in receptacle section A is the wire that is designated to be connected to the wire in plug section A.

Assembly: Locate the cable that will be used between the lamp and the receptacle section of the waterproof connector. Locate the leads that have the "barrel"-style pins crimped onto the wires. Grasp the wire approximately 1" behind the contact barrel. Hold the receptacle so that the

QTY	QTY	ITEM	PART NUMBER	DESCRIPTION
	*		01-1517676-02	2 LT. REAR LED HIDE-A-WAY SYSTEM / 2006 CROWN VIC
*			01-1517676-04	4 LT. REAR LED HIDE-A-WAY SYSTEM / 2006 CROWN VIC
4	2	1	01-0264445-55	ASSY / LED HIDE-A-WAY LAMP / RED-RED
1	1	2	01-0264734-00	ASSY / ELECT REAR HIDE-A-WAY FLASHER
1	1	3	46-0764711-07	INPUT HARNESS / 4-CHANNEL / LED HIDE-A-WAY
2	1	4	46-0764711-02	OUTPUT HARNESS / 5' / LED HIDE-A-WAY
2	1	5	46-0764711-03	OUTPUT HARNESS / 15' / LED HIDE-A-WAY
4	2	6	39-1H16424-3S	WEDGE / SOCKET 3-POSITION DEUTSCH / Not shown
4	2	7	39-1H16424-3P	WEDGE / PIN 3-POSITION DEUTSCH / Not shown
4	2	8	39-1H03024-35	HOUSING / SOCKET 3-POSITION DEUTSCH
4	2	9	39-1H03014-35	HOUSING / PIN 3-POSITION DEUTSCH
12	6	10	39-1H00326-35	SOCKET / WATERPROOF
12	6	11	39-1H00316-35	PIN / WATERPROOF

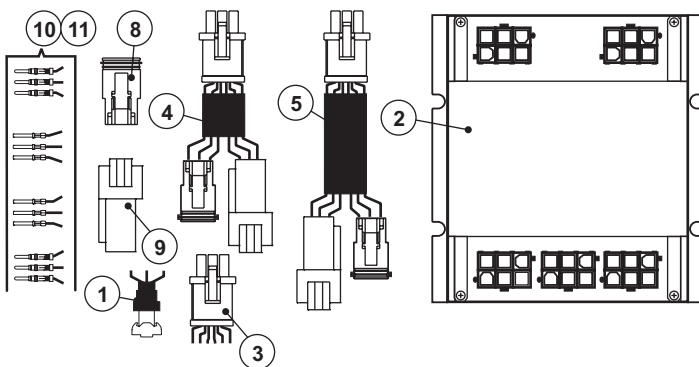

grommet is facing you. Push the pin straight into the grommet until a "click" is felt. A gentle tug will confirm that it is locked into place. Once all the pins are installed, insert the wedge into the receptacle. Be sure that the arrow on the wedge is pointing towards the exterior lock.

NOTE: Although the above text outlines the procedure for assembling the receptacle, the same procedure is used for the plug. The plug utilizes a faceplate instead of a wedge. It can be removed with a small screwdriver.

Contact Removal: Remove the wedge with either a pair of needle nose pliers (if removing contacts from the receptacle section) or a small, regular screwdriver (for the faceplate of the plug section). To remove the contacts, gently pull the desired wire back away from the grommet. At the same time, release the locking finger by moving it away from the contact with a screwdriver. Be sure to hold the rear seal in place, as removing the contact will disrupt its position.