

## WHELEN<sup>®</sup> ENGINEERING COMPANY INC.

51 Winthrop Road,  
Chester, Connecticut 06412-0684  
Phone: (860) 526-9504  
Fax: (860) 526-4078

### Installation Guide: Beacon Mirror Mount Model: MIRROR15 and MIRROR20

Internet: [www.whelen.com](http://www.whelen.com)  
Sales e-mail: [autosale@whelen.com](mailto:autosale@whelen.com)  
Canadian Sales e-mail: [autocan@whelen.com](mailto:autocan@whelen.com)  
Customer Service e-mail: [custserv@whelen.com](mailto:custserv@whelen.com)

#### Mirror Mount Installation:

1. Secure the bracket to the mirror (or other part of the vehicle) using the two supplied U-Bolts and elastic stop nuts.
2. Secure the Beacon to the bracket using the supplied sheet metal screws and elastic stop nuts.

**IMPORTANT!** It is the responsibility of the installation technician to make sure that the installation and operation of this product will not interfere with or compromise the operation or efficiency of any vehicle equipment!

**IMPORTANT!** Before returning the vehicle to active service, visually confirm the proper operation of this product, as well as all vehicle components/equipment.

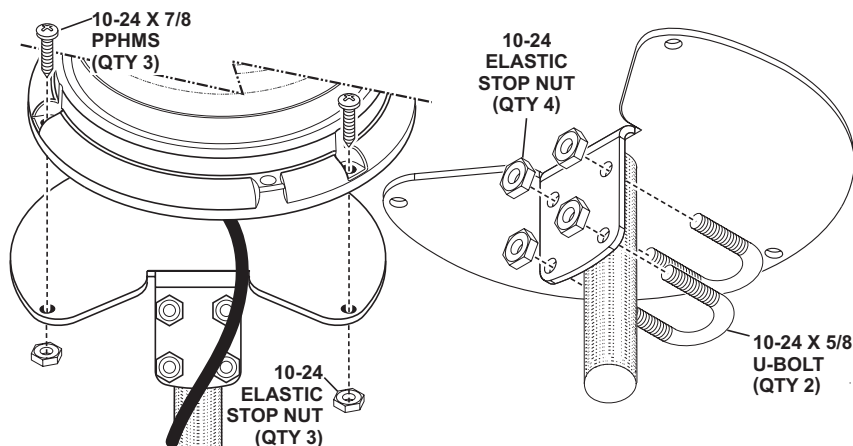

©2008 Whelen Engineering Company Inc.  
Form No.14164 (010408)

For warranty information regarding this product, visit [www.whelen.com/warranty](http://www.whelen.com/warranty)

## WHELEN<sup>®</sup> ENGINEERING COMPANY INC.

51 Winthrop Road,  
Chester, Connecticut 06412-0684  
Phone: (860) 526-9504  
Fax: (860) 526-4078

### Installation Guide: Beacon Mirror Mount Model: MIRROR15 and MIRROR20

Internet: [www.whelen.com](http://www.whelen.com)  
Sales e-mail: [autosale@whelen.com](mailto:autosale@whelen.com)  
Canadian Sales e-mail: [autocan@whelen.com](mailto:autocan@whelen.com)  
Customer Service e-mail: [custserv@whelen.com](mailto:custserv@whelen.com)

#### Mirror Mount Installation:

1. Secure the bracket to the mirror (or other part of the vehicle) using the two supplied U-Bolts and elastic stop nuts.
2. Secure the Beacon to the bracket using the supplied sheet metal screws and elastic stop nuts.

**IMPORTANT!** It is the responsibility of the installation technician to make sure that the installation and operation of this product will not interfere with or compromise the operation or efficiency of any vehicle equipment!

**IMPORTANT!** Before returning the vehicle to active service, visually confirm the proper operation of this product, as well as all vehicle components/equipment.

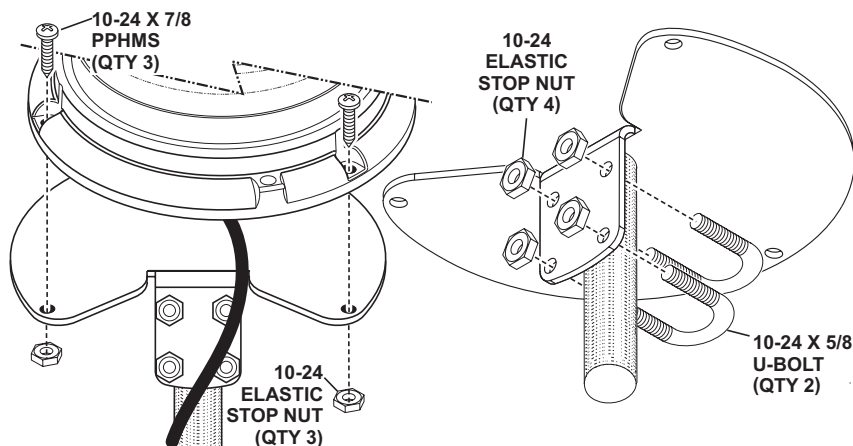

©2008 Whelen Engineering Company Inc.  
Form No.14164 (010408)

For warranty information regarding this product, visit [www.whelen.com/warranty](http://www.whelen.com/warranty)