

WHELEN[®]

ENGINEERING COMPANY INC.

51 Winthrop Road
Chester, Connecticut 06412-0684
Phone: (860) 526-9504
Fax: (860) 526-4078
Internet: www.whelen.com
Sales e-mail: autosale@whelen.com
Canadian Sales e-mail: canadiansales@whelen.com
Customer Service e-mail: custserv@whelen.com

Installation Guide:
VI Pod LED Mini-Lightbar
Models: 6PODMA, 6PODPA

Warnings to Installers

Whelen's emergency vehicle warning devices must be properly mounted and wired in order to be effective and safe. Read and follow all of Whelen's written instructions when installing or using this device. Emergency vehicles are often operated under high speed stressful conditions which must be accounted for when installing all emergency warning devices. Controls should be placed within convenient reach of the operator so that he can operate the system without taking his eyes off the roadway. Emergency warning devices can require high electrical voltages and/or currents. Properly protect and use caution around live electrical connections. Grounding or shorting of electrical connections can cause high current arcing, which can cause personal injury and/or vehicle damage, including fire. Many electronic devices used in emergency vehicles can create or be affected by electromagnetic interference. Therefore, after installation of any electronic device it is necessary to test all electronic equipment simultaneously to insure that they operate free of interference from other components within the vehicle. Never power emergency warning equipment from the same circuit or share the same grounding circuit with radio communication equipment. All devices should be mounted in accordance with the manufacturer's instructions and securely fastened to vehicle elements of sufficient strength to withstand the forces applied to the device. Driver and/or passenger air bags (SRS) will affect the way equipment should be mounted. This device should be mounted by permanent installation and within the zones specified by the vehicle manufacturer, if any. Any device mounted in the deployment area of an air bag will damage or reduce the effectiveness of the air bag and may damage or dislodge the device. Installer must be sure that this device, its mounting hardware and electrical supply wiring does not interfere with the air bag or the SRS wiring or sensors. Mounting the unit inside the vehicle by a method other than permanent installation is not recommended as unit may become dislodged during swerving; sudden braking or collision. Failure to follow instructions can result in personal injury. Whelen assumes no liability for any loss resulting from the use of this warning device. **PROPER INSTALLATION COMBINED WITH OPERATOR TRAINING IN THE PROPER USE OF EMERGENCY WARNING DEVICES IS ESSENTIAL TO INSURE THE SAFETY OF EMERGENCY PERSONNEL AND THE PUBLIC.**

Warnings to Users

Whelen's emergency vehicle warning devices are intended to alert other operators and pedestrians to the presence and operation of emergency vehicles and personnel. However, the use of this or any other Whelen emergency warning device does not guarantee that you will have the right-of-way or that other drivers and pedestrians will properly heed an emergency warning signal. Never assume you have the right-of-way. It is your responsibility to proceed safely before entering an intersection, driving against traffic, responding at a high rate of speed, or walking on or around traffic lanes. Emergency vehicle warning devices should be tested on a daily basis to ensure that they operate properly. When in actual use, the operator must ensure that both visual and audible warnings are not blocked by vehicle components (i.e.: open trunks or compartment doors), people, vehicles, or other obstructions. It is the user's responsibility to understand and obey all laws regarding emergency warning devices. The user should be familiar with all applicable laws and regulations prior to the use of any emergency vehicle warning device. Whelen's audible warning devices are designed to project sound in a forward direction away from the vehicle occupants. However, because sustained periodic exposure to loud sounds can cause hearing loss, all audible warning devices should be installed and operated in accordance with the standards established by the National Fire Protection Association.

Safety First

This document provides all the necessary information to allow your Whelen product to be properly and safely installed. Before beginning the installation and/or operation of your new product, the installation technician and operator must read this manual completely. Important information is contained herein that could prevent serious injury or damage.

- **Proper installation of this product requires the installer to have a good understanding of automotive electronics, systems and procedures.**
- **Whelen Engineering requires the use of waterproof butt splices and/or connectors if that connector could be exposed to moisture.**
- **Failure to use specified installation parts and/or hardware will void the product warranty.**
- **If mounting this product requires drilling holes, the installer MUST be sure that no vehicle components or other vital parts could be damaged by the drilling process. Check both sides of the mounting surface before drilling begins. Also de-burr the holes and remove any metal shards or remnants. Install grommets into all wire passage holes.**
- **If this manual states that this product may be mounted with suction cups, magnets, tape or Velcro®, clean the mounting surface with a 50/50 mix of isopropyl alcohol and water and dry thoroughly.**
- **Do not install this product or route any wires in the deployment area of your air bag. Equipment mounted or located in the air bag deployment area will damage or reduce the effectiveness of the air bag, or become a projectile that could cause serious personal injury or death. Refer to your vehicle owner's manual for the air bag deployment area. The User/Installer assumes full responsibility to determine proper mounting location, based on providing ultimate safety to all passengers inside the vehicle.**
- **For this product to operate at optimum efficiency, a good electrical connection to chassis ground must be made. The recommended procedure requires the product ground wire to be connected directly to the NEGATIVE (-) battery post (this does not include products that use cigar power cords).**
- **If this product uses a remote device for activation or control, make sure that this device is located in an area that allows both the vehicle and the device to be operated safely in any driving condition.**
- **Do not attempt to activate or control this device in a hazardous driving situation.**
- **This product contains either strobe light(s), halogen light(s), high-intensity LEDs or a combination of these lights. Do not stare directly into these lights. Momentary blindness and/or eye damage could result.**
- **Use only soap and water to clean the outer lens. Use of other chemicals could result in premature lens cracking (crazing) and discoloration. Lenses in this condition have significantly reduced effectiveness and should be replaced immediately. Inspect and operate this product regularly to confirm its proper operation and mounting condition. Do not use a pressure washer to clean this product.**
- **It is recommended that these instructions be stored in a safe place and referred to when performing maintenance and/or reinstallation of this product.**
- **FAILURE TO FOLLOW THESE SAFETY PRECAUTIONS AND INSTRUCTIONS COULD RESULT IN DAMAGE TO THE PRODUCT OR VEHICLE AND/OR SERIOUS INJURY TO YOU AND YOUR PASSENGERS!**

IMPORTANT! The lightbar should be a minimum of 16" from any radio antennas!

Mirror Mounting:

This light is available with a 1" bolt for mounting to a DOT mirror. The mirror bracket and mounting hardware are not supplied. A West Coast bracket is shown here for example.

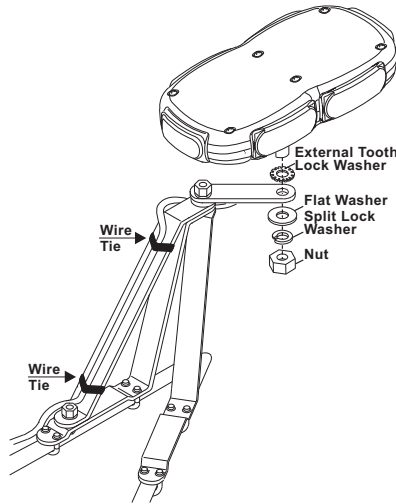

Temporary Mount: Magnetic, Suction Cup

WARNING: The use of any magnetically mounted warning device on the outside of a vehicle in motion is not recommended and is at the sole risk and responsibility of the user.

Magnetic/suction: Thoroughly clean the proposed mounting surface prior to mounting. For suction cup mounting, wipe the suction cup clean, place the lightbar onto its mounting surface and apply gentle pressure to ensure a good seal has been achieved. The Magnetic/Suction Cups mount the same way as standard suction cups but are best suited to a flat, steel surface. **Magnetic:** Place the lightbar onto the mounting surface and plug it into the vehicle cigar lighter. **NOTE: For an uneven mounting surface, loosen the screws that secure the magnets 1/2 turn. The magnets will now tilt slightly and conform to the mounting surface.**

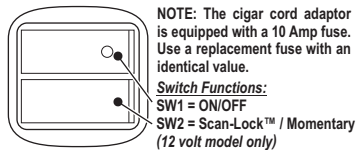

Connection and Operation:

WARNING! All customer supplied wires that connect to the positive terminal of the battery must be sized to supply at least 125% of the maximum operating current and FUSED at the battery to carry that load. DO NOT USE CIRCUIT BREAKERS WITH THIS PRODUCT!

This lightbar is powered and controlled by a 5 conductor cable. If you have a cigar plug model, the low power and sync features are not available.

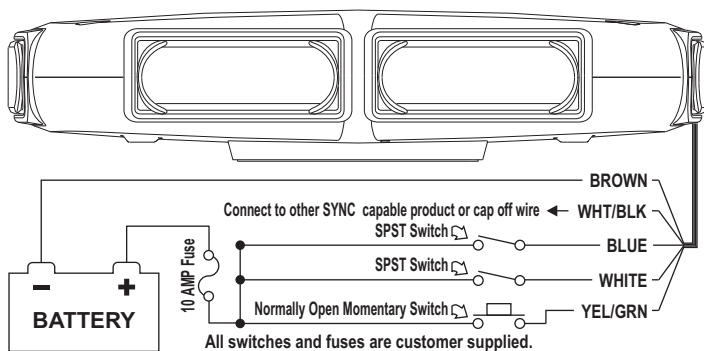

WIRE COLOR-FUNCTION CONNECTION
WHITE: Positive +12V DC Connect to the positive terminal of battery
BROWN: Negative Connect to ground
BLUE: Low Power Connect to customer supplied switch (See Hi/Low Power)
WHT/BLK: SYNC Connect to SYNC wire of other SYNC capable lights
YEL/GRN: Scan-Lock™ Flash patterns Connect to momentary switch

BLUE (Low Power): Reduces output to low power for night use.

Latching Mode: By applying +VBAT to the BLUE wire for less than 1 second, the light is "latched" into low power. The unit must be turned off and then back on to restore normal high power operation (Momentary switch).

Level Mode: Applying +VBAT to the BLUE wire for more than 1 second holds the lightbar in low power mode until voltage is removed (Toggle switch).

YELLOW/GREEN / Scan-Lock™ / Flash Pattern Selection:

To change the flash pattern, the light must be powered up.

TO CHANGE PATTERNS: To advance to the next pattern apply +12VDC to the YEL/GRN wire for less than 1 second and release. To cycle back to the previous pattern apply +12VDC to the WHITE wire for more than 1 second and release.

TO CHANGE THE DEFAULT PATTERN: When the desired pattern is displayed, allow it to run for more than 5 seconds. The light will now display this pattern when initially activated.

TO RESTORE THE FACTORY DEFAULT PATTERN: With the light turned off, apply power to the YEL/GRN wire. With power applied to the YEL/GRN wire, turn the light on. Allow the unit to run for 3 seconds before removing power from the YEL/GRN wire.

A Normally Open momentary switch should be used to control Scan-Lock™ operation.

WHITE/BLACK / SYNC / Light Synchronization:

To SYNC two or more PODS, configure both PODS to display the same Phase 1 pattern. Turn power off and connect the WHT/BLK wires from each POD together. When activated, the patterns from each POD will be synchronized. To configure specific PODS to alternate their patterns with other PODS, advance the pattern of either POD to Phase 2 of the current pattern.

MODE	PHASE 1: Active lights	PHASE 2: Active lights
	Simultaneous "A"	All lamps
Simultaneous "B"	No lamps	All lamps
Alternating	Lamps 1, 2 & 6	3, 4 & 5

Available Flash Patterns:

- Signal Alert™ 75 Phase-1 / SYNC
- Signal Alert™ 75 Phase-2 / SYNC
- Signal Alert™ 75 ALT / SYNC
- CometFlash® 75 Phase-1 / SYNC
- CometFlash® 75 Phase-2 / SYNC
- CometFlash® 75 ALT / SYNC
- DoubleFlash 75 Ph.-1 / CAL / SYNC
- DoubleFlash 75 Ph.-2 / CAL / SYNC
- DoubleFlash 75 ALT / CAL / SYNC
- SingleFlash 75 Ph.-1 / CAL / SYNC
- SingleFlash 75 Ph.-2 / CAL / SYNC
- SingleFlash 75 ALT / CAL / SYNC
- Com-Alert™ 75 Phase 1 / SYNC
- Com-Alert™ 75 Phase 1 / SYNC
- Com-Alert™ 75 ALT / SYNC
- Com-Alert™ 75 ALT / SYNC
- LongBurst™ 75 Phase 1 / SYNC
- LongBurst™ 75 Phase 2 / SYNC
- LongBurst™ 75 ALT / SYNC
- PingPong™ 75 Ph.-1 / CAL / SYNC
- PingPong™ 75 Ph.-2 / CAL / SYNC
- PingPong™ 75 ALT / CAL / SYNC
- SingleFlash 60 Phase 1 / CAL
- SingleFlash 60 ALT / CAL
- SingleFlash 90 Phase 1 / CAL
- SingleFlash 90 ALT / CAL
- SingleFlash 120 Phase 1 / CAL
- SingleFlash 120 ALT / CAL
- SingleFlash 300 Phase 1
- SingleFlash 300 ALT
- DoubleFlash 150 Phase 1
- DoubleFlash 150 ALT
- Com-Alert™ 150 Phase 1
- Com-Alert™ 150 ALT
- ActionFlash™ 50 Phase 1
- ActionFlash™ 50 ALT
- ActionFlash™ 150 Phase 1
- ActionFlash™ 150 ALT
- ModuFlash™ Phase 1
- ModuFlash™ ALT
- FlimFam™ ALT
- DoubleFlash 120 Phase 1 / CAL
- DoubleFlash 120 ALT / CAL
- PingPong™ 120 Phase 1 / CAL
- PingPong™ 120 ALT / CAL
- TripleFlash™ 75 Phase 1 / CAL
- TripleFlash™ 75 ALT / CAL
- TripleFlash™ 120 Phase 1 / CAL
- TripleFlash™ 120 ALT / CAL
- SignalAlert™ Ph1 / CAL
- SignalAlert™ ALT / CAL
- ActionFlash™ SF60/120 Ph.1 / CAL
- ActionFlash™ SF60/120 / CAL
- ActionFlash™ SF120/TF75 Ph1 / CAL
- ActionFlash™ SF120/TF75 / CAL
- CalScan™ Phase 1 / CAL
- CalScan™ ALT / CAL
- ActionScan™ Phase 1
- ActionScan™ ALT
- 40% Steady / CAL
- 18 Steady
- 5 Steady
- 0.8 Steady

IMPORTANT! It is the responsibility of the installation technician to make sure that the installation and operation of this product will not interfere with or compromise the operation or efficiency of any vehicle equipment!

IMPORTANT WARNING!
CAUTION! DO NOT LOOK DIRECTLY AT THESE LED'S WHILE THEY ARE ON. MOMENTARY BLINDNESS AND/OR EYE DAMAGE COULD RESULT!

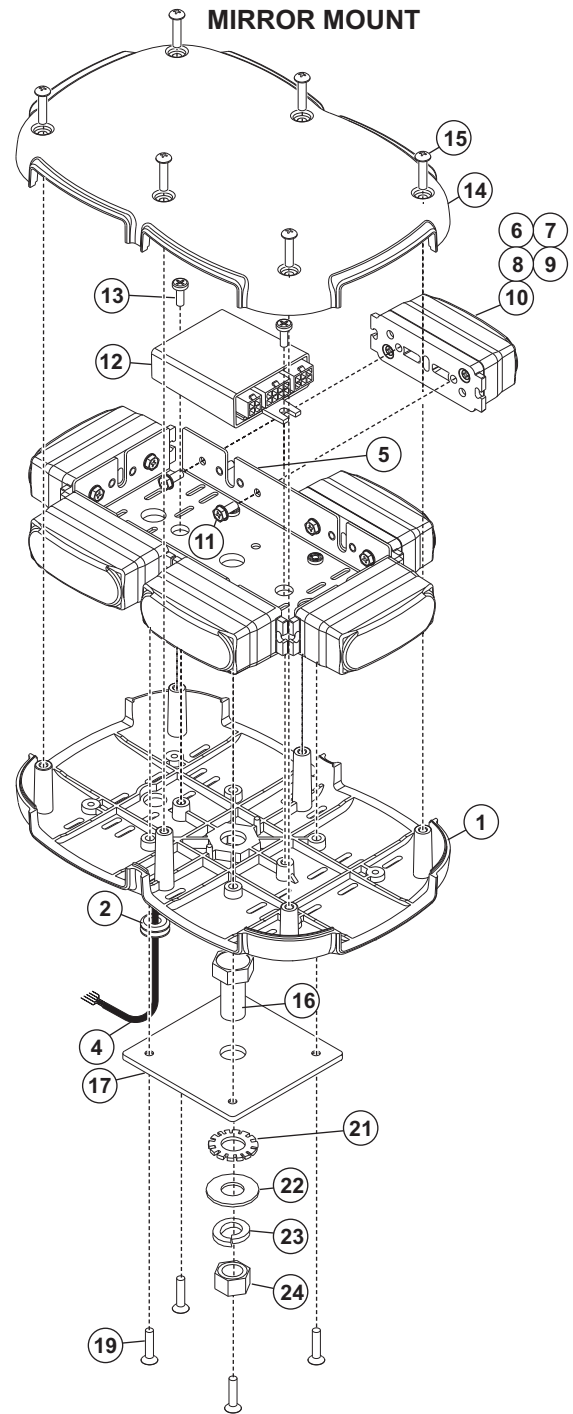
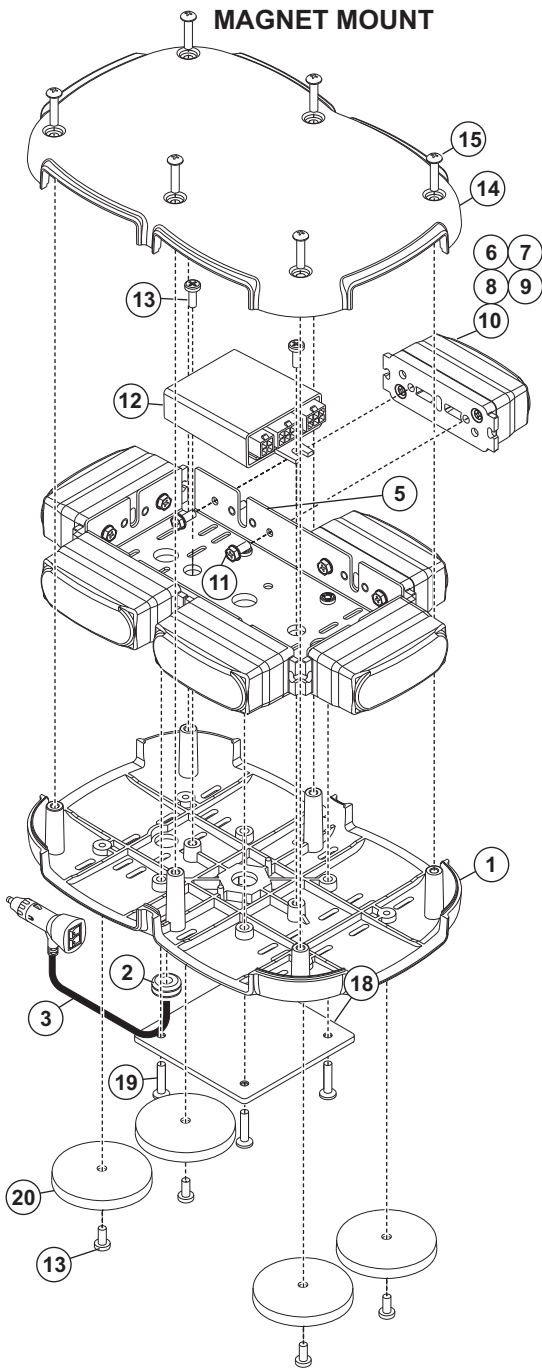

QTY	QTY	ITEM	PART NUMBER	DESCRIPTION
	*		01-0686233	VI POD SERIES / MAGNET MOUNT
*			01-0686233	VI POD SERIES / MIRROR MOUNT
1	1	1	11-386161-000	HOUSING / BASE 6-LINZ6 LTHD MNT
1	1	2	21-11091202-0	GROMMET / 3/8" #905
-	1	3	02-0243606-02	CORD / 2 SWITCH CIGAR PLUG with MINI UMNL
1	-	4	46-0742938-00	CABLE 5/C 18 GA TPR 20' STRIP 8' UMNL SCKT 1 END
1	1	5	07-26B120-000	BRACKET / HEATSINK LTHEAD MNT DOT MIRROR MNT
A/R	A/R	6	01-026B042214	ELECT LINZ6 AMBER STEADY MUMNL
A/R	A/R	7	01-026B042224	ELECT LINZ6 BLUE STEADY MUMNL
A/R	A/R	8	01-026B042234	ELECT LINZ6 WHITE STEADY MUMNL
A/R	A/R	9	01-026B042244	ELECT LINZ6 GREEN STEADY MUMNL
A/R	A/R	10	01-026B042254	ELECT LINZ6 RED STEADY MUMNL
12	12	11	15-081916-066	SCREW / 8 X 3/8 PHEXWASHHD SS 400 SERIES

1	1	12	01-026B423-00	FLASHER VI POD SERIES
2	6	13	15-085416-060	SCREW / 8 X 3/8 PPH PLASTILOC SS OR BLK OXIDE
1	1	14	11-286162-000	HOUSING / TOP 6-LINZ6 LTHD MNT
6	6	15	15-085416-100	SCREW / 8 X 5/8 PPH PLASTI-LOC SS
1	-	16	14-173436-240	BOLT / 1/2-13 X 1-1/2 HEX HEAD SS
1	-	17	06-143815-000	BASEPLATE, LIGHTHEAD MOUNT MIRROR MOUNT
-	1	18	06-143815-001	BASEPLATE / LIGHTHEAD MOUNT MAGNETIC
4	4	19	14-082116-120	SCREW / 8-32 X 3/4 PFHMS
-	4	20	65-0010191-00	MAGNET / X-50 RESPONDER NICKLE PLATED
1	-	21	16-1712920-40	WASHER - 1/2" EXTERNAL TOOTH LOCK, SS
1	-	22	16-1704020-80	WASHER - 1/2" FLAT SS 1/2 ID X 1 1/4 OD X .060
1	-	23	16-1732720-14	WASHER - 1/2" SPLIT LOCK STAINLESS STEEL
1	-	24	13-173120-120	NUT - 1/2-13 HEX SS