

WHELEN[®]
ENGINEERING COMPANY INC.

Route 145, Winthrop Road,
Chester, Connecticut 06412
Phone: (860) 526-9504
Fax: (860) 526-4078

**Installation Guide: Fender Mounting Bracket
Model M2FNDR for TIR3 Series Lighthood
2008/2009 Harley-Davidson[®]**

Internet: www.whelen.com
Sales e-mail: autosale@whelen.com
Canadian Sales e-mail: autocan@whelen.com
Customer Service e-mail: custserv@whelen.com

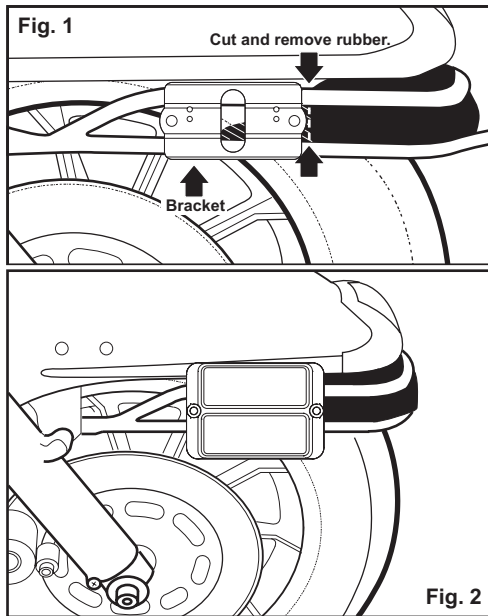

Installation:

1. First remove the reflector from the rubber bumper located inside the front guard.
2. Now cut and remove just enough rubber from the rear of the bumper to fit the bracket (Fig. 1).
3. Slide the mounting bracket behind the guard and secure the flange, lighthoods and anchor plate to the bracket using the two supplied 8-32 X 5/8 Phillips Pan Head Metal Screws (Figs. 2 & 3).
4. Extend the wires toward the headlight assembly (see reverse).

WARNING! All customer supplied wires that connect to the positive terminal of the battery must be sized to supply at least 125% of the maximum operating current and **FUSED** at the battery to carry that load. **DO NOT USE CIRCUIT BREAKERS WITH THIS PRODUCT!**

IMPORTANT! It is the responsibility of the installation technician to make sure that the installation and operation of this product will not interfere with or compromise the operation or efficiency of any vehicle equipment!

©2009 Whelen Engineering Company Inc.
Form No.14282 (032509)

For warranty information regarding this product, visit www.whelen.com/warranty

WHELEN[®]
ENGINEERING COMPANY INC.

Route 145, Winthrop Road,
Chester, Connecticut 06412
Phone: (860) 526-9504
Fax: (860) 526-4078

**Installation Guide: Fender Mounting Bracket
Model M2FNDR for TIR3 Series Lighthood
2008/2009 Harley-Davidson[®]**

Internet: www.whelen.com
Sales e-mail: autosale@whelen.com
Canadian Sales e-mail: autocan@whelen.com
Customer Service e-mail: custserv@whelen.com

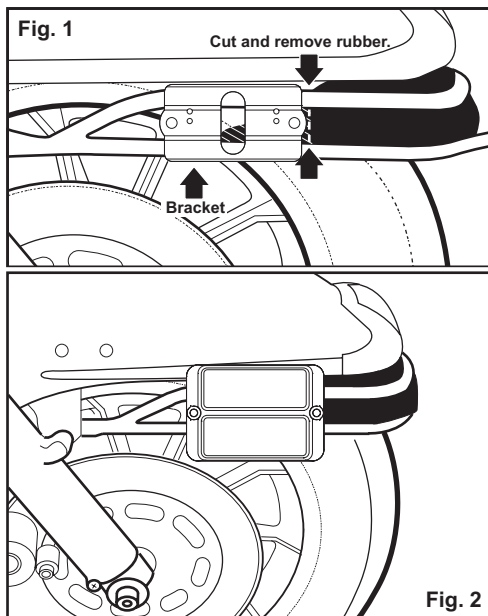

Installation:

1. First remove the reflector from the rubber bumper located inside the front guard.
2. Now cut and remove just enough rubber from the rear of the bumper to fit the bracket (Fig. 1).
3. Slide the mounting bracket behind the guard and secure the flange, lighthoods and anchor plate to the bracket using the two supplied 8-32 X 5/8 Phillips Pan Head Metal Screws (Figs. 2 & 3).
4. Extend the wires toward the headlight assembly (see reverse).

WARNING! All customer supplied wires that connect to the positive terminal of the battery must be sized to supply at least 125% of the maximum operating current and **FUSED** at the battery to carry that load. **DO NOT USE CIRCUIT BREAKERS WITH THIS PRODUCT!**

IMPORTANT! It is the responsibility of the installation technician to make sure that the installation and operation of this product will not interfere with or compromise the operation or efficiency of any vehicle equipment!

©2009 Whelen Engineering Company Inc.
Form No.14282 (032509)

For warranty information regarding this product, visit www.whelen.com/warranty

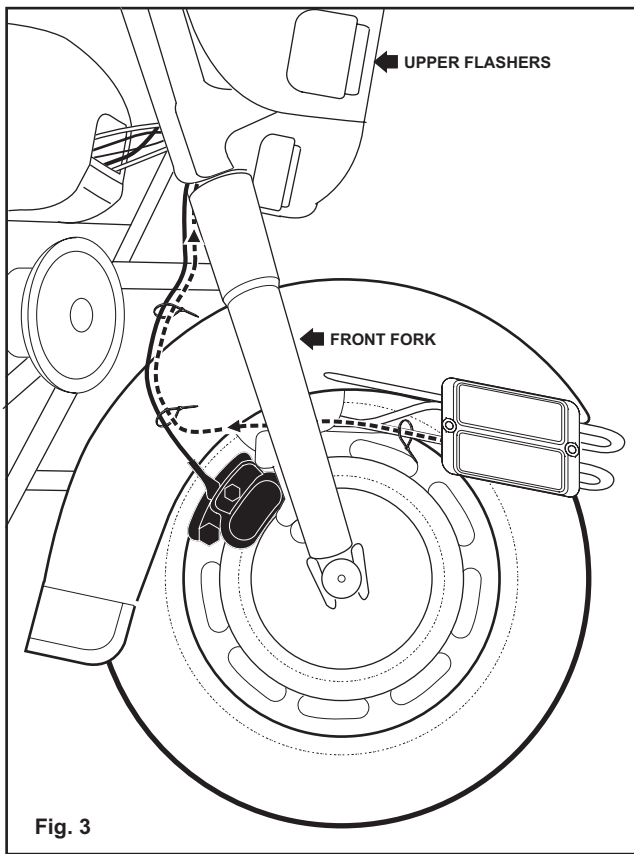

Wiring:

WARNING! For this installation you will secure the lighthead wires to the vehicle's brake line. You must be absolutely sure that when you attach the wires they do not bind or interfere with the brake line or any other vehicle components when the wheel is turned. Also take care not to run the wires too close to the tire.

1. Extend the wires toward the headlight assembly where they will connect to the terminals that power the upper front flashers. As you extend the lighthead wires, first secure them to the chrome guard the lighthead is mounted onto with ty-wraps or other suitable fasteners as shown (Fig. 3). You will want to run the wires behind the chrome guard and front fork so they will not show.
2. Run the wires along the path of the brake line and secure them to the brake line making sure the wire has plenty of play in it and will not interfere in any way with the brake line or other wiring when the wheel is turned.

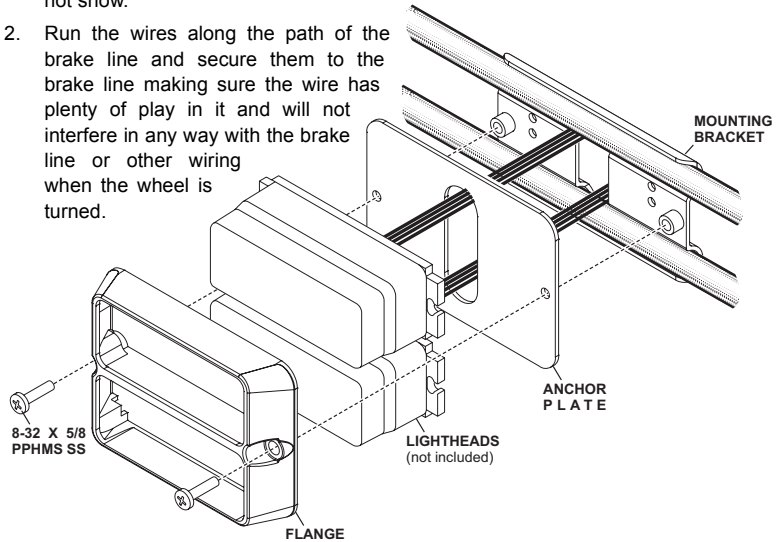

3. Extend the wires up to the headlight assembly where you will connect them to the same circuit that controls the upper front flashers. Refer to your motorcycle manual and the manual that comes with the lighthead for proper wiring.

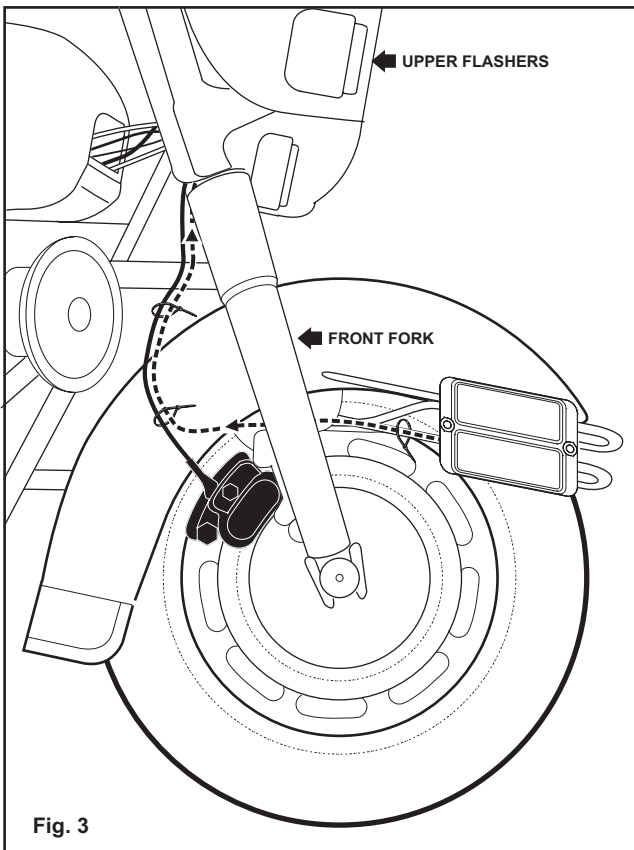

Wiring:

WARNING! For this installation you will secure the lighthead wires to the vehicle's brake line. You must be absolutely sure that when you attach the wires they do not bind or interfere with the brake line or any other vehicle components when the wheel is turned. Also take care not to run the wires too close to the tire.

1. Extend the wires toward the headlight assembly where they will connect to the terminals that power the upper front flashers. As you extend the lighthead wires, first secure them to the chrome guard the lighthead is mounted onto with ty-wraps or other suitable fasteners as shown (Fig. 3). You will want to run the wires behind the chrome guard and front fork so they will not show.
2. Run the wires along the path of the brake line and secure them to the brake line making sure the wire has plenty of play in it and will not interfere in any way with the brake line or other wiring when the wheel is turned.

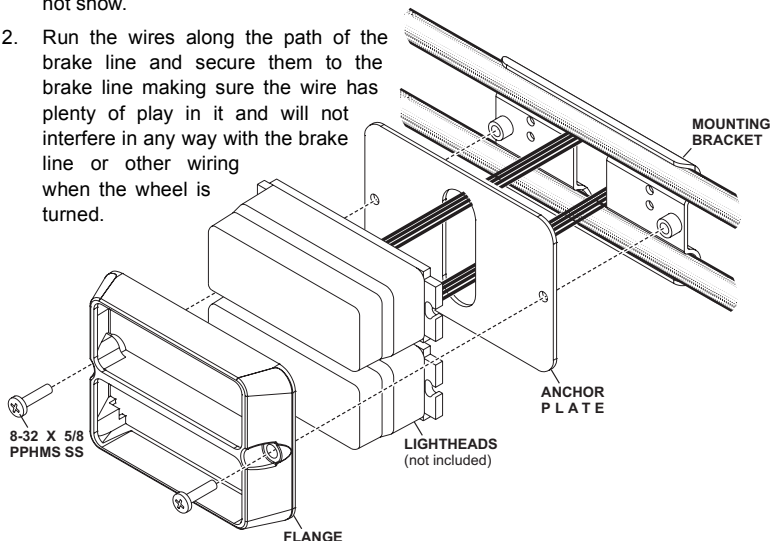

3. Extend the wires up to the headlight assembly where you will connect them to the same circuit that controls the upper front flashers. Refer to your motorcycle manual and the manual that comes with the lighthead for proper wiring.