

# WHELEN<sup>®</sup>

ENGINEERING COMPANY INC.

51 Winthrop Road  
 Chester, Connecticut 06412-0684  
 Phone: (860) 526-9504  
 Fax: (860) 526-2009  
 Internet: [www.whelen.com](http://www.whelen.com)  
 Sales/Service e-mail: [aviation@whelen.com](mailto:aviation@whelen.com)

## Installation Guide: 71182( )-series Model(s) 7118201, 7118202 P/N(s): 01-0771182-01 01-0771182-02 LED Forward Position Light Assembly

TSO-C30c  
 TYPES I & II  
 APPROVED



*The conditions and tests required for TSO approval of this article are minimum performance standards. It is the responsibility of those installing this article either on or within a specific type or class of aircraft to determine that the aircraft installation conditions are within the TSO standards. TSO articles must have separate approval for installation in aircraft. The article may be installed only if performed under 14 CFR part 43 or the applicable airworthiness requirements.*

### OPERATING INSTRUCTIONS:

**Nominal Operational Voltage:** . . . 28 VDC (nominal)  
**Input Current:** . . . . . 0.32 Amps  
**Weight** . . . . . 0.25 lbs.

**EQUIPMENT LIMITATIONS:** An approved forward position lighting system consists of two lights, one located on each wingtip, mounted behind a clear lens.

**CONTINUED AIRWORTHINESS:** The 71182 series LED wingtip position light assembly is designed with 6 LED's. If any one LED fails, the unit must be repaired or replaced.

**INSTALLATION PROCEDURES:** The following information is to assist in the installation of a Whelen LED forward position light system.

1. Choose the appropriate 71182( ) series light assembly.
2. The installation procedure described in the following text will be confined to a single light installation, but is identical for multiple light installations.
3. Make sure the system is equipped with an appropriate sized breaker. Connect the +28VDC lead to position A on the input cable assembly (supplied with the light assembly). Connect the existing ground lead to position B wire on the input cable assembly or use the supplied connector as shown in the illustrations. Both leads must be connected by an approved FAA connection. Insure that the wire leads clear of any obstructions and ty-wrap as required.
4. Position the base of the new light assembly onto the mounting surface. Insert three (3) #6 x 100° flat head screws into the mounting holes and tighten firmly.
5. Check all avionics systems for interference from the installation.
6. A flight check should be performed by a properly certified pilot.
7. Update aircraft records, complete Form 337 and obtain FAA field approval for installation, as required.

**Model(s):**  
 7118201 (Green)  
 7118202 (Red)

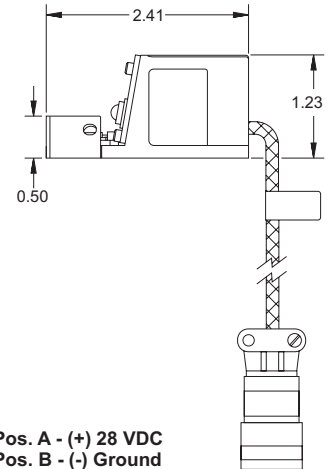

**Model(s):**  
 7118201  
 7118202

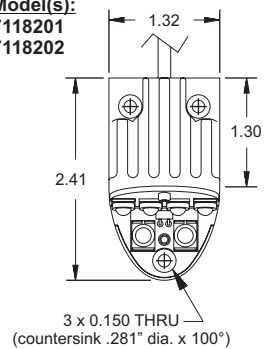

Aviation

**Models Shown:**

7118201 (P/N 01-0771182-01)

7118202 (P/N 01-0771182-02)

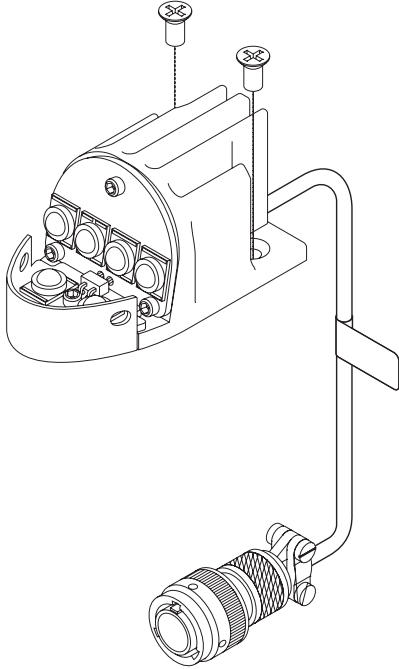

**Mounting Dimensions**

