

# WHELEN<sup>®</sup>

ENGINEERING COMPANY INC.

51 Winthrop Road  
 Chester, Connecticut 06412-0684  
 Phone: (860) 526-9504  
 Fax: (860) 526-2009  
 Internet: www.whelen.com  
 Sales/Service e-mail: aviation@whelen.com

**Installation Guide:**  
**Model(s) 7118400, 7118401**  
**P/N(s) 01-0771184-00**  
**01-0771184-01**

## LED Anti-Collision Light Ass'y

TSO-C96a  
 CLASS II;  
 APPROVED



The conditions and tests required for TSO approval of this article are minimum performance standards. It is the responsibility of those installing this article either on or within a specific type or class of aircraft to determine that the aircraft installation conditions are within the TSO standards. TSO articles must have separate approval for installation in aircraft. The article may be installed only if performed under 14 CFR part 43 or the applicable airworthiness requirements.

### SPECIFICATIONS:

Total Weight ..... .65 lbs.

### EQUIPMENT LIMITATIONS:

An approved forward anti-collision system consists of at least 2 lighthead units, each connected to a model 7114800 Flasher.

Certain types of installations may require additional testing.

### CONTINUED AIRWORTHINESS:

The wingtip anti-collision light is designed with 24 LEDs. If any one fails, the unit must be repaired or replaced.

**Note:** To reduce eye strain use an optical filter such as dark glasses or a blue covering dome during LED inspection.

Note: The anti-collision lights will automatically shut-off after 9-10 flashes if a failure is detected, when used with model 7114800.

### INSTALLATION PROCEDURES:

The following information is to assist you in installing a Whelen anti-collision light system.

1. The installation procedure described in the following text will be confined to a single light installation, but is identical for multiple light installations.
2. Connect the anti-collision inputs according to the chart shown. Connections to be in accordance with FAA approved methods.
3. Using appropriate, approved hardware, install light assembly and insure that all leads are clear of any obstructions and ty-rop as required. Secure light assembly, using vibration resistant threaded fasteners.
4. Check all avionics systems for interference from this installation.
5. A flight check should be performed by a properly certified pilot.
6. Update aircraft records, complete Form 337 and obtain FAA field approval for installation, as necessary.

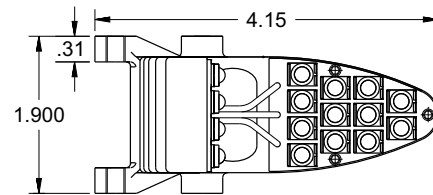

7118400 Shown

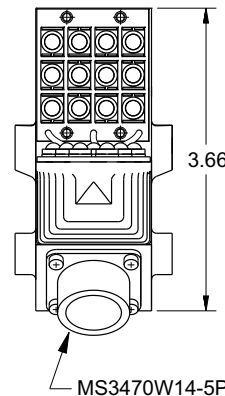
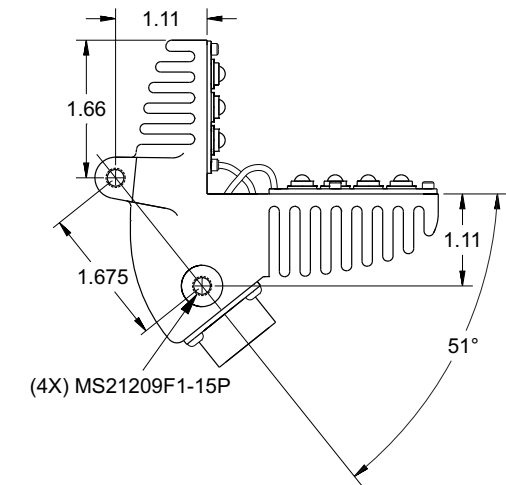

J1 SIGNAL	CONTACT
ANODE	A
CATHODE 1	B
CATHODE 2	C
CATHODE 3	D
CATHODE 4	E

Aviation