

## WHELEN<sup>®</sup> ENGINEERING COMPANY INC.

51 Winthrop Road,  
Chester, Connecticut 06412-0684  
Phone: (860) 526-9504  
Fax: (860) 526-4078

### Installation Guide: Grommet Mount LINZ6, LIN3 and TIR3 Lightheads

Internet: [www.whelen.com](http://www.whelen.com)  
Sales e-mail: [autosale@whelen.com](mailto:autosale@whelen.com)  
Canadian Sales e-mail: [canadiansales@whelen.com](mailto:canadiansales@whelen.com)  
Customer Service e-mail: [custserv@whelen.com](mailto:custserv@whelen.com)

#### Installation:

**Caution:** Permanent mounting of this product will require drilling. It is absolutely necessary to make sure that no other vehicle components could be damaged by this process. Check both sides of the mounting surface before starting. If damage is likely, select a different mounting location.

1. Mark the mounting hole dimensions onto the mounting surface using the **exact** measurements shown below and carefully cut the mounting hole into the surface. Carefully de-burr the opening.

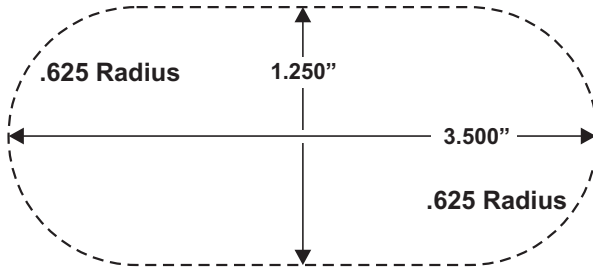

2. Secure the grommet to the lighthead with the 2 supplied #4 X 5/8 Plasti-Loc screws and washers. **Do not to overtighten the screws.**

©2010 Whelen Engineering Company Inc.  
Form No.14361B (061912)

For warranty information regarding this product, visit [www.whelen.com/warranty](http://www.whelen.com/warranty)

3. Extend the lighthead wires to your power source and make the connections following the lighthead instructions.

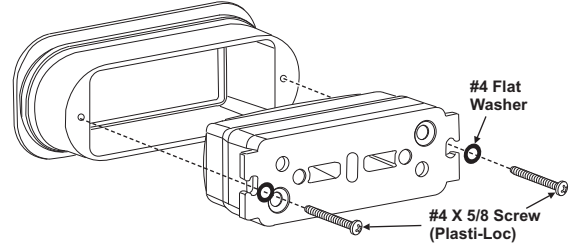

**WARNING!** All customer supplied wires that connect to the positive terminal of the battery must be sized to supply at least 125% of the maximum operating current and **FUSED** at the battery to carry that load. **DO NOT USE CIRCUIT BREAKERS WITH THIS PRODUCT!**

4. Push the grommet into the mounting hole until it snaps into place and installation is complete.

**IMPORTANT!** It is the responsibility of the installation technician to make sure that the installation and operation of this product will not interfere with or compromise the operation or efficiency of any vehicle equipment!

## WHELEN<sup>®</sup> ENGINEERING COMPANY INC.

51 Winthrop Road,  
Chester, Connecticut 06412-0684  
Phone: (860) 526-9504  
Fax: (860) 526-4078

### Installation Guide: Grommet Mount LINZ6, LIN3 and TIR3 Lightheads

Internet: [www.whelen.com](http://www.whelen.com)  
Sales e-mail: [autosale@whelen.com](mailto:autosale@whelen.com)  
Canadian Sales e-mail: [canadiansales@whelen.com](mailto:canadiansales@whelen.com)  
Customer Service e-mail: [custserv@whelen.com](mailto:custserv@whelen.com)

#### Installation:

**Caution:** Permanent mounting of this product will require drilling. It is absolutely necessary to make sure that no other vehicle components could be damaged by this process. Check both sides of the mounting surface before starting. If damage is likely, select a different mounting location.

1. Mark the mounting hole dimensions onto the mounting surface using the **exact** measurements shown below and carefully cut the mounting hole into the surface. Carefully de-burr the opening.

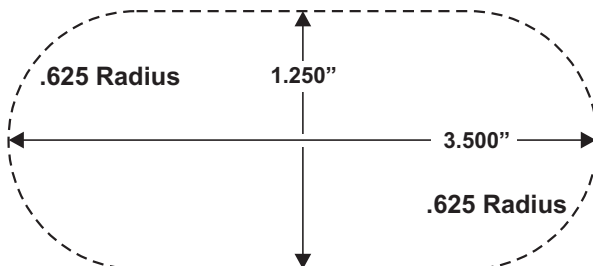

2. Secure the grommet to the lighthead with the 2 supplied #4 X 5/8 Plasti-Loc screws and washers. **Do not to overtighten the screws.**

©2010 Whelen Engineering Company Inc.  
Form No.14361B (061912)

For warranty information regarding this product, visit [www.whelen.com/warranty](http://www.whelen.com/warranty)

3. Extend the lighthead wires to your power source and make the connections following the lighthead instructions.

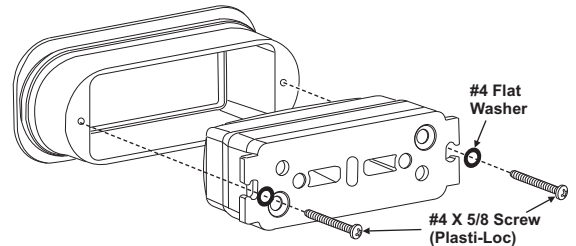

**WARNING!** All customer supplied wires that connect to the positive terminal of the battery must be sized to supply at least 125% of the maximum operating current and **FUSED** at the battery to carry that load. **DO NOT USE CIRCUIT BREAKERS WITH THIS PRODUCT!**

4. Push the grommet into the mounting hole until it snaps into place and installation is complete.

**IMPORTANT!** It is the responsibility of the installation technician to make sure that the installation and operation of this product will not interfere with or compromise the operation or efficiency of any vehicle equipment!