

WHELEN[®]

ENGINEERING COMPANY INC.

51 Winthrop Road
 Chester, Connecticut 06412-0684
 Phone: (860) 526-9504
 Fax: (860) 526-2009
 Internet: www.whelen.com
 Sales/Service e-mail: aviation@whelen.com

Installation Guide:
Aviation model(s): 9058800
P/N: 01-0790588-00
LED Anti-Collision Light Assembly



TSO-C96a
CLASS II;
APPROVED



SPECIFICATIONS:

Nominal Operational Voltage:..... 28VDC
(Operation from 22-32 VDC)
Input Current (Average):..... 0.67 Amps
Pulse @ 0.25 Sec.:..... 3.9 Amps
Flashrate: 45± 5 per min.

EQUIPMENT LIMITATIONS:

An approved lighting system consists of two lights, one located on each wingtip. The baseplate must be mounted parallel to the vertical and horizontal centerlines of the aircraft to project the patterns properly.

Certain types of installations may require additional testing.

CONTINUED AIRWORTHINESS:

The anti-collision light is designed with 36 LED's. If any one LED fails, the unit must be repaired or replaced. Inspect the lens. Replace if there is excessive scratching, pitting, discoloration or cracking.

Note: The anti-collision light will automatically shut-off after 9-10 flashes if a failure is detected.

INSTALLATION PROCEDURES:

The following information is to assist in the installation of a Whelen Anti-Collision light system.

1. The installation procedure described in the following text will be confined to a single light installation, but is identical for multiple light installations.
2. Connect the anti-collision inputs according to the chart shown. Connect the power lead to an appropriately sized breaker. Connections to be in accordance with FAA approved methods.
3. Using appropriate hardware, install light assembly and insure that all leads are clear of any obstructions and ty-rap as required. Secure light assembly, using vibration resistant threaded fasteners. Note that proper orientation of the unit is achieved when the "TOP" label is facing up.

The conditions and tests required for TSO approval of this article are minimum performance standards. It is the responsibility of those installing this article either on or within a specific type or class of aircraft to determine that the aircraft installation conditions are within the TSO standards. TSO articles must have separate approval for installation in aircraft. The article may be installed only if performed under 14 CFR part 43 or the applicable airworthiness requirements.

4. Check all avionics systems for interference from this installation.
5. A flight check should be performed by a properly certified pilot.
6. When necessary, waterproof the light base to aircraft. Apply single part silicone (RTV) or equivalent around any open area where water could get in.
7. Update aircraft records, complete Form 337 and obtain FAA field approval for installation, as necessary.

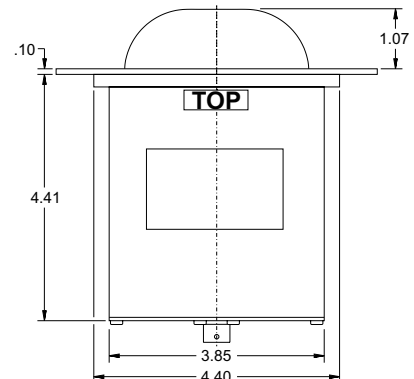
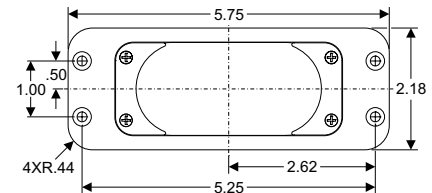
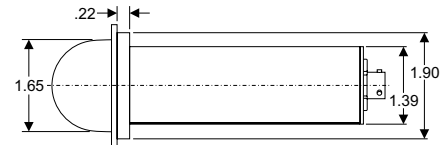

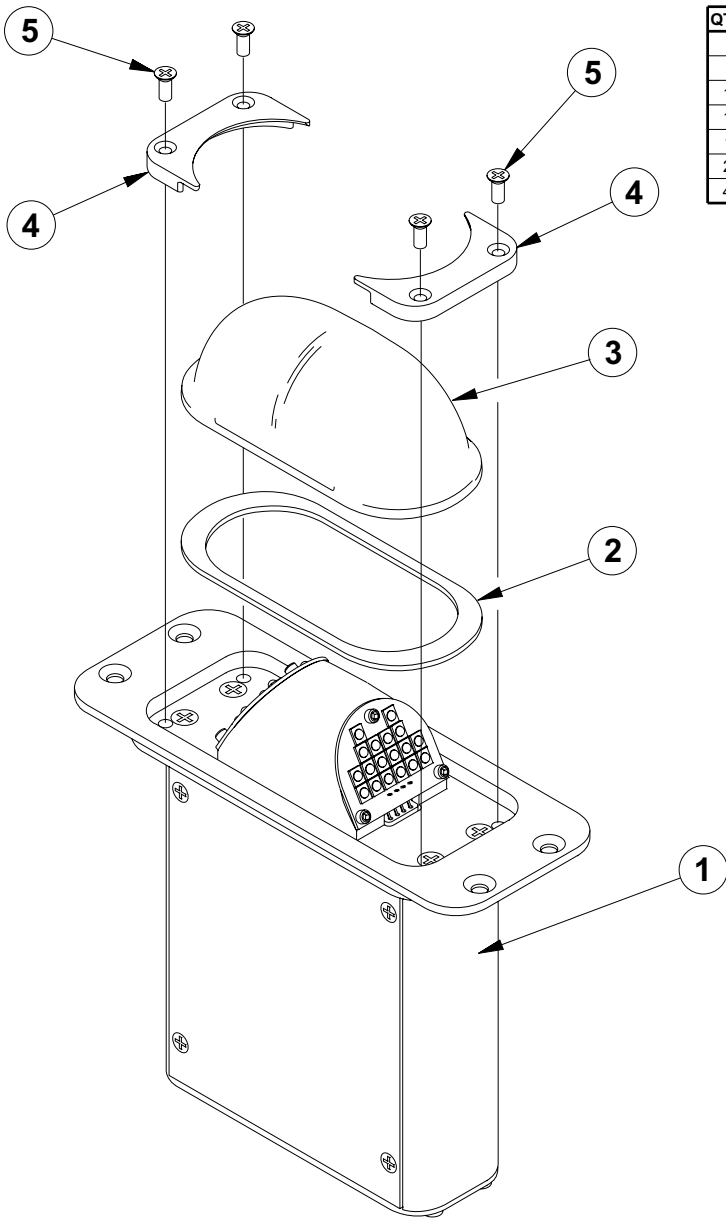

QTY	ITEM	PART NUMBER	DESCRIPTION
		01-0790588-00	ASS'Y, ANTI-COLLISION LIGHT MODEL 9058800
1	1	01-0290602-00	ASS'Y, LIGHTHEAD, 9058800
1	2	38-0151009-00	GASKET, LENS
1	3	68-3971498A30	LENS, HARD COAT
2	4	19-151005-100	RETAINER, LENS
4	5	14-0050581-03	SCREW, 4-40 X 5/16 FHMS 100° COUNTERSINK

REAR VIEW

MS27508E8F98P CONNECTOR
 POSITION A = 28VDC
 POSITION B = SYNC
 POSITION C = GROUND

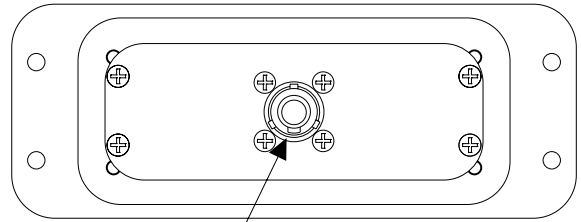

KEY ORIENTATION