

WHELEN[®]

ENGINEERING COMPANY INC.

51 Winthrop Road
 Chester, Connecticut 06412-0684
 Phone: (860) 526-9504
 Fax: (860) 526-2009
 Internet: www.whelen.com
 Sales/Service e-mail: aviation@whelen.com

Installation Guide: Aviation model: 7106502 P/N: 01-0771065-02

LED Ground Recognition Light Assembly

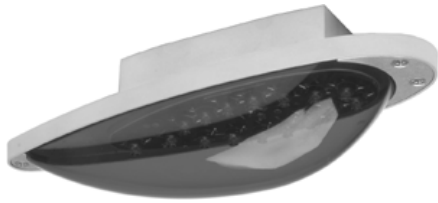

SPECIFICATIONS:

Nominal Operational Voltage:..... 28VDC
 Input Current:..... 0.53 Amps
 Pulse @ 0.2 Sec.:..... 2.0 Amps
 Flashrate: 80± 10% per min.

EQUIPMENT LIMITATIONS:

The baseplate must be mounted parallel to the vertical and horizontal centerlines of the aircraft to project the patterns properly.

CONTINUED AIRWORTHINESS:

The Ground Recognition Light, Model 7106502, consists of two banks of eight LEDs, for a total of 16 LEDs. If one LED fails as a short, the other 15 will continue to operate. If an LED fails open, all eight LEDs in that bank will be off, the other bank will operate normally. There is no FAR requirement for this light. Inspect the lens. Replace if there is excessive scratching, pitting, discoloration or cracking.

INSTALLATION PROCEDURES:

The following information is to assist in the installation of a Whelen Ground Recognition Light.

- Using the mounting detail information provided, prepare the aircraft for means to secure the LED light assembly.
- Connect the light inputs according to the chart shown. Connect the power lead to an appropriate sized breaker. Connections to be in accordance with FAA approved methods.
- Remove the lens retainers and lens from the assembly CAUTION! Do not touch the LED lens surface with either fingers or sharp objects. This could soil and/or damage the lens and effect the optical performance of the LED.
- Using appropriate hardware, install light assembly and insure that all leads are clear of any obstructions and secured as required. Secure light assembly using vibration resistant threaded fasteners.
- Reinstall the lens. Confirm proper gasket fit.

- Install lens retainers. Re-insert #6 flat head screws and tighten firmly.
- When necessary, waterproof the light base to aircraft. Apply single part silicone (RTV) or equivalent around any open area where water could get in, with the exception of the drain hole.
- Check all avionics systems for interference from the installation.
- A flight check should be performed by a properly certified pilot.
- Update aircraft records, complete Form 337 and obtain FAA field approval for installation, as necessary.

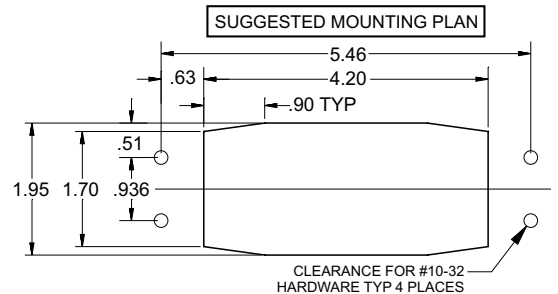
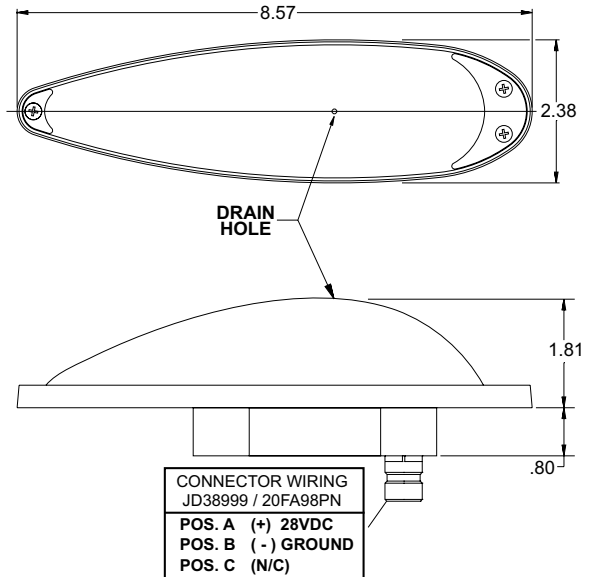

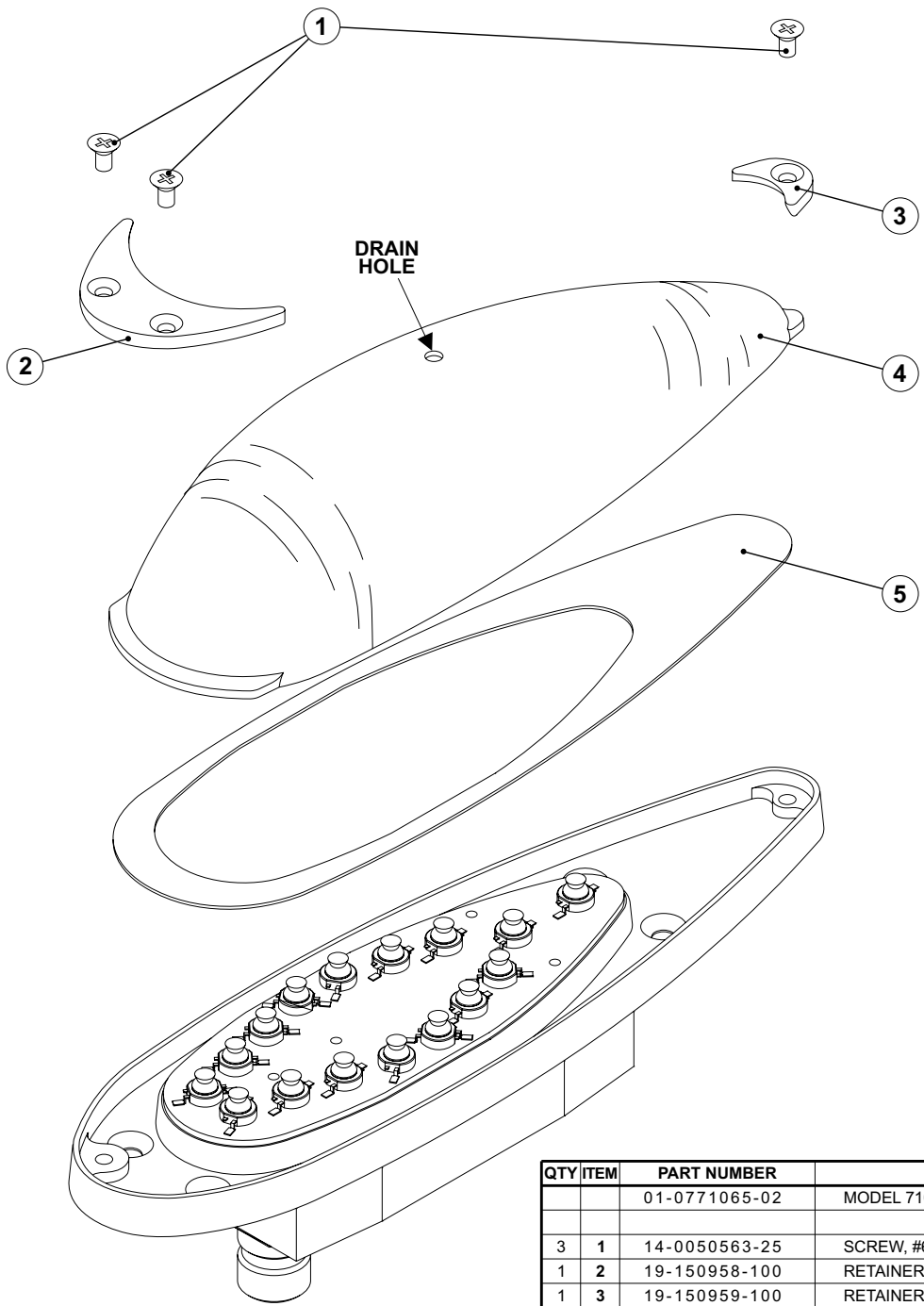

QTY	ITEM	PART NUMBER	DESCRIPTION
		01-0771065-02	MODEL 7106502 FINAL ASSEMBLY LOWER MOUNT
3	1	14-0050563-25	SCREW, #6-32 X 5/16 PFHMS MS24693-25
1	2	19-150958-100	RETAINER, LENS - FRONT
1	3	19-150959-100	RETAINER, LENS - REAR
1	4	68-4971307A51	LENS, RED
1	5	38-0271342-00	GASKET, LENS