

WHELEN[®]

ENGINEERING COMPANY INC.

51 Winthrop Road
 Chester, Connecticut 06412-0684
 Phone: (860) 526-9504
 Fax: (860) 526-2009
 Internet: www.whelen.com
 Sales/Service e-mail: aviation@whelen.com

Installation Guide: Model 9076950 P/N:01-0790769-50 LED Anti-Collision/Ground Recognition Light Assembly Lower Mount

TSO-C96a
 CLASS II;
 APPROVED



The conditions and tests required for TSO approval of this article are minimum performance standards. It is the responsibility of those installing this article either on or within a specific type or class of aircraft to determine that the aircraft installation conditions are within the TSO standards. TSO articles must have separate approval for installation in aircraft. The article may be installed only if performed under 14 CFR part 43 or the applicable airworthiness requirements.

SPECIFICATIONS:

Nominal Operational Voltage:..... 28 VDC
 (Operation from 22-32 VDC)
Input Current:
LED Anti-Collision Light (Pulse@.25 Sec.) 3.2 Amps
LED Ground Recognition Light (Pulse@.25 Sec.) ... 1.0 Amps
Flashrate..... 45 ±5 / Min.

EQUIPMENT LIMITATIONS: An approved Anti-Collision light assembly should be located so that the light will not impair the crews vision or detract from the conspicuity of the position lights. The baseplate must be mounted parallel to the vertical and horizontal centerlines of the aircraft to project the patterns properly. Model 9076950 is designed to be mounted to the underside of the fuselage. Model 9076950 is designed for use with anti-collision lights with a SYNC output.

Certain types of aircraft may require additional testing.
CONTINUED AIRWORTHINESS: The anti-collision light is designed with 24 outboard forward-facing white LEDs. the ground recognition is designed with 18 red LEDs. Should any one white LED fail, the unit must be repaired or replaced. **Note:** To reduce eye strain use an optical filter such as dark glasses or a blue covering dome during LED inspection.

Inspect the lens and replace if there is excessive scratching, pitting, discoloration or cracking.

INSTALLATION PROCEDURES: The following information is to assist in the installation of a Whelen LED Anti-collision Light.

- Using the mounting detail information provided, prepare the aircraft for means to secure the LED Light assembly.
- Connect the light inputs according to the chart shown. Connect the power lead to an appropriately sized breaker. Connections to be in accordance with FAA approved methods.
- Carefully remove the Phillips screw and lens retainer. **CAUTION:** Do not touch the LEDs with either fingers or sharp objects. This could soil and/or damage the LEDs and effect the optical performance of the light.
- Using the appropriate hardware install the baseplate gasket and LED assembly to the aircraft. Insure that all leads are clear of any obstructions and secured as required.
- Reinstall gasket, lens and retainer. Confirm proper gasket fit. Reinsert screws and tighten firmly.
- Check all avionics systems for interference from this installation.
- A flight check should be performed by a properly certified pilot.
- Update aircraft records, complete Form 337 and obtain FAA field approval for installation, as necessary.

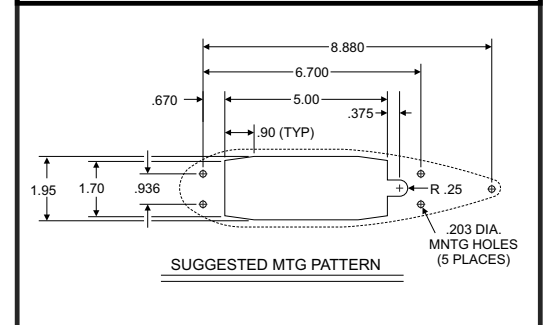
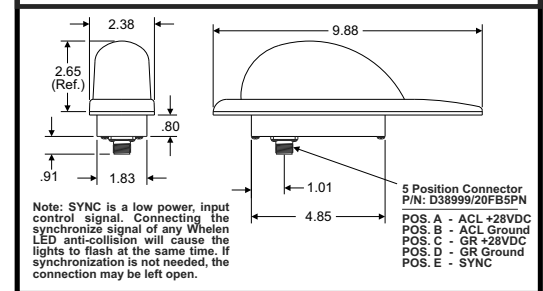
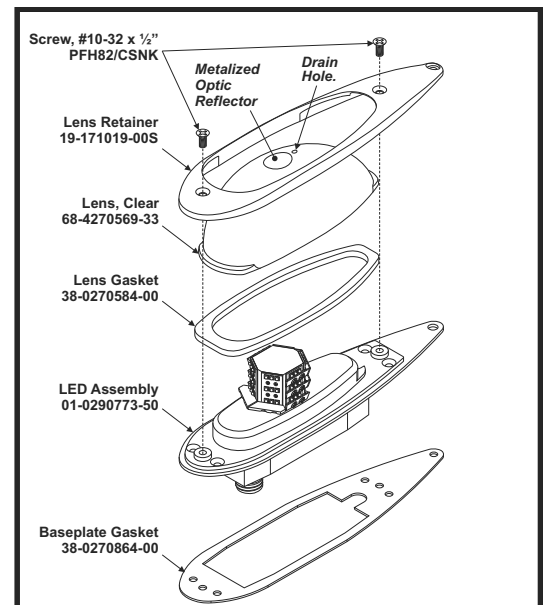

Aviation