

Avenger™ Series

SELF-CONTAINED SUPER-LED® DASH/DECK WARNING SIGNALS



The Avenger is a compact little light with a big attitude! Avenger packs full-size Super-LED power. This is serious warning protection in a small package that's easy to mount or transfer from vehicle to vehicle.

FEATURES

- Small size and clear outer lenses make Avenger barely detectable until powered on.
- Single, dual or split module, Linear Super-LEDs.
- Lightweight and sturdy. Rated for 100,000 hours of operation.
- Polycarbonate assembly is safer than metal in the event of an accident or airbag deployment.
- Multiple Scan-Lock™ flash patterns.
- Five year HDP® Heavy-Duty Professional warranty.

AVN Models

- Standard swivel/bail bracket with three suction cups.
- Snap-on polycarbonate hood secures with two screws, minimizing flashback to the driver.
- Ten foot straight cord with cigar plug with switches for On/Off function and Scan-Lock flash pattern control.

AVNS Synchronized Models

- Synchronized models for unified warning lighting on your vehicle.
- Standard swivel/bail bracket with three suction cups.
- Snap-on polycarbonate hood secures with two screws, minimizing flashback to the driver.
- Phase 1 and Phase 2 for alternate and simultaneous flashing.
- 4-wire pigtail, standard.

AVNCV9 Models

- Straddles 3rd brake light with two Linear-LED® lightheades in molded polycarbonate housing for 2005-2011 Ford Crown Victoria.
- Includes two Linear Super-LEDs modules.
- External low power control.
- 4-wire pigtail, standard.



WHELEN®

Avenger™ Series Specifications

FLASH PATTERNS

AVN1 Single

| Pattern | CAL |
|---------------------|-----|
| SignalAlert™ 75 | - |
| CometFlash™ 75 | - |
| DoubleFlash 75 | yes |
| SingleFlash 75 | yes |
| ComAlert™ 75 | - |
| LongBurst™ 75 | - |
| PingPong™ 75 | yes |
| SingleFlash 60 | yes |
| SingleFlash 90 | yes |
| SingleFlash 120 | yes |
| SingleFlash 300 | - |
| DoubleFlash 150 | - |
| ComAlert 150 | - |
| ActionFlash™ 50 | - |
| ActionFlash 150 | - |
| ModuFlash™ | - |
| DoubleFlash 120 | yes |
| PingPong 120 | yes |
| TripleFlash™ 75 | yes |
| TripleFlash 120 | yes |
| SignalAlert™ CAL | yes |
| Action SF 60/120 | yes |
| Action SF 60/TF 120 | yes |
| CalScan™ | yes |
| ActionScan™ | - |
| SignalAlert Steady | - |
| Steady | yes |

AVNS1 Synchronized Single

| Pattern | CAL | Sync | Phases |
|---------------------|-----|------|--------|
| SignalAlert 75 | - | yes | 1 & 2 |
| CometFlash 75 | - | yes | 1 & 2 |
| DoubleFlash 75 | yes | yes | 1 & 2 |
| SingleFlash 75 | yes | yes | 1 & 2 |
| ComAlert 75 | - | yes | 1 & 2 |
| LongBurst 75 | - | yes | 1 & 2 |
| PingPong 75 | yes | yes | 1 & 2 |
| SingleFlash 60 | yes | - | 1 |
| SingleFlash 90 | yes | - | 1 |
| SingleFlash 120 | yes | - | 1 |
| SingleFlash 300 | - | - | 1 |
| DoubleFlash 150 | - | - | 1 |
| ComAlert 150 | - | - | 1 |
| ActionFlash 50 | - | - | 1 |
| ActionFlash 150 | - | - | 1 |
| ModuFlash | - | - | 1 |
| DoubleFlash 120 | yes | - | 1 |
| PingPong 120 | yes | - | 1 |
| TripleFlash 75 | yes | - | 1 |
| TripleFlash 120 | yes | - | 1 |
| SignalAlert CAL | yes | - | 1 |
| Action SF 60/120 | yes | - | 1 |
| Action SF 60/TF 120 | yes | - | 1 |
| CalScan | yes | - | 1 |
| ActionScan | - | - | 1 |
| SignalAlert Steady | - | - | 1 |
| Steady | yes | - | 1 |

AVN2 Dual & AVNCV9 Rear Deck

| Pattern | CAL |
|---------------------|-----|
| SignalAlert 75 | - |
| CometFlash 75 | - |
| DoubleFlash 75 | yes |
| SingleFlash 75 | yes |
| ComAlert 75 | - |
| LongBurst 75 | - |
| PingPong 75 | yes |
| SSNF 75 | - |
| SingleFlash 60 | yes |
| SingleFlash 90 | yes |
| SingleFlash 120 | yes |
| SingleFlash 300 | - |
| DoubleFlash 150 | - |
| ComAlert 150 | - |
| ActionFlash 50 | - |
| ActionFlash 150 | - |
| ModuFlash | - |
| DoubleFlash 120 | yes |
| PingPong 120 | yes |
| TripleFlash 75 | yes |
| TripleFlash 120 | yes |
| SignalAlert CAL | yes |
| Action SF 60/120 | yes |
| Action SF 60/TF 120 | yes |
| CalScan | yes |
| ActionScan | - |
| SteadyFlash 60 | yes |
| SteadyFlash 75 | yes |
| SteadyFlash 90 | yes |
| SteadyFlash 120 | yes |
| Steady & Steady | yes |

AVNS2 Synchronized Dual

| Pattern | CAL | Sync | Seq. |
|---------------------|-----|------|------|
| SignalAlert 75 | - | yes | 4 |
| CometFlash 75 | - | yes | 4 |
| DoubleFlash 75 | yes | yes | 4 |
| SingleFlash 75 | yes | yes | 4 |
| ComAlert 75 | - | yes | 4 |
| LongBurst 75 | - | yes | 4 |
| PingPong 75 | yes | yes | 4 |
| SSNF | - | yes | 2 |
| SingleFlash 60 | yes | - | 2 |
| SingleFlash 90 | yes | - | 2 |
| SingleFlash 120 | yes | - | 2 |
| SingleFlash 300 | - | - | 2 |
| DoubleFlash 150 | - | - | 2 |
| ComAlert 150 | - | - | 2 |
| ActionFlash 50 | - | - | 2 |
| ActionFlash 150 | - | - | 2 |
| ModuFlash | - | - | 2 |
| DoubleFlash 120 | yes | - | 2 |
| PingPong 120 | yes | - | 2 |
| TripleFlash 75 | yes | - | 2 |
| TripleFlash 120 | yes | - | 2 |
| SignalAlert CAL | yes | - | 2 |
| Action SF 60/120 | yes | - | 2 |
| Action SF 60/TF 120 | yes | - | 2 |
| CalScan | yes | - | 1 |
| ActionScan | - | - | 1 |
| SteadyFlash 60 | yes | - | 1 |
| SteadyFlash 75 | yes | - | 1 |
| SteadyFlash 90 | yes | - | 1 |
| SteadyFlash 120 | yes | - | 1 |
| Steady & Steady | yes | - | 1 |

Note: CAL = California Title 13

MODELS

AVN WITH CIGAR PLUG

- AVN1* Solid color, single module red, blue, amber or white.
- AVN1J Split color red/blue.
- AVN1D Split color red/white.
- AVN2** Solid color, dual modules red, blue, amber and/or white.

AVNS SYNCHRONIZED WITH PIGTAIL

- AVNS1* Solid color, single module red, blue, amber or white.
- AVNS2** Solid color, dual modules red, blue, amber and/or white.

AVNCV9 REAR DECK WITH PIGTAIL

- AVNCV9** Solid red, blue and/or amber.
- AVNCV92M Split color, 1 blue/blue, 1 blue/amber.
- AVNCV9JJ Split color, 2 red/blue.
- AVNCV9JK Split color, 1 red/blue, 1 red/amber.
- AVNCV9KK Split color, 2 red/amber.

OPTIONS

- AVNBKT1 Low profile mounting (headliner) bracket for AVN1 Series.
- AVNBKT2 Low profile mounting (headliner) bracket for AVN2 Series.
- AVNBKT3 Visor mounting bracket, each (2 required for dual unit).
- AVNBKT4 Adjustable height bracket kit.
- AVNBKT5 Headliner mounting bracket for 2003-2010 Ford Crown Victoria.

* Replace symbol in model number with letter indicating choice of color:
A = Amber, B = Blue, R = Red or C = White

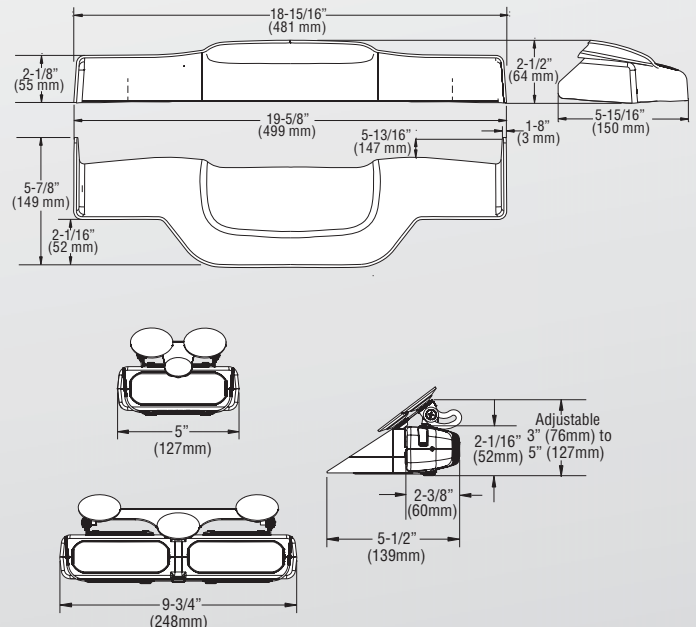

WHELEN®

ENGINEERING COMPANY, INC.

51 Winthrop Road

Chester, Connecticut 06412-0684

(860) 526-9504 • Fax: (860) 526-4078

www.whelen.com

Whelen Engineering reserves the right to upgrade and improve products without notice.
© 2011 Whelen Engineering Company, Inc. Printed in U.S.A.
NASCAR® is a registered trademark of the National Association for Stock Car Auto Racing, Inc
Code No. 12182D - 08/11