

WHELEN®

Power Control Centers & Switch Panels



Whelen products
are proudly designed
and manufactured
in the U.S.A.

Form# PCCA1009

POWER CONTROL CENTERS & SWITCH PANELS

WCC9 - WeCan® Electronic Control Head



For use with Liberty, Freedom and Justice WeCan lightbars. Hand held or mounted to the dash or console, the WCC9 replaces the standard ECM (Electronic Control Module) and is easy to program, install and control.

FEATURES

- Control warning, take-downs, alley lights and Traffic Advisor from a single key pad.

- Auxiliary input slide switch, position 3.
- Small diameter, 22 gauge, 2 conductor cables mates to your WeCan lightbar for easy installation.
- 10 pre-programmed popular warning configurations via four dip switches located on the rear of the controller.
- No computer required to program control head.
- May be used with existing WeCan lightbars or substituted for the WeCan ECM at the time of the lightbar purchase.
- LED backlighted push buttons with LED On/Off indicators.
- State-of-the-art membrane switches provide tactile feedback of activation and are equipped with a solid rubber overlay for moisture resistance.
- Surface mounting plate allows for vertical or horizontal mounting of control head.
- 5-C, 3' input/output harness, standard.
- Function labels are included.

MODELS

WCC9

Controller for use with existing WeCan lightbars.

WCC9SUB

Substitute WCC9 for ECM, when purchased with a WeCan lightbar.

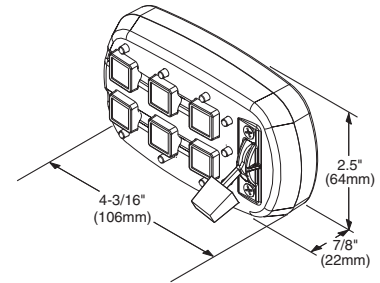

PCCS9 Series - 9 Switch High & Low Current Power Control Centers



PCCS9NP

PCCS9R

4 position, 3 level slide switch with 3 different colored LED indicators for 3 separate primary warning light controls.

FEATURES

- Control 9 lightbar functions.
- Auxiliary input slide switch, position 3.
- Small diameter, 22 gauge output wires, reduce cable size to switch remote relays (not included) for proper operation of devices.
- 6 push button type switches for secondary lightbar functions.

- Two models (PCCS9NP/S9R) offer momentary contact switch, on the 6th push-button switch for strobe low power, trunk lock or gun lock control.
- Backlighted legend windows switch from green to red when switch is engaged for easy identification of switch in use.
- 72 press-on legend tabs.
- Individual fused outputs on Models PCCS9R / PCCS9R1.
- Designed to stack-mount with the WS295 Series Siren amplifiers or Traffic Advisor™ Control Head.
- Universal bail bracket.

MODELS

PCCS9NP

Programmable low current control switch center for use with the new WeCan® Series Lightbars, Edge® 9M, Freedom, Liberty and other lightbars with low current switching. For lightbars that utilize high current switching, use PCCS9R. Four position slide switch, five push-on/push-off switches and a momentary push On-Off switch.

PCCS9R

High current switch control center with built-in relays for lightbars that use standard switching. Four position slide switch and five push-on/push-off switches and one momentary push on-off switch. Nine built-in 30-amp relays. Connects to most rotating or strobe lightbars without the use of separately mounted relays or relay boxes.

PCCS9NP

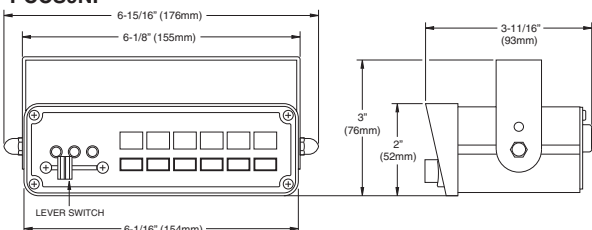

PCCS9R

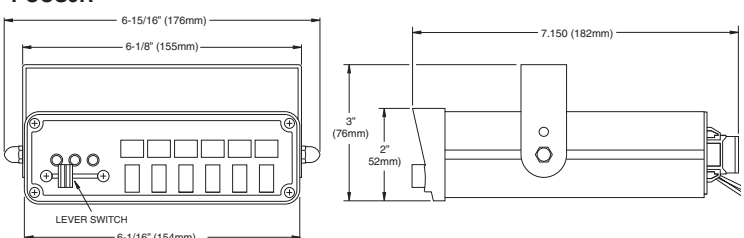

PCC Series -Light Switching Power Control Centers



PCC6R



PCC10

Six and ten-switch control centers provide complete control in a fully assembled, low cost package.

FEATURES

- PCC6R power control centers are fully wired, with one 40-amp and five 20-amp rocker style switches.
- PCC10 power control centers are fully wired, with ten 20-amp rocker style switches.

- Single pole/single throw switches light up to indicate function in use.
- Backlighted legend windows for easy visibility in any light.
- 72 commonly used press-on legend tabs standard.
- Backlight circuit can be connected to vehicle dimmer switch to control backlight intensity.
- Individual spade-type fuses conveniently located on rear mounted fuse strip.

- Easy installation using rear mounted "captive" terminal block.
- Black epoxy-finished, steel housing.
- 12 VDC.
- Universal bail bracket mount for under dash mounting.

MODELS

PCC6R

One 40-amp master switch, five 20 amp switches, lighted.

PCC10

Ten 20-amp switches, lighted.

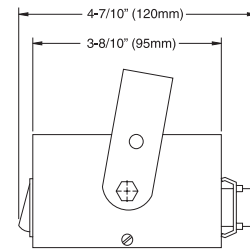
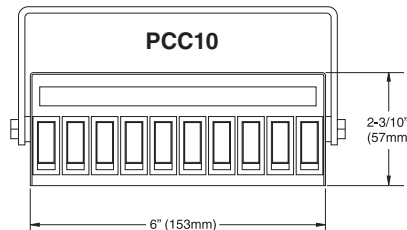
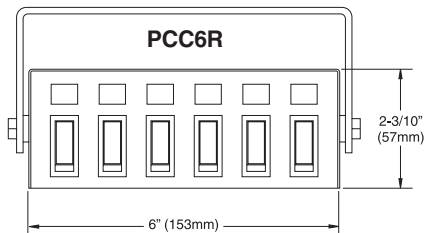

PCC8R - 8 Function Power Control Centers



MODEL

PCC8R

Eight function control center with three 20-amp relays and five 10-amp relays.

Basic, eight position key pad with remote relay box, ideal for DOT, Tow and Wrecker vehicles.

FEATURES

- Eight function control center with three 20-amp relays and five 10-amp relays.

- Not programmable.
- Diagnostic feedback for relay confirmation.
- Push-On/Push-Off or momentary activation.
- LED back lighted membrane switches are designed with a solid rubber overlay for moisture resistance.
- 12-volt or isolated switching.
- Ignition control available via DIP switch.
- 70 Amps maximum.

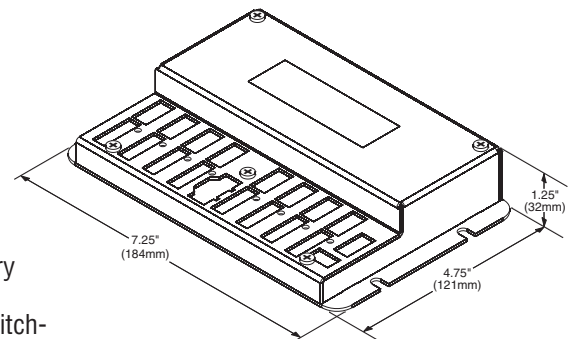

PCCHD Series - Heavy-Duty Power Control Centers

Reliable control for all types of lightbar and emergency signaling functions.



FEATURES

- All switches are heavy duty, circuit breaker type.
- PCCHD1 is fully assembled with six 25-amp SPST circuit breaker switches.
- PCCHD2 has five 25-amp circuit breaker switches plus a 40-amp circuit breaker switch for use as a master switch to control all other switches or for high current switching requirements.

- Backlight circuit can be connected to vehicle dimmer switch to control backlight intensity.
- All extruded aluminum housing.
- Backlight legend windows for easy visibility in any light.
- 72 commonly used press-on legend tabs standard.
- Red LED indicators above switches for each On/Off function.
- Rear terminal block for ease of wiring.
- Universal bail bracket mount for under dash mounting.

- Designed to stack mount with the 295 Series Siren amplifiers or Traffic Advisor™ Control Heads.

MODELS

PCCHD1

Heavy-duty switchbox with six 25-amp circuit breaker switches.

PCCHD2

Heavy-duty switchbox with five 25-amp and one 40-amp master circuit breaker switches.

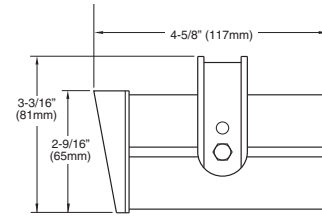
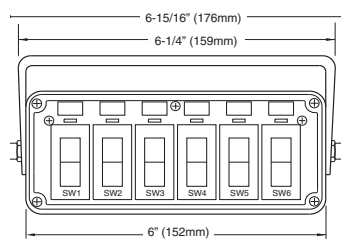

Switch Panels



FEATURES

- "L" shaped aluminum bracket with one, two, three or four PC switches of your choice.
- Illuminated or non-illuminated switches available.
- All PC switches have 15-amp contacts.

MODELS

PSW3

Hi/Off/Low intensity strobe beacon or strobe system switch with LED "On" indicator and "L" bracket.

1SWITCH

1 switch bracket, specify PC switch.

2SWITCH

2 switch bracket, specify PC switches.

3SWITCH

3 switch bracket with switch, specify PC switches below.

4SWITCH

4 switch bracket with switch, specify PC switches below.

PC1

SPST, illuminated, On/Off switch.

PC2

SPST, momentary On switch.

PC3

SPDT, illuminated, On/Off/On switch.

PC4

SPDT, On/On switch.

PC5

DPDT, On/Off/On switch.

PC5S

DPDT, for strobe Hi/Off/Low switch.

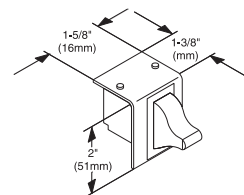
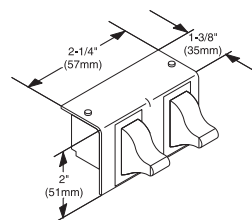
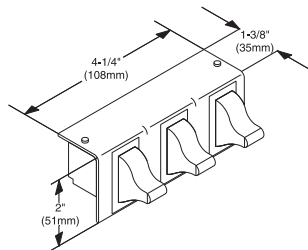
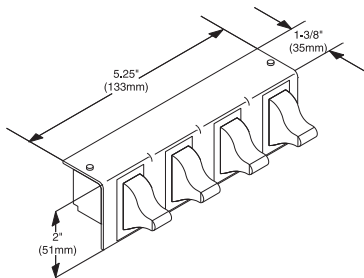

WHELEN
ENGINEERING COMPANY, INC.

51 Winthrop Road
Chester, Connecticut 06412-0684
(860) 526-9504 • Fax: (860) 526-4078
www.whelen.com



Whelen Engineering reserves the right to upgrade and improve products without notice.

© 2009 Whelen Engineering Company, Inc.
Printed in U.S.A. Form No. 11988B-1009