

ORION™ 600

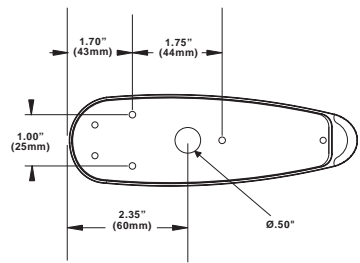

ORION 650E

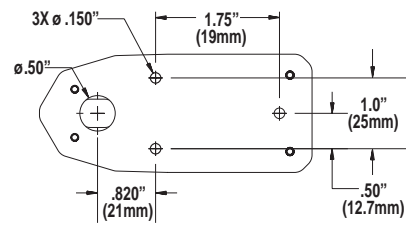

ORION 500

25413

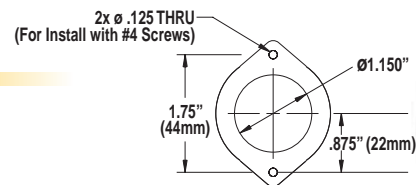

ORION 650

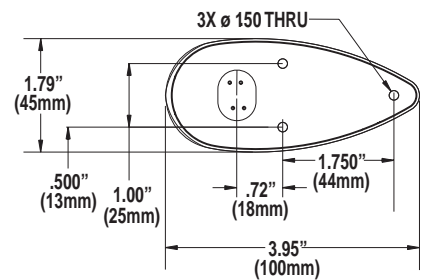

Distributed By:



Warranty, Service & Repair Station
United States
 Whelen Engineering Company, Inc.
 51 Winthrop Road
 Chester, CT 06412-0684
 Tel: 860-526-9504
 Fax: 860-526-2009
 www.whelen.com
 aviation@whelen.com

Aviation Technical Support
 Tim Loftus
 860-526-9504 Ext. 2335
 tloftus@whelen.com

Customer Service
 860-526-9504 Ext. 6
 custserv@whelen.com

Service & Repair Station
Canada
 Wright Instruments Ltd.
 2762 Slough Street
 Mississauga, Ontario
 Canada L4T 1G3
 Tel: 905-677-7167
 Fax: 905-677-2188

Overseas
 AAR Allen Group International
 Kruisweg 705
 P.O. Box 52
 Hoofddorp, Netherlands 2130 AB
 Tel: 31-20-6552213
 Fax: 31-20-6533991



Orion
 Series

Self contained LED position & anti-collision lightheads



ORION™ Series Lighthoods

All LED self-contained wingtip and tail mounted Position & Anti-Collision system. Eliminates the need for external power supplies and reduces current draw and provides thousands of hours of operation.



ORION 600

Drawing#: 71733 **Weight:** 0.5 lbs. (227gm)
Current Draw: 0.48/0.17 Amps Position 1.0/0.5 Amps Avg. ACL
Position LED Color: Aviation Red, Aviation Green, Aviation White
Anti-Collision LED Color: Aviation White
Lens: Clear polycarbonate hardcoat, field replaceable.

Model #	Part #	Description	Approvals
OR6001G	01-0771733-01	Wingtip PTA Green, 12 VDC	TSO/ETSO-C96a Class II / TSO/ETSO-C30c Type II & III
OR6001R	01-0771733-02	Wingtip PTA Red, 12 VDC	TSO/ETSO-C96a Class II / TSO/ETSO-C30c Type I & III
OR6002G	01-0771733-11	Wingtip PTA Green, 28 VDC	TSO/ETSO-C96a Class II / TSO/ETSO-C30c Type II & III
OR6002R	01-0771733-12	Wingtip PTA Red, 28 VDC	TSO/ETSO-C96a Class II / TSO/ETSO-C30c Type I & III

ORION 650E

Drawing#: 90701 **Weight:** 0.26 lbs. (118gm)
Current Draw: 0.3/0.15 Amps Position 0.7/0.35 Amps Avg. ACL
Position LED Color: Aviation Red, Aviation Green, Aviation White
Anti-Collision LED Color: Aviation White
Lens: -

Model #	Part #	Description	Approvals
OR6501GE	01-0790701-01	Embedded PTA Green, 12 V	STC / TSO/ETSO-C96a Class II / TSO/ETSO-C30c Type II & III
OR6501RE	01-0790701-02	Embedded PTA Red, 12 V	STC / TSO/ETSO-C96a Class II / TSO/ETSO-C30c Type I & III
OR6502GE	01-0790701-11	Embedded PTA Green, 28 V	STC / TSO/ETSO-C96a Class II / TSO/ETSO-C30c Type II & III
OR6502RE	01-0790701-12	Embedded PTA Red, 28 V	STC / TSO/ETSO-C96a Class II / TSO/ETSO-C30c Type I & III

ORION 650

Drawing#: 90725 **Weight:** 0.3 lbs. (136gm)
Current Draw: 0.2/0.17 Amps Position 0.56/0.24 Amps Avg. ACL
Position LED Color: Aviation Red, Aviation Green
Anti-Collision LED Color: Aviation White
Lens: Clear polycarbonate hardcoat, field replaceable.

Model #	Part #	Description	Approvals
OR6501G	01-0790725-01	Wingtip PTA Green, 14 V	STC / TSO/ETSO-C96a Class III / TSO/ETSO-C30c Type II
OR6501R	01-0790725-02	Wingtip PTA Red, 14 V	STC / TSO/ETSO-C96a Class III / TSO/ETSO-C30c Type I
OR6502G	01-0790725-11	Wingtip PTA Green, 28 V	STC / TSO/ETSO-C96a Class III / TSO/ETSO-C30c Type II
OR6502R	01-0790725-12	Wingtip PTA Red, 28 V	STC / TSO/ETSO-C96a Class III / TSO/ETSO-C30c Type I

ORION 500

Drawing#: 71774 **Weight:** 0.29 lbs. (132gm)
Current Draw: 0.2/0.1 Amps Position 0.72/0.36 Amps Avg. ACL
Position LED Color: Aviation White
Anti-Collision LED Color: Aviation White
Lens: Clear polycarbonate hardcoat, field replaceable.

Model #	Part #	Description	Approvals
OR5001V	01-0771774V01	Tail PTA Light White, 12 V	STC / TSO/ETSO-C96a Class II & III / TSO/ETSO-C30c Type III
OR5002V	01-0771774V02	Tail PTA Light White, 28 V	STC / TSO/ETSO-C96a Class II & III / TSO/ETSO-C30c Type III

FAR SPEC

A Technical Standard Order (TSO) is a minimum performance standard and does not equal compliance with the applicable Federal Aviation Regulations. In fact other manufacturers produce TSO approved items with operational characteristics that contradict the FARs. Whelen designs products as FAR-SPEC, Federal Aviation Regulations – Specified Lighting. FAR-SPEC is compliant with all applicable FAR's making your installation legal. * Installers must follow the approved guidance for installation of the product to be FAR-SPEC compliant

LED Anti-Collision Performance Outputs

