

PRODUCT DESCRIPTION

Model WSXPL60x*, EXPLOSION PROOF SPEAKER ASSEMBLY

Part # 01C1461898-0x*
Doc. # 04-0113175-01

GENERAL-

Whelen Model WSXPL60x* is an explosion proof 60 watt speaker assembly intended for use in indoor personnel warning applications, where high sound level output is required.

The speaker flare is made from fiberglass, with a spun aluminum re-entrant section. A speaker driver, housed in an explosion proof housing, is assembled to the speaker. A heavy duty, painted steel mounting bracket allows the installer to position the speaker in a number of different ways.

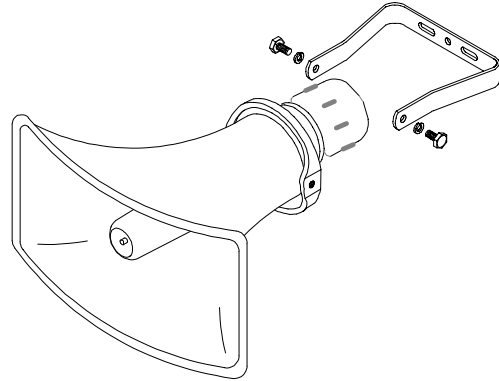

INSTALLATION-

Determine the location of the speaker. Mount to a rigid structure, using the supplied mounting bracket. The bracket dimensions are shown in the detail drawing. Position the speaker as required. Do not position the speaker pointing upward, if there is a possibility of filling with water.

Speaker connections are made by carefully removing the back cover of the driver housing. Connect one of the siren audio speaker wires to one driver wire. Connect the second speaker audio wire to the other driver wire.

Prior to re-assembly, make certain that the machined surfaces of the housing are clean. Do not use any type of gasket or sealing compound. Tighten all housing bolts completely.

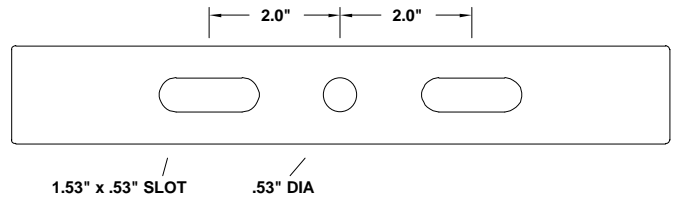

Mounting Bracket Detail

PIONEERS IN WARNING SIGNALS
WHELEN®

ENGINEERING COMPANY

Route 145, Winthrop Rd., Chester, CT 06412-0684

Tel.: (800) 63 SIREN • Fax: (860) 526-4784

WSXPL60x* EXPLOSION PROOF SPEAKER ASSEMBLY**PRODUCT SPECIFICATIONS****Dimensions**

Height: 12" (30.4 cm)
Width: 22" (55.8 cm)
Depth: 25.5" (58.3 cm)
Weight: 25 lbs. (11.3 kg)

Performance

SPL: 60W 123 dbA (at 4 ft., 500 Hz)
Dispersion: 120° x 60°

Finish

Speaker: Black

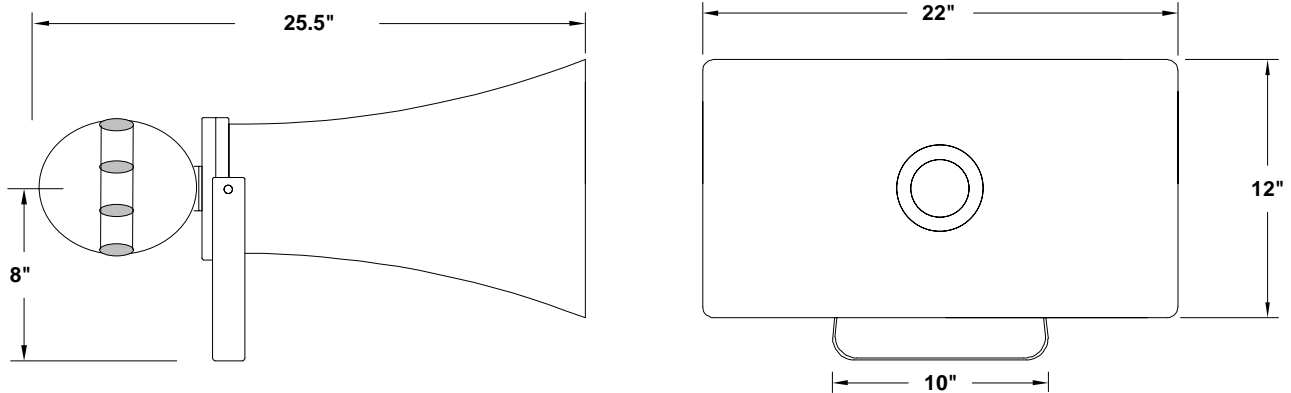
**DIMENSIONS**

- Notes: 1. Specify classified area.
* x = 1 for Class I, Groups C,D
2 for Class I, Groups C,D and Class II, Groups E, F, G
3 for Class I, Groups B, C, D
2. Hazardous location listings per Model HLE-30, by Atlas/Soundolier, Fenton, Missouri.
3. SPL (Sound Pressure Level) readings are +/- 2 dbA.

PIONEERS IN WARNING SIGNALS
WHELEN®
ENGINEERING COMPANY
Route 145, Winthrop Rd., Chester, CT 06412-0684
Tel.: (800) 63 SIREN • Fax: (860) 526-4784