



WHELEN AEROSPACE TECHNOLOGIES

Phone: (860) 526-9504  
Fax: (860) 526-2009  
Internet: www.flyWAT.com  
Sales/Service e-mail: info@flyWAT.com

### Installation Guide/ICA: 71182( )-series

Model(s) 7118201, 7118202

P/N(s): 01-0771182-01, 01-0771182-02  
LED Forward Position Light Assembly

TSO-C30c  
TYPE I & II;  
APPROVED

*The conditions and tests required for TSO approval of this article are minimum performance standards. Those installing this article either on or within a specific type or class of aircraft must determine that the aircraft installation conditions are within the TSO standards which include any accepted integrated non-TSO functions. TSO articles and any accepted integrated non-TSO function(s) must have separate approval for installation in an aircraft. The article may be installed only according to 14 CFR part 43 or the applicable airworthiness requirements.*

#### OPERATING INSTRUCTIONS:

**Nominal Operational Voltage:** . . . 28 VDC (nominal)  
**Input Current:** . . . . . 0.35 Amps  
**Weight** . . . . . 0.25 lbs.

**EQUIPMENT LIMITATIONS:** An approved forward position lighting system consists of two lights, one located on each wingtip, mounted behind a clear lens.

**AIRWORTHINESS LIMITATIONS:** The Airworthiness Limitations section is FAA approved and specifies inspections and other maintenance required under §43.16 and §91.403 of the Federal Aviation Regulations, unless an alternative program has been approved.

No airworthiness limitations are associated with the installation of the forward position light.

**CONTINUED AIRWORTHINESS:** The 71182 series LED wingtip position light assembly is designed with 6 LED's. If any one LED fails, the unit must be repaired or replaced.

**PERIODIC INSPECTIONS:** An annual inspection shall be performed unless the OEM specifies a shorter interval.

**INSTALLATION PROCEDURES:** The following information is to assist in the installation of a WAT LED forward position light system.

1. Choose the appropriate 71182( ) series light assembly.
2. The installation procedure described in the following text will be confined to a single light installation, but is identical for multiple light installations.  
**CAUTION!** Do not touch the LEDs with either fingers or sharp objects. This could soil or damage the LEDs and effect the optical performance of the light.
3. Make sure the system is equipped with an appropriate sized breaker. Connect the +28VDC lead to position A on the input cable assembly (supplied with the light assembly). Connect the existing ground lead to position B wire on the input cable assembly or use the supplied connector as shown in the illustrations. Both leads must be connected by an approved FAA connection. Insure that the wire leads clear of any obstructions and ty-wrap as required.
4. Position the base of the new light assembly onto the mounting surface. Insert three (3) #6 x 100° flat head screws into the mounting holes and tighten firmly.
5. Check all avionics systems for interference from the installation.
6. A flight check should be performed by a properly certified pilot.
7. If required, update aircraft records utilizing FAA Field Approval (Form 337) or equivalent.

Model(s):  
7118201 (Green)  
7118202 (Red)

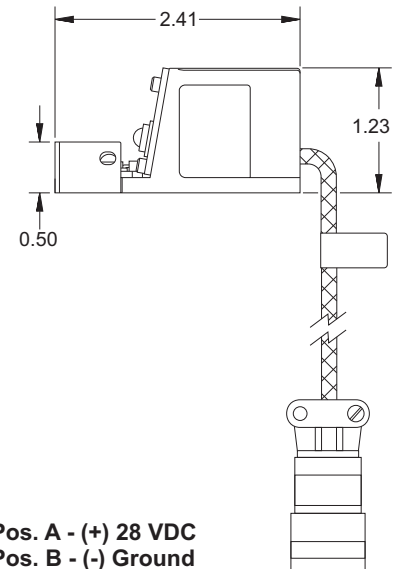

Model(s):  
7118201  
7118202

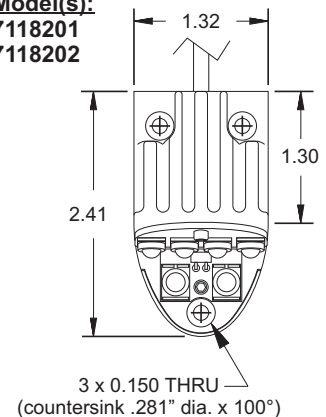

Aviation

**Models Shown:**

7118201 (P/N 01-0771182-01)

7118202 (P/N 01-0771182-02)

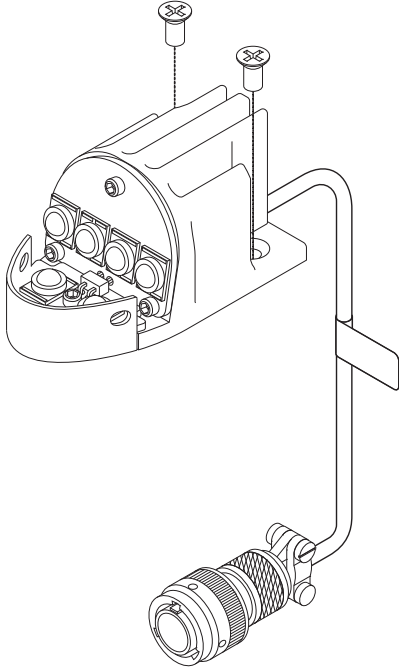

**Mounting Dimensions**

