

51 Winthrop Road
Chester, Connecticut 06412-0684
Phone: (860) 526-9504
Sales Email: autosale@whelen.com
Canadian Sales: canadiansales@whelen.com
Customer Service: custserv@whelen.com

Safety First: This document provides all the necessary information to allow your Whelen product to be properly and safely installed. Before beginning the installation and/or operation of your new product, the installation technician and operator must read this manual completely. Important information is contained herein that could prevent serious injury or damage.

- Proper installation of this product requires the installer to have a good understanding of automotive electronics, systems and procedures.
- Whelen Engineering requires the use of waterproof butt splices and/or connectors if that connector could be exposed to moisture.
- Failure to use specified installation parts and/or hardware will void the product warranty!
- If mounting this product requires drilling holes, the installer MUST be sure that no vehicle components or other vital parts could be damaged by the drilling process. Check both sides of the mounting surface before drilling begins. Also de-burr any holes and remove any metal shards or remnants. Install grommets into all wire passage holes.
- Do not install this product or route any wires in the deployment area of your air bag. Equipment mounted or located in the air bag deployment area will damage or reduce the effectiveness of the air bag, or become a projectile that could cause serious personal injury or death. Refer to your vehicle owner's manual for the air bag deployment area. The User/Installer assumes full responsibility to determine proper mounting location, based on providing ultimate safety to all passengers inside the vehicle.
- For this product to operate at optimum efficiency, a good electrical connection to chassis ground must be made. The recommended procedure requires the product ground wire to be connected directly to the NEGATIVE (-) battery post.
- If this product uses a remote device to activate or control this product, make sure that this control is located in an area that allows both the vehicle and the control to be operated safely in any driving condition.
- Do not attempt to activate or control this device in a hazardous driving situation.
- This product contains either strobe light(s), halogen light(s), high-intensity LEDs or a combination of these lights. Do not stare directly into these lights. Momentary blindness and/or eye damage could result.
- Waterproof butt splices and/or connectors are required if that connection could be exposed to moisture. Any unused wires must be sealed (waterproofed) to prevent moisture infiltration.
- WARNING!** All customer supplied wires that connect to the positive (+) terminal of the battery must be sized to supply at least 125% of the maximum operating current and FUSED "at the battery" to carry that load. DO NOT USE CIRCUIT BREAKERS WITH THIS PRODUCT!
- FAILURE TO FOLLOW THESE PRECAUTIONS AND INSTRUCTIONS COULD RESULT IN DAMAGE TO THE PRODUCT OR VEHICLE AND/OR SERIOUS INJURY TO YOU AND YOUR PASSENGERS!**

Mounting:

- Mark the location of the 2 mounting holes onto the mounting surface using the dimensions shown, or use the flange as a template. Always check behind the mounting surface to be sure you will not harm other vehicle components.
- Drill the 2 mounting holes using a drill sized for a #6 sheet metal screw, then drill the 1" wire access hole as shown. Deburr this hole before continuing.
- Feed wires through wire hole then secure WorkSide Light to mounting surface as shown.

IMPORTANT! Proper installation requires the vent membrane to be located above the horizontal centerline of the installed WorkSide Light!

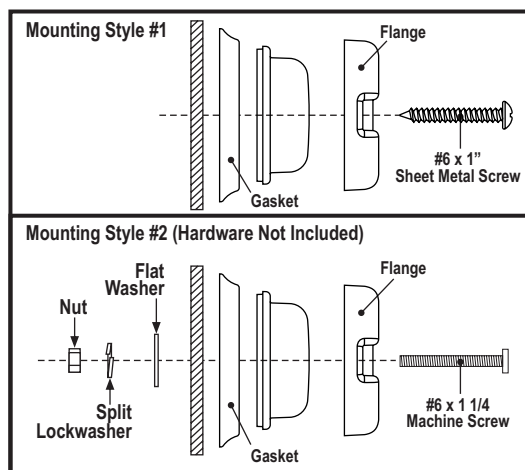
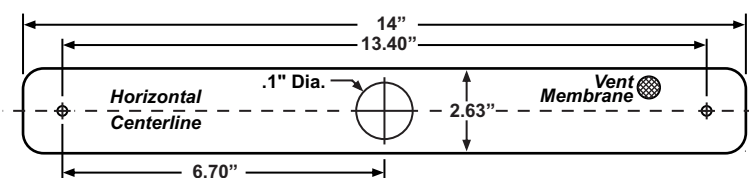

IMPORTANT WARNING!

CAUTION! DO NOT LOOK DIRECTLY AT THESE LEDS WHILE THEY ARE ON. MOMENTARY BLINDNESS AND/OR EYE DAMAGE COULD RESULT!

Scan-Lock™:

TO CHANGE RAMP ON SETTING: To cycle forward to the next ramp on setting apply +VBAT to the WHT/VIO wire (or switch) for less than 1 second and release. To cycle back to the previous ramp on setting, apply +VBAT to WHT/VIO wire for over 1 second and release. When cycling through options, the unit will demonstrate the ramp on speed and then save it. A quick flash indicates ramp on is turned OFF and the unit is set to power on at full brightness instantly.

TO RESTORE THE FACTORY DEFAULT RAMP ON SETTING: With the unit turned off, apply power to the WHT/VIO wire, then turn on the unit. The unit will turn on with its current setting and then reset to default (SLOW 800ms) for subsequent power on. Allow the unit to run for 3 seconds before removing power from the WHT/VIO wire.

TO CHANGE LOW POWER INTENSITY: Apply +VBAT to the VIO wire to hold in low power mode. Cycle forward to the next intensity by applying +VBAT to the WHT/VIO wire (or switch) for less than 1 second and releasing. To cycle back to the previous intensity, apply +VBAT to WHT/VIO wire for over 1 second and release. The intensity will be saved 1 second after the switch.

TO RESTORE THE FACTORY DEFAULT LOW POWER INTENSITY: With the unit turned off, apply power to the WHT/VIO wire and the VIO wire, then turn on the unit. The unit will turn on with low power active with its current intensity and then reset to default (25%) for subsequent low power operation. Allow the unit to run for 3 seconds before removing power from the WHT/VIO wire.

Electrical Specifications:

Current: 12V - 1.40A | 25.6V - 0.75A

Wire Color	Function
White	(+) 12V or 24V (Fuse@3A)
Black	(-) Ground
Violet	Low Power
White W/ Violet	Scan-Lock

DVI / Low Power Scan-Lock Table

Num	DVI Ramp Up Speed	Num	Low Power
1	Slow Ramp 800ms	1	25%
2	Medium Ramp 400ms	2	50%
3	Fast Ramp 200ms	3	75%
4	Instant On	4	NA

It is the responsibility of the installation technician to make sure that the installation and operation of this product will not interfere with or compromise the operation or efficiency of any vehicle equipment!

Before returning the vehicle to active service, visually confirm the proper operation of this product, as well as all vehicle components/equipment.